

UNITED STATES
DEPARTMENT OF THE INTERIOR
GEOLOGICAL SURVEY

Form Approved.
Budget Bureau No. 42-R1424

SUNDRY NOTICES AND REPORTS ON WELLS

(Do not use this form for proposals to drill or to deepen or plug back to a different reservoir. Use Form 9-331-C for such proposals.)

1. oil well ☐ gas well ☒ other ☐
2. NAME OF OPERATOR
El Paso Exploration Company
3. ADDRESS OF OPERATOR
PO Box 4289, Farmington, NM 87499
4. LOCATION OF WELL (REPORT LOCATION CLEARLY. See space 17 below.)
1770'S, 1740'W
AT SURFACE:
AT TOP PROD. INTERVAL:
AT TOTAL DEPTH:

16. CHECK APPROPRIATE BOX TO INDICATE NATURE OF NOTICE, REPORT, OR OTHER DATA

REQUEST FOR APPROVAL TO:

TEST WATER SHUT-OFF ☐
FRACTURE TREAT ☐
SHOOT OR ACIDIZE ☐
REPAIR WELL ☐
PULL OR ALTER CASING ☐
MULTIPLE COMPLETE ☐
CHANGE ZONES ☐
ABANDON* ☐

(other) Change Dedication

SUBSEQUENT REPORT ON

☐
☐
☐
☐
☐
☐
☐
☐
☐
☐

RECEIVED
APR 21 1983

U. S. GEOLOGICAL SURVEY
FARMINGTON, N. M.

Report results of multiple completion or zone change on Form 9-330.)

5. LEASE

Contract #183

6. IF INDIAN, ALLOTTEE OR TRIBE NAME

Jicarilla Apache

7. UNIT AGREEMENT NAME

8. FARM OR LEASE NAME

Chacon Jicarilla "D"

9. WELL NO.

20

10. FIELD OR WILDCAT NAME

Chacon Dakota Associated Pool

11. SEC., T., R., M., OR BLK. AND SURVEY OR AREA

Section 27, T-23-N, R-3-W, NMPM

12. COUNTY OR PARISH

Sandoval

13. STATE

NM

14. API NO.

15. ELEVATIONS (SHOW DF, KDB, AND WD)

7372' DF

17. DESCRIBE PROPOSED OR COMPLETED OPERATIONS (Clearly state all pertinent details, and give pertinent dates, including estimated date of starting any proposed work. If well is directionally drilled, give subsurface locations and measured and true vertical depths for all markers and zones pertinent to this work.)*

Attached is a revised C-102 in order to comply with the New Mexico Oil Conservation Division pool rules for the Chacon Dakota Associated Pool. Note the acreage dedication change from the SW/4 to the S/2.

RECEIVED
APR 27 1983
OIL CONSERVATION DIV.

Subsurface Safety Valve: Manu. and Type _____ Set @ _____ Ft.

18. I hereby certify that the foregoing is true and correct

SIGNED

Larry W. Bunk

TITLE

Project Drilling Engineer

DATE

April 19, 1983

(This space for Federal or State office use)

APPROVED BY

TITLE

DATE

CONDITIONS OF APPROVAL, IF ANY:

FILED FOR RECORD

*See Instructions on Reverse Side

APR 21 1983

FAC

198303

OIL CONSERVATION DIVISION

P. O. BOX 2088

SANTA FE, NEW MEXICO 87501

Form C-107
Revised 10-1-78STATE OF NEW MEXICO
MINERALS DEPARTMENT

All distances must be from the outer boundaries of the Section.

EL PASO EXPLORATION COMPANY				Lease CHACON JICARILLA "D"		Well No. 20	
Unit Letter K	Section 27	Township 23N	Range 3W	County Sandoval			
Actual Footage Location of Well: 1770 feet from the South line and 1740 feet from the West line							
Ground Level Elev. 7359	Producing Formation Dakota		Pool Chacon Dakota Associated		Dedicated Acreage: 320 Acres		

1. Outline the acreage dedicated to the subject well by colored pencil or hachure marks on the plat below.
2. If more than one lease is dedicated to the well, outline each and identify the ownership thereof (both as to working interest and royalty).
3. If more than one lease of different ownership is dedicated to the well, have the interests of all owners been consolidated by communitization, unitization, force-pooling, etc?

☐ Yes ☐ No If answer is "yes," type of consolidation _____

If answer is "no," list the owners and tract descriptions which have actually been consolidated. (Use reverse side of this form if necessary.) _____

No allowable will be assigned to the well until all interests have been consolidated (by communitization, unitization, forced-pooling, or otherwise) or until a non-standard unit, eliminating such interests, has been approved by the Commission. REISSUED TO SHOW OPERATOR & DEDICATION CHANGE 4/18/83

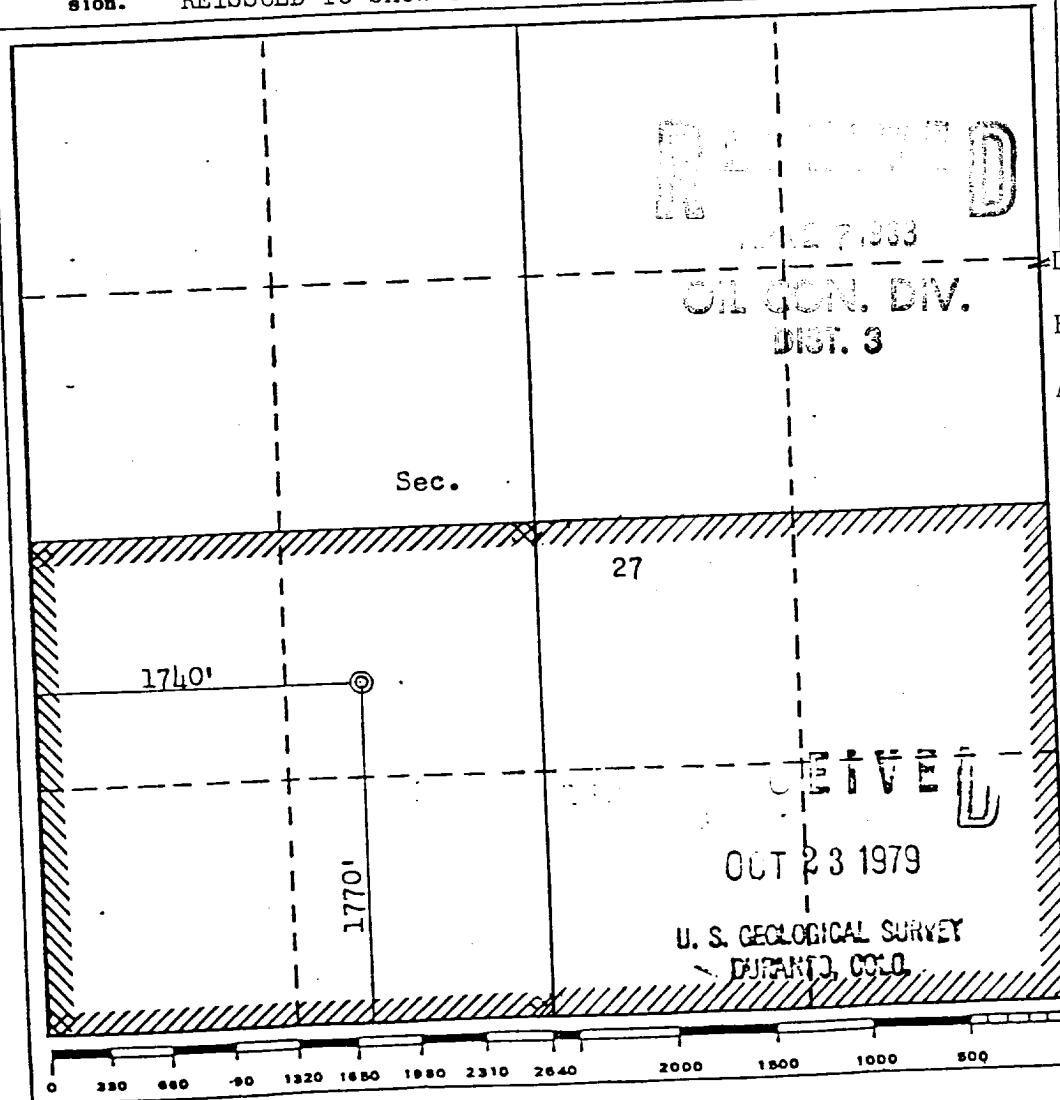

CERTIFICATION

I hereby certify that the information contained herein is true and complete to the best of my knowledge and belief.

D. G. Brisco

Name

Drilling Clerk

Position

El Paso Exploration Co.

Company

April 21, 1983

Date

I hereby certify that the well location shown on this plat was plotted from field notes of actual surveys made by me or under my supervision, and that the same is true and correct to the best of my knowledge and belief.

Date Surveyed

October 4, 1979

Registered Professional Engineer
and/or Land Surveyor*Fred B. Vann Jr.*

Certificate No.

3950