

UNITED STATES  
DEPARTMENT OF THE INTERIOR  
GEOLOGICAL SURVEY

## APPLICATION FOR PERMIT TO DRILL, DEEPEN, OR PLUG BACK

## 1a. TYPE OF WORK

DRILL ☒DEEPEN ☐PLUG BACK ☐

## b. TYPE OF WELL

OIL  
WELL ☒GAS  
WELL ☐

OTHER

SINGLE  
ZONE ☒MULTIPLE  
ZONE ☐

## 2. NAME OF OPERATOR

DOME PETROLEUM CORPORATION

## 3. ADDRESS OF OPERATOR

501 Airport Drive, Suite 107, Farmington, New Mexico 87401

## 4. LOCATION OF WELL (Report location clearly and in accordance with any State requirements.)\*

At surface

2100' FNL, 2100' FWL

At proposed prod. zone

## 14. DISTANCE IN MILES AND DIRECTION FROM NEAREST TOWN OR POST OFFICE\*

17 miles West of Cuba, New Mexico

## 15. DISTANCE FROM PROPOSED\*

LOCATION TO NEAREST

PROPERTY OR LEASE LINE, FT.

(Also to nearest drlg. unit line, if any)

## 18. DISTANCE FROM PROPOSED LOCATION\*

TO NEAREST WELL, DRILLING, COMPLETED,

OR APPLIED FOR, ON THIS LEASE, FT.

## 16. NO. OF ACRES IN LEASE

1920

## 19. PROPOSED DEPTH

5700

## 17. NO. OF ACRES ASSIGNED

TO THIS WELL

40

## 20. ROTARY OR CABLE TOOLS

Rotary

## 21. ELEVATIONS (Show whether DF, RT, GR, etc.)

6794' GR.

## 23.

## PROPOSED CASING AND CEMENTING PROGRAM

SIZE OF HOLE	SIZE OF CASING	WEIGHT PER FOOT	SETTING DEPTH	QUANTITY OF CEMENT
13 1/2"	9 5/8"	32.3#	200'	200 sacks (circulated)
8 3/4"	7"	20# & 23#	5700'	900 sacks (2 stage circulated)

Move in rotary tools. Drill 13 1/2" hole to 200'. Set 200' new 9 5/8", H-40 casing. Cement with 200 sx. class "B" cement with 2% C<sub>A</sub>C<sub>L</sub>. Wait on cement 12 hours. Install 10" 900 series BOP. Test to 500 psi before drilling out from under surface pipe. Check pipe rams daily and blind rams on trips. Drill 8 3/4" hole to TD. The geologic name of the surface formation is Ojo Alamo. Oil is expected in the Entrada. All other formations are probably water bearing. Pertinent formation tops are estimated as Point Lookout 2238, Gallup 3328, Dakota 4560, Morrison 4683, Todilto 5543, and Entrada 5576. Mud system will be low solids nondispersed. Mud weight 8.5-9.2 #/Gal. FL8-10cc, Viscosity 30-50 Sec/Quart. No abnormal temperatures or pressures are anticipated. Logging program will be DIL, FDC/CNL/GR with caliper log. Drill stem test will be taken where necessary for evaluation. If productive 7", 20# & 23#, K55 casing will be run and cemented in two stages with 65/35 Pozmix, 6% Gel, 10# Gilsonite/sx. followed with 100 sacks class "B" cement with 10% salt. Drilling should require approximately 15 days.

IN ABOVE SPACE DESCRIBE PROPOSED PROGRAM: If proposal is to deepen or plug back, give data on present productive zone and proposed new productive zone. If proposal is to drill or deepen directionally, give pertinent data on subsurface locations and measured and true vertical depths. Give blowout preventer program, if any.

24.

SIGNED

*H. D. Hollingsworth*  
H. D. HOLLINGSWORTH

(This space for Federal or State office use)

PERMIT NO.

APPROVED BY

CONDITIONS OF APPROVAL, IF ANY:

TITLE Drilling &amp; Production Foreman

3/4/80

APPROVED  
AS AMENDED  
APPROVAL DATE

TITLE

APR 2 1980

JAMES F. SIMS

DISTRICT ENGINEER

DATE

MAR 6 1980

U. S. GEOLOGICAL SURVEY  
DALLAS, TEX.

5. LEASE DESIGNATION AND SERIAL NO.

N.M. 19151

6. IF INDIAN, ALLOTTEE OR TRIBE NAME

7. UNIT AGREEMENT NAME

8. FARM OR LEASE NAME

DOME FEDERAL 33-20-3

9. WELL NO.

10. FIELD AND POOL, OR WILDCAT

Wildcat

Entrada

11. SEC. T. R. M. OR BLK.

AND SURVEY OR AREA

Sec. 33, T20N, R3W

12. COUNTY OR PARISH

13. STATE

Sandoval

New Mexico

## OIL CONSERVATION DIVISION

STATE OF NEW MEXICO  
ENERGY AND MINERALS DEPARTMENTP. O. BOX 2088  
SANTA FE, NEW MEXICO 87501Form C-107  
Revised 10-1-78

All distances must be from the outer boundaries of the Section

Operator <b>DOME PETROLEUM CORPORATION</b>			Lease <b>DOME-FEDERAL 33-20-3</b>		Well No. <b>1</b>
Unit Letter <b>F</b>	Section <b>33</b>	Township <b>20N</b>	Range <b>3W</b>	County <b>Sandoval</b>	
Actual Footage Location of Well:					
<b>2100</b> feet from the <b>North</b> line and		<b>2100</b> feet from the <b>West</b> line			
Ground Level Elev. <b>6794</b>	Producing Formation <b>Entrada</b>	Pool <b>uc</b> <b>Undesignated Entrada</b>		Dedicated Acreage: <b>40</b> Acres	

1. Outline the acreage dedicated to the subject well by colored pencil or hachure marks on the plat below.
2. If more than one lease is dedicated to the well, outline each and identify the ownership thereof (both as to working interest and royalty).
3. If more than one lease of different ownership is dedicated to the well, have the interests of all owners been consolidated by communitization, unitization, force-pooling, etc?

☐ Yes ☐ No If answer is "yes," type of consolidation \_\_\_\_\_

If answer is "no," list the owners and tract descriptions which have actually been consolidated. (Use reverse side of this form if necessary.) \_\_\_\_\_

No allowable will be assigned to the well until all interests have been consolidated (by communitization, unitization, forced-pooling, or otherwise) or until a non-standard unit, eliminating such interests, has been approved by the Commission.

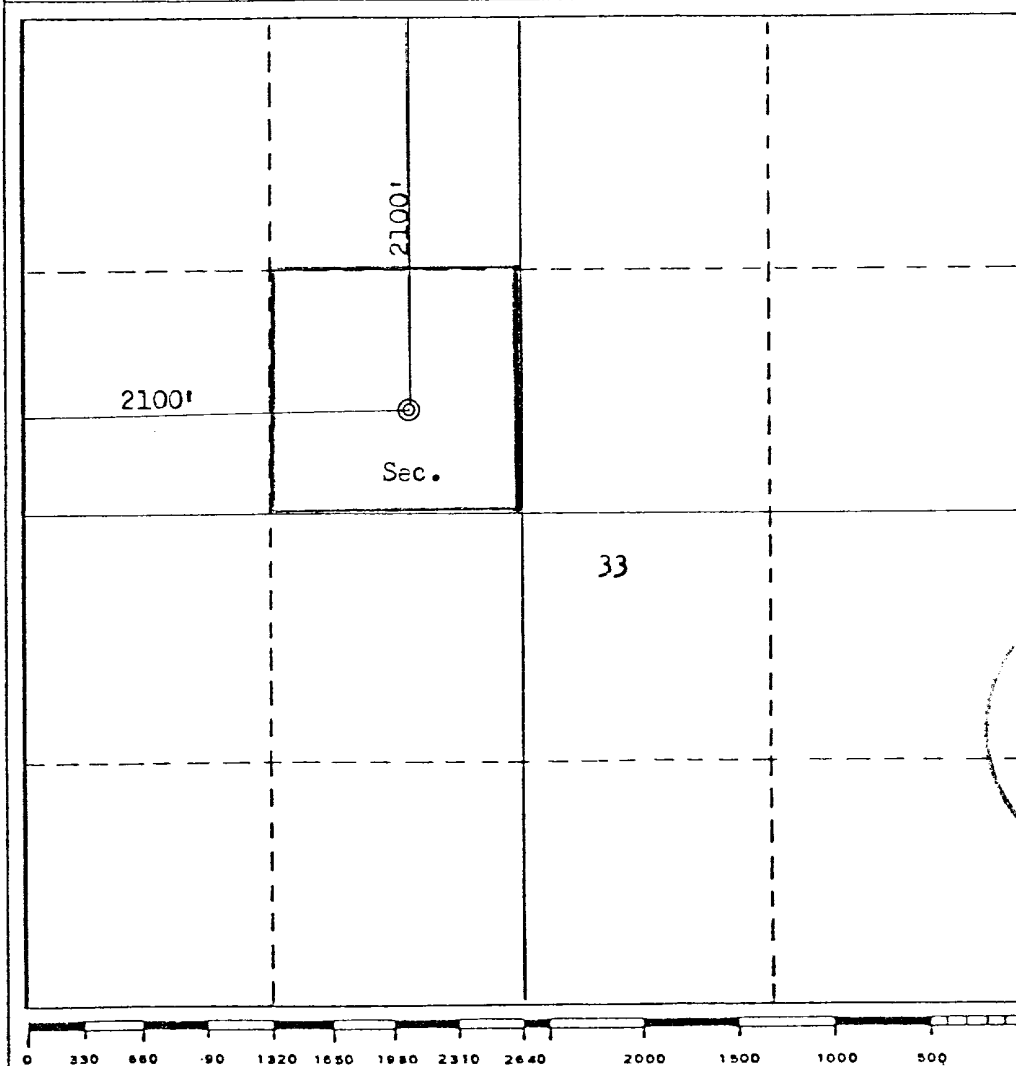

## CERTIFICATION

I hereby certify that the information contained herein is true and complete to the best of my knowledge and belief.

Name

H. D. HOLLINGSWORTH

Position

Drilling &amp; Prod. Foreman

Company

DOME PETROLEUM CORP.

Date

3/5/80

I hereby certify that the well location shown on this plat was plotted from field notes of actual surveys made by me or under my supervision, and that the same is true and correct to the best of my knowledge and belief.

OIL CON. COM.

DIST. 3  
Date Surveyed

March 2, 1980

Registered Professional Engineer  
and/or Land Surveyor

Fred B. Kerr Jr.

Certificate No.

3950

FRED B. KERR, JR.



# DOME PETROLEUM CORP.

SUITE 1400, COLORADO STATE BANK BLDG.

1600 BROADWAY

DENVER, COLORADO 80202

TELEPHONE  
(303) 861-1230

## Development Plan For Surface Use

DOME FEDERAL 33-20-3, WELL #1

2100FNL, 2100'FWL

Sec. 33, T20N, R3W

SANDOVAL COUNTY, NEW MEXICO

1. Existing Roads

The main road to the location is Highway 197 from Cuba, New Mexico towards Torreion Trading Post 9 miles and using existing side roads as shown on the attached topographic map.

2. Planned Access Roads

The access road, to be routed as shown on attached map, will be 18' wide with adequate ditch and water bars.

3. Location Of Existing Wells

None

4. Location Of Proposed Facilities

Flowline and tank battery will be on location pad. Equipment and pits will be fenced as required for protection of livestock and wildlife.

5. Location And Type Of Water Supply

To be hauled from Eugene Johnson's water hole located 6 miles out of Cuba, New Mexico, on Highway 197.

6. Source Of Construction Materials

Not applicable.

7. Method Of Handling Waste Material

All garbage and trash that can be burned shall be burned. All trash that cannot be burned will be contained in a trash pit and covered with a minimum of 24" dirt. All drilling waste, that is cuttings, overflows of oil, water, or drilling fluids will be contained in the reserve pit and buried with adequate cover upon completion of operations. The reserve pit will be fenced until cleanup operations are commenced. Toilet facilities will be provided.

8. Ancillary Facilities

No camps or airstrips are proposed for this location.

DOME PETROLEUM CORP.  
Development Plan For Surface Use  
DOME FEDERAL 33-20-3, WELL #L

9. Well Site Layout  
See attached diagram.
10. Plans For Restoration Of Surface  
Cleanup of location will commence immediately following the removal of the drilling equipment. The reserve pit will be fenced until restoration operations are commenced. The location will be re-turned to original contour if the well is not productive. Both the road and location will be reseeded in accordance with BLM Specifications.
11. Other Information  
This location is on sparsely vegetated sandy land. Vegetation consists principally of sagebrush and native grasses.
12. Lessee's Or Operator's Representative  
H. D. Hollingsworth  
Dome Petroleum Corp.  
501 Airport Drive, Suite 107  
Farmington, New Mexico 87401  
Phone: 505-325-2897 Office  
505-327-1548 Home
13. Certification  
I hereby certify that I, or persons under my direct supervision, have inspected the proposed drill site and access route; that I am familiar with the conditions which presently exist; that the statements made in this plan are, to the best of my knowledge, true and correct; and that the work associated with the operations proposed herein will be performed by Dome Petroleum Corp. and it's contractors and subcontractors in conformity with this plan and the terms and conditions under which it is approved.

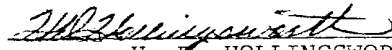
  
H. D. HOLLINGSWORTH  
Drilling & Production Foreman  
Dome Petroleum Corp.

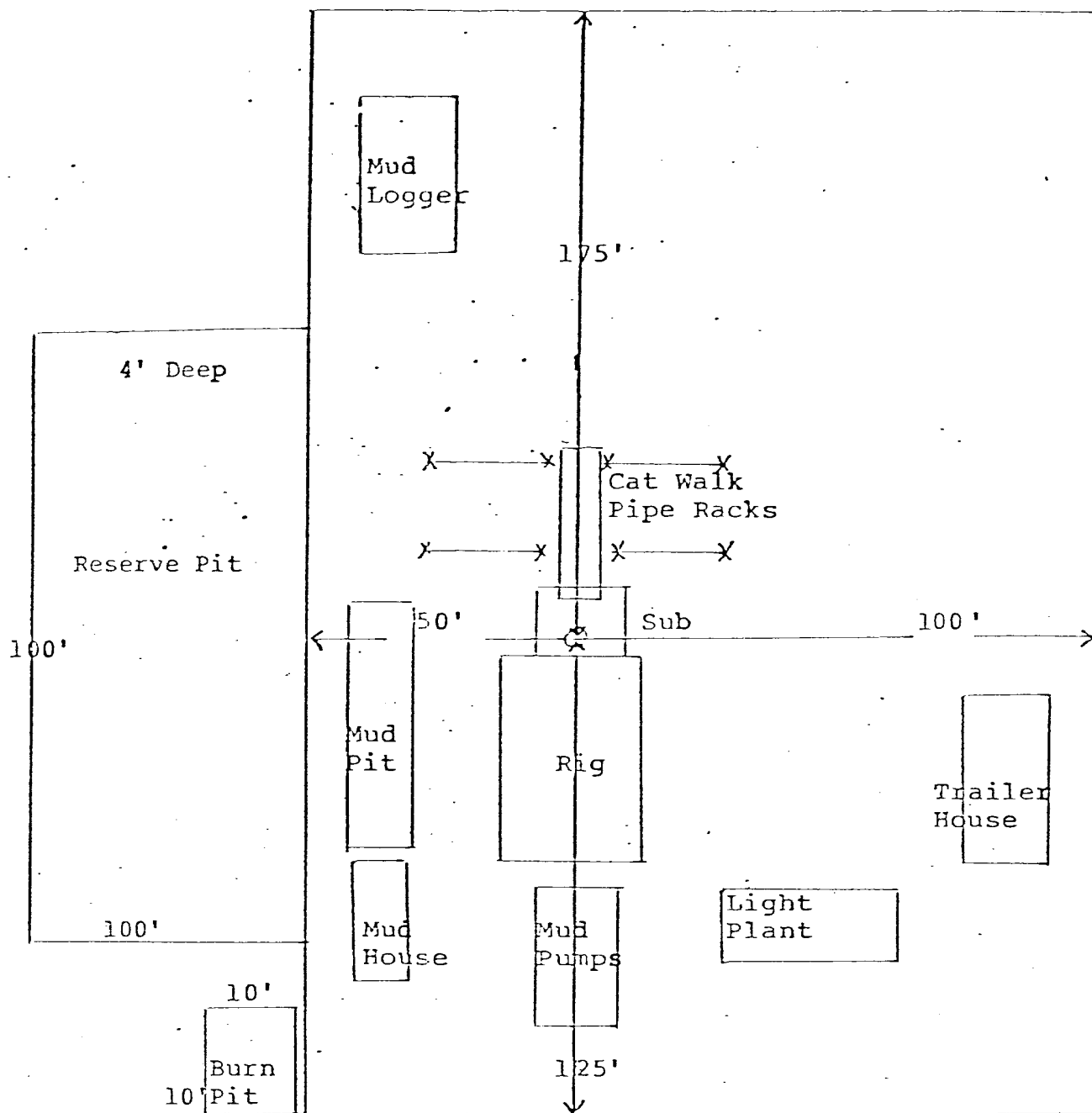
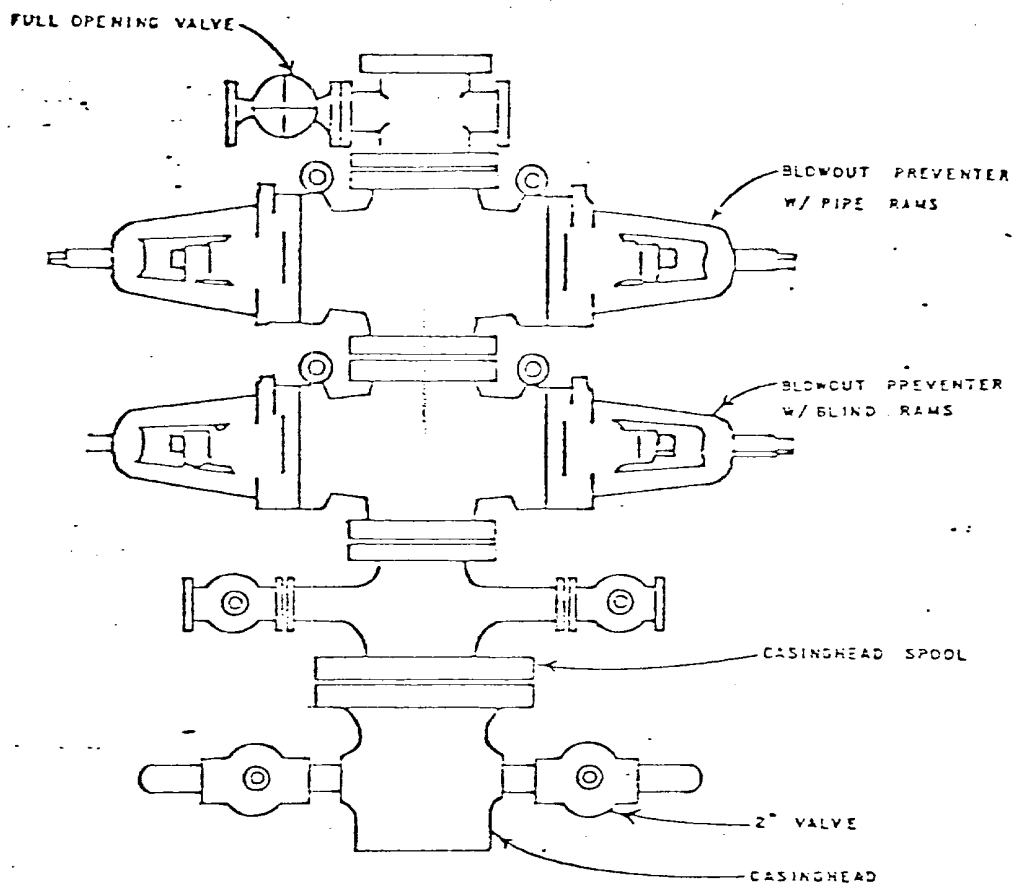

DIAGRAM OF WELL LOCATION

AND DRILLING RIG LAYOUT



## DOME PETROLEUM CORP.

SUITE 1500, COLORADO STATE BANK BLDG.

1600 BROADWAY

DENVER, COLORADO 80202

STANDARD BLOWOUT PREVENTER ASSEMBLY  
10" 900 SERIES

