

UNITED STATES
DEPARTMENT OF THE INTERIOR
GEOLOGICAL SURVEY

APPLICATION FOR PERMIT TO DRILL, DEEPEN, OR PLUG BACK

1a. TYPE OF WORK

DRILL ☒DEEPEN ☐PLUG BACK ☐

b. TYPE OF WELL

OIL
WELL ☒GAS
WELL ☐

OTHER

SINGLE
ZONE ☒MULTIPLE
ZONE ☐

2. NAME OF OPERATOR

DOME PETROLEUM CORP.

3. ADDRESS OF OPERATOR

501 Airport Drive, Suite 107, Farmington, New Mexico 87401

4. LOCATION OF WELL (Report location clearly and in accordance with any State requirements.)*

At surface 1940' FNL, 930' FEL

At proposed prod. zone

14. DISTANCE IN MILES AND DIRECTION FROM NEAREST TOWN OR POST OFFICE*

2 miles Southwest of Counselor's Trading Post, New Mexico

15. DISTANCE FROM PROPOSED*

LOCATION TO NEAREST
PROPERTY OR LEASE LINE, FT.
(Also to nearest drlg. unit line, if any)18. DISTANCE FROM PROPOSED LOCATION*
TO NEAREST WELL, DRILLING, COMPLETED,
OR APPLIED FOR, ON THIS LEASE, FT.

21. ELEVATIONS (Show whether DF, RT, GR, etc.)

7078' GR

23.

PROPOSED CASING AND CEMENTING PROGRAM

SIZE OF HOLE	SIZE OF CASING	WEIGHT PER FOOT	SETTING DEPTH	QUANTITY OF CEMENT
12 1/4"	8 5/8"	23#	200'	200 sacks (circulated)
7 7/8"	4 1/2"	10.5#	5730'	600 sacks (circulated)

Move in rotary tools. Drill 12 1/4" hole to 200'. Set 200' new 8 5/8" 23# K55 casing. Cement with 200 sacks Class "B" cement with 2% CaCl. Wait on cement 12 hours. Install 10" 900 series blowout preventer. Test to 500 psi before drilling out from under surface pipe. Check pipe rams daily and blind rams on trips. Drill 7 7/8" hole to TD. The geological name of the surface formation is San Jose. Oil is expected in the Gallup. All other formations are probably water bearing. Pertinent formation tops are estimated as Kirtland 1620'; Fruitland 1900'; Pictured Cliff 2090'; Chacra 2475'; Cliffhouse 3580'; Point Lookout 4290'; Mancos 4490' and Gallup 5380'. Mud will be low solids nondispersed. Mud weight 8.8-9.2#/Gal., FL 8-10cc, and viscosity 30-50 sec./quart. No abnormal temperatures or pressures are anticipated. Logging program will be DIL, FDC/CNL/GR with Caliper Log. Drill stem test will be taken where necessary for evaluation. If productive 4 1/2" 10.5#, K55 casing will be run and cemented with 500 sacks 65/35 Pozmix, w/6% Gel and 10# Gilsonite/sx. followed with 100 sacks class "B" cement with 10% salt. Drilling should require 15 days.

IN ABOVE SPACE DESCRIBE PROPOSED PROGRAM: If proposal is to deepen or plug back, give data on present productive zone and proposed new productive zone. If proposal is to drill or deepen directionally, give pertinent data on subsurface locations and measured and true vertical depths. Give blowout preventer program, if any.

24.

SIGNED

H. D. HOLINGSWORTH
H. D. HOLINGSWORTH

TITLE

Drlg. & Prod. Foreman

DATE

5/01/80

(This space for Federal or State office use)

PERMIT NO.

APPROVAL DATE

APPROVED BY

CONDITIONS OF APPROVAL, IF ANY:

TITLE

DRILLING OPERATIONS AUTHORIZED ARE
SUBJECT TO COMPLIANCE WITH ATTACHED
"GENERAL REQUIREMENTS"

al Branch

MOCC

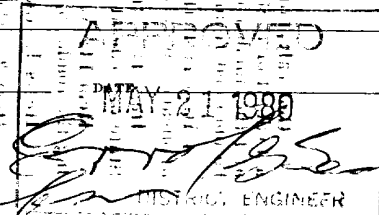

OIL CONSERVATION DIVISION

STATE OF NEW MEXICO
ENERGY AND MINERALS DEPARTMENTP. O. BOX 2088
SANTA FE, NEW MEXICO 87501Form C-107
Revised 10-1-78

All distances must be from the outer boundaries of the Section.

Operator DOME PETROLEUM CORPORATION			Lease DOME-FEDERAL 28-23-6		Well No. 2
Unit Letter H	Section 28	Township 23N	Range 6W	County Sandoval	
Actual Footage Location of Well: 1940 feet from the North line and 930 feet from the East line					
Ground Level Elev. 7078	Producing Formation Gallup		Pool Wildcat		Dedicated Acreage: 40 Acres
<p>1. Outline the acreage dedicated to the subject well by colored pencil or hatchure marks on the plat below.</p> <p>2. If more than one lease is dedicated to the well, outline each and identify the ownership thereof (both as to working interest and royalty).</p> <p>3. If more than one lease of different ownership is dedicated to the well, have the interests of all owners been consolidated by communitization, unitization, force-pooling, etc?</p> <p><input type="checkbox"/> Yes <input type="checkbox"/> No If answer is "yes," type of consolidation _____</p> <p>If answer is "no," list the owners and tract descriptions which have actually been consolidated. (Use reverse side of this form if necessary.) _____</p> <p>No allowable will be assigned to the well until all interests have been consolidated (by communitization, unitization, forced-pooling, or otherwise) or until a non-standard unit, eliminating such interests, has been approved by the Commission.</p>					

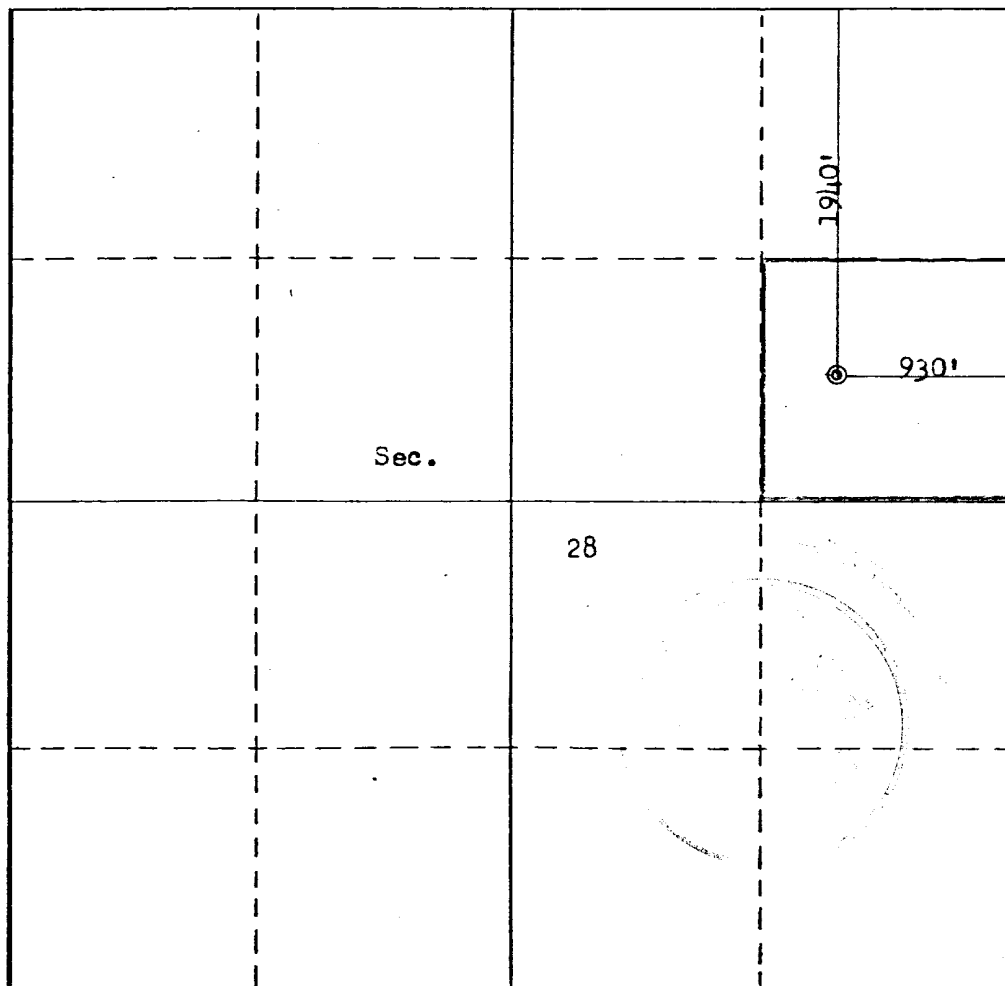

CERTIFICATION

I hereby certify that the information contained herein is true and complete to the best of my knowledge and belief.

H. D. Hollingsworth
Name

H. D. HOLLINGSWORTH
Position

Drilling & Production Foreman
Company

DOME PETROLEUM CORP.

Date
May 1, 1980

I hereby certify that the well location shown on this plat was plotted from field notes of actual surveys made by me or under my supervision, and that the same is true and correct to the best of my knowledge and belief.

Date Surveyed

April 18, 1980
Registered Professional Engineer
and/or Land Surveyor

Fred B. Kerr, Jr.
Certificate No. **3950**

FRED B. KERR, JR.

RIO ARRIBA CO
SANDOVAL CO

Counselor

Brethren
Boarding

Bill Hole

Vicinity Map for
DOME PETROLEUM CORP. #2 DOME-FEDERAL 28-23-6
1940'FNL 930'FEL Sec. 28-T23N-R6W
SANDOVAL COUNTY, NEW MEXICO