

UNITED STATES
DEPARTMENT OF THE INTERIOR
GEOLOGICAL SURVEY

APPLICATION FOR PERMIT TO DRILL, DEEPEN, OR PLUG BACK

| | | | | |
|--|--|--|---|--|
| 1a. TYPE OF WORK DRILL <input checked="" type="checkbox"/> DEEPEN <input type="checkbox"/> PLUG BACK <input type="checkbox"/> | | | 5. LEASE DESIGNATION AND SERIAL NO. N. M. 5019 Jic. 55 | |
| b. TYPE OF WELL OIL WELL <input checked="" type="checkbox"/> GAS WELL <input type="checkbox"/> OTHER <input type="checkbox"/> | | | 6. IS INDIAN, ALLOTTEE OR TRIBE NAME Jicarilla Apache | |
| 2. NAME OF OPERATOR SUPERIOR OIL | | | 7. UNIT AGREEMENT NAME Jicarilla 55 | |
| 3. ADDRESS OF OPERATOR P. O. DRAWER 'G', CORTEZ, COLORADO 81321 | | | 8. FARM OR LEASE NAME Jicarilla 55 | |
| 4. LOCATION OF WELL (Report location clearly and in accordance with any State requirements.)* At surface K 1753' FSL and 1883' FWL of Sec. 35 At proposed prod. zone Same as surface | | | 9. WELL NO. #1 | |
| 14. DISTANCE IN MILES AND DIRECTION FROM NEAREST TOWN OR POST OFFICE* 8.7 miles west of La Jara, New Mexico | | | 10. FIELD AND POOL, OR WILDCAT Chacon Dakota | |
| 15. DISTANCE FROM PROPOSED* LOCATION TO NEAREST PROPERTY OR LEASE LINE, FT. (Also to nearest drlg. unit line, if any) 887' | | | 11. SEC., T., R., M., OR BLK. AND SURVEY OR AREA Sec. 35, T23N, R3W | |
| 16. NO. OF ACRES IN LEASE 320 | | | 12. COUNTY OR PARISH Sandoval | |
| 17. NO. OF ACRES ASSIGNED TO THIS WELL 160, 11 | | | 13. STATE New Mexico | |
| 18. DISTANCE FROM PROPOSED LOCATION* TO NEAREST WELL, DRILLING, COMPLETED, OR APPLIED FOR, ON THIS LEASE, FT. 1350' | | | 20. ROTARY OR CABLE TOOLS Rotary | |
| 21. ELEVATIONS (Show whether DF, RT, GR, etc.) 7230.1' Ungraded Ground Level | | | 22. APPROX. DATE WORK WILL START* September 1, 1980 | |

PROPOSED CASING AND CEMENTING PROGRAM

| SIZE OF HOLE | SIZE OF CASING | WEIGHT PER FOOT | SETTING DEPTH | QUANTITY OF CEMENT |
|--------------|----------------|-----------------|---------------|--------------------|
| 16" | New 13-3/8" | 54.5# K-55 | 50' | 25 sx |
| 12-1/4" | New 9-5/8" | 36# K-55 | 285' | 150 sx |
| 7-7/8" | New 5-1/2" | 15.5# K-55 | 7450' | 1000 sx |

1. Drill 16" hole to 50'. Set 50' of new 13-3/8" 54.5# K-55 casing. Cement to surface with 25 sx.
2. Drill 12-1/4" hole to 285' with fresh water mud system. Set 285' of new 9-5/8" 36# K-55 casing to 285'. Cement to surface with 150 sx. NU BOP.
3. Drill 7-7/8" hole to 7450' with fresh water mud system.
4. Log well. Set 7450' of new 5-1/2" 15.5# K-55 casing and cement with 1000 sx.
5. Perforate Dakota formation and stimulate as necessary.

This action is subject to administrative
appeal pursuant to 30 CFR 290.

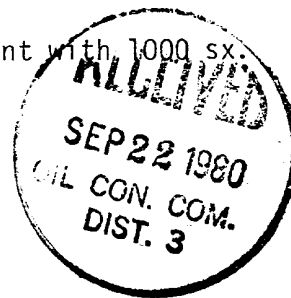

RECEIVED

AUG 12 1980

IN ABOVE SPACE DESCRIBE PROPOSED PROGRAM: If proposal is to deepen or plug back, give data on present productive zone and proposed new productive zone. If proposal is to drill or deepen directionally, give pertinent data on subsurface locations and measured and true vertical depths. Give blowout prevention program, if any.

24. FARMINGTON, N. M.

SIGNED D. B. Bradford TITLE Production Engineer DATE August 12, 1980

(This space for Federal or State office use)

PERMIT NO. _____ APPROVAL DATE _____

APPROVED BY [Signature] TITLE _____ DATE _____

CONDITIONS OF APPROVAL, IF ANY:

NMCC

THE SUPERIOR OIL CO.

OPERATOR

Chacon Dakota No. 1

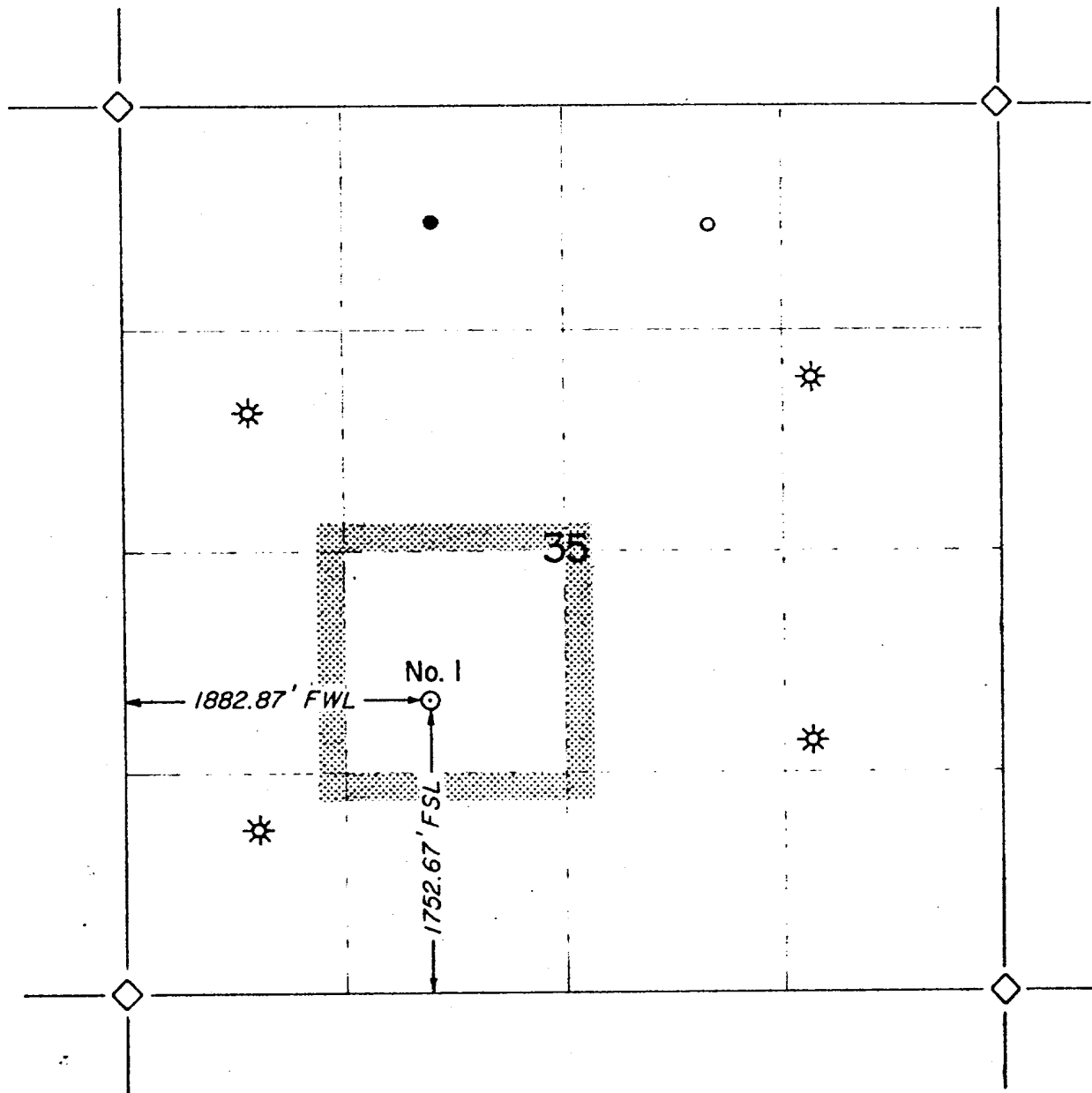

NE/SW SECTION 35, T.23 N. - R. 3 W.



Charles L. Hill



Scale: 1" = 1000'



- ⊙ Location
- Well
- ☼ Injector

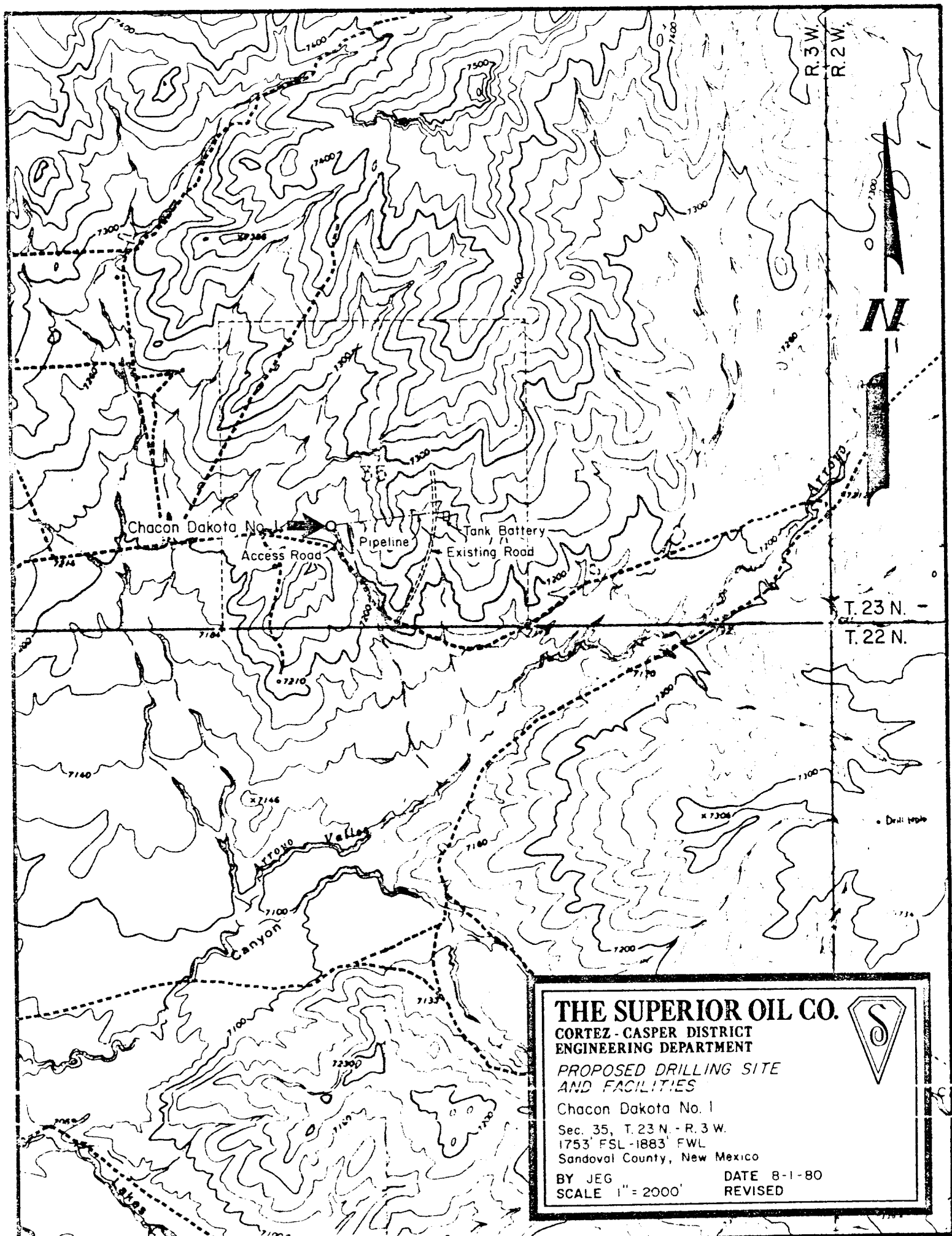

THE SUPERIOR OIL CO.

CORTEZ - CASPER DISTRICT
ENGINEERING DEPARTMENT

PROPOSED DRILLING SITE
AND FACILITIES

Chacon Dakota No. 1

Sec. 35, T. 23 N. - R. 3 W.

1753' FSL - 1883' FWL

Sandoval County, New Mexico

BY JEG

SCALE 1" = 2000'

DATE 8-1-80

REVISED

