

UNITED STATES
DEPARTMENT OF THE INTERIOR
GEOLOGICAL SURVEY

APPLICATION FOR PERMIT TO DRILL, DEEPEN, OR PLUG BACK

1a. TYPE OF WORK

DRILL ☒DEEPEN ☐PLUG BACK ☐

b. TYPE OF WELL

OIL
WELL ☒GAS
WELL ☐

OTHER

SINGLE
ZONE ☒MULTIPLE
ZONE ☐

2. NAME OF OPERATOR

Chace Oil Company, Inc.

3. ADDRESS OF OPERATOR

313 Washington SE Albuquerque, NM 87108

4. LOCATION OF WELL (Report location clearly and in accordance with any State requirements.)

At surface

Unit "C"

1000' NL and 1850'

At proposed prod. zone

14. DISTANCE IN MILES AND DIRECTION FROM NEAREST TOWN OR POST OFFICE

North of Cuba, NM 27 miles

15. DISTANCE FROM PROPOSED*

LOCATION TO NEAREST
PROPERTY OR LEASE LINE, FT.
(Also to nearest drlg. unit line, if any)

3650'

18. DISTANCE FROM PROPOSED LOCATION*

TO NEAREST WELL, DRILLING, COMPLETED,
OR APPLIED FOR, ON THIS LEASE, FT.

19. PROPOSED DEPTH

7500

21. ELEVATIONS (Show whether DF, RT, GR, etc.)

7175 GR

12. COUNTY OR PARISH

Sandoval

13. STATE

NM

17. NO. OF ACRES ASSIGNED

160

20. ROTARY OR CABLE TOOLS

Rotary

22. APPROX. DATE WORK WILL START*

November 1980

23.

PROPOSED CASING AND CEMENTING PROGRAM

SIZE OF HOLE	SIZE OF CASING	WEIGHT PER FOOT	SETTING DEPTH	QUANTITY OF CEMENT
9-3/4"	8-5/8"	24	200	200 sxs

Drill 205' of 9-3/4" surface hole. Set 200' 8-5/8" casing. Cement to surface with 200 sxs using oil base mud (15%) oil and Schaeffer 5000# standard doublegate hydraulic BOP. Drill a 7-7/8" hole to 7500 feet to test the Dakota formation.

3) Wasatch formation on surface

6) Ojo - 1985'; Pictured Cliff - 2690'; Chacra - 2965'; Cliff House - 4150'; Point Lookout - 4740'; Gallup - 5700'; Greenhorn - 6750'; Dakota "A" - 6840'; Burro Canyon - 7130'.

7) 1500-2200' water; 2500-2510 gas; 4150-4210' water; 6830-6860 oil; 6930-6950 gas; 7030-7070 water.

NEW 4-1/2" 10.5# casing to be run to 7100'. Cemented in two stages. 7080 float collar. Second stage 3200' 800 sxs 50-50 posmix and Class "B" cement with 2% calcium chloride, 6 1/2# Gilsonite per sack.

12) Will log with induction and density logs. No cores. 13) No hazards expected.

IN ABOVE SPACE DESCRIBE PROPOSED PROGRAM: If proposal is to deepen or plug back, give data on present productive zone and proposed new productive zone. If proposal is to drill or deepen directionally, give pertinent data on subsurface locations and measured and true vertical depths. Give blowout preventer program, if any.

24.

SIGNED

Raymond G. McCarty

TITLE

President

DATE

8/1/80

(This space for Federal or State office use)

PERMIT NO.

APPROVED
AS AMENDED

APPROVAL DATE

APPROVED BY

TITLE

DATE

CONDITIONS OF APPROVAL, IF ANY:

JAN 29 1981
for *James F. Sims*
DISTRICT ENGINEER

*See Instructions On Reverse Side

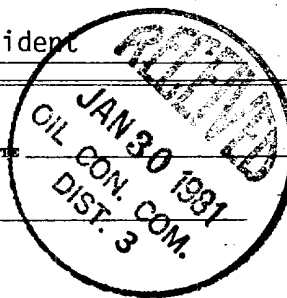

NEW MEXICO OIL CONSERVATION COMMISSION
WELL LOCATION AND ACREAGE DEDICATION PLAT

Form C-102
Supersedes C-128
Effective 1-1-65

All distances must be from the outer boundaries of the Section.

Operator CHACE OIL COMPANY		Lease CHACE APACHE 54		Well No. 54-9
Unit Letter C	Section 3	Township 22 NORTH	Range 3 WEST	County SANDOVAL
Actual Footage Location of Well: 1000 feet from the NORTH line and 1850 feet from the WEST line				
Ground Level Elev. 7175	Producing Formation Dakota	Pool Chace Dakota Ext	Dedicated Acreage: Acres	

1. Outline the acreage dedicated to the subject well by colored pencil or hatchure marks on the plat below.
2. If more than one lease is dedicated to the well, outline each and identify the ownership thereof (both as to working interest and royalty).
3. If more than one lease of different ownership is dedicated to the well, have the interests of all owners been consolidated by communitization, unitization, force-pooling, etc?

☐ Yes ☐ No If answer is "yes," type of consolidation _____

If answer is "no," list the owners and tract descriptions which have actually been consolidated. (Use reverse side of this form if necessary.) _____

No allowable will be assigned to the well until all interests have been consolidated (by communitization, unitization, forced-pooling, or otherwise) or until a non-standard unit, eliminating such interests, has been approved by the Commission.

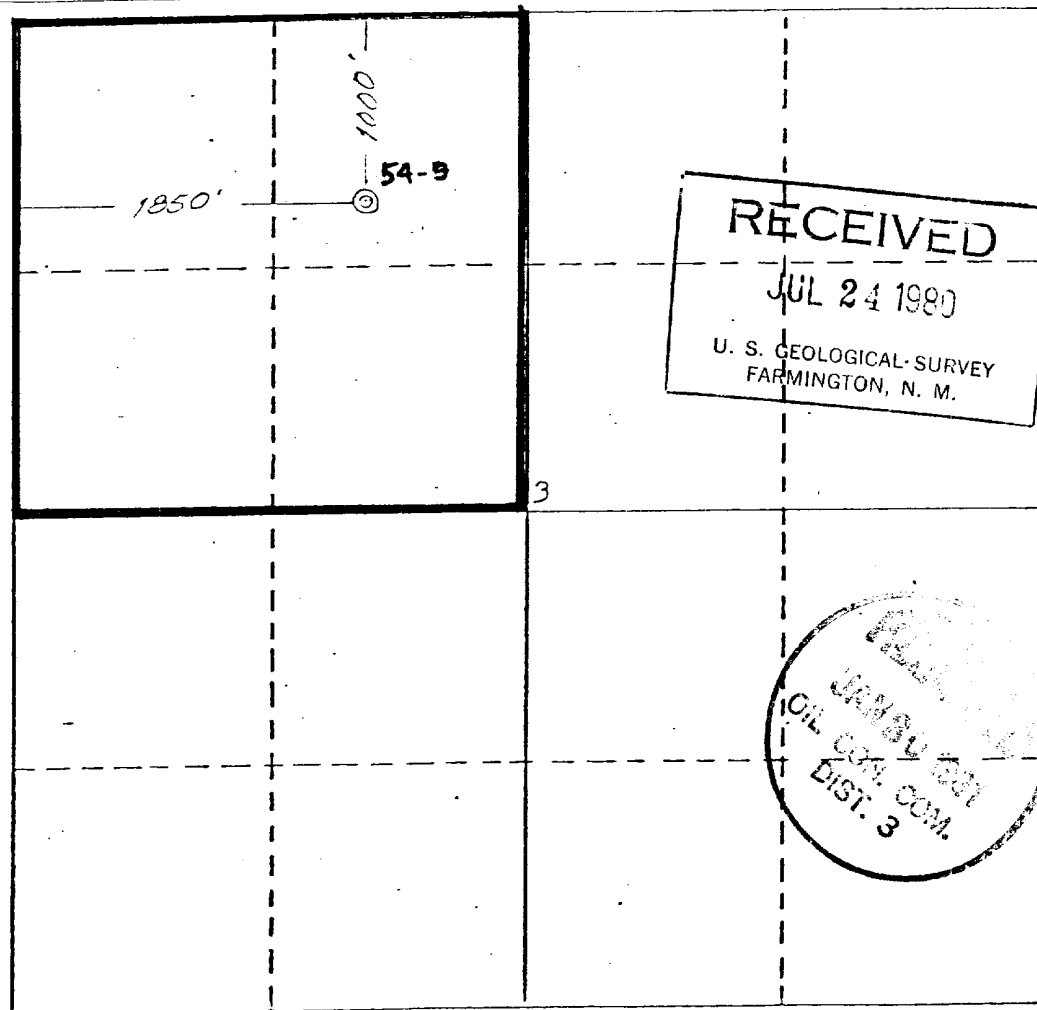

CERTIFICATION

I hereby certify that the information contained herein is true and complete to the best of my knowledge and belief.

Reginald M. Cary
Name _____
President

Position
Chace Oil Company, Inc.

Company
July 18, 1980

Date

I hereby certify that the information shown on this plat was plotted from field notes of actual surveys made by or under my supervision and that the same is true and correct to the best of my knowledge and belief.

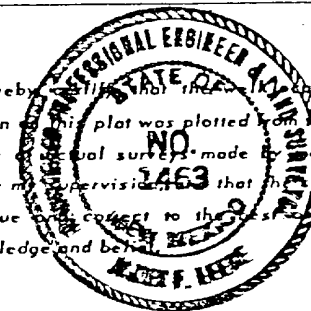

Date Surveyed
July 9, 1980

Registered Professional Engineer and/or Land Surveyor

James P. Leese
James P. Leese

Certificate No.

1463

0 330 660 990 1320 1650 1980 2310 2640 2000 1500 1000 500 0



Chace Oil Company
Chace Apache 54-9
NW $\frac{1}{4}$ Sec 3, T22N, R3W, N.M.P.M.
Sandoval County, New Mexico