

UNITED STATES
DEPARTMENT OF THE INTERIOR
GEOLOGICAL SURVEY

APPLICATION FOR PERMIT TO DRILL, DEEPEN, OR PLUG BACK

1a. TYPE OF WORK

DRILL ☒DEEPEN ☐PLUG BACK ☐

b. TYPE OF WELL

OIL
WELL ☒GAS
WELL ☐

OTHER

SINGLE
ZONE ☒MULTIPLE
ZONE ☐

2. NAME OF OPERATOR

DOME PETROLEUM CORP.

3. ADDRESS OF OPERATOR

501 Airport Drive, Suite 114, Farmington, New Mexico 87401

4. LOCATION OF WELL (Report location clearly and in accordance with any State requirements.)*

At surface

1660' FSL, 1650' FWL

At proposed prod. zone

14. DISTANCE IN MILES AND DIRECTION FROM NEAREST TOWN OR POST OFFICE*

9 miles Southwest of Lybrook Trading Post

15. DISTANCE FROM PROPOSED*

LOCATION TO NEAREST

PROPERTY OR LEASE LINE, FT.

(Also to nearest drlg. unit line, if any)

16. NO. OF ACRES IN LEASE

160

17. NO. OF ACRES ASSIGNED

TO THIS WELL

40

18. DISTANCE FROM PROPOSED LOCATION*

TO NEAREST WELL, DRILLING, COMPLETED,

OR APPLIED FOR, ON THIS LEASE, FT.

19. PROPOSED DEPTH

5000'

20. ROTARY OR CABLE TOOLS

Rotary

21. ELEVATIONS (Show whether DF, RT, GR, etc.)

6857' GR

23.

PROPOSED CASING AND CEMENTING PROGRAM

SIZE OF HOLE	SIZE OF CASING	WEIGHT PER FOOT	SETTING DEPTH	QUANTITY OF CEMENT
12 1/4"	8 5/8"	24#	200'	200 sacks (Circulated)
7 7/8"	4 1/2"	10.5#	5000'	900 sacks (Circulated)

This action is subject to administrative

approval of the Bureau of Land Management.

Move in rotary tools. Drill 12 1/4" hole to 200'. Set 200' new 8 5/8", 24#, K55 Casing. Cement with 200 sxs. Class "B" Cement with 2% CaCl. Wait on cement 12 hours. Install 10" 900 Series BOP. Test to 500 psi. before drilling out from under surface pipe. Check pipe rams daily & blind rams on trips. Drill 7 7/8" hole to T.D. The geological name of the surface formation is Nacimiento. Oil is expected in the Gallup and gas is expected in the Chacra. All other formations are probably water bearing. Pertinent formation tops are estimated as Pictured Cliff 1051'; Chacra 1413'; Cliffhouse 1784'; Point Lookout 3429'; Mancos 3623'; and Gallup 4520'. Mud will be low solids non-dispersed. Mud weight 8.8-9.2#/Gal., FL 8-10cc, and viscosity 30-60 sec./quart. No abnormal temperatures or pressures are anticipated. Logging program will be DIL, FDC/CNL with Gamma Ray/Caliper. If productive 4 1/2", 10.5#, K55 Casing will be run and cemented with 700 sxs. 65/35 Pozmix, 6% Gel, and 10# Gilsonite/sx. Followed with 200 sxs. Class "B" Cement with 10% salt. Drilling should require approximately 10 days.

DRILLING OPERATIONS AUTHORIZED ARE

SHOWN ON THE MAPS WITH ATTACHED

IN ABOVE SPACE DESCRIBE PROPOSED PROGRAM: If proposal is to deepen or plug back, give data on present productive zone and proposed new productive zone. If proposal is to drill or deepen directionally, give pertinent data on subsurface locations and measured and true vertical depths. Give blowout preventer program, if any.

24.

SIGNED

H. D. HOLINGSWORTH

TITLE Drlg. & Production Foreman

DATE November 17, 1980

(This space for Federal or State office use)

PERMIT NO.

APPROVAL DATE

APPROVED BY

CONDITIONS OF APPROVAL, IF ANY:

TITLE

DATE

30-043-20544

5. LEASE DESIGNATION AND SERIAL NO.

NOO-C-14-20-5355

6. IF INDIAN, ALLOTTEE OR TRIBE NAME

Navajo Allotted

7. UNIT AGREEMENT NAME

8. FARM OR LEASE NAME

Dome Tesoro 22

9. WELL NO.

#2

10. FIELD AND POOL, OR WILDCAT

Undesignated Gallup

11. SEC., T., R., M., OR BLK.
AND SURVEY OR AREA

Sec. 22-T22N-R7W

12. COUNTY OR PARISH

13. STATE

Sandoval

New Mexico

17. NO. OF ACRES ASSIGNED

TO THIS WELL

40

20. ROTARY OR CABLE TOOLS

Rotary

22. APPROXIMATE TIME TO START*

12/01/80

OIL CON. 6 1981

QUANTITY OF CEMENT
(Circulated)

All distances must be from the outer boundaries of the Section.

Operator DOMESTIC PETROLEUM CORPORATION			Lease DOMESTIC-TESORO 22		Well No. 2
Unit Letter K	Section 22	Township 22N	Range 7W	County Sandoval	
Actual Footage Location of Well: 1660 feet from the South line and 1650 feet from the West line					
Ground Level Elev. 6857	Producing Formation Gallup		Pool Undesignated Gallup		Dedicated Acreage 40 Acres

1. Outline the acreage dedicated to the subject well by colored pencil or hatchure marks on the plat below.

2. If more than one lease is dedicated to the well, outline each and identify the ownership thereof (both as to working interest and royalty).

3. If more than one lease of different ownership is dedicated to the well, have the interests of all owners been consolidated by communitization, unitization, force-pooling, etc?

☐ Yes ☐ No If answer is "yes," type of consolidation _____

If answer is "no," list the owners and tract descriptions which have actually been consolidated. (Use reverse side of this form if necessary.) _____

No allowable will be assigned to the well until all interests have been consolidated (by communitization, unitization, forced-pooling, or otherwise) or until a non-standard unit, eliminating such interests, has been approved by the Commission.

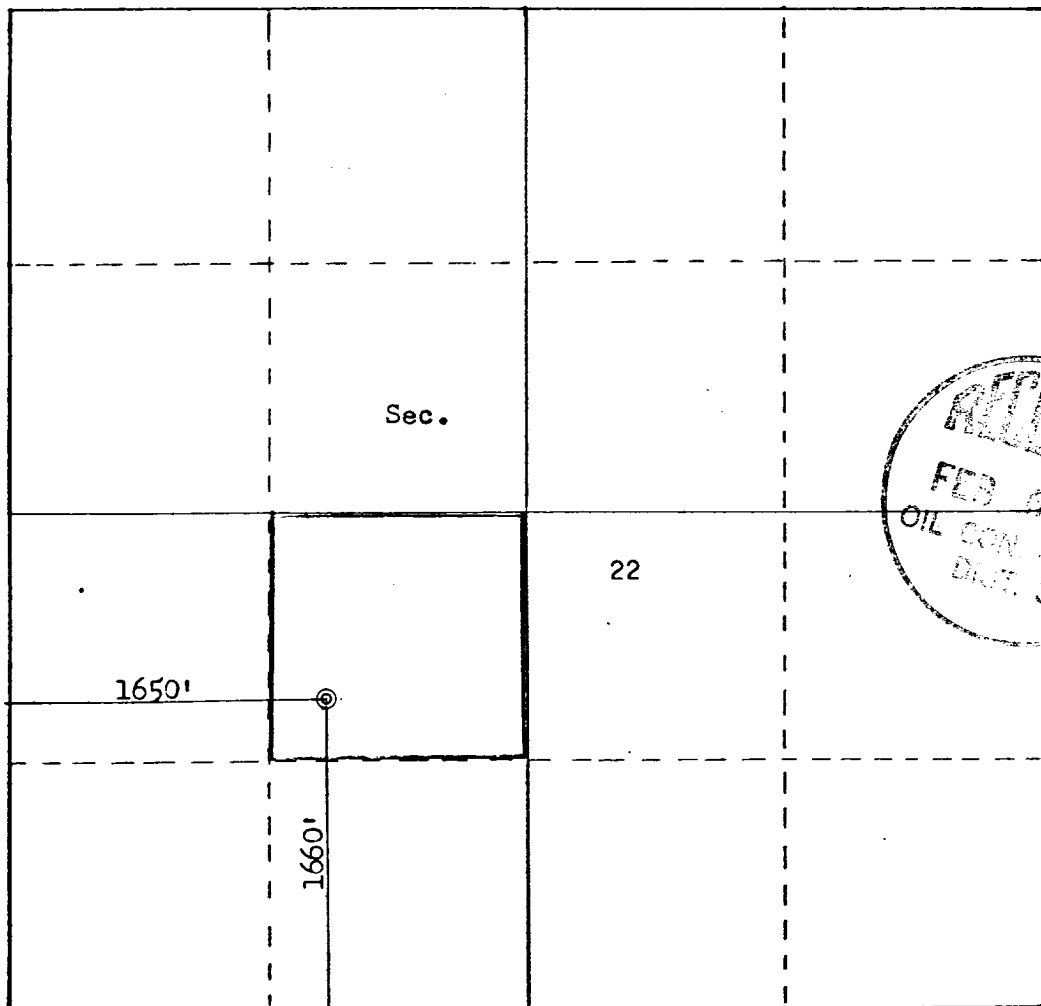

Scale: 1"=1000'

CERTIFICATION	
I hereby certify that the information contained herein is true and complete to the best of my knowledge and belief.	
Name H. D. HOLLINGSWORTH	
Position Drlg. & Production Foreman	
Company DOMESTIC PETROLEUM CORP.	
Date November 17, 1980	
I hereby certify that the well location shown on this plat was plotted from field notes of actual surveys made by me or under my supervision, and that the same is true and correct to the best of my knowledge and belief.	
Date Surveyed NOVEMBER 17, 1980	
Registered Professional Engineer and Land Surveyor Fred B. KERR, JR.	
Certificate No. 3950	