

UNITED STATES
DEPARTMENT OF THE INTERIOR
GEOLOGICAL SURVEY

30-043-20559

5. LEASE DESIGNATION AND SERIAL

Contract No. 55-A

6. IF INDIAN, ALLOTTEE OR TRIBE NAME

Jicarilla Apache

7. UNIT AGREEMENT NAME

8. FARM OR LEASE NAME

Indian Bend

9. WELL NO.

7

10. FIELD AND POOL, OR WILDCAT

Ballard Pictured Cliffs

11. SEC., T., R., M., OR BLK.

Sec. 25 - T23N-R3W
N.M.P.M.

12. COUNTY OR PARISH

Sandoval

13. STATE

N.M.

APPLICATION FOR PERMIT TO DRILL, DEEPEN, OR PLUG BACK

12. TYPE OF WORK

DRILL ☒DEEPEN ☐PLUG BACK ☐

b. TYPE OF WELL

OIL
WELL ☐GAS
WELL ☒

OTHER

SINGLE
ZONE ☒MULTIPLE
ZONE ☐

2. NAME OF OPERATOR

JACK A. COLE

3. ADDRESS OF OPERATOR

P. O. Box 191 Farmington, New Mexico 87401

4. LOCATION OF WELL (Report location clearly and in accordance with any State requirements.)

At surface

1520' FSL 1620' FEL

At proposed prod. zone Same

14. DISTANCE IN MILES AND DIRECTION FROM NEAREST TOWN OR POST OFFICE*

32 miles Northwest of Cuba, N.M.

15. DISTANCE FROM PROPOSED*

LOCATION TO NEAREST
PROPERTY OR LEASE LINE, FT.
(Also to nearest drig. unit line, if any)

1620'

16. NO. OF ACRES IN LEASE

2240.91

17. NO. OF ACRES ASSIGNED

TO THIS WELL 160

18. DISTANCE FROM PROPOSED LOCATION*
TO NEAREST WELL, DRILLING, COMPLETED,
OR APPLIED FOR, ON THIS LEASE, FT.

2000'

19. PROPOSED DEPTH

3130'

20. ROTARY OR CABLE TOOLS

Rotary

21. ELEVATIONS (Show whether DF, RT, GR, etc.)

7295' GL

DRILLING OPERATIONS AUTHORIZED ARE
SUBJECT TO COMPLIANCE WITH ATTACHED

22. APPROX. DATE WORK WILL START*

5/15/81

23. PROPOSED CASING REQUIREMENTS PROGRAM This action is subject to administrative
appeal pursuant to 30 CFR 290.

SIZE OF HOLE	SIZE OF CASING	WEIGHT PER FOOT	SETTING DEPTH	QUANTITY OF CEMENT
12-1/4"	8-5/8"	24.0	85'	100 sacks
7-7/8"	4-1/2"	10.50	3130'	150 sacks

All producing intervals in Pictured Cliffs Formation will be perforated and stimulated as necessary.

EXHIBITS

"A" Location & Elevation Plat	"E" Access Road to Location
"B" Ten Point Compliance Program	"F" Radius Map of Field
"C" Blowout Preventer Diagram	"G" Drill Rig Layout
"D" Multi-Point Requirements for APD	"H" Fracturing Program Layout
	"I" Location Profile

The gas from this well is committed.

The SE/4, Section 25 is dedicated to this well.

IN ABOVE SPACE DESCRIBE PROPOSED PROGRAM: If proposal is to deepen or plug back, give data on present productive zone and proposed new productive zone. If proposal is to drill or deepen directionally, give pertinent data on subsurface locations and measured and true vertical depths. Give blowout preventer program, if any.

24. FOR: JACK A. COLE

President, Walsh Engr.

SIGNED

ORIGINAL SIGNED BY
EWELL N. WALSH
Ewell N. Walsh, P.E.

TITLE

& Production Corp.

DATE

3-24-81

(This space for Federal or State office use)

PERMIT NO.

APPROVAL DATE

APPROVED BY

TITLE

CONDITIONS OF APPROVAL, IF ANY:

APPROVED
AS AMENDED

DATE

APR 17 1981
James F. Sims
JAMES F. SIMS
DISTRICT ENGINEER

*See Instructions On Reverse Side

All distances must be from the outer boundaries of the Section.

Operator: JACK A. COLE		Lease: INDIAN BEND		Well No.: 7
Unit Letter: J	Section: 25	Township: 23N	Range: 3W	County: Sandoval
Actual Footage Location of Well: 1520 feet from the South line and 1620 feet from the East line				
Ground Level Elev.: 7295	Producing Formation: Pictured Cliffs	Pool: Ballard Pictured Cliffs	Dedicated Acreage: 160 Acres	

1. Outline the acreage dedicated to the subject well by colored pencil or hachure marks on the plat below.
2. If more than one lease is dedicated to the well, outline each and identify the ownership thereof (both as to working interest and royalty).
3. If more than one lease of different ownership is dedicated to the well, have the interests of all owners been consolidated by communitization, unitization, force-pooling, etc?

☐ Yes ☐ No If answer is "yes," type of consolidation _____

If answer is "no," list the owners and tract descriptions which have actually been consolidated. (Use reverse side of this form if necessary.) _____

No allowable will be assigned to the well until all interests have been consolidated (by communitization, unitization, forced-pooling, or otherwise) or until a non-standard unit, eliminating such interests, has been approved by the Commission.

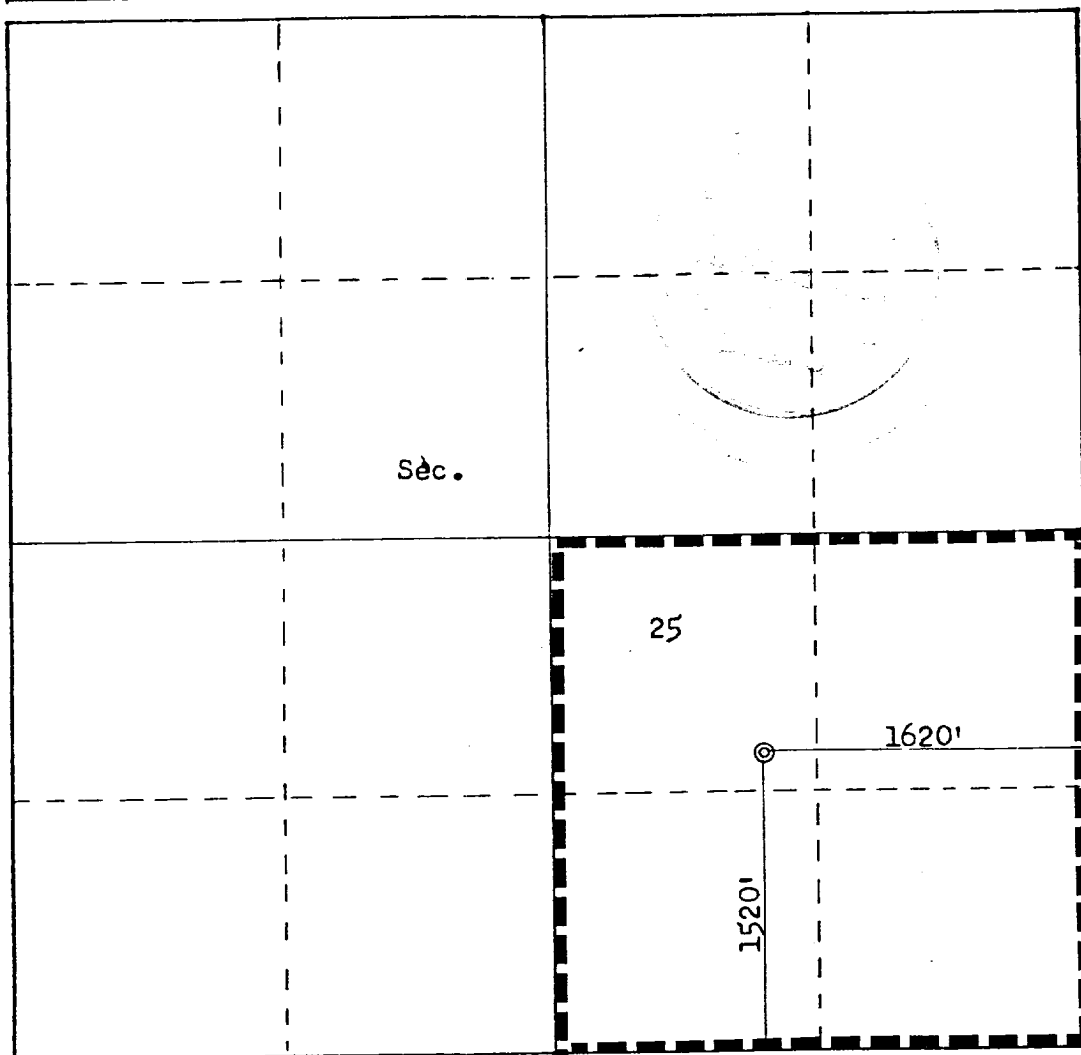

Scale: 1"=1000'

CERTIFICATION

I hereby certify that the information contained herein is true and complete to the best of my knowledge and belief.

FOR: JACK A. COLE
ORIGINAL SIGNED BY

Name **EWELL N. WALSH**
Ewell N. Walsh, P.E.

Position
President

Company
Walsh Engineering & Production Corporation

Date
March 23, 1981

I hereby certify that the well location shown on this plat was plotted from field notes of actual surveys made by me or under my supervision, and that the same is true and correct to the best of my knowledge and belief.

Date Surveyed

March 16, 1981

Registered Professional Engineer and Land Surveyor

Fred B. Kerr Jr.

Certificate No.

3950

