

UNITED STATES  
DEPARTMENT OF THE INTERIOR  
GEOLOGICAL SURVEY

## APPLICATION FOR PERMIT TO DRILL, DEEPEN, OR PLUG BACK

30-043-20563  
5. LEASE DESIGNATION AND SERIAL NO.  
Contract No. 55-A  
6. IF INDIAN, ALLOTTEE OR TRIBE NAME  
Jicarilla Apache  
7. UNIT AGREEMENT NAME  
8. FARM OR LEASE NAME  
Indian Bend  
9. WELL NO.  
8  
10. FIELD AND POOL, OR WILDCAT  
Ballard Pictured Cl  
11. SEC., T., R., M., OR BLK.  
AND SURVEY OR AREA  
Sec. 36-123N-R3W  
N.M.P.M.  
12. COUNTY OR PARISH  
Sandoval  
13. STATE  
N.M.1a. TYPE OF WORK  
DRILL ☒ DEEPEN ☐ PLUG BACK ☐b. TYPE OF WELL  
OIL WELL ☐ GAS WELL ☒ OTHER ☐ SINGLE ZONE ☒ MULTIPLE ZONE ☐

2. NAME OF OPERATOR

JACK A. COLE

3. ADDRESS OF OPERATOR

P. O. Box 191 Farmington, New Mexico 87401

4. LOCATION OF WELL (Report location clearly and in accordance with any State requirements.)  
At surfaceA 810'FNL 820'FEL  
At proposed prod. zone Same

14. DISTANCE IN MILES AND DIRECTION FROM NEAREST TOWN OR POST OFFICE\*

32 miles Northwest of Cuba, N.M.

15. DISTANCE FROM PROPOSED\*

LOCATION TO NEAREST  
PROPERTY OR LEASE LINE, FT.  
(Also to nearest drilg. unit line, if any)

820'

16. NO. OF ACRES IN LEASE

2240.91

17. NO. OF ACRES ASSIGNED

TO THIS WELL

160

18. DISTANCE FROM PROPOSED LOCATION\*  
TO NEAREST WELL, DRILLING, COMPLETED,  
OR APPLIED FOR, ON THIS LEASE, FT.

2300'

19. PROPOSED DEPTH

3130'

20. ROTARY OR CABLE TOOLS

Rotary

21. ELEVATIONS (Show whether DF, RT, GR, etc.)

7269'GL

22. APPROX. DATE WORK WILL START\*

5/15/81

23.

## PROPOSED CASING AND CEMENTING PROGRAM

SIZE OF HOLE	SIZE OF CASING	WEIGHT PER FOOT	SETTING DEPTH	QUANTITY OF CEMENT
12-1/4"	8-5/8"	24.0	85'	100 sacks
7-7/8"	4-1/2"	10.50	3130'	150 sacks

All producing intervals in Pictured Cliffs Formation will be perforated and stimulated as necessary.

## EXHIBITS

"A" Location & Elevation Plat	"E" Access Road to Location
"B" Ten Point Compliance Program	"F" Radius Map of Field
"C" Blowout Preventer Diagram	"G" Drill Rig Layout
"D" Multi-Point Requirements for APD	"H" Fracturing Program Layout
	"I" Location Profile

The gas from this well is committed.

The NE 1/4, Section 36 is dedicated to this well.

IN ABOVE SPACE DESCRIBE PROPOSED PROGRAM: If proposal is to deepen or plug back, give data on present productive zone and proposed new productive zone. If proposal is to drill or deepen directionally, give pertinent data on subsurface locations and measured and true vertical depths. Give blowout preventer program, if any.

24. FOR: JACK A. COLE  
ORIGINAL SIGNED BY

SIGNED

Ewell N. Walsh, P.E.

TITLE

President, Walsh Engr.  
& Production Corp.

DATE

3-24-81

(This space for Federal or State office use)

PERMIT NO.

APPROVAL DATE

APPROVED BY

TITLE

CONDITIONS OF APPROVAL, IF ANY:

\*See Instructions On Reverse Side

NM000

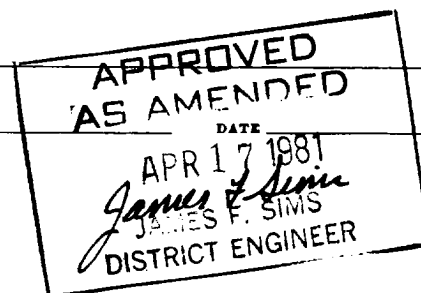

All distances must be from the outer boundaries of the Section.

Operator <b>JACK A. COLE</b>			Lease <b>INDIAN BEND</b>		Well No. <b>8</b>
Unit Letter <b>A</b>	Section <b>36</b>	Township <b>23N</b>	Range <b>3W</b>	County <b>Sandoval</b>	
Actual Footage Location of Well: <b>810</b> feet from the <b>North</b> line and <b>820</b> feet from the <b>East</b> line					
Ground Level Elev. <b>7269</b>	Producing Formation <b>Pictured Cliffs</b>		Pool <b>Ballard Pictured Cliffs</b>		Dedicated Acreage: <b>160</b> Acres

1. Outline the acreage dedicated to the subject well by colored pencil or hatchure marks on the plat below.
2. If more than one lease is dedicated to the well, outline each and identify the ownership thereof (both as to working interest and royalty).
3. If more than one lease of different ownership is dedicated to the well, have the interests of all owners been consolidated by communitization, unitization, force-pooling, etc?

☐ Yes ☐ No If answer is "yes," type of consolidation \_\_\_\_\_

If answer is "no," list the owners and tract descriptions which have actually been consolidated. (Use reverse side of this form if necessary.) \_\_\_\_\_

No allowable will be assigned to the well until all interests have been consolidated (by communitization, unitization, forced-pooling, or otherwise) or until a non-standard unit, eliminating such interests, has been approved by the Commission.

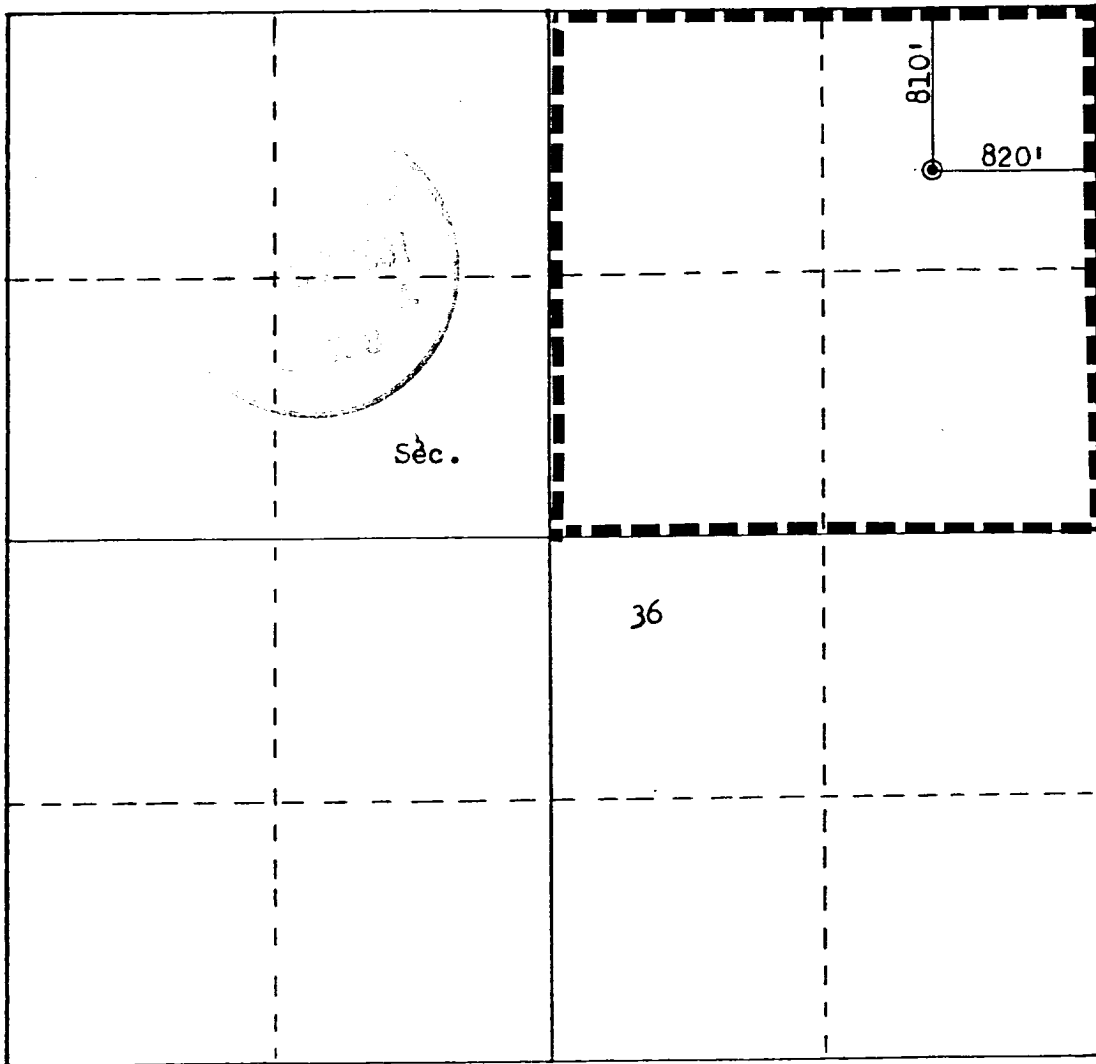

Scale: 1"=1000'

CERTIFICATION

I hereby certify that the information contained herein is true and complete to the best of my knowledge and belief.

FOR: **JACK A. COLE**

**ORIGINAL SIGNED BY**

Name **EWELL N. WALSH**  
Ewell N. Walsh, P.E.

Position  
President

Company  
Walsh Engineering & Production Corporation

Date  
March 23, 1981

I hereby certify that the well location shown on this plat was plotted from field notes of actual surveys made by me or under my supervision, and that the same is true and correct to the best of my knowledge and belief.

Date Surveyed  
March 26, 1981  
Registered Professional Engineer and Land Surveyor  
**Fred B. Kerr Jr.**  
Certificate No. 3950

7 MI FROM  
DULCE ROAD

AMERADA

AMERADA

R3W

R4W

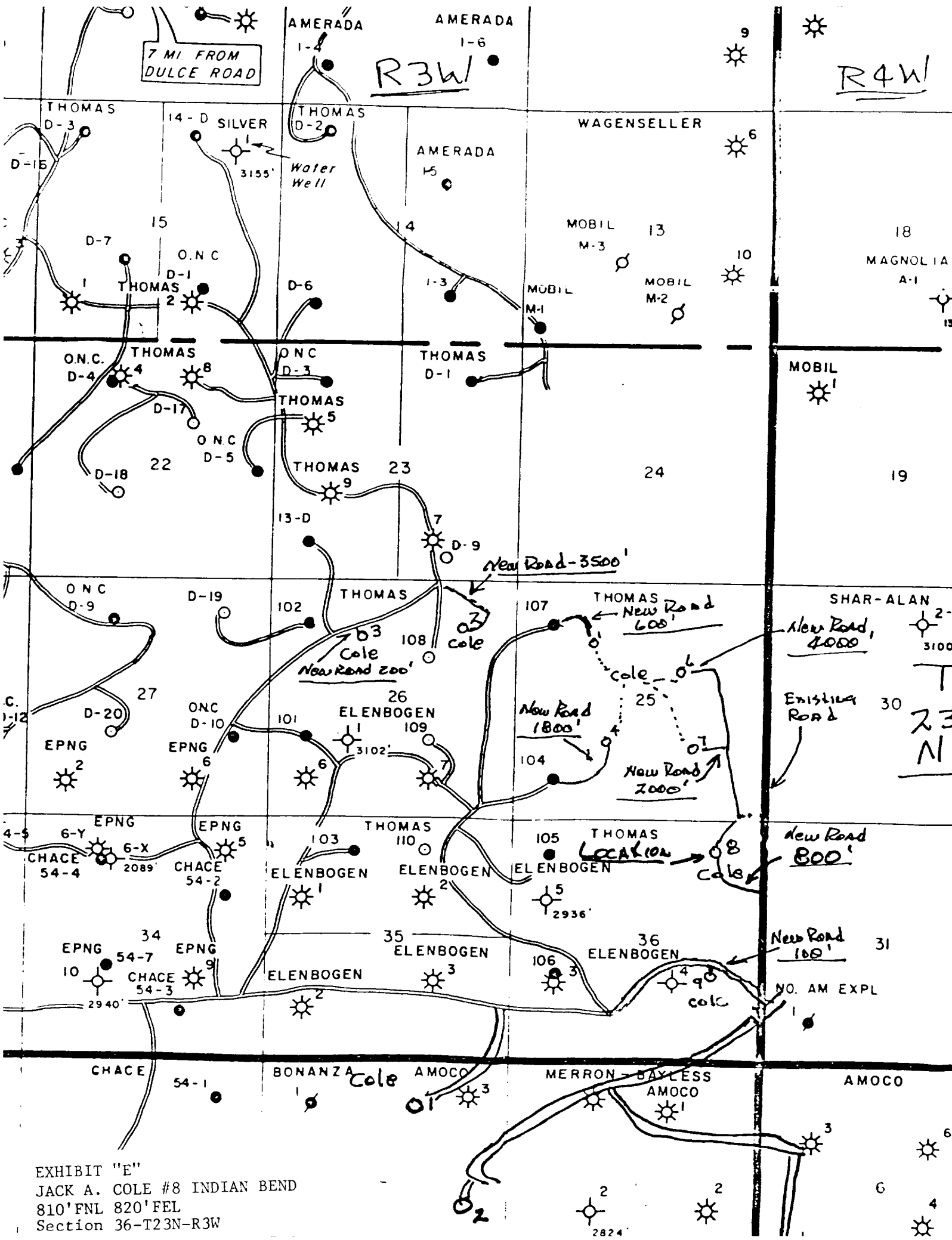

EXHIBIT "E"

JACK A. COLE #8 INDIAN BEND

810'FNL 820'FEL

Section 36-T23N-R3W