

UNITED STATES  
DEPARTMENT OF THE INTERIOR  
GEOLOGICAL SURVEY30-043-20574  
5. LEASE DESIGNATION AND SERIAL NO.  
NM 13781

## APPLICATION FOR PERMIT TO DRILL, DEEPEN, OR PLUG BACK

1a. TYPE OF WORK

DRILL ☒DEEPEN ☐PLUG BACK ☐

b. TYPE OF WELL

OIL  
WELL ☒GAS  
WELL ☐OTHER ☐SINGLE  
ZONE ☐MULTIPLE  
ZONE ☒

2. NAME OF OPERATOR

T.L. MORRIS

3. ADDRESS OF OPERATOR

\*\*\* P.O. Box 1038 Kilgore TX

4. LOCATION OF WELL (Report location clearly and in accordance  
with any State requirements.)

At surface 2310 FSL 2210x 330 FEL

At proposed prod. zone

14. DISTANCE IN MILES AND DIRECTION FROM NEAREST TOWN OR POST OFFICE\*

Three miles West of the Village of San Luis

15. DISTANCE FROM PROPOSED\*

LOCATION TO NEAREST  
PROPERTY OR LEASE LINE, FT.  
(Also to nearest drilg. unit line, if any)

330'

16. NO. OF ACRES IN LEASE

2360

18. DISTANCE FROM PROPOSED LOCATION\*

TO NEAREST WELL, DRILLING, COMPLETED,  
OR APPLIED FOR, ON THIS LEASE, FT.

19. PROPOSED DEPTH

400'

21. ELEVATIONS (Show whether DF, RT, GR, etc.)

DRILLING OPERATIONS AUTHORIZED ARE 6445' GR

23. SUBJECT TO COMPLIANCE WITH ATTACHED PROPOSED CASING AND CEMENTING PROGRAM

"GENERAL REQUIREMENTS"

SIZE OF HOLE	SIZE OF CASING	WEIGHT PER FOOT	SETTING DEPTH
10 1/4	8 5/8 Surface	20# New	40'

15 sx common to 300' or

If production is indicated, we propose setting 4.5" 10.5# new casing to TD and circulate regular cement to surface with 60 sx.

This borehole is intended to test the oil shows encountered in the Hosta Sand in the Shell and Candy Butte wells a mile to the Northeast. The Hosta lies about 300' below the Mesaverde Point Lookout Sand.

The test will start in the Point Lookout and should reach the top of the Hosta at about 350 feet.

Well control will be accomplished by full opening globe valve with oil saver.

An electric log will be run.

IN ABOVE SPACE DESCRIBE PROPOSED PROGRAM: If proposal is to deepen or plug back, give data on present productive zone and proposed new productive zone. If proposal is to drill or deepen directionally, give pertinent data on subsurface locations and measured and true vertical depths. 1981 blowout preventer program, if any.

24.

SIGNED

Thomas D. Chase

TITLE Agent

(This space for Federal or State office use)

PERMIT NO.

APPROVAL DATE

APPROVED BY

CONDITIONS OF APPROVAL, IF ANY:

TITLE

APPROVED  
AS AMENDED

DATE

MAY 28 1981

Dean Elliott  
FOR JAMES F. SIMS  
DISTRICT ENGINEER

This action is subject to administrative  
appeal pursuant to 30 CFR 250.206

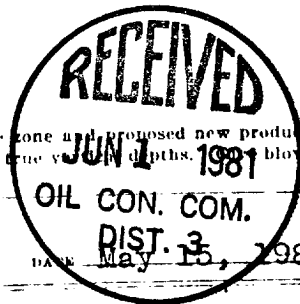

NEW MEXICO OIL CONSERVATION COMMISSION  
WELL LOCATION AND ACREAGE DEDICATION PLAT

Form C-102  
Supersedes C-128  
Effective 1-1-65

All distances must be from the outer boundaries of the Section.

Owner T.L.Morris		Lease N.M. 13781		Well No. Betty #1	
Section Letter I	Section 35	Township 17 North	Range 3 West	County Sandoval	
Actual Footage Location of Well: 2310 feet from the South line and 330 feet from the East line					
Ground Level Elev. 6445	Producing Formation		Pool	Dedicated Acreage: 40 Acres	

1. Outline the acreage dedicated to the subject well by colored pencil or hachure marks on the plat below.
2. If more than one lease is dedicated to the well, outline each and identify the ownership thereof (both as to working interest and royalty).
3. If more than one lease of different ownership is dedicated to the well, have the interests of all owners been consolidated by communitization, unitization, force-pooling, etc?

☐ Yes ☐ No If answer is "yes," type of consolidation \_\_\_\_\_

If answer is "no," list the owners and tract descriptions which have actually been consolidated. (Use reverse side of this form if necessary.) \_\_\_\_\_

No allowable will be assigned to the well until all interests have been consolidated (by communitization, unitization, forced-pooling, or otherwise) or until a non-standard unit, eliminating such interests, has been approved by the Commission.

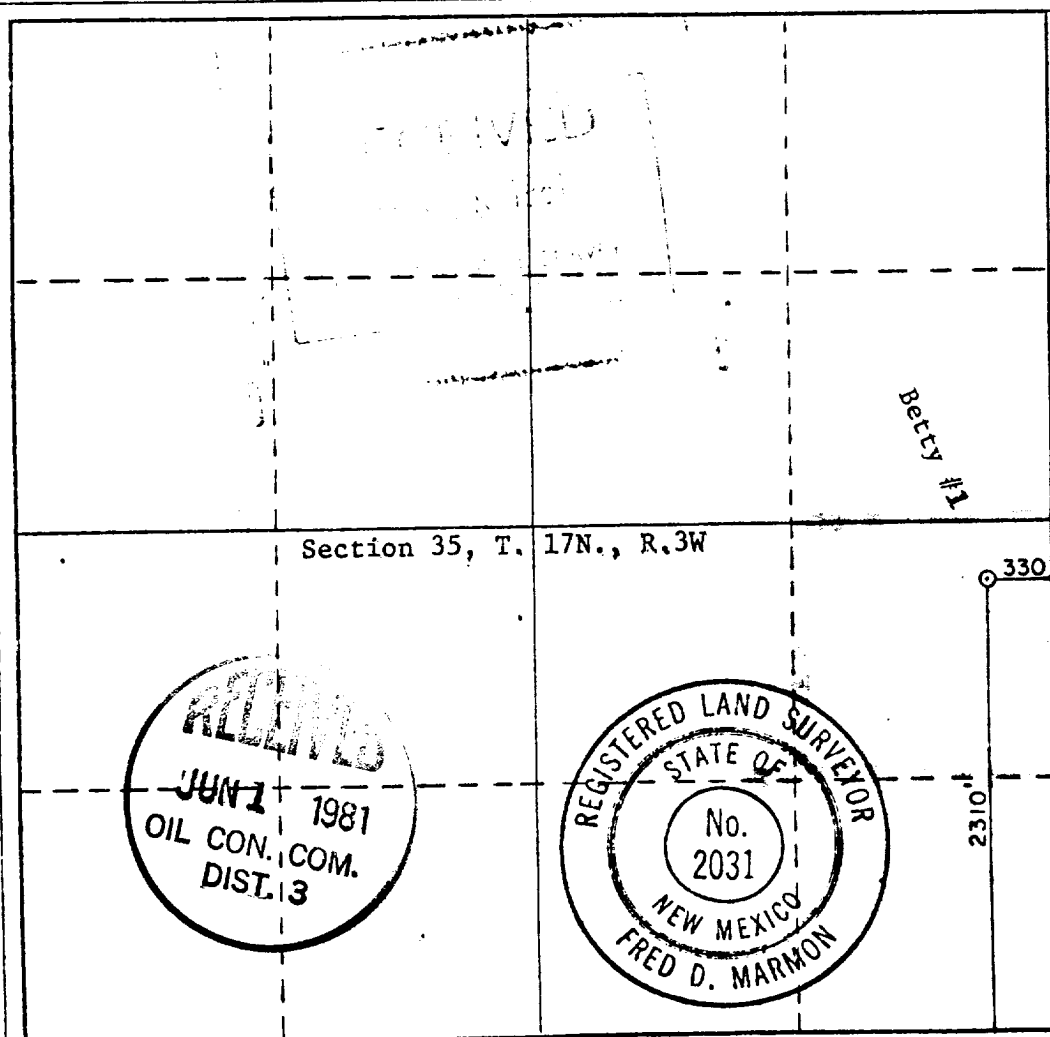

CERTIFICATION

I hereby certify that the information contained herein is true and complete to the best of my knowledge and belief.

*Thomas D. Chace*

Name  
Thomas D. Chace

Position  
Agent

Company  
T.L.Morris

Date  
May 15, 1981

I hereby certify that the well location shown on this plat was plotted from field notes of actual surveys made by me or under my supervision, and that the same is true and correct to the best of my knowledge and belief.

Date Surveyed  
May 8, 1981

Registered Professional Engineer  
and/or Land Surveyor

*Fred D. Marmon*

Certificate No.  
2031

330 2640 2000 1500 1000 500 0