

UNITED STATES
DEPARTMENT OF THE INTERIOR
GEOLOGICAL SURVEY

30-043-20595
5. LEASE DESIGNATION AND SERIAL NO.
NM-37548
6. IF INDIAN, ALLOTTEE OR TRIBE NAME
7. UNIT AGREEMENT NAME
8. FARM OR LEASE NAME
Lewis 1-20-3
9. WELL NO.
10. FIELD AND POOL, OR WILDCAT
Wildcat
11. SEC., T., R., M., OR BLK.
AND SURVEY OR AREA
Section 1-T20N-R3W
12. COUNTY OR PARISH
Sandoval
13. STATE
New Mexico

APPLICATION FOR PERMIT TO DRILL, DEEPEN, OR PLUG BACK

1a. TYPE OF WORK
DRILL ☒ DEEPEN ☐ PLUG BACK ☐
b. TYPE OF WELL
OIL WELL ☒ GAS WELL ☐ OTHER ☐
SINGLE ZONE ☒ MULTIPLE ZONE ☐
2. NAME OF OPERATOR
Lewis Energy Corporation
3. ADDRESS OF OPERATOR
232 North Schwartz, Farmington, New Mexico 87401
4. LOCATION OF WELL (Report location clearly and in accordance with any State requirements.)
At surface
1650' FSL, 1650 FWL; Section 1, T20N-R3W
At proposed prod. zone

14. DISTANCE IN MILES AND DIRECTION FROM NEAREST TOWN OR POST OFFICE*
15. DISTANCE FROM PROPOSED*
LOCATION TO NEAREST
PROPERTY OR LEASE LINE, FT.
(Also to nearest drlg. unit line, if any)
16. NO. OF ACRES IN LEASE
1646.54
17. NO. OF ACRES ASSIGNED
TO THIS WELL
40
18. DISTANCE FROM PROPOSED LOCATION*
TO NEAREST WELL, DRILLING, COMPLETED,
OR APPLIED FOR, ON THIS LEASE, FT.
4,900'
19. PROPOSED DEPTH
4,900'
20. ROTARY OR CABLE TOOLS
Rotary

21. ELEVATIONS (Show whether DF, RT, GR, etc.)
Estimated K.B. Elevation: +6990
22. APPROX. DATE WORK WILL START*
October 1, 1981

23. PROPOSED CASING AND CEMENTING PROGRAM

SIZE OF HOLE	SIZE OF CASING	WEIGHT PER FOOT	SETTING DEPTH	QUANTITY OF CEMENT
14 3/4	9 5/8	36	400'	To surface
8 3/4	7	23	4300	To surface
6 1/2	4 1/2	10.5	Liner to T.D.	Per caliper

INSTRUCTIONS CONCERNING PERMITS ARE
SUPPLIED TO ALL APPLICANTS WITH ATTACHED
"GENERAL INFORMATION" SHEET.
Note Gen. Regs 413/15C

This action is subject to administrative
appeal pursuant to 30 CFR 250.109.



IN ABOVE SPACE DESCRIBE PROPOSED PROGRAM: If proposal is to deepen or plug back, give data on present productive zone and proposed new productive zone. If proposal is to drill or deepen directionally, give pertinent data on subsurface locations and measured and true vertical depths. Give blowout preventer program, if any.

24. SIGNED OB Lubb TITLE Operations Manager DATE August 3, 1981
San Juan Basin

(This space for Federal or State office use)

PERMIT NO. _____ APPROVAL DATE _____
APPROVED BY _____ TITLE _____
CONDITIONS OF APPROVAL, IF ANY:
DATE SEP 28 1981
(Orig. Sig.) RAYMOND W. VINYARD
DISTRICT ENGINEER

Operator Lewis Energy Corporation		Lease NM-37548		Well No. 1	
Unit Letter	Section 1	Township 20N	Range 3W	County Sandoval	
Actual Footage Location of Well: 1650' feet from the South line and 1650' feet from the West line					
Ground Level Elev. 6964.5	Producing Formation Mancos Shale		Pool Wildcat		Dedicated Acreage: Acre:

1. Outline the acreage dedicated to the subject well by colored pencil or hachure marks on the plat below.
2. If more than one lease is dedicated to the well, outline each and identify the ownership thereof (both as to working interest and royalty).
3. If more than one lease of different ownership is dedicated to the well, have the interests of all owners been consolidated by communitization, unitization, force-pooling, etc?

☐ Yes ☐ No If answer is "yes," type of consolidation _____

If answer is "no," list the owners and tract descriptions which have actually been consolidated. (Use reverse side of this form if necessary.) _____

No allowable will be assigned to the well until all interests have been consolidated (by communitization, unitization, forced-pooling, or otherwise) or until a non-standard unit, eliminating such interests, has been approved by the Division

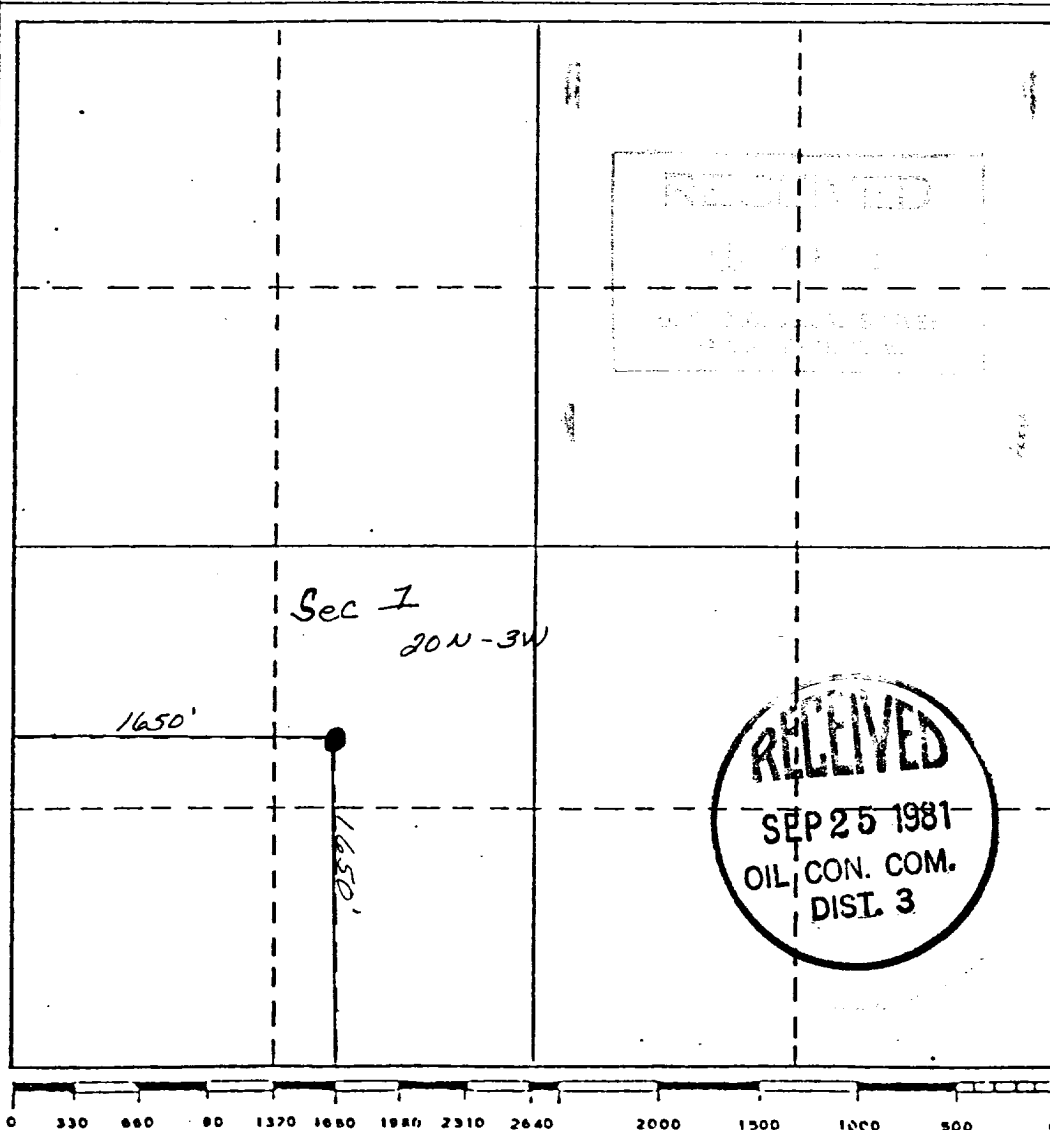

CERTIFICATION

I hereby certify that the information contained herein is true and complete to the best of my knowledge and belief.

Name

Carrol B. Tubbs

Position

Operations Manager

Company

Lewis Energy Corporation

Date

July 28, 1981

I hereby certify that the well location shown on this plat was plotted from field notes of actual surveys made by me or under my supervision, and that the same is true and correct to the best of my knowledge and belief.

B- 9-81

Date Surveyed

Ludwig B. Thomas

Registered Professional Engineer
and/or Land Surveyor

Colo 46728

Certificate No.

