

30-043-20615

NO. OF COPIES RECEIVED	
DISTRIBUTION	
SANTA FE	
FILE	
U.S.G.S.	
LAND OFFICE	
OPERATOR	

## NEW MEXICO OIL CONSERVATION COMMISSION

Form C-101  
Revised 1-4-65

5A. Indicate Type of Lease	
STATE <input type="checkbox"/>	FEE <input checked="" type="checkbox"/>
5. State Oil & Gas Lease No.	

## APPLICATION FOR PERMIT TO DRILL, DEEPEN, OR PLUG BACK

1a. Type of Work		7. Unit Agreement Name	
b. Type of Well OIL WELL <input checked="" type="checkbox"/> GAS WELL <input type="checkbox"/> OTHER <input type="checkbox"/>		8. Farm or Lease Name Chapman "A"	
2. Name of Operator Merrion Oil & Gas Corporation		9. Well No. 1	
3. Address of Operator P. O. Box 1017, Farmington, New Mexico 87401		10. Field and Pool, or Wildcat Lybrook Gallup Ext.	
4. Location of Well UNIT LETTER F LOCATED 1790 FEET FROM THE North LINE AND 1830 FEET FROM THE West LINE OF SEC. 29 TWP. 23N RGE. 6W NMPM		12. County Sandoval	
19. Proposed Depth 5750' KB		19A. Formation Gallup	
21. Elevations (Show whether DF, RT, etc.) 7105 GL		20. Rotary or C.T. Rotary	
21A. Kind & Status Plug. Bond		22. Approx. Date Work will start April 1, 1982	
21B. Drilling Contractor Unknown			

## PROPOSED CASING AND CEMENT PROGRAM

SIZE OF HOLE	SIZE OF CASING	WEIGHT PER FOOT	SETTING DEPTH	SACKS OF CEMENT	EST. TOP
12-1/4"	8-5/8"	20 #/ft.	200'	175 sx	Surface
7-7/8"	4-1/2"	10.5 #/ft.	5750' KB	875 sx	Above Ojo Alamo

Propose to drill 12-1/4' hole to 200 ft., set 200 ft. of 8-5/8" 20 #/ft. new surface casing w/175 sx Class "B" 2% CACL<sub>2</sub>. Will drill 7-7/8" hole to TD and run open hole logs. If logs appear productive will run 4-1/2", K-55, 10.5 #/ft. new casing to TD and 2 stage cement. 1st stage 175 sx Class "H" 2% gel to cover Gallup. Stage tool below point lookout @ 4550' est. 2nd stage 600 sx Class "B" w/2% D-79 followed by 100 sx Class "H" 2% gel. Will bring cement above Ojo Alamo. Drilling mud will be low water loss gel, fresh water, starch. Will perforate and frac as necessary. Blowout prevention equipment will be 10" 900 series double ram.

## ESTIMATE TOPS

Ojo Alamo	1485'	Lewis	2210'
Kirtland	1655'	Mesa Verde	3610'
Fruitland	1935'	Mancos	4530'
Pictured Cliffs	2070'	Gallup	5368'

TOTAL DEPTH 5750'

IN ABOVE SPACE DESCRIBE PROPOSED PROGRAM: IF PROPOSAL IS TO DEEPEN OR PLUG BACK, GIVE DATA ON PRESENT PRODUCTIVE ZONE AND PROPOSED NEW PRODUCTIVE ZONE, GIVE BLOWOUT PREVENTER PROGRAM, IF ANY.

I hereby certify that the information above is true and complete to the best of my knowledge and belief.

Signed [Signature] Title Operations Manager Date March 2, 1982

(This space for State Use)

APPROVED BY [Signature] TITLE SUPERVISOR DISTRICT 3 DATE MAR 4 1982

CONDITIONS OF APPROVAL, IF ANY:

All distances must be from the outer boundaries of the Section.

Operator <b>MERRION OIL &amp; GAS CORPORATION</b>			Lease <b>CHAPMAN "A"</b>		Well No. <b>1</b>
Unit Letter <b>F</b>	Section <b>29</b>	Township <b>23N</b>	Range <b>6W</b>	County <b>SANDOVAL</b>	
Actual Footage Location of Well: <b>1790</b> feet from the <b>North</b> line and <b>1830</b> feet from the <b>West</b> line					
Ground Level Elev. <b>7105</b>	Producing Formation <b>Gallup</b>		Pool <b>Lybrook Ext.</b>	Dedicated Acreage: <b>40</b> Acres	

1. Outline the acreage dedicated to the subject well by colored pencil or hachure marks on the plat below.
2. If more than one lease is dedicated to the well, outline each and identify the ownership thereof (both as to working interest and royalty).
3. If more than one lease of different ownership is dedicated to the well, have the interests of all owners been consolidated by communitization, unitization, force-pooling, etc?

☐ Yes ☐ No If answer is "yes," type of consolidation \_\_\_\_\_

If answer is "no," list the owners and tract descriptions which have actually been consolidated. (Use reverse side of this form if necessary.) \_\_\_\_\_

No allowable will be assigned to the well until all interests have been consolidated (by communitization, unitization, forced-pooling, or otherwise) or until a non-standard unit, eliminating such interests, has been approved by the Commission.

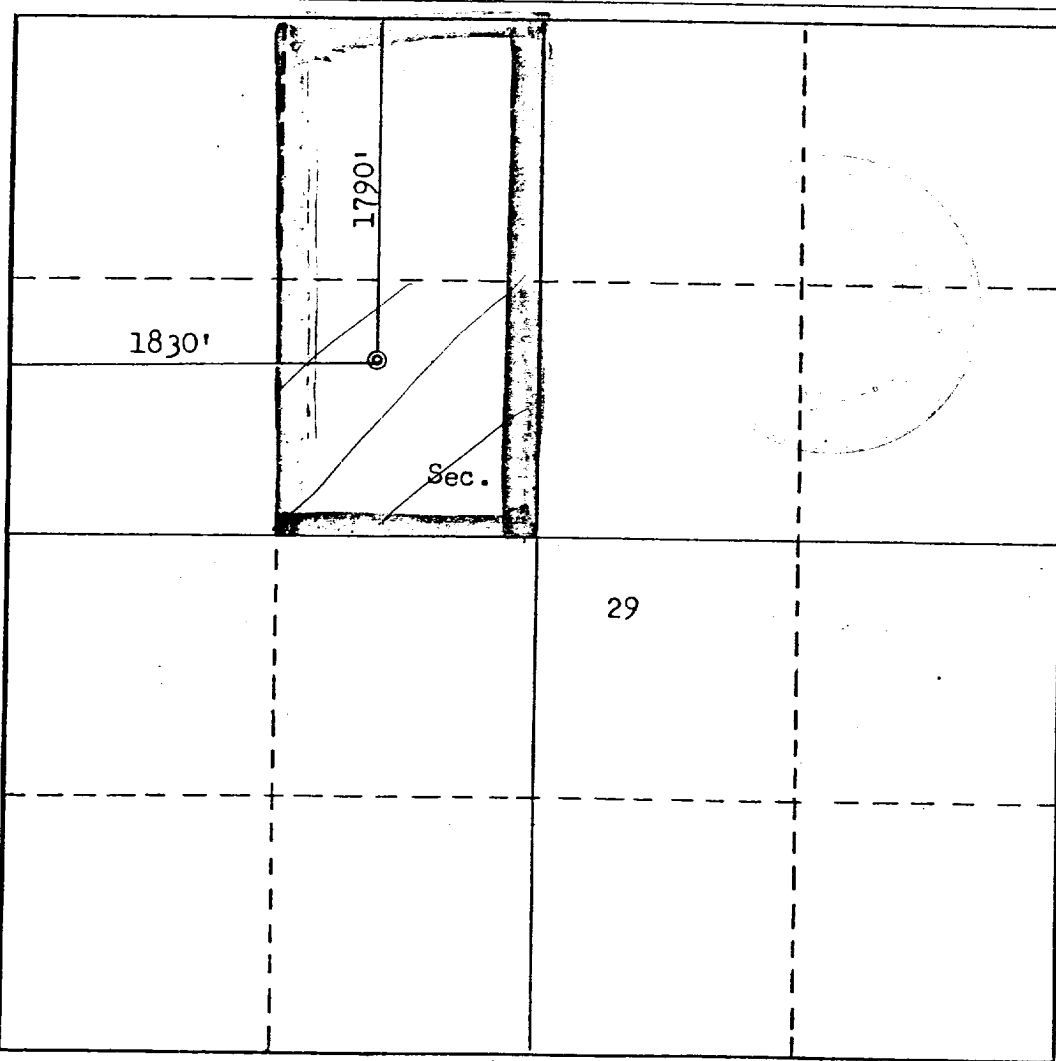

## CERTIFICATION

I hereby certify that the information contained herein is true and complete to the best of my knowledge and belief.

Name

Steve S. Dunn

Position

Operations Manager

Company

Merrion Oil &amp; Gas Corporation

Date

March 2, 1982

I hereby certify that the well location shown on this plat was plotted from field notes of actual surveys made by me or under my supervision, and that the same is true and correct to the best of my knowledge and belief.

Date Surveyed

February 28, 1982

Registered Professional Engineer  
and/or Land Surveyor

Fred E. Kerr Jr.

Certificate No.

3950

F. E. KERR, JR.