

UNITED STATES  
DEPARTMENT OF THE INTERIOR  
GEOLOGICAL SURVEY

30-043-20633

## APPLICATION FOR PERMIT TO DRILL, DEEPEN, OR PLUG BACK

## 1a. TYPE OF WORK

DRILL ☒DEEPEN ☐PLUG BACK ☐

## b. TYPE OF WELL

OIL  
WELL ☒GAS  
WELL ☐

OTHER

SINGLE  
ZONE ☐MULTIPLE  
ZONE ☐

## 2. NAME OF OPERATOR

Lewis Energy Corporation

## 3. ADDRESS OF OPERATOR

232 N. Schwartz, Farmington, New Mexico 87401

## 4. LOCATION OF WELL (Report location clearly and in accordance with any State requirements.\*)

At surface

2310' FSL 2310' FEL Sec. 16 T20N R3W

At proposed prod. zone  
Same

## 14. DISTANCE IN MILES AND DIRECTION FROM NEAREST TOWN OR POST OFFICE\*

15 miles SW of Cuba, New Mexico

## 15. DISTANCE FROM PROPOSED\*

LOCATION TO NEAREST

PROPERTY OR LEASE LINE, FT.

(Also to nearest drlg. unit line, if any) 2310' FSL

## 16. NO. OF ACRES IN LEASE

480

## 17. NO. OF ACRES ASSIGNED

TO THIS WELL 40

## 18. DISTANCE FROM PROPOSED LOCATION\*

TO NEAREST WELL, DRILLING, COMPLETED,

OR APPLIED FOR, ON THIS LEASE, FT.

None

## 19. PROPOSED DEPTH

4350'

## 20. ROTARY OR CABLE TOOLS

0-4350'

## 21. ELEVATIONS (Show whether DF, RT, GR, etc.)

6793' GR

## 22. APPROX. DATE WORK WILL START\*

3/22/82

## 23.

## PROPOSED CASING AND CEMENTING PROGRAM

SIZE OF HOLE	SIZE OF CASING	WEIGHT PER FOOT	SETTING DEPTH	QUANTITY OF CEMENT
12-1/4	8-5/8	23#	200'	To Surface
7-7/8	5-1/2	14#	3600'	To Surface
4-3/4	None	N/A	N/A	N/A

A 12-1/4" hole will be drilled w/mud to  $\pm$  200'. Then 8-5/8", 23#, X-42 will be run and set @  $\pm$  200'. This is limited service pipe that has been tested to 1500 psi and is recommended for depths up to 1000'. The 8-5/8" pipe will be cemented to surface. After WOC for 12 hrs. the braidenhead casing & BOP will be tested to 1000 psi. A 7-7/8" hole will then be drilled w/mud to  $\pm$  3600'. Then 5-1/2", 14#, J-55 will be run and set @  $\pm$  3600'. The 5-1/2" casing will be cemented to surface. At this point the drilling rig will be released. The hole will be finished using a completion rig. The casing head, BOP, and 5-1/2" casing will be tested to 1500 psi. Then a 4-3/4" hole will be drilled w/air-mist to  $\pm$  4350'. We anticipate completing this well in open hole. If hole problems develop a 3-1/2" slotted liner may be run from  $\pm$  3400' to T.D.

(See attached supplement for details)

IN ABOVE SPACE DESCRIBE PROPOSED PROGRAM: If proposal is to deepen or plug back, give data on present productive zone and proposed new productive zone. If proposal is to drill or deepen directionally, give pertinent data on subsurface locations and measured and true vertical depths. Give blowout preventer program, if any.

## 24.

SIGNER

Zachary C. Lewis

TITLE

Operations Manager

DATE

3/15/82

(This space for Federal or State office use)

PERMIT NO.

APPROVAL DATE

APPROVED BY

CONDITIONS OF APPROVAL, IF ANY:

TITLE

APPROVED  
3 AMENDED

DATE

MAR 24 1982

NMOCG

All distances must be from the outer boundaries of the Section.

Operator <b>LEWIS ENERGY CORPORATION</b>		Lease <b>LEWIS 16-20-3</b>		Well No. <b>1</b>
Unit Letter <b>J</b>	Section <b>16</b>	Township <b>20N</b>	Range <b>3W</b>	County <b>Sandoval</b>
Actual Footage Location of Well: <b>2310</b> feet from the <b>South</b> line and <b>2310</b> feet from the <b>East</b> line				
Ground Level Elev. <b>6793</b>	Producing Formation <b>Mancos Shale</b>	Pool <b>Wildcat</b>	Dedicated Acreage: <b>40</b> Acres	

1. Outline the acreage dedicated to the subject well by colored pencil or hachure marks on the plat below.
2. If more than one lease is dedicated to the well, outline each and identify the ownership thereof (both as to working interest and royalty).
3. If more than one lease of different ownership is dedicated to the well, have the interests of all owners been consolidated by communitization, unitization, force-pooling, etc?

☐ Yes ☐ No If answer is "yes," type of consolidation \_\_\_\_\_

If answer is "no," list the owners and tract descriptions which have actually been consolidated. (Use reverse side of this form if necessary.) \_\_\_\_\_

No allowable will be assigned to the well until all interests have been consolidated (by communitization, unitization, forced-pooling, or otherwise) or until a non-standard unit, eliminating such interests, has been approved by the Commission.

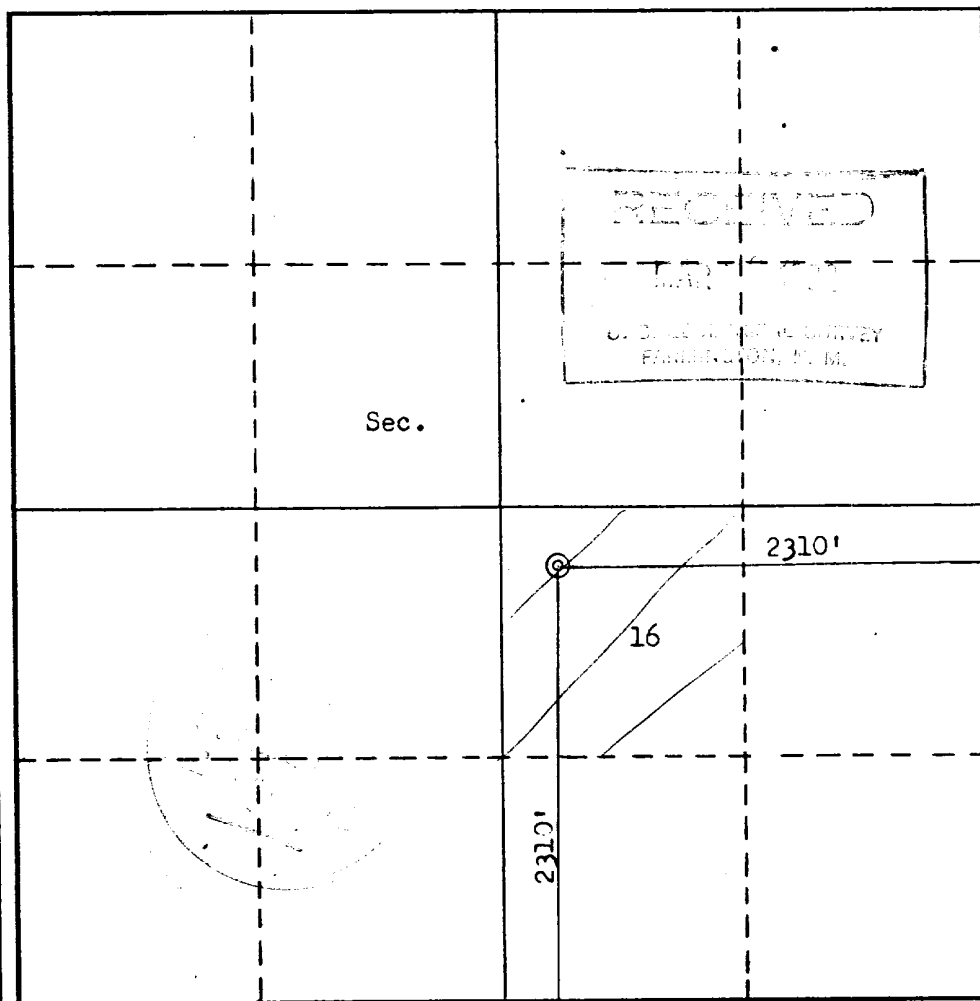

CERTIFICATION

I hereby certify that the information contained herein is true and complete to the best of my knowledge and belief.

Name

Position

Company

Date

I hereby certify that the well location shown on this plat was plotted from field notes of actual surveys made by me or under my supervision, and that the same is true and correct to the best of my knowledge and belief.

Date Surveyed

Registered Professional Engineer and/or Land Surveyor

Certificate No.

3950

