

UNITED STATES
DEPARTMENT OF THE INTERIOR
GEOLOGICAL SURVEY

30-043-20635

APPLICATION FOR PERMIT TO DRILL, DEEPEN, OR PLUG BACK

1a. TYPE OF WORK DRILL <input checked="" type="checkbox"/> DEEPEN <input type="checkbox"/> PLUG BACK <input type="checkbox"/>			5. LEASE DESIGNATION AND SERIAL NO. Contract No. 358		
b. TYPE OF WELL OIL WELL <input type="checkbox"/> GAS WELL <input checked="" type="checkbox"/> OTHER <input type="checkbox"/>			6. IF INDIAN, ALLOTTEE OR TRIBE NAME Jicarilla Apache		
2. NAME OF OPERATOR JACK A. COLE			7. UNIT AGREEMENT NAME		
3. ADDRESS OF OPERATOR P. O. Box 191 Farmington, New Mexico 87401			8. FARM OR LEASE NAME Indian Bend "A"		
4. LOCATION OF WELL (Report location clearly and in accordance with any State requirements.) At surface 790'FNL, 1820'FWL At proposed prod. zone Same			9. WELL NO. 1		
14. DISTANCE IN MILES AND DIRECTION FROM NEAREST TOWN OR POST OFFICE* 32 miles Northwest of Cuba, N.M.			10. FIELD AND POOL, OR WILDCAT Ballard Pictured Cli		
15. DISTANCE FROM PROPOSED* LOCATION TO NEAREST PROPERTY OR LEASE LINE, FT. (Also to nearest drlg. unit line, if any) 790'			11. SEC., T., R., M., OR BLK. AND SURVEY OR AREA Sec. 5-T22N-R2W C N.M.P.M.		
16. NO. OF ACRES IN LEASE 2546			12. COUNTY OR PARISH Sandoval		
17. NO. OF ACRES ASSIGNED TO THIS WELL 160			13. STATE N.M.		
18. DISTANCE FROM PROPOSED LOCATION* TO NEAREST WELL, DRILLING, COMPLETED, OR APPLIED FOR, ON THIS LEASE, FT. 1300'			20. ROTARY OR CABLE TOOLS Rotary		
21. ELEVATIONS (Show whether DF, RT, GR, etc.) 7436'G.L.			22. APPROX. DATE WORK WILL START* 4/20/82		

PROPOSED CASING AND CEMENTING PROGRAM

SIZE OF HOLE	SIZE OF CASING	WEIGHT PER FOOT	SETTING DEPTH	QUANTITY OF CEMENT
12-1/4"	8-5/8"	24.0	120'	100 sacks
7-7/8"	4-1/2"	10.50	3038'	150 sacks
6-3/4"				

All producing intervals in Pictured Cliffs Formation will be perforated and stimulated as necessary.

EXHIBITS:

- | | |
|--------------------------------------|-------------------------------|
| "A" Location & Elevation Plat | "E" Access Road to Location |
| "B" Ten Point Compliance Program | "F" Radius Map of Field |
| "C" Blowout Preventer Diagram | "G" Drill Rig Layout |
| "D" Multi-Point Requirements for APD | "H" Fracturing Program Layout |
| | "I" Location Profile |

The gas from this well is committed.

The NW/4, Section 5, is dedicated to this well.

IN ABOVE SPACE DESCRIBE PROPOSED PROGRAM: If proposal is to deepen or plug back, give data on present productive zone and proposed new productive zone. If proposal is to drill or deepen directionally, give pertinent data on subsurface locations and measured and true vertical depths. Give blowout preventer program, if any.

24. FOR: JACK A. COLE
ORIGINAL SIGNED BY EWELL N. WALSH
SIGNED _____ TITLE President, Walsh Engr. & Production Corp.
Ewell N. Walsh, P.E. DATE 3/24/82
(This space for Federal or State office use)

PERMIT NO. _____

APPROVAL DATE _____

APPROVED BY _____

CONDITIONS OF APPROVAL, IF ANY: _____

TITLE _____

See Instructions On Reverse Side

NMOCC

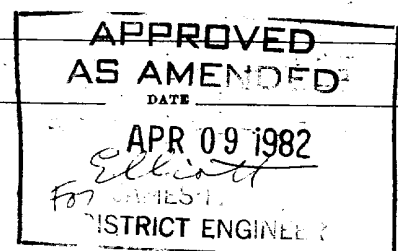

All distances must be from the outer boundaries of the Section.

Operator JACK A. COLE			Lease INDIAN BEND "A"		Well No. 1
Unit Letter C	Section 5	Township 22N	Range 2W	County Sandoval	
Actual Footage Location of Well: 790 feet from the North line and 1820 feet from the West line					
Ground Level Elev. 7436	Producing Formation Pictured Cliffs		Pool Ballard Pictured Cliffs		Dedicated Acreage: 160 Acres

1. Outline the acreage dedicated to the subject well by colored pencil or hachure marks on the plat below.
2. If more than one lease is dedicated to the well, outline each and identify the ownership thereof (both as to working interest and royalty).
3. If more than one lease of different ownership is dedicated to the well, have the interests of all owners been consolidated by communitization, unitization, force-pooling, etc?

☐ Yes ☐ No If answer is "yes," type of consolidation _____

If answer is "no," list the owners and tract descriptions which have actually been consolidated. (Use reverse side of this form if necessary.) _____

No allowable will be assigned to the well until all interests have been consolidated (by communitization, unitization, forced-pooling, or otherwise) or until a non-standard unit, eliminating such interests, has been approved by the Commission.

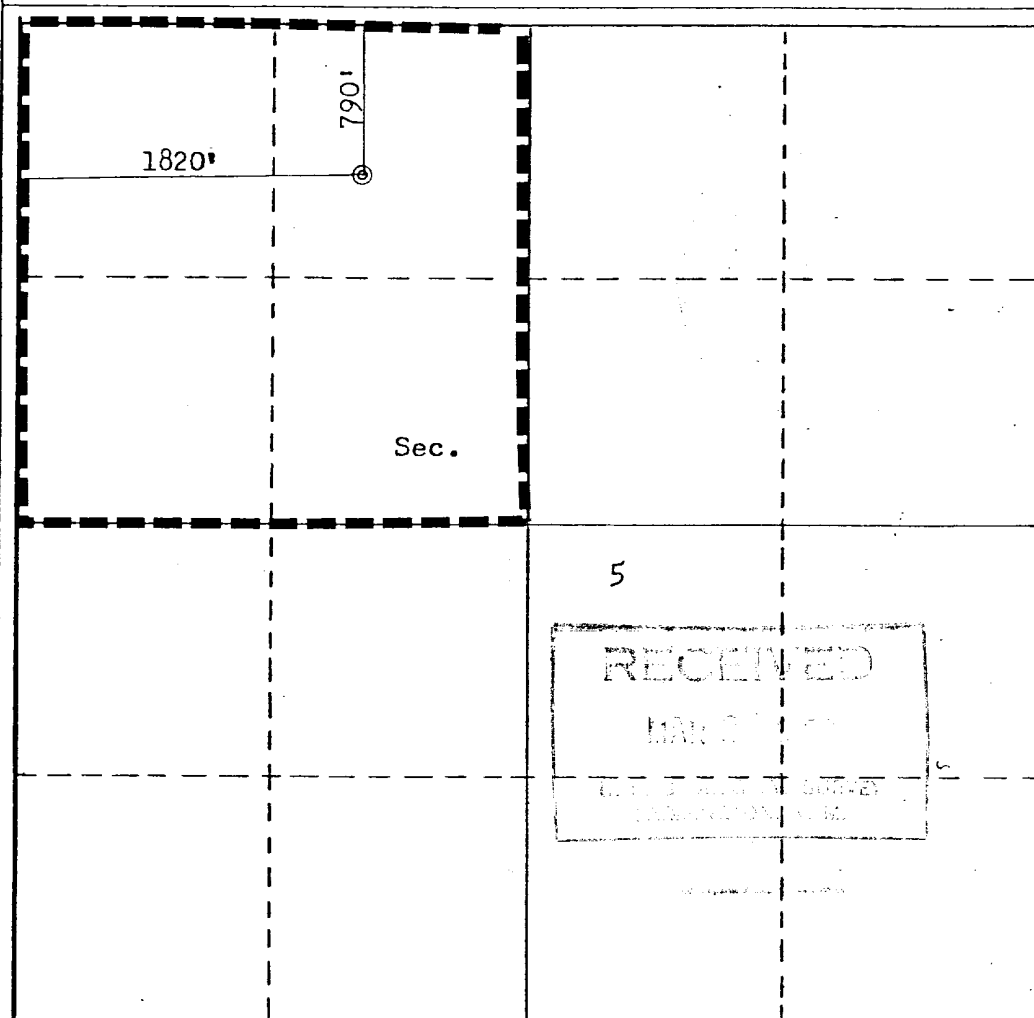

CERTIFICATION

I hereby certify that the information contained herein is true and complete to the best of my knowledge and belief.

FOR: JACK A. COLE
ORIGINAL SIGNED BY
EWELL N. WALSH

Name
Ewell N. Walsh, P.E.

Position
President

Company
Walsh Engr. & Prod. Corp.

Date
3/24/82

I hereby certify that the well location shown on this plat was plotted from field notes of actual surveys made by me or under my supervision, and that the same is true and correct to the best of my knowledge and belief.

Date Surveyed

March 22, 1982
Registered Professional Engineer
and/or Land Surveyor

Fred B. Kerr Jr.

Certificate No.

3950

F. B. KERR, JR.

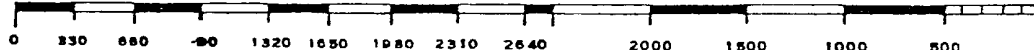

Vicinity Map for
JACK A. COLE #1 INDIAN BEND "A"
790'FNL 1820'FWL Sec. 5-T22N-R2W
SANDOVAL COUNTY, NEW MEXICO