

UNITED STATES
DEPARTMENT OF THE INTERIOR
GEOLOGICAL SURVEY

APPLICATION FOR PERMIT TO DRILL, DEEPEN, OR PLUG BACK

1a. TYPE OF WORK DRILL <input checked="" type="checkbox"/> DEEPEN <input type="checkbox"/> PLUG BACK <input type="checkbox"/>		5. LEASE DESIGNATION AND SERIAL NO. Contract No. 358	
b. TYPE OF WELL OIL WELL <input type="checkbox"/> GAS WELL <input checked="" type="checkbox"/> OTHER <input type="checkbox"/>		6. IF INDIAN, ALLOTTEE OR TRIBE NAME Jicarilla Apache	
2. NAME OF OPERATOR JACK A. COLE		7. UNIT AGREEMENT NAME	
3. ADDRESS OF OPERATOR P. O. Box 191 Farmington, New Mexico 87401		8. FARM OR LEASE NAME Indian Bend "A"	
4. LOCATION OF WELL (Report location clearly and in accordance with any State requirements.) At surface 1520'FNL, 1520'FEL At proposed prod. zone Same		9. WELL NO. 2	
14. DISTANCE IN MILES AND DIRECTION FROM NEAREST TOWN OR POST OFFICE* 32 miles Northwest of Cuba, N.M.		10. FIELD AND POOL, OR WILDCAT Ballard Picture Cliff	
15. DISTANCE FROM PROPOSED* LOCATION TO NEAREST PROPERTY OR LEASE LINE, FT. (Also to nearest drlg. unit line, if any) 1520'		11. SEC., T., R., M., OR BLK. AND SURVEY OR AREA Section 5-T22N-R2W G N.M.P.M.	
18. DISTANCE FROM PROPOSED LOCATION* TO NEAREST WELL, DRILLING, COMPLETED, OR APPLIED FOR, ON THIS LEASE, FT. 2600'		12. COUNTY OR PARISH Sandoval	
16. NO. OF ACRES IN LEASE 2546		13. STATE N.M.	
17. NO. OF ACRES ASSIGNED TO THIS WELL 160		20. ROTARY OR CABLE TOOLS Rotary	
21. ELEVATIONS (Show whether DF, RT, GR, etc.) 7396'G.L.		22. APPROX. DATE WORK WILL START* 4/20/82	

23. PROPOSED CASING AND CEMENTING PROGRAM				
SIZE OF HOLE	SIZE OF CASING	WEIGHT PER FOOT	SETTING DEPTH	QUANTITY OF CEMENT
12-1/4"	8-5/8"	24.0	120'	100 sacks
7-7/8"	4-1/2"	10.50	2988'	150 sacks

All producing intervals in Pictured Cliffs Formation will be perforated and stimulated as necessary.

EXHIBITS

- | | |
|-------------------------------------|-------------------------------|
| "A" Location & Elevation Plat | "E" Access Road to Location |
| "B" Ten Point Compliance Program | "F" Radius Map of Field |
| "C" Blowout Preventer Diagram | "G" Drill Rig Layout |
| "D" Multi-Point Requirement for APD | "H" Fracturing Program Layout |
| | "I" Location Profile |

The gas from this well is committed.

The NE/4, Section 5 is dedicated to this well.

IN ABOVE SPACE DESCRIBE PROPOSED PROGRAM: If proposal is to deepen or plug back, give data on present productive zone and proposed new productive zone. If proposal is to drill or deepen directionally, give pertinent data on subsurface locations and measured and true vertical depths. Give blowout preventer program, if any.

24. FOR: JACK A. COLE
SIGNED EWELL N. WALSH TITLE President, Walsh Engr. & Production Corp. DATE 3/24/82
Ewell N. Walsh, P.E.
(This space for Federal or State office use)

PERMIT NO. _____ APPROVAL DATE _____

APPROVED BY _____ TITLE _____
CONDITIONS OF APPROVAL, IF ANY: _____

*See Instructions On Reverse Side

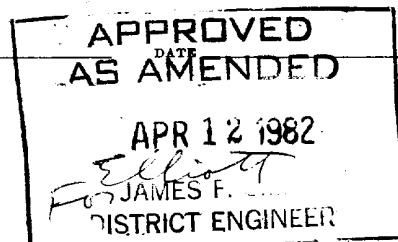

All distances must be from the outer boundaries of the Section.

Operator JACK A. COLE			Lease INDIAN BEND "A"		Well No. 2
Unit Letter (G)	Section 5	Township 22N	Range 2W	County Sandoval	
Actual Footage Location of Well: 1520 feet from the North line and 1520 feet from the East line					
Ground Level Elev. 396	Producing Formation Pictured Cliffs		Pool Ballard Pictured Cliffs		Dedicated Acreage: 160 Acres

1. Outline the acreage dedicated to the subject well by colored pencil or hachure marks on the plat below.
2. If more than one lease is dedicated to the well, outline each and identify the ownership thereof (both as to working interest and royalty).
3. If more than one lease of different ownership is dedicated to the well, have the interests of all owners been consolidated by communitization, unitization, force-pooling, etc?

☐ Yes ☐ No If answer is "yes," type of consolidation _____

If answer is "no," list the owners and tract descriptions which have actually been consolidated. (Use reverse side of this form if necessary.) _____

No allowable will be assigned to the well until all interests have been consolidated (by communitization, unitization, forced-pooling, or otherwise) or until a non-standard unit, eliminating such interests, has been approved by the Commission.

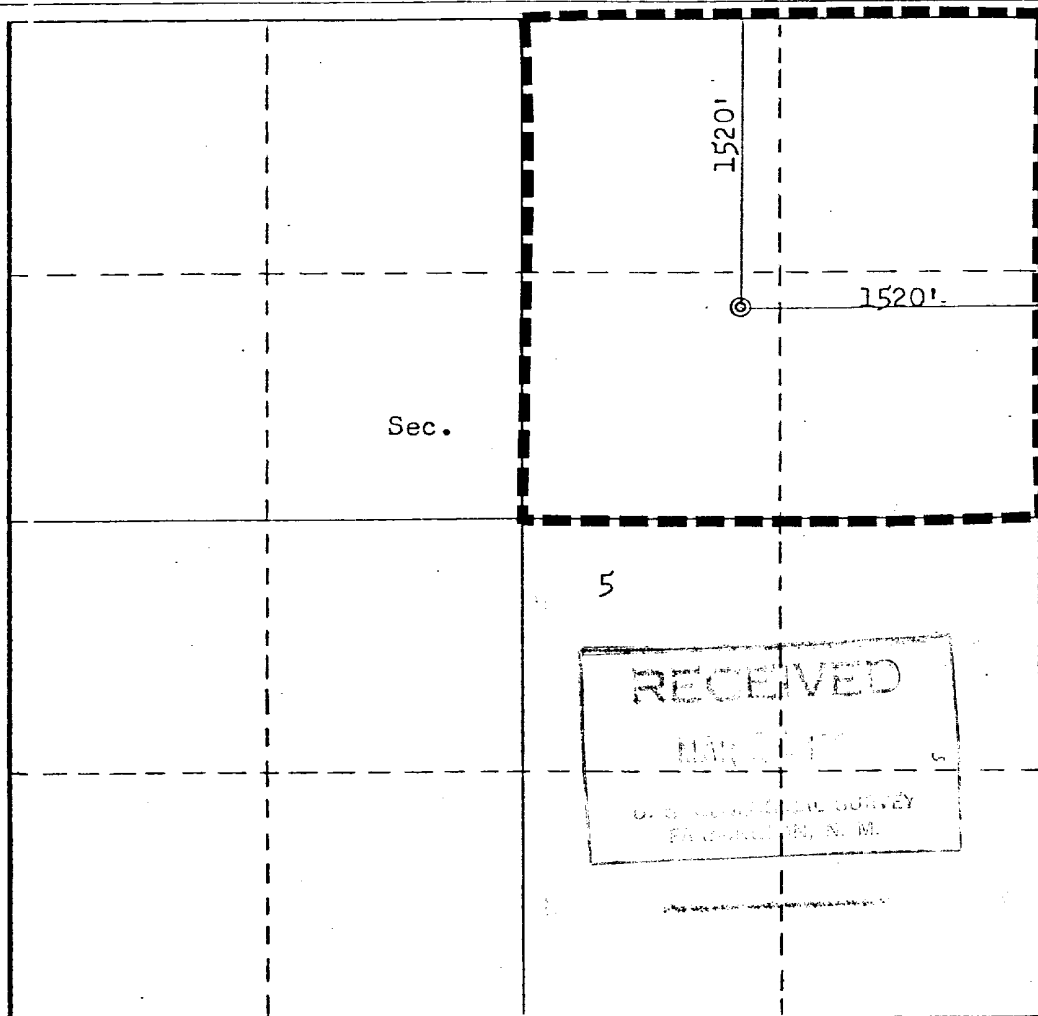

CERTIFICATION

I hereby certify that the information contained herein is true and complete to the best of my knowledge and belief.

FOR: **JACK A. COLE**

ORIGINAL SIGNED BY

Name **EWELL N. WALSH**
Ewell N. Walsh, P.E.

Position
President

Company
Walsh Engineering & Prod. Cor

Date
3/24/82

I hereby certify that the well location shown on this plat was plotted from field notes of actual surveys made by me or under my supervision, and that the same is true and correct to the best of my knowledge and belief.

Date Surveyed

March 24, 1982

Registered Professional Engineer and/or Land Surveyor

Fred E. Kerr Jr.

Certificate No.

3950

8. KERR, JR.

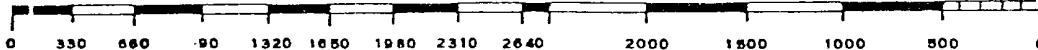



Vicinity Map for
JACK A. COLE #2 INDIAN BEND "A"
1520'FNL 1520'FEL Sec. 5-T22N-R2W
SANDOVAL COUNTY, NEW MEXICO

x7332