

UNITED STATES
DEPARTMENT OF THE INTERIOR
GEOLOGICAL SURVEY(Other instructions on
reverse side)

36-048-20650

30-039-23021

APPLICATION FOR PERMIT TO DRILL, DEEPEN, OR PLUG BACK

1a. TYPE OF WORK

DRILL ☒DEEPEN ☐PLUG BACK ☐

b. TYPE OF WELL

OIL
WELL ☒GAS
WELL ☐

OTHER

SINGLE
ZONE ☐MULTIPLE
ZONE ☐

2. NAME OF OPERATOR

Chace Oil Company, Inc.

3. ADDRESS OF OPERATOR

313 Washington, S. E., Albuquerque, NM 87108

4. LOCATION OF WELL (Report location clearly and in accordance with any State requirements.)*

At surface

Unit "K" 1850' FSL and 1850' FWL

At proposed prod. zone

14. DISTANCE IN MILES AND DIRECTION FROM NEAREST TOWN OR POST OFFICE*

14 miles W-SW of Lindrith, New Mexico

15. DISTANCE FROM PROPOSED*

LOCATION TO NEAREST
PROPERTY OR LEASE LINE, FT.
(Also to nearest drlg. unit line, if any) 1500'

16. NO. OF ACRES IN LEASE

2560

18. DISTANCE FROM PROPOSED LOCATION*

TO NEAREST WELL, DRILLING, COMPLETED,
OR APPLIED FOR, ON THIS LEASE, FT. 2500'

19. PROPOSED DEPTH

7140'

21. ELEVATIONS (Show whether DF, RT, GR, etc.)

7230' - 18

7215' - 6L

23.

PROPOSED CASING AND CEMENTING PROGRAM

| SIZE OF HOLE | SIZE OF CASING | WEIGHT PER FOOT | SETTING DEPTH | QUANTITY OF CEMENT |
|--------------|----------------|-----------------|---------------|---|
| 9 3/4" | 8 5/8" | 22.29 | 225' | 225 sxs Class "B" cement |
| 7 7/8" | 4 1/2" | 11.6 | 7140' | 1st stage - 750 sxs 50/50 posmix; 2nd stage - 550 sxs 40/60 posmix; 12% gel; 200 sxs Class "B" cement |

Drill 230' of 9 3/4" surface hole. Set 225' of 8 5/8" casing; cement to surface with 225 sxs cement. Use an oil base mud (15% oil) and Schaeffer 5000# standard doublegate hydraulic BOP. Drill 7 7/8" hole to 7140' to test the Dakota formation.

Wasatch formation on surface. Estimated tops: Ojo- 2260'; Pictured Cliffs-2570'; Chacra-2935'; Cliff House-4105'; Point Lookout-4480'; Gallup-5750'; Greenhorn-6740'; Dakota "A"-6815'; Dakota "D"-6990'.

D. V. tool @ 3000'. Float collar at 7110'.

RECEIVED

APR 3 1982

U. S. GEOLOGICAL SURVEY

IN ABOVE SPACE DESCRIBE PROPOSED PROGRAM: If proposal is to deepen or plug back, give data on present productive zone and proposed new productive zone. If proposal is to drill or deepen directionally, give pertinent data on subsurface locations and measured and true vertical depths. Give blowout preventer program, if any.

24.

SIGNED

Rosa Esterhuysen

TITLE

Landman

DATE

3-30-82

(This space for Federal or State office use)

PERMIT NO.

APPROVAL DATE

APPROVED BY

TITLE

CONDITIONS OF APPROVAL, IF ANY:

*See Instructions On Reverse Side

NMOCC

APPROVED
AS AMENDED

JUN 14 1982

JAMES F. SIM
DISTRICT ENGINEER

NEW MEXICO OIL CONSERVATION COMMISSION
WELL LOCATION AND ACREAGE DEDICATION PLAT

Form C-102
Supersedes C-128
Effective 1-1-65

All distances must be from the outer boundaries of the Section.

| | | | | | |
|--|--------------------------------------|-----------------------------|---------------------------------|---|--------------------------|
| Operator CHACE OIL CO. | | | Lease CHACE APACHE 94 | | Well No. 54-11 |
| Unit Letter K | Section 3 | Township 22 NORTH | Range 3 WEST | County SANDOVAL | |
| Actual Footage Location of Well: 1850 feet from the SOUTH line and 1850 feet from the WEST line | | | | | |
| Ground Level Elev. 7216 | Producing Formation DAKOTA | | Pool Chacon DAKOTA | Dedicated Acreage 160 70 Acres | |

1. Outline the acreage dedicated to the subject well by colored pencil or hatchure marks on the plat below.
2. If more than one lease is dedicated to the well, outline each and identify the ownership thereof (both as to working interest and royalty).
3. If more than one lease of different ownership is dedicated to the well, have the interests of all owners been consolidated by communitization, unitization, force-pooling, etc?

☐ Yes ☐ No If answer is "yes," type of consolidation _____

If answer is "no," list the owners and tract descriptions which have actually been consolidated. (Use reverse side of this form if necessary.) _____

No allowable will be assigned to the well until all interests have been consolidated (by communitization, unitization, forced-pooling, or otherwise) or until a non-standard unit, eliminating such interests, has been approved by the Commission.

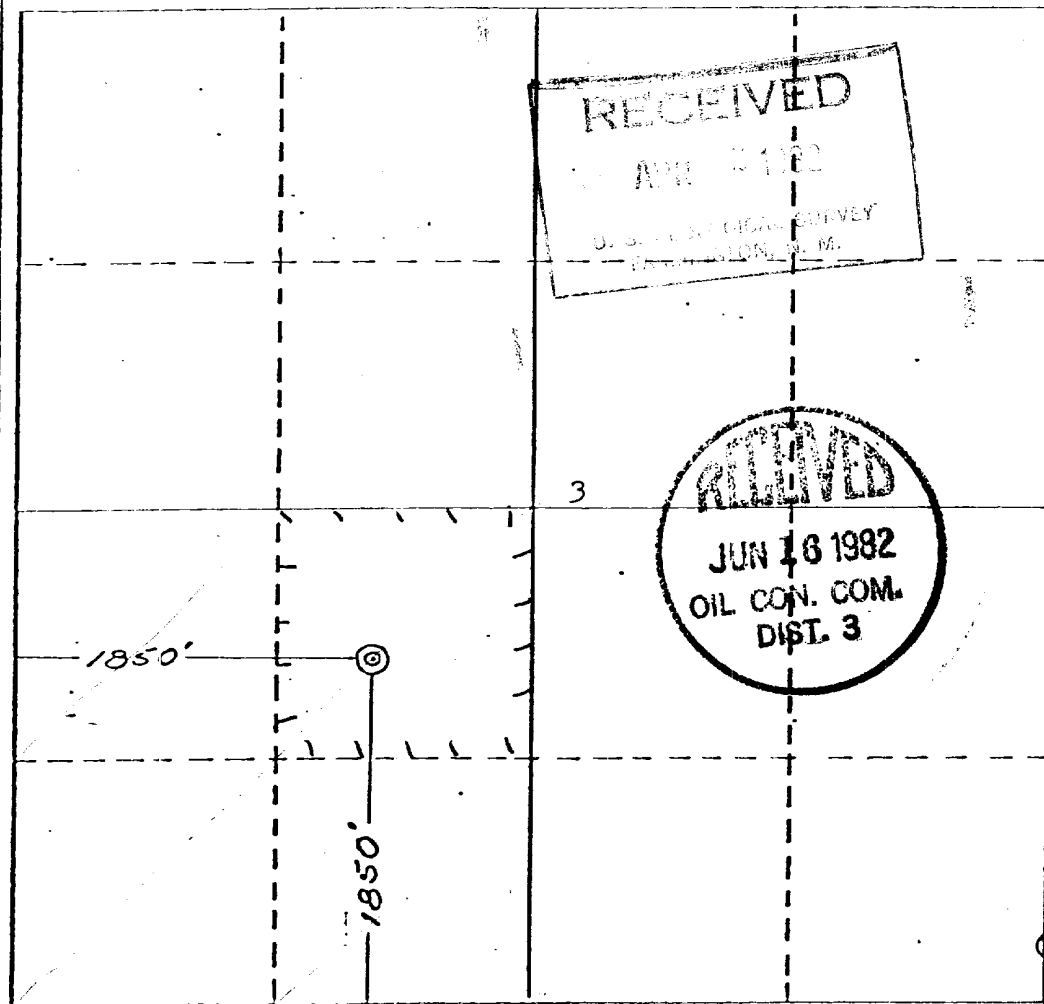

CERTIFICATION

I hereby certify that the information contained herein is true and complete to the best of my knowledge and belief.

Name James P. Leese
Position Geologist
Company Chace Oil Co.

Date 4-1-82

I hereby certify that the location shown on this plat was plotted from field notes of actual survey by me or under my supervision, and the same is true and correct to the best of my knowledge.

Date Surveyed
March 18, 1982

Registered Professional Engineer and/or Land Surveyor

James P. Leese

Certificate No.

1463

0 330 660 990 1320 1650 1980 2310 2640 2000 1500 1000 500 0

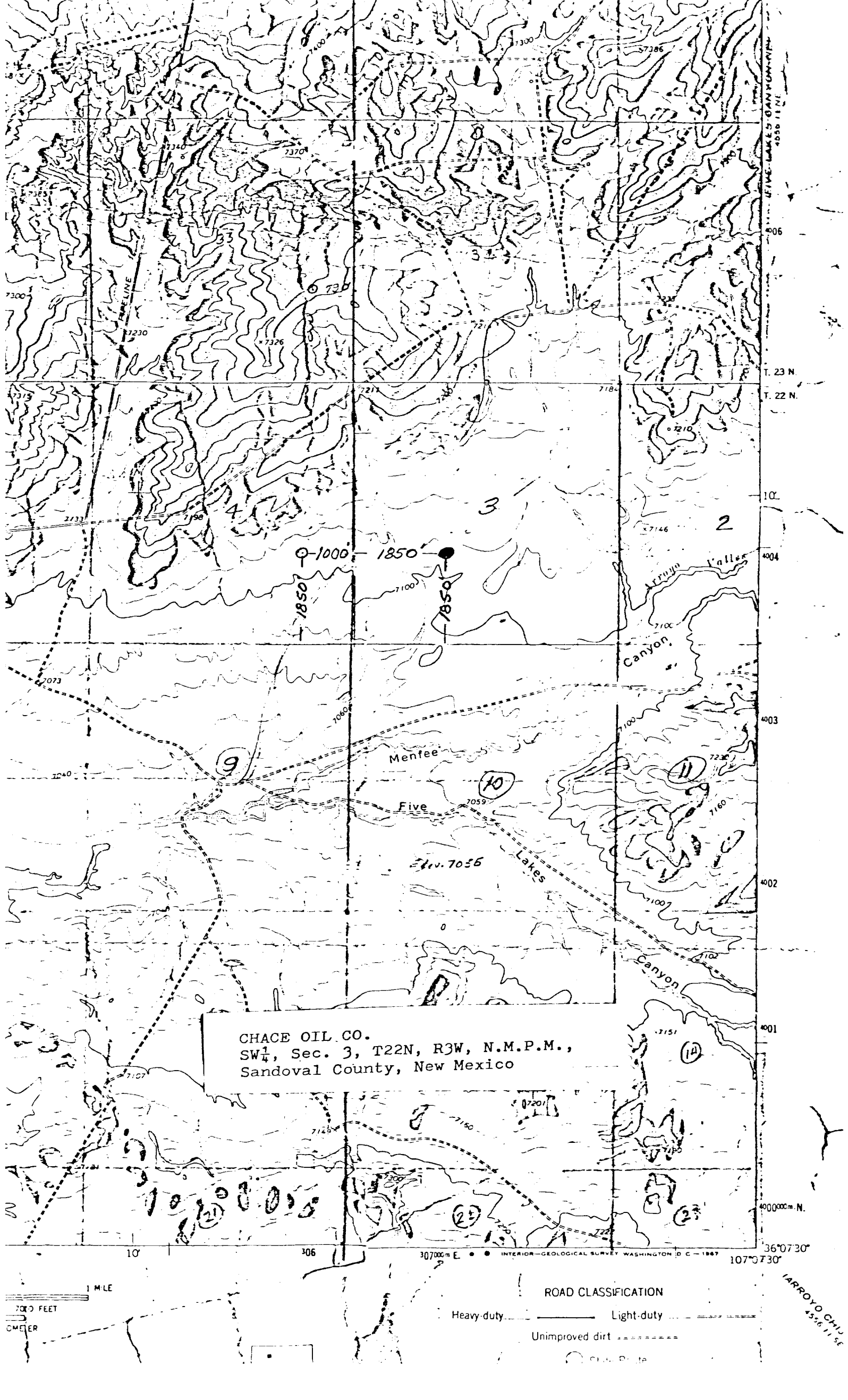

CHACE OIL CO.
SW $\frac{1}{4}$, Sec. 3, T22N, R3W, N.M.P.M.,
Sandoval County, New Mexico

1 MILE
700 FEET
METER

ROAD CLASSIFICATION
Heavy-duty ——— Light-duty - - - - -
Unimproved dirt =====
Clim. Route

ARROYO CHUI
45.6 11.55

UNITED STATES
DEPARTMENT OF THE INTERIOR
GEOLOGICAL SURVEY

SUNDRY NOTICES AND REPORTS ON WELLS

(Do not use this form for proposals to drill or to deepen or plug back to a different reservoir. Use Form 9-331-C for such proposals.)

1. oil ☒ well gas ☐ well other ☐

2. NAME OF OPERATOR

Chace Oil Company, Inc.

3. ADDRESS OF OPERATOR

313 Washington, S. E., Albuquerque, NM 87108

4. LOCATION OF WELL (REPORT LOCATION CLEARLY. See space 17 below.) Unit "K" 1850' FSL & 1850' FWL

AT SURFACE:

AT TOP PROD. INTERVAL:

AT TOTAL DEPTH:

16. CHECK APPROPRIATE BOX TO INDICATE NATURE OF NOTICE, REPORT, OR OTHER DATA

REQUEST FOR APPROVAL TO:

TEST WATER SHUT-OFF ☐
FRACTURE TREAT ☐
SHOOT OR ACIDIZE ☐
REPAIR WELL ☐
PULL OR ALTER CASING ☐
MULTIPLE COMPLETE ☐
CHANGE ZONES ☐
ABANDON* ☐

SUBSEQUENT REPORT OF:

(other) Casing grade

5. LEASE

Contract #54

6. IF INDIAN, ALLOTTEE OR TRIBE NAME

Jicarilla Apache

7. UNIT AGREEMENT NAME

8. FARM OR LEASE NAME Chace Apache
Jicarilla Tribal Contract #54

9. WELL NO.

#11

10. FIELD OR WILDCAT NAME

Chacon Dakota

11. SEC., T., R., M., OR BLK. AND SURVEY OR AREA

Section 3 T22N-R3W

12. COUNTY OR PARISH 13. STATE

Sandoval

New Mexico

14. API NO.

15. ELEVATIONS (SHOW DE KDB, AND WD)

7230' KB

7216' GL

(NOTE: Report results of multiple completion or zone change on Form 9-330.)

17. DESCRIBE PROPOSED OR COMPLETED OPERATION (Clearly state all pertinent details, and give pertinent dates, including estimated date of starting any proposed work. If well is directionally drilled, give subsurface locations and measured and true vertical depths for all markers and zones pertinent to this work.)*

Surface Casing - #29 8 5/8" K-55 casing

Production Casing - 11.6# 4 1/2" K-55 casing

Purchase Invoice attached

Subsurface Safety Valve: Manu. and Type

Set @ Ft.

18. I hereby certify that the foregoing is true and correct

SIGNED

TITLE Landman

DATE June 14, 1982

(This space for Federal or State office use)

APPROVED BY
CONDITIONS OF APPROVAL, IF ANY:

TITLE

DATE

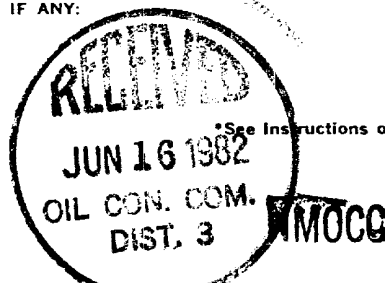

*See Instructions on Reverse Side

