

UNITED STATES
DEPARTMENT OF THE INTERIOR
GEOLOGICAL SURVEY

APPLICATION FOR PERMIT TO DRILL, DEEPEN, OR PLUG BACK

1a. TYPE OF WORK

DRILL ☒DEEPEN ☐PLUG BACK ☐

b. TYPE OF WELL

OIL
WELL ☒GAS
WELL ☐

OTHER

SINGLE
ZONE ☒MULTIPLE
ZONE ☐

2. NAME OF OPERATOR

Jicarilla Energy Company

3. ADDRESS OF OPERATOR

Box 507, Dulce, New Mexico 87528

4. LOCATION OF WELL (Report location clearly and in accordance with any State requirements*)

At surface

850 FNL, 800 FEL

At proposed prod. zone

same

14. DISTANCE IN MILES AND DIRECTION FROM NEAREST TOWN OR POST OFFICE*

15 miles NE of Cuba, New Mexico

10. DISTANCE FROM PROPOSED*

LOCATION TO NEAREST

PROPERTY OR LEASE LINE, FT.

(Also to nearest drlg. unit line, if any)

790'

18. DISTANCE FROM PROPOSED LOCATION*

TO NEAREST WELL, DRILLING, COMPLETED,

OR APPLIED FOR, ON THIS LEASE, FT.

2640'

16. NO. OF ACRES IN LEASE

19. PROPOSED DEPTH

7100'

17. NO. OF ACRES ASSIGNED
TO THIS WELL

160

20. ROTARY OR CABLE TOOLS

Rotary

21. ELEVATIONS (Show whether DF, RT, GR, etc.)

7165 GR

DRILLING OPERATIONS AUTHORIZED ARE
SUBJECT TO COMPLIANCE WITH ATTACHED

22. APPROX. DATE WORK WILL START*

October 15, 1983

23.

"GENERAL REQUIREMENTS"
PROPOSED CASING AND CEMENTING PROGRAMThis action is subject to administrative
appeal pursuant to 30 CFR 290.

SIZE OF HOLE	SIZE OF CASING	WEIGHT PER FOOT	SETTING DEPTH	QUANTITY OF CEMENT
12 1/4	8 5/8	24	300'	275 sx
7 7/8	4 1/2	10.5 & 11.6	7100'	1600 sx

We propose to drill this well to test the Dakota formation. Should it be productive, a string of 4 1/2" 10.5# and 11.6# casing will be set through the pay, and selectively perforated and stimulated. The hole will be mud drilled. A double gate BOP will be utilized from 300' to TD.

There are no known drilling problems associated with this well.

RECEIVED
OCT 17 1983

OIL CON. DIV.

DIST. 3

IN ABOVE SPACE DESCRIBE PROPOSED PROGRAM: If proposal is to deepen or plug back, give data on present productive zone and planned new productive zone. If proposal is to drill or deepen directionally, give pertinent data on subsurface locations and measured and true vertical depths. Give blowout preventer program, if any.

24.

SIGNED

(This space for Federal or State office use)

TITLE Oil and Gas Supervisor

APPROVED
AS AMENDED

PERMIT NO.

APPROVAL DATE

APPROVED BY

CONDITIONS OF APPROVAL, IF ANY:

TITLE

OCT 14 1983

M. MILLENBACH

AREA MANAGER

*See Instructions On Reverse Side

All distances must be from the outer boundaries of the Section

Operator JICARILLA ENERGY COMPANY			Lease JECO 83-A		Well No. 1
Unit Letter A	Section 14	Township 22 NORTH	Range 3 WEST	County SANDOVAL	
Actual Postage Location of Well: 850 feet from the NORTH line and 800 feet from the EAST line					
Ground Level Elev. 7165	Producing Formation		Pool	Dedicated Acreage:	

1. Outline the acreage dedicated to the subject well by colored pencil or hatchure marks on the plat below.
2. If more than one lease is dedicated to the well, outline each and identify the ownership thereof (both as to working interest and royalty).
3. If more than one lease of different ownership is dedicated to the well, have the interests of all owners been consolidated by communitization, unitization, force-pooling, etc?

☐ Yes ☐ No If answer is "yes," type of consolidation _____

If answer is "no," list the owners and tract descriptions which have actually been consolidated. (Use reverse side of this form if necessary.) _____

No allowable will be assigned to the well until all interests have been consolidated (by communitization, unitization, forced-pooling, or otherwise) or until a non-standard unit, eliminating such interests, has been approved by the Division

RECEIVED

OCT 1 7 1983

OIL CON. DIV.
DIST. 9

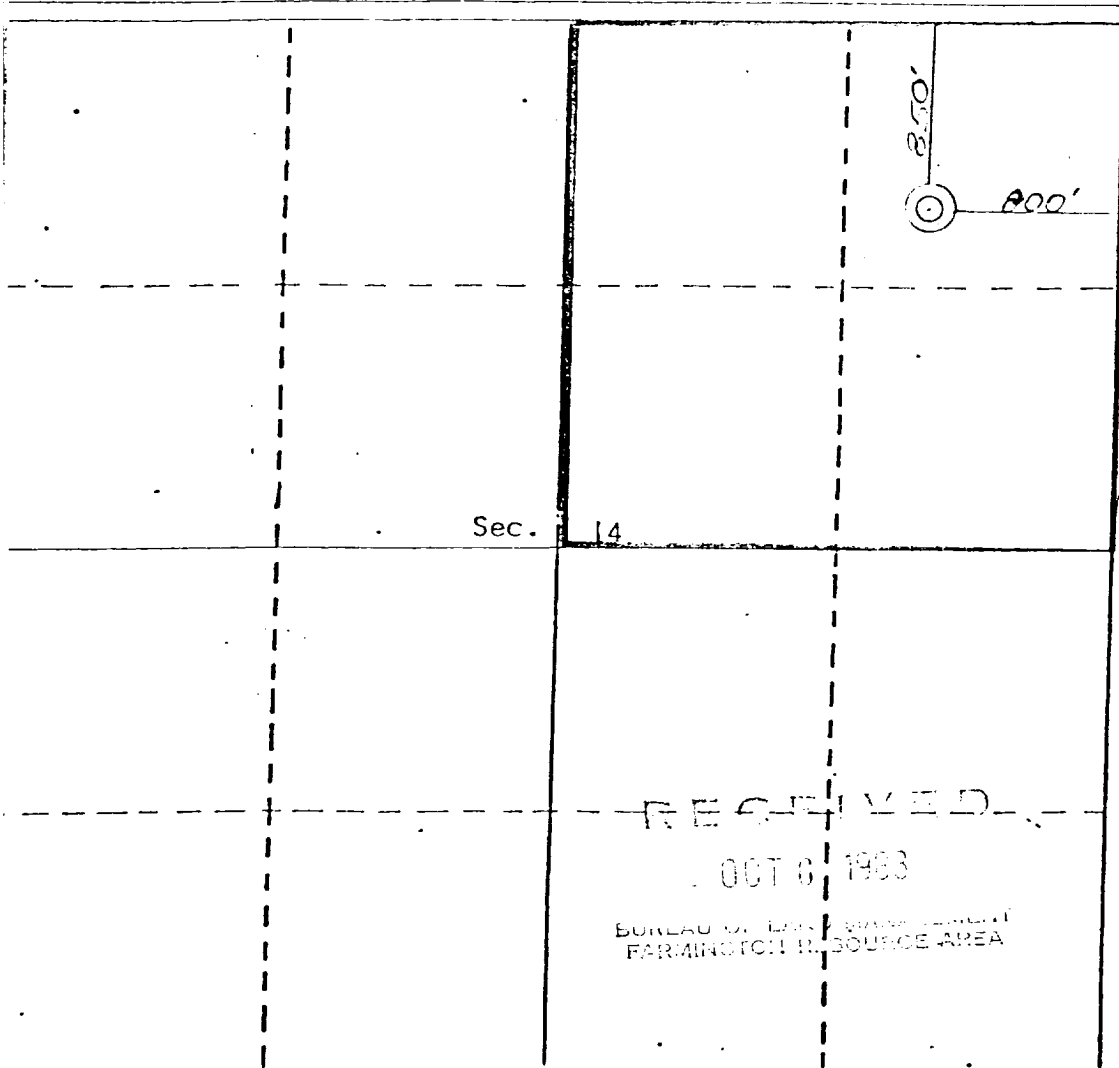

CERTIFICATION

I hereby certify that the information contained herein is true and complete to the best of my knowledge and belief.

Name
David W. Ellledge
Position
PRESIDENT
Company
ELLEGE CONSULTING
Date
10-5-83

I hereby certify that the well location shown on this plat was plotted from field notes of actual surveys made by me or under my supervision, and that the same is true and correct to the best of my knowledge and belief.

RECEIVED
OCT 6 1983
BUREAU OF LAND MANAGEMENT
FARMINGTON RESOURCE AREA

REGISTERED LAND
3 October 1983
Date
David W. Ellledge
Registered Professional Engineer
and/or Licensed Surveyor
CURTIS C. STOCKING

Certificate No.
5980

