

UNITED STATES  
DEPARTMENT OF THE INTERIOR  
GEOLOGICAL SURVEY

## APPLICATION FOR PERMIT TO DRILL, DEEPEN, OR PLUG BACK

1a. TYPE OF WORK  
DRILL ☒ DEEPEN ☐ PLUG BACK ☐b. TYPE OF WELL  
OIL WELL ☒ GAS WELL ☐ OTHER ☐  
SINGLE ZONE ☐ MULTIPLE ZONE ☐

2. NAME OF OPERATOR

Samuel Gary Oil Producers

3. ADDRESS OF OPERATOR

#4 Inverness Court East, Englewood, CO 80112-5599

4. LOCATION OF WELL (Report location clearly and in accordance with any State requirements.)\*  
At surface

660' FNL &amp; 660' FWL Sec. 14-20N-3W

At proposed prod. zone

14. DISTANCE IN MILES AND DIRECTION FROM NEAREST TOWN OR POST OFFICE\*

Approximately 6 miles S.W. of Cuba, NM

15. DISTANCE FROM PROPOSED\*  
LOCATION TO NEAREST  
PROPERTY OR LEASE LINE, FT.  
(Also to nearest drig. unit line, if any)7 + miles to Fed.  
28-818. DISTANCE FROM PROPOSED LOCATION\*  
TO NEAREST WELL, DRILLING, COMPLETED,  
OR APPLIED FOR, ON THIS LEASE, FT.

16. NO. OF ACRES IN LEASE

192

19. PROPOSED DEPTH

4400'

17. NO. OF ACRES ASSIGNED  
TO THIS WELL

40

20. ROTARY OR CABLE TOOLS

Rotary

21. ELEVATIONS (Show whether DF, RT, GR, etc.)

6848' GR

DRILLING OPERATIONS AUTHORIZED ARE  
SUBJECT TO COMPLETION WITH ATTACHED  
"GENERAL REQUIREMENTS"

PROPOSED CASING AND CEMENTING PROGRAM

22. APPROX. DATE WORK WILL START\*

November 15, 1983

This action is subject to administrative  
appeal pursuant to 30 CFR 290.

SIZE OF HOLE	SIZE OF CASING	WEIGHT PER FOOT	SETTING DEPTH	QUANTITY OF CEMENT
13 1/2"	9-5/8"	36# J-55	200'	Cement to surface
8-3/4"	7"	23# K-55	3700'	Determined by Caliper Log
6"	4-1/2"	10.50J	4400'	5 SX Cement

Drill 13 1/2" Surface hole to 200'. Cmt. to surface. Drill 8-3/4" hole to 3700'  
Cement thru Ojo Alamo. Run 7" 23lb. K-55 LTC to TD. Cmt. w/approximate 1000' fill.  
Run 4-1/2" producing csg. to 4400' + -.

Surface to be drilled with 9 lb. mud weight viscosity 45' to 200', from 200' to TD  
will be drilled with air mist.

RECEIVED

NOV 29 1983

OIL CON. DIV.

IN ABOVE SPACE DESCRIBE PROPOSED PROGRAM: If proposal is to deepen or plug back, give data on present productive zone and proposed new productive zone. If proposal is to drill or deepen directionally, give pertinent data on subsurface locations and measured and true vertical depths. Give blowout preventer program, if any.

24.

SIGNED

TITLE

DATE

(This space for Federal or State office use)

PERMIT NO.

APPROVAL DATE

APPROVED BY

TITLE

CONDITIONS OF APPROVAL, IF ANY:

APPROVED  
AS AMENDED

DATE NOV 25 1983

R. Bringham  
M. MILLENBACH  
AREA MANAGER  
(Acting)

NMOC

All distances must be from the outer boundaries of the Section.

Operator <b>SAMUEL GARY OIL PRODUCER</b>			Lease <b>SAN ISIDRO 14</b>		Well No. <b>14</b>
Unit Letter <b>D</b>	Section <b>14</b>	Township <b>20 NORTH</b>	Range <b>3 WEST</b>	County <b>SANDOVAL</b>	
Actual Footage Location of Well: <b>660</b> feet from the <b>NORTH</b> line and <b>660</b> feet from the <b>WEST</b> line					
Ground Level Elev. <b>6848</b>	Producing Formation <b>Undesignated-Gallup</b>		Pool	Dedicated Acreage: <b>40</b> Acres	

1. Outline the acreage dedicated to the subject well by colored pencil or hachure marks on the plat below.
2. If more than one lease is dedicated to the well, outline each and identify the ownership thereof (both as to working interest and royalty).
3. If more than one lease of different ownership is dedicated to the well, have the interests of all owners been consolidated by communitization, unitization, force-pooling, etc?

☐ Yes ☐ No If answer is "yes," type of consolidation \_\_\_\_\_

If answer is "no," list the owners and tract descriptions which have actually been consolidated. (Use reverse side of this form if necessary.) \_\_\_\_\_

No allowable will be assigned to the well until all interests have been consolidated (by communitization, unitization, forced-pooling, or otherwise) or until a non-standard unit, eliminating such interests, has been approved by the Division

RECEIVED

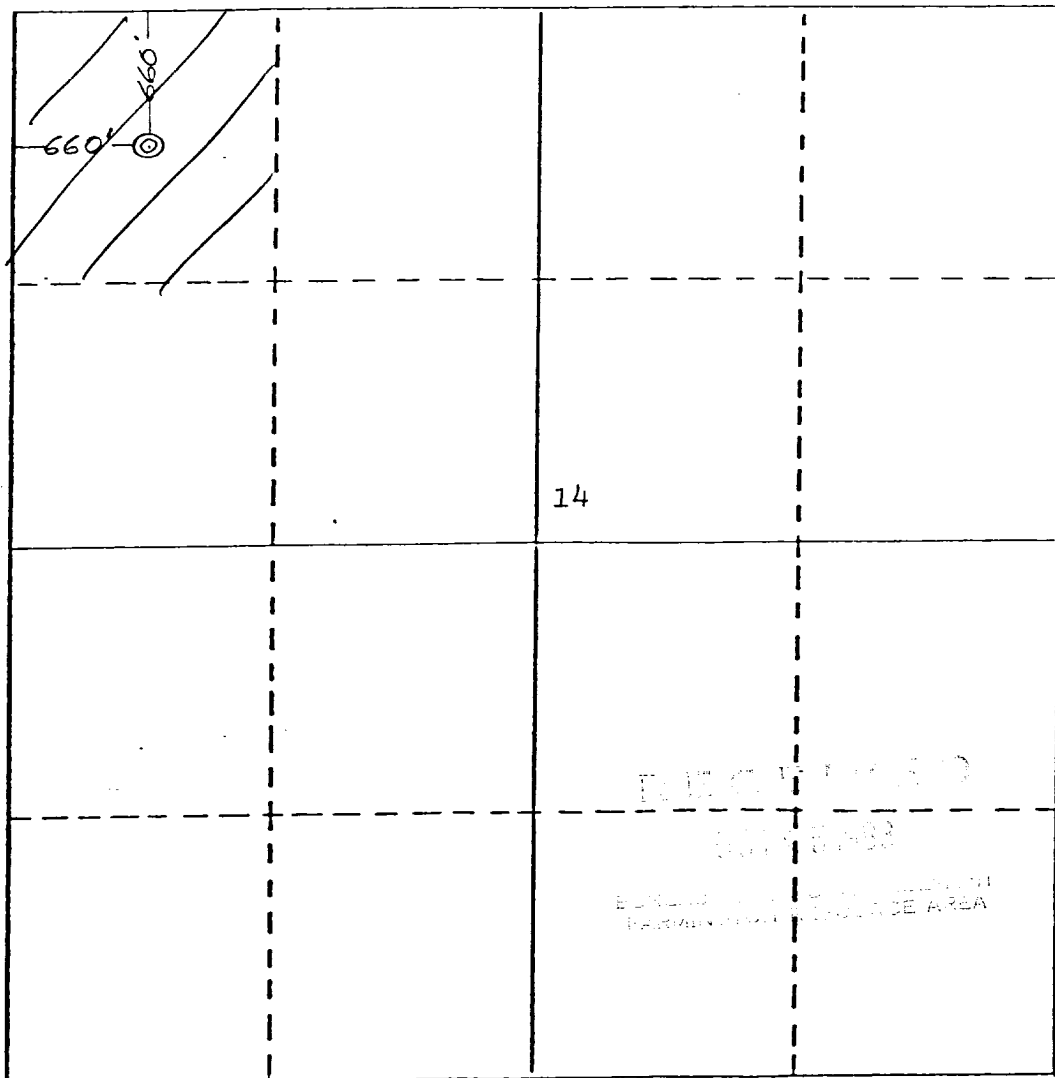

CERTIFICATION

I hereby certify that the information contained herein is true and complete to the best of my knowledge and belief.

Name *Neil Keller*  
Position *Agent*  
Company *Samuel Gary Oil Producer*  
Date *10-18-83*

I hereby certify that the location shown on this plat was plotted in the field and that the actual measurements made by me or under my supervision and that the same is true and correct to the best of my knowledge and belief.

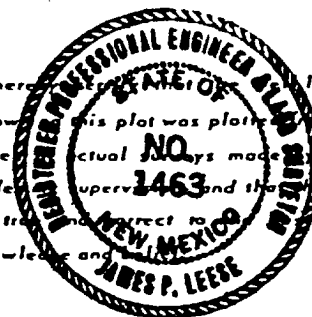

Date Surveyed *October 17, 1983*  
Registered Professional Engineer and/or Land Surveyor *James P. Leese*  
Certificate No. *1463*

