

UNITED STATES
DEPARTMENT OF THE INTERIOR
GEOLOGICAL SURVEY

30-043-20702

5. LEASE DESIGNATION AND SERIAL NO.
NM-38576

6. IF INDIAN, ALLOTTEE OR TRIBE NAME

7. UNIT AGREEMENT NAME

8. FARM OR LEASE NAME

9. WELL NO.
San Isidro 18-8

10. FIELD AND POOL, OR WILDCAT
Undesignated Gallup

11. SEC., T., R., M., OR BLM.
AND SURVEY OR AREA
SENE
NE NE Sec. 18-20N-3W

12. COUNTY OR PARISH
Sandoval

13. STATE
NM

APPLICATION FOR PERMIT TO DRILL, DEEPEN, OR PLUG BACK

1a. TYPE OF WORK
DRILL ☒ DEEPEN ☐ PLUG BACK ☐

b. TYPE OF WELL
OIL WELL ☒ GAS WELL ☐ OTHER ☐
SINGLE ZONE ☐ MULTIPLE ZONE ☐

2. NAME OF OPERATOR
Samuel Gary Oil Producers

3. ADDRESS OF OPERATOR
#4 Inverness Court East, Englewood, CO 80112-5599

4. LOCATION OF WELL (Report location clearly and in accordance with any State requirements.)
At surface
2015' FM & 695' FEL Sec. 18-20N-3W
At proposed prod. zone

14. DISTANCE IN MILES AND DIRECTION FROM NEAREST TOWN OR POST OFFICE*
Approximately 11 miles SE of Cuba, NM

15. DISTANCE FROM PROPOSED*
LOCATION TO NEAREST
PROPERTY OR LEASE LINE, FT.
(Also to nearest drig. unit line, if any)

16. NO. OF ACRES IN LEASE
2531.76

18. DISTANCE FROM PROPOSED LOCATION*
TO NEAREST WELL, DRILLING, COMPLETED,
OR APPLIED FOR, ON THIS LEASE, FT.

19. PROPOSED DEPTH
4400'

21. ELEVATIONS (Show whether DF, RT, GR, etc.)
6842' GR

17. NO. OF ACRES ASSIGNED
TO THIS WELL
40

20. ROTARY OR CABLE TOOLS
Rotary

22. APPROX. DATE WORK WILL START*
November 23, 1983

23. PROPOSED CASING AND CEMENTING PROGRAM

SIZE OF HOLE	SIZE OF CASING	WEIGHT PER FOOT	SETTING DEPTH	QUANTITY OF CEMENT
13 1/2"	9-5/8"	J-55 36#	200'	Cement to Surface
8-3/4"	7"	23# K-55	3700'	Determined by Caliper log
6"	4 1/2"	10.50	4400'	5 SX. Cmt.

Drill 13 1/2" Surface hole to 200'. Cmt. to surface. Drill 8-3/4" hole to 3700'. Cement thru Ojo Alamo. Run 7" 23 lb. K-55 LTC to TD. Cmt. with approximate 1000' fill. Run 4 1/2" producing csg. to 4400' + -.

Surface to be drilled with 9 lb. mud weight viscosity 45' to 200'. From 200' to TD will be drilled with air mist.

RECEIVED

NOV 30 1983

OIL CON. DIV.
DIST. 3

IN ABOVE SPACE DESCRIBE PROPOSED PROGRAM: If proposal is to deepen or plug back, give data on present productive zone and proposed new productive zone. If proposal is to drill or deepen directionally, give pertinent data on subsurface locations and measured and true vertical depths. Give blowout preventer program, if any.

24. SIGNED [Signature] TITLE Agent
(This space for Federal or State office use)

PERMIT NO. _____ APPROVAL DATE _____

APPROVED BY _____ TITLE _____
CONDITIONS OF APPROVAL, IF ANY:

APPROVED
DATE 10-17-83
AS AMENDED
NOV 29 1983
REST AREA MANAGER
FARMINGTON RESOURCE AREA

NM000

All distances must be from the outer boundaries of the Section.

Operator SAMUEL GARY OIL PRODUCER			Lease SAN ISIDRO 18		Well No. 18 8
Unit Letter H	Section 18	Township 20 NORTH	Range 3 WEST	County SANDOVAL	
Actual Footage Location of Well: 2015 feet from the NORTH line and 695 feet from the EAST line					
Ground Level Elev. 6831	Producing Formation <i>Undesignated Gullies</i>		Pool	Dedicated Acreage: 40 Acres	

1. Outline the acreage dedicated to the subject well by colored pencil or hatchure marks on the plat below.
2. If more than one lease is dedicated to the well, outline each and identify the ownership thereof (both as to working interest and royalty).
3. If more than one lease of different ownership is dedicated to the well, have the interests of all owners been consolidated by communitization, unitization, force-pooling, etc?

☐ Yes ☐ No If answer is "yes," type of consolidation _____

If answer is "no," list the owners and tract descriptions which have actually been consolidated. (Use reverse side of this form if necessary.) _____

No allowable will be assigned to the well until all interests have been consolidated (by communitization, unitization, forced-pooling, or otherwise) or until a non-standard unit, eliminating such interests, has been approved by the Division

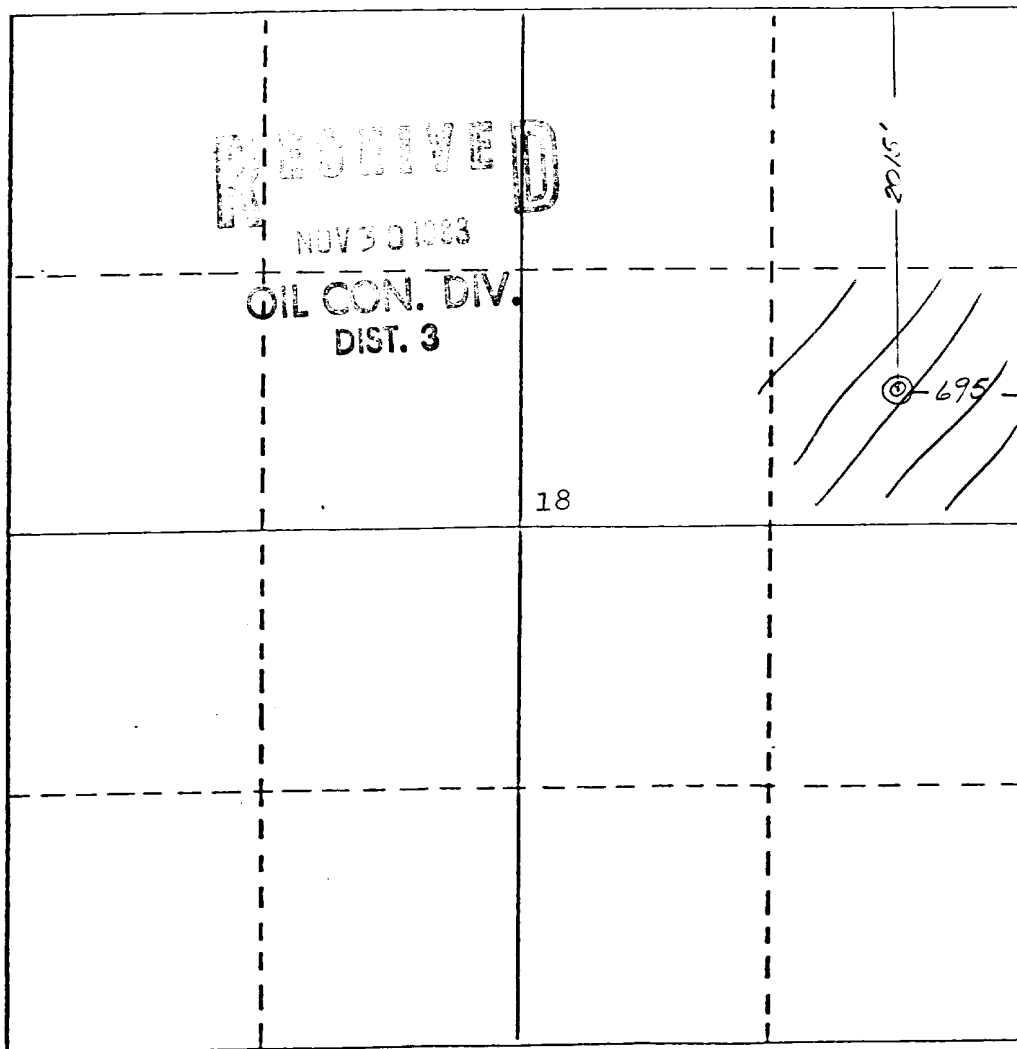

CERTIFICATION

I hereby certify that the information contained herein is true and complete to the best of my knowledge and belief.

Name *James P. Leese*
Position *Agent*
Company *Samuel Gary Oil Producer Inc*
Date *10-27-83*

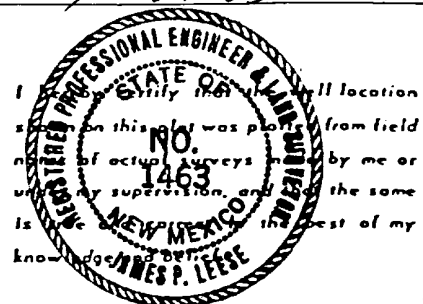

Date Surveyed
October 26, 1983

Registered Professional Engineer
and/or Land Surveyor
James P. Leese
James P. Leese

Certificate No.
1463

0 330 660 990 1320 1650 1980 2310 2640 2970 3300 3630 3960 4290 4620 4950 5280 5610 5940 6270 6600

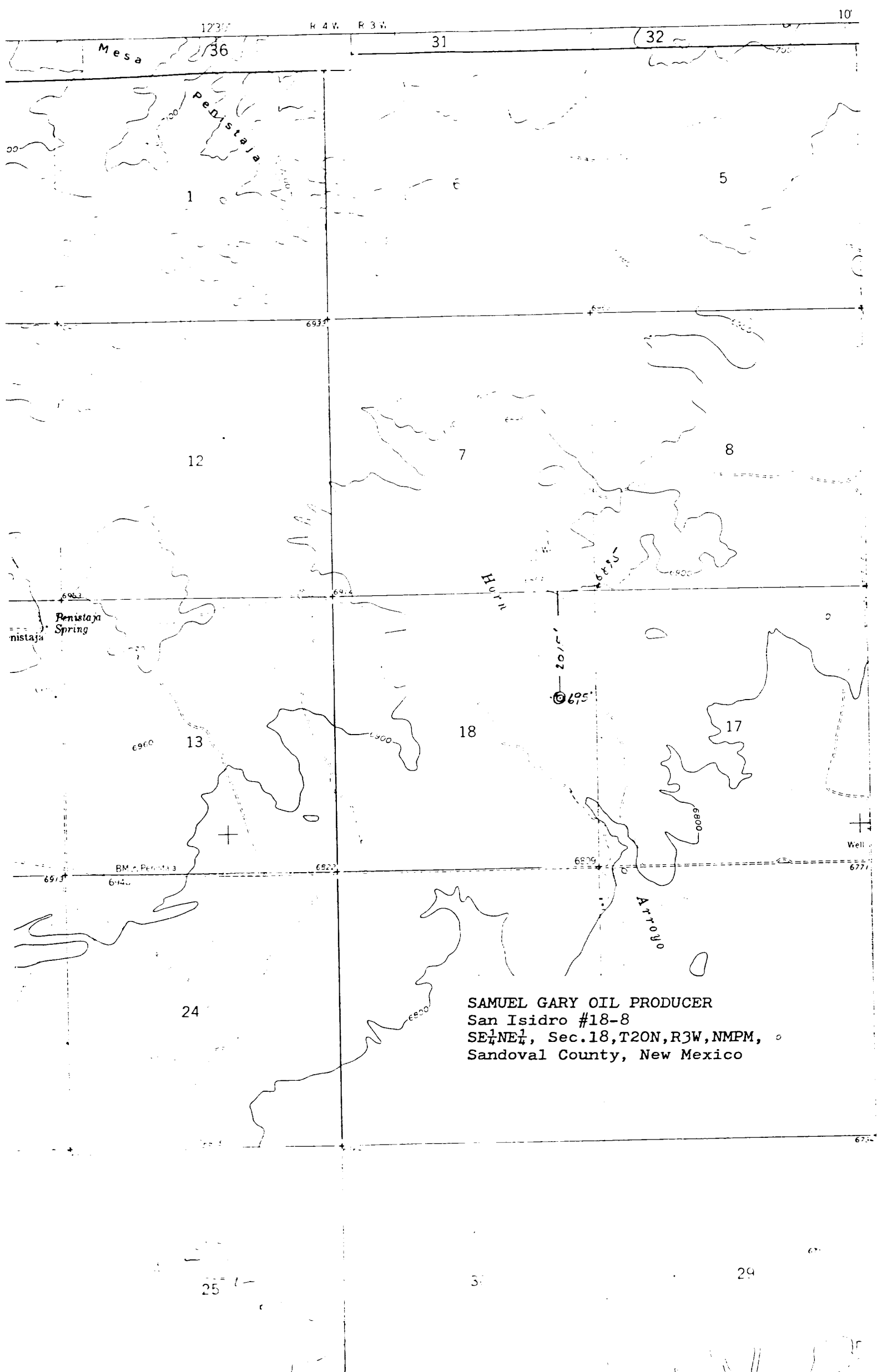

SAMUEL GARY OIL PRODUCER
San Isidro #18-8
SE $\frac{1}{4}$ NE $\frac{1}{4}$, Sec. 18, T20N, R3W, NMPM, Sandoval County, New Mexico