

UNITED STATES
DEPARTMENT OF THE INTERIOR
GEOLOGICAL SURVEY

30-043-20730

WM 2674

APPLICATION FOR PERMIT TO DRILL, DEEPEN, OR PLUG BACK

1. TYPE OF WELL DRILL <input checked="" type="checkbox"/> DEEPEN <input type="checkbox"/> PLUG BACK <input type="checkbox"/>		2. UNIT AGREEMENT NAME	
3. NAME OF OPERATOR Noarko Resources, Inc.		5. FARM OR LEASE NAME Lu Lu	
4. ADDRESS OF OPERATOR 1206 East 20th Street, Farmington, N. M. 87401		9. WELL NO. 6	
6. LOCATION OF WELL (Report location clearly and in accordance with any State requirements.) At surface 2070' FNL 660' FEL		10. FIELD AND POOL, OR WILDCAT Lybrook Gallup <i>est</i>	
7. DISTANCE IN MILES AND DIRECTION FROM NEAREST TOWN OR POST Approx. 1.5 miles (Counselors, N. M.)		11. SEC., T., R., M., OR BLE. AND SURVEY OR AREA H Sec. 29, T.23N, R.6W	
8. DISTANCE FROM PROPOSED LOCATION* TO NEAREST WELL, DRILLING, COMPLETED, OR APPLIED FOR, ON THIS LEASE, FT. 660'		12. COUNTY OR PARISH Sandoval	
9. DISTANCE FROM PROPOSED LOCATION* TO NEAREST WELL, DRILLING, COMPLETED, OR APPLIED FOR, ON THIS LEASE, FT. 1256'		13. STATE N.M.	
10. ELEVATIONS (Show whether DP, RT, GR, etc.) 7223 Ft. GR.		14. NO. OF ACRES IN LEASE 480	
11. DRILLING OPERATIONS AUTHORIZED ARE SUBJECT TO COMPLIANCE WITH ATTACHED "GENERAL REQUIREMENTS"		15. NO. OF ACRES ASSIGNED TO THIS WELL 40	
12. PROPOSED CASING AND CEMENTING PROGRAM		16. ROTARY OR CABLE TOOLS Rotary	
13. PROPOSED CASING AND CEMENTING PROGRAM		17. APPROX. DATE WORK WILL START* May 1984	
14. PROPOSED CASING AND CEMENTING PROGRAM		18. APPROX. DATE WORK WILL START* May 1984	
15. PROPOSED CASING AND CEMENTING PROGRAM		19. APPROX. DATE WORK WILL START* May 1984	
16. PROPOSED CASING AND CEMENTING PROGRAM		20. APPROX. DATE WORK WILL START* May 1984	
17. PROPOSED CASING AND CEMENTING PROGRAM		21. APPROX. DATE WORK WILL START* May 1984	
18. PROPOSED CASING AND CEMENTING PROGRAM		22. APPROX. DATE WORK WILL START* May 1984	
19. PROPOSED CASING AND CEMENTING PROGRAM		23. APPROX. DATE WORK WILL START* May 1984	
20. PROPOSED CASING AND CEMENTING PROGRAM		24. APPROX. DATE WORK WILL START* May 1984	

RECEIVED
APR 30 1984

This action is subject to administrative appeal pursuant to 30 CFR 290.

1. Drill 12-1/4" hole with rotary tools to approximately 250 feet and run new 8-5/8", 24#/ft casing. Cement casing with approximately 200 sacks Class B cement, circulating to surface.
2. Install BOP, test BOP and casing to 1000 psig.
3. Drill 7-7/8" hole to approximately 5900' with fresh water-gel mud.
4. Log well
5. Run and set approximately 5900", 5-1/2" casing and cement in two stages. Cement to cover Ojo Alamo.
6. Perforate and stimulate Gallup Formation. Clean up well and complete as required.

IN ABOVE SPACE DESCRIBE PROPOSED PROGRAM: If proposal is to deepen or plug back, give data on present productive zone and proposed new productive zone. If proposal is to drill or deepen directionally, give pertinent data on subsurface locations and measured and true vertical depths. Give blowout preventer program, if any.

SIGNED Ronnie W. Allen TITLE Geologist DATE 4-26-84
(This space for Federal or State office use)

PERMIT NO. _____ APPROVAL DATE _____

APPROVED BY _____

CONDITIONS OF APPROVAL, IF ANY:

RECEIVED
JUL 24 1984
OIL CON. DIV.
DIST. 3

APPROVED
AS AMENDED
JUL 20 1984
/s/ J. Stan McKee
AREA MANAGER
FARMINGTON RESOURCE AREA

WMOCC

NO. RESOURCES, INC.

Well Letter H	Section 29	Township 23 NORTH	Range 6 WEST	County SANDOVAL
------------------	---------------	----------------------	-----------------	--------------------

Actual Footage Location of Well:

2070	feet from the	NORTH	line and	660	feet from the	EAST	line
Ground Level Elev. 7223	Producing Formation Gallup		Pool Lybrook Gallup		Dedicated Acreage: 40		Acre

1. Outline the acreage dedicated to the subject well by colored pencil or hachure marks on the plat below.
2. If more than one lease is dedicated to the well, outline each and identify the ownership thereof (both as to working interest and royalty).
3. If more than one lease of different ownership is dedicated to the well, have the interests of all owners been consolidated by communitization, unitization, force-pooling, etc?

☐ Yes ☐ No If answer is "yes," type of consolidation _____

If answer is "no," list the owners and tract descriptions which have actually been consolidated. (Use reverse side of this form if necessary.) _____

No allowable will be assigned to the well until all interests have been consolidated (by communitization, unitization, forced-pooling, or otherwise) or until a non-standard unit, eliminating such interests, has been approved by the Division.

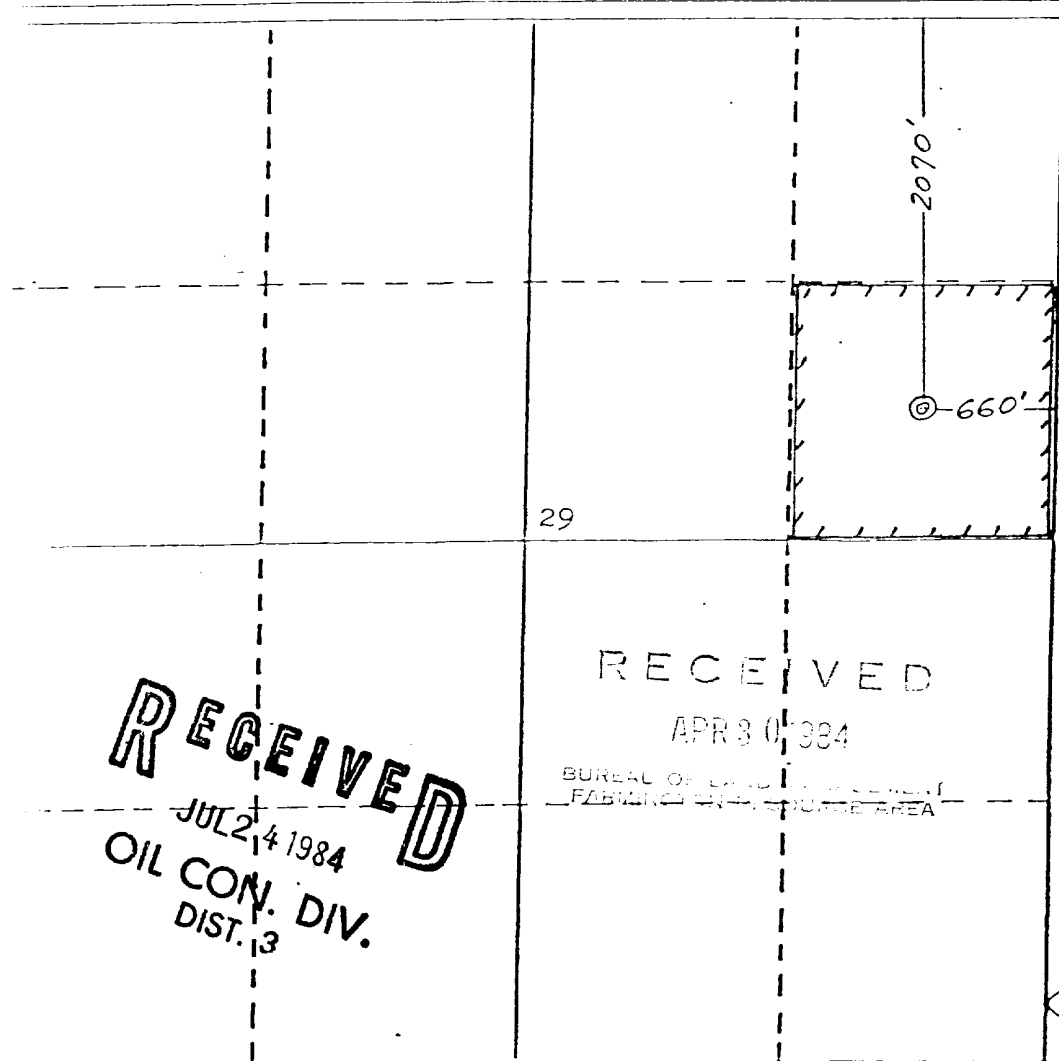

RECEIVED
JUL 24 1984
OIL CON. DIV.
DIST. 13

RECEIVED
APR 30 1984

BUREAU OF LAND MANAGEMENT
FABIAN COUNTY, NEW MEXICO

CERTIFICATION

I hereby certify that the information contained herein is true and complete to the best of my knowledge and belief.

Ronnie W. Allen
Name Ronnie W. Allen
Geologist
Position
Noarko Resources, Inc.
Company
April 26, 1984
Date

I hereby certify that the location shown on this plat was plotted from field notes, actual surveys made by me or under my supervision, and that the same is true and correct to the best of my knowledge and belief.

James P. Leese
JAMES P. LEESE
REGISTERED PROFESSIONAL ENGINEER & SURVEYOR
STATE OF NEW MEXICO
NO. 4503

Date Surveyed
April 19, 1984
Registered Professional Engineer and/or Land Surveyor
James P. Leese
James P. Leese

Certificate No.
1463

