

30-043-20747
Form approved.
Budget Bureau No. 1004-0136
Expires August 31, 1985

UNITED STATES
DEPARTMENT OF THE INTERIOR
BUREAU OF LAND MANAGEMENT

APPLICATION FOR PERMIT TO DRILL, DEEPEN, OR PLUG BACK

1a. TYPE OF WORK DRILL ☒ DEEPEN ☐ PLUG BACK ☐

D. TYPE OF WELL

OIL WELL <input checked="" type="checkbox"/>	GAS WELL <input type="checkbox"/>	OTHER <input type="checkbox"/>	SINGLE ZONE <input type="checkbox"/>	MULTIPLE ZONE <input type="checkbox"/>
--	-----------------------------------	--------------------------------	--------------------------------------	--

2. NAME OF OPERATOR
Champlin Petroleum Company

3. ADDRESS OF OPERATOR
P. O. Box 1257, Englewood, CO 80150

4. LOCATION OF WELL (Report location clearly and in accordance with any State requirements.)
At surface SESW (660' FSL & 1980' FWL)
At proposed prod. zone

14. DISTANCE IN MILES AND DIRECTION FROM NEAREST TOWN OR POST OFFICE 9 miles

BLM Road 1104, then west 3 miles on Seismograph Trail, and north		
10. DISTANCE FROM PROPOSED*	660' into location.	10. NO. OF ACRES IN LEASE
		17. N

LOCATION TO NEAREST PROPERTY OR LEASE LINE, FT. (Also to nearest drlg. unit line, if any)	660'	320	3
19. DISTANCE FROM PROPOSED LOCATION*		19. PROPOSED DEPTH	20. H

TO NEAREST WELL, DRILLING, COMPLETED, OR APPLIED FOR, ON THIS LEASE, FT.	3300'	4900'	0-
---	-------	-------	----

ALL OPERATIONS AUTHORIZED ARE 6466' GR, 6476' KB
SUBJECT TO COMPLIANCE WITH ATTACHED

GENERAL REQUIREMENTS					PROPOSED CASING AND CEMENTING PROGRAM	This
SIZE OF HOLE	SIZE OF CASING	WEIGHT PER FOOT	SETTING DEPTH		app	

12 $\frac{1}{4}$ "	9-5/8"	36#	500'	420 2%
--------------------	--------	-----	------	-----------

8-3/4"	7"	32#/26#	4100'	441
--------	----	---------	-------	-----

" B "

Upe

6-1/8-6-1/4"	4-1/2"	11.6#	4900'	To
--------------	--------	-------	-------	----

Drill 12 $\frac{1}{4}$ " hole to 500'. Set 9-5/8" casing and cement to surfa

casing & BOP before drilling out. BOP to be operated each day 8-3/4" hole to approximately 4100'. Set 7" casing and cement.

6-1/8" or 6-1/4" hole to approximately 4900'. In the event of casing will be run and cemented to 500' above uppermost product

will be tested.

AN AGENCY MUST DESCRIBE PROPOSED PROGRAM: If proposal is to deepen or plug back, give data on present

IN ABOVE SPACE DESCRIBE PROPOSED PROGRAM FOR PREVENTING CONTAMINATION OF AQUIFER ZONE. IF PROPOSAL IS TO DRILL OR DEEPEN DIRECTIONALLY, GIVE PERTINENT DATA ON SUBSURFACE LOCATIONS AND MEANS FOR PREVENTING CONTAMINATION OF AQUIFER ZONE.

34. James I. Rhoades Sr. Engineering Aide

SIGNED Ramona J. Rios
(This space for Federal or State Use)

PERMIT NO. _____ APPROVAL DATE _____

APPROVED BY _____ TITLE _____

CONDITIONS OF APPROVAL, IF ANY :
 7
 OIL
 DIST. 3
 NMCC

See ***See Instructions On Reverse Side**

Title 18 U.S.C. Section 1001, makes it a crime for any person knowingly and willfully to make to United States any false, fictitious or fraudulent statements or representations as to any matter w

5. LEASE DESIGNATION AND SERIAL NO.
NM 39532

6. IF INDIAN, ALLOTTEE OR TRIBE NAME

7. UNIT AGREEMENT NAME

8. FARM OR LEASE NAME
Federal 24-2

9. WELL NO.
2

10. FIELD AND POOL, OR WILDCAT
Rio Puerco - Mancos ~~Cal~~

☒ D. SEC., T., R., M., OR BLK.
AND SURVEY OR AREA
Section 2-T20N-R3W

12. COUNTY OR PARISH
Sandoval

13. STATE
New Mexico

OF ACRES ASSIGNED
THIS WELL
(W/2 of Section 2) 30.1

ARY OR CABLE TOOLS

Rotary

22. APPROX. DATE WORK WILL START
Upon approval

ction is subject to administrative
pursuant to 30 CFR 290.

CF "B" w/1/4#/sx Flocele &
CL2.

CF 50-50 Poz w/2% Gel, 6 1/2"
onite, 1/4#/sx Flocele & 190
eat w/1/4#/sx Flocele, 2% C
DV & cmt w/567 CF 50-50 F

e determined from Caliper

e. WOC 12 hours, test sur
fter drilling out. Drill
WOC 24 hours. Air drill
mmercial production, 4 1/2"
ve zone. All shows of oil

ductive zone and proposed new productivity
ed and true vertical depths. Give blowout

APPROVED
DATE 12-14-34

AS AMENDED
DEC 14 1934
J. Stan McKee
DATE

ASST. AREA MANAGER
ARMINGTON RESOURCE AREA

***See Instructions On Reverse Side**

Title 18 U.S.C. Section 1001, makes it a crime for any person knowingly and willfully to make to any department or agency of the United States any false, fictitious or fraudulent statements or representations as to any matter within its jurisdiction.

All distances must be from the outer boundaries of the Section.

Operator CHAMPLIN PETROLEUM COMPANY			Lease FEDERAL 24-2		Well No. 2
Unit Letter N	Section 2	Township 20N	Range 3W	County Sandoval	
Actual Footage Location of Well: 660 feet from the South line and 1980 feet from the West line					
Ground Level Elev: 6931	Producing Formation Morone	Pool Rio Puer	Dedicated Acreage: 301.36 Acres		

1. Outline the acreage dedicated to the subject well by colored pencil or hachure marks on the plat below.
2. If more than one lease is dedicated to the well, outline each and identify the ownership thereof (both as to working interest and royalty).
3. If more than one lease of different ownership is dedicated to the well, have the interests of all owners been consolidated by communitization, unitization, force-pooling, etc?

☐ Yes ☐ No If answer is "yes," type of consolidation _____

If answer is "no," list the owners and tract descriptions which have actually been consolidated. (Use reverse side of this form if necessary.) _____

No allowable will be assigned to the well until all interests have been consolidated (by communitization, unitization, forced-pooling, or otherwise) or until a non-standard unit, eliminating such interests, has been approved by the Commission.

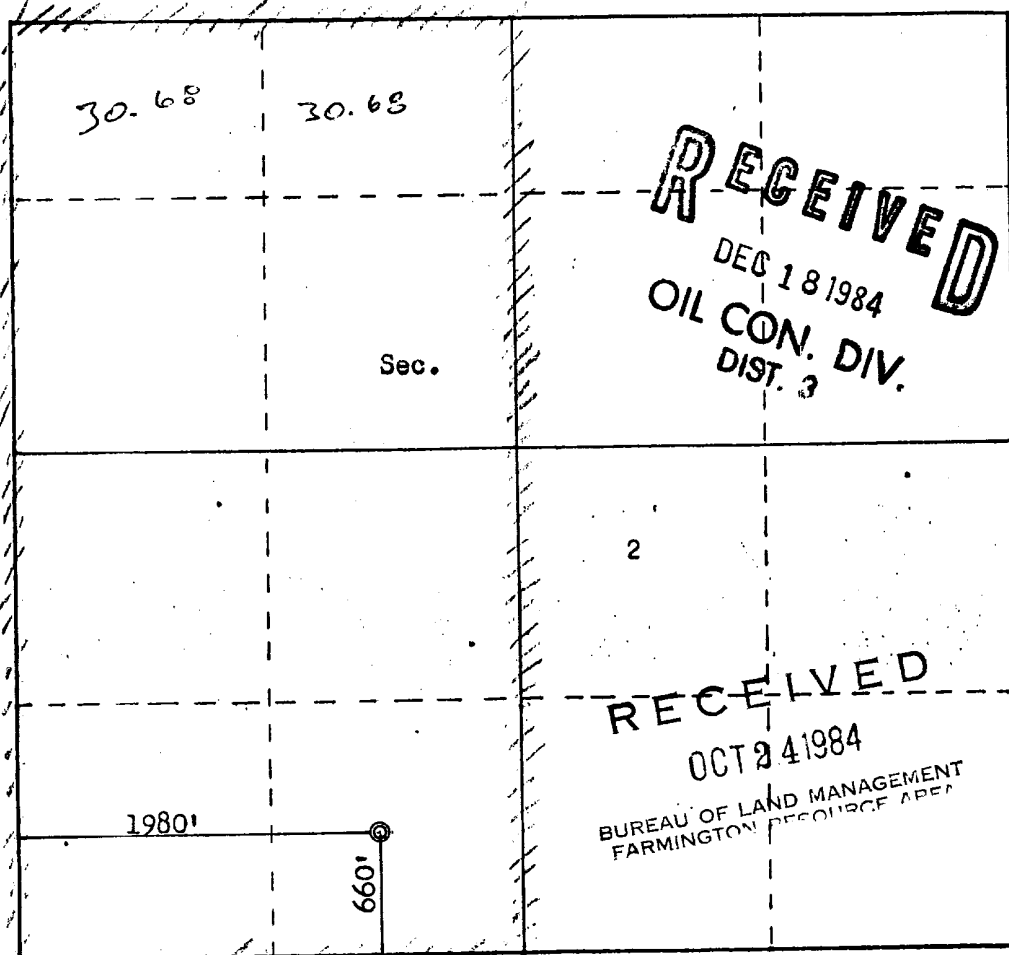

CERTIFICATION

I hereby certify that the information contained herein is true and complete to the best of my knowledge and belief.

R. A. Scott
Name
X R. A. Scott
Position
Regional Drilling Manager
Company
Champlin Petroleum Co.
Date
12-27-84

I hereby certify that the well location shown on this plat was plotted from field notes of actual surveys made by me or under my supervision, and that the same is true and correct to the best of my knowledge and belief.

Date Surveyed
October 6, 1984
Registered Professional Engineer and Land Surveyor
Fred B. Kerr Jr.
Fred B. Kerr Jr.
Certificate No. 3950

EXHIBIT II
UNITED STATES
DEPARTMENT OF THE INTERIOR
GEOLOGICAL SURVEY

309000m. E.

