

OIL CONSERVATION DIVISION

P. O. BOX 2088

SANTA FE, NEW MEXICO 87501

Form C-101
Revised 10-1-78

5A. Indicate Type of Lease

STATE ☒ FEE ☐

5. State Oil & Gas Lease No.

LG 3924 3

7. Unit Agreement Name

Alamito Unit

8. Farm or Lease Name

9. Well No.

2

10. Field and Pool, or Wildcat

Alamito Gallup

12. County

Sandoval

19. Proposed Depth

5100

19A. Formation

Gallup

20. Rotary or C.T.

Rotary

21. Elevations (Show whether DF, RT, etc.)

6820GR

21A. Kind & Status Plug. Bond

\$50,000 statewide bond on file with OCD

21B. Drilling Contractor

Walters Drilling

22. Approx. Date Work will start

August 10, 1987

PROPOSED CASING AND CEMENT PROGRAM

SIZE OF HOLE	SIZE OF CASING	WEIGHT PER FOOT	SETTING DEPTH	SACKS OF CEMENT	EST. TOP
12-1/4	8-5/8 new	23.0	200	195 150	Circulate
7-7/8	4-1/2 new	11.6	5100	1000	Circulate

Propose to drill 12-1/4" hole approximately 200' and run approximately 200' of 8-5/8" casing which will be cemented with approximately 150 sacks of cement. We will drill 7-7/8" hole to approximately 5100'. Intend to run Induction Electric Gamma Log and Density Neutron Log. Will cement approximately 1000 sacks of cement. Will perforate and frac Gallup formation as determined after reviewing logs. We may delay completion until Spring 1988. Attached is a copy of a topographic map showing the approximate location of the well.

APPROVAL EXPIRES 1-20-88
UNLESS DRILLING IS COMMENCED.
SPUD NOTICE MUST BE SUBMITTED
WITHIN 10 DAYS.

RECEIVED
JUL 20 1987
OIL CON. DIV.
DIST. 3

IN ABOVE SPACE DESCRIBE PROPOSED PROGRAM; IF PROPOSAL IS TO DEEPEN OR PLUG BACK, GIVE DATA ON PRESENT PRODUCTIVE ZONE AND PROPOSED NEW PRODUCTIVE ZONE. GIVE BLOWOUT PREVENTER PROGRAM, IF ANY.

I hereby certify that the information above is true and complete to the best of my knowledge and belief.

Signed Elizabeth B. Keeshan Title Vice President Date July 17, 1987

(This space for State Use)

APPROVED BY Eric R. Busch TITLE DEPUTY OIL & GAS INSPECTOR, DIST. #3 DATE JUL 20 1987

CONDITIONS OF APPROVAL, IF ANY:

All distances must be from the outer boundaries of the Section.

Operator BCO, Inc.		Lease Alamito Unit			Well No. 2
Unit Letter N	Section 32	Township 23 North	Range 7 West	County Sandoval	
Actual Footage Location of Well: 770 feet from the South line and 1820 feet from the West line					
Ground Level Elev. 6820	Producing Formation Gallup		Pool Alamito Gallup		Dedicated Acreage: 40 Acres

1. Outline the acreage dedicated to the subject well by colored pencil or hachure marks on the plat below.
2. If more than one lease is dedicated to the well, outline each and identify the ownership thereof (both as to working interest and royalty).
3. If more than one lease of different ownership is dedicated to the well, have the interests of all owners been consolidated by communitization, unitization, force-pooling, etc?

☐ Yes ☐ No If answer is "yes," type of consolidation _____

If answer is "no," list the owners and tract descriptions which have actually been consolidated. (Use reverse side of this form if necessary.) _____

No allowable will be assigned to the well until all interests have been consolidated (by communitization, unitization, forced-pooling, or otherwise) or until a non-standard unit, eliminating such interests, has been approved by the Division.

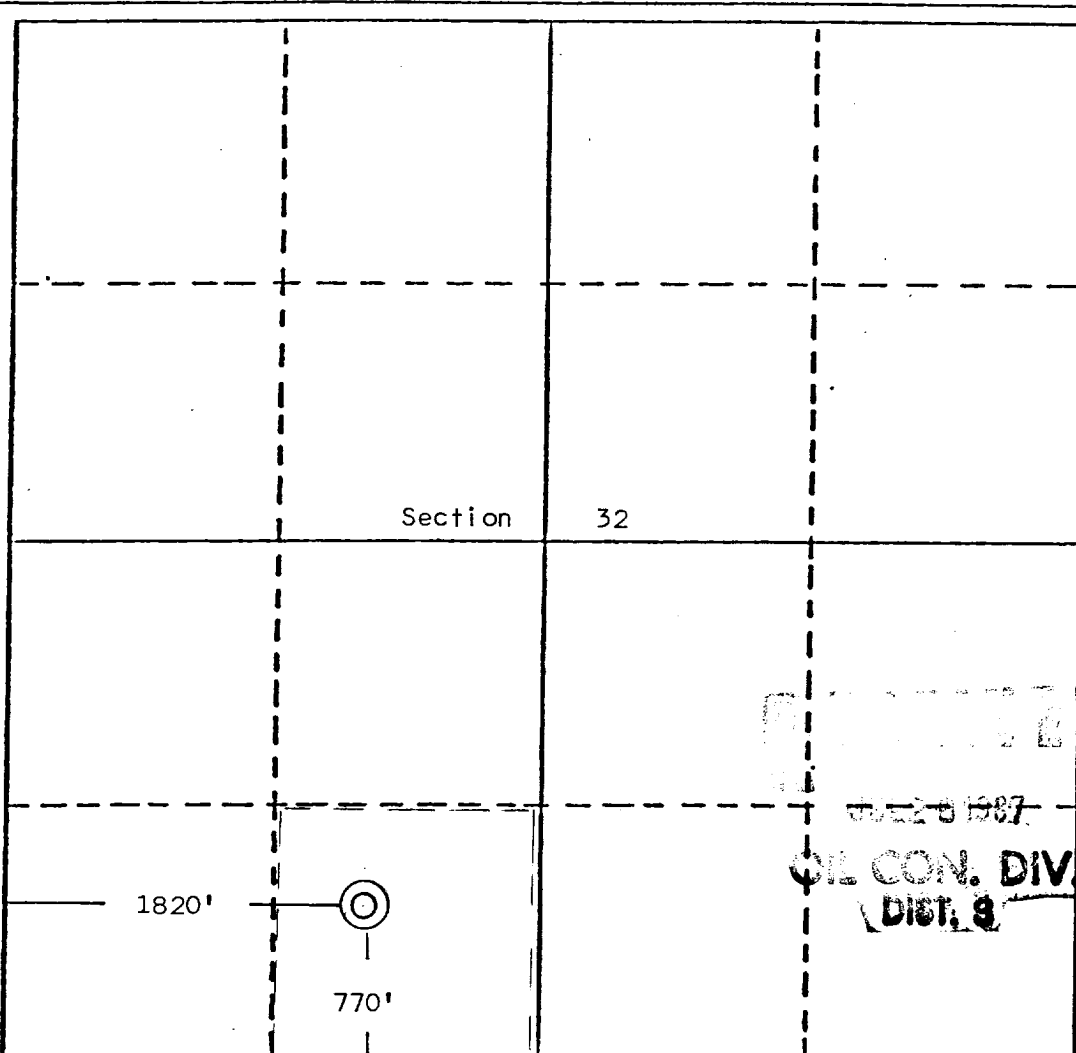

CERTIFICATION

I hereby certify that the information contained herein is true and complete to the best of my knowledge and belief.

Elizabeth B. Keeshan

Name
Elizabeth B. Keeshan

Position
Vice President

Company
BCO, Inc.

Date
July 16, 1987

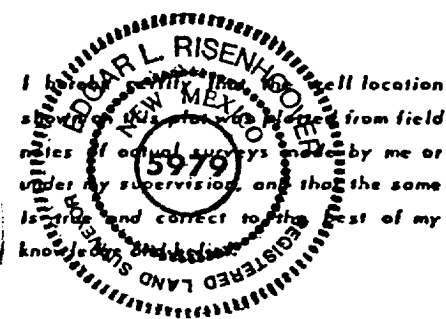

Date Surveyed
July 9, 1987

Registered Professional Engineer
and/or Land Surveyor

Edgar L. Risenhoover

Certificate No. 5979

Edgar L. Risenhoover, L.S.

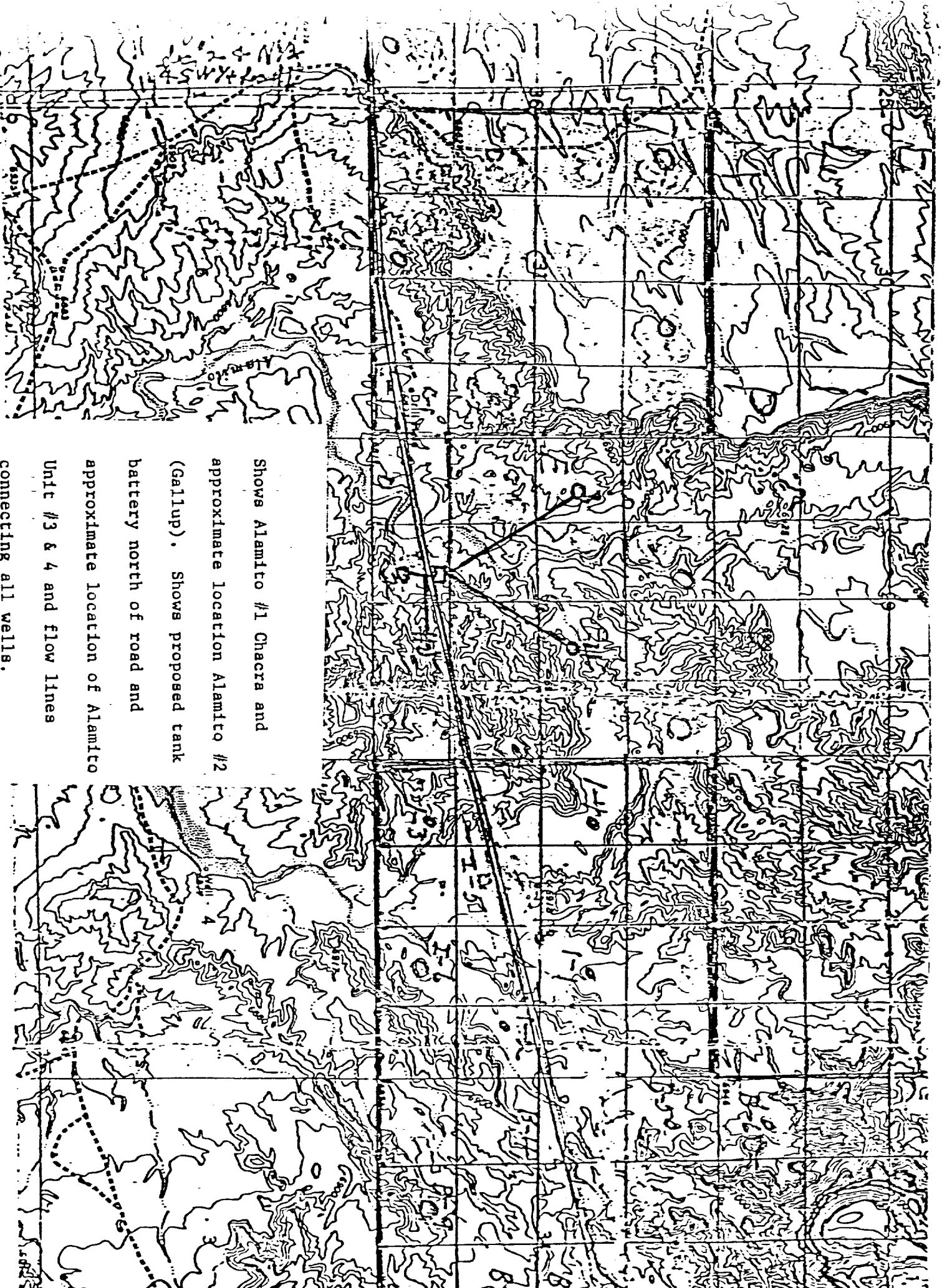

Shows Alamito #1 Chacra and
approximate location Alamito #2
(Gallup). Shows proposed tank
battery north of road and
approximate location of Alamito
Unit #3 & 4 and flow lines
connecting all wells.
Section 32 T23N R7W MPM