

UNITED STATES
DEPARTMENT OF THE INTERIOR

BUREAU OF LAND MANAGEMENT

30-043-20892

APPLICATION FOR PERMIT TO DRILL, DEEPEN, OR PLUG BACK

1a. TYPE OF WORK ☒ DRILL ☐ DEEPEN ☐ PLUG BACK

b. TYPE OF WELL
OIL WELL ☐ GAS WELL ☒ OTHER ☐
SINGLE ZONE ☐ MULTIPLE ZONE ☐

2. NAME OF OPERATOR

Robert L. Bayless 19418

3. ADDRESS OF OPERATOR

PO Box 168 Farmington, NM 87499-0168

4. LOCATION OF WELL (Report location clearly and in accordance with any State requirements.)

At surface
990' FSL & 1850' FEL
At proposed prod. zone

14. DISTANCE IN MILES AND DIRECTION FROM NEAREST TOWN OR POST OFFICE*

10. DISTANCE FROM PROPOSED* LOCATION TO NEAREST PROPERTY OR LEASE LINE, FT. (Also to nearest dirg. unit line, if any)

18. DISTANCE FROM PROPOSED LOCATION* TO NEAREST WELL, DRILLING, COMPLETED, OR APPLIED FOR, ON THIS LEASE, FT.

21. ELEVATIONS (Show whether DF, RT, GR, etc.)

7246 GL

23. PROPOSED CASING AND CEMENTING PROGRAM

SIZE OF HOLE	SIZE OF CASING	WEIGHT PER FOOT	SETTING DEPTH	QUANTITY OF CEMENT
12 1/4	8 5/8	24.0	100	41 ft
7 7/8	4 1/2	10.5	3025	689 ft

Will drill 12 1/4" hole to 100 ft. and set 100 ft. of 8 5/8" 24.0#/ft J-55 used casing with 41 ft³ Class B cement, circulated to surface. Will drill 7 7/8" hole to 3025 ft. and set 3025 ft. 4 1/2" 10.5#/ft J-55 new casing and cement with 689 ft³ cement, circulated to surface. Circulating medium will be clear water, natural mud, and water loss additives. No abnormal pressures or temperatures are anticipated. Induction and density logs will be run. Blowout preventor schematic is attached. The gas from this well is not dedicated.

Formation Tops

Ojo Alamo 2490
Fruitland 2700
Pictured Cliffs 2846

IN ABOVE SPACE DESCRIBE PROPOSED PROGRAM: If proposal is to deepen or plug back, give data on present productive zone and proposed new productive zone. If proposal is to drill or deepen directionally, give pertinent data on subsurface locations and measure true vertical depths. Give blowout preventer program, if any.

24. SIGNED Price M. Bayless TITLE Petroleum Engineer DATE April 6, 1993

(This space for Federal or State office use)

PERMIT NO. APPROVAL DATE

APPROVED BY SHIRLEY MONDY TITLE AREA MANAGER DATE MAY 05 1993
CONDITIONS OF APPROVAL, IF ANY: RIO PUERCO RESERVOIR AREA

*See Instructions On Reverse Side

Title 18 U.S.C. Section 1001, makes it a crime for any person knowingly and willfully to make to any department or agency of the United States any false, fictitious or fraudulent statements or representations as to any matter within its jurisdiction.

NMOCD

RECEIVED
MAY 10 1993
OIL CON. DIV.
DIST. 3

Submit to Appropriate
District Office
State Lease - 4 copies
Fee Lease - 3 copies

State of New Mexico
Energy, Minerals and Natural Resources Department

Form C-102
Revised 1-1-89

OIL CONSERVATION DIVISION

P.O. Box 2088

Santa Fe, New Mexico 87504-2088

DISTRICT I

P.O. Box 1980, Hobbs, NM 88240

DISTRICT II

P.O. Drawer DD, Artesia, NM 88210

DISTRICT III

1000 Rio Brazos Rd., Aztec, NM 87410

WELL LOCATION AND ACREAGE DEDICATION PLAT

All Distances must be from the outer boundaries of the section

Operator ROBERT L. BAYLESS			Lease APACHE BEND		Well No. 6
Unit Letter 0	Section 30	Township 23 N	Range 2 W	County Sandoval	
Actual Footage Location of Well: 990 feet from the South line and 1850 feet from the East line					
Ground level Elev. 7246	Producing Formation Pictured Cliffs		Pool Ballard Pictured Cliffs	Dedicated Acreage: 160 Acres	
<p>1. Outline the acreage dedicated to the subject well by colored pencil or hatchure marks on the plat below.</p> <p>2. If more than one lease is dedicated to the well, outline each and identify the ownership thereof (both as to working interest and royalty).</p> <p>3. If more than one lease of different ownership is dedicated to the well, have the interest of all owners been consolidated by communitization, unitization, force-pooling, etc.? <input type="checkbox"/> Yes <input type="checkbox"/> No If answer is "yes" type of consolidation _____</p> <p>If answer is "no" list the owners and tract descriptions which have actually been consolidated. (Use reverse side of this form if necessary.) _____</p> <p>No allowable will be assigned to the well until all interests have been consolidated (by communitization, unitization, forced-pooling, or otherwise) or until a non-standard unit, eliminating such interest, has been approved by the Division.</p>					

0 330 660 990 1320 1650 1980 2310 2640 2000 1500 1000 500 0

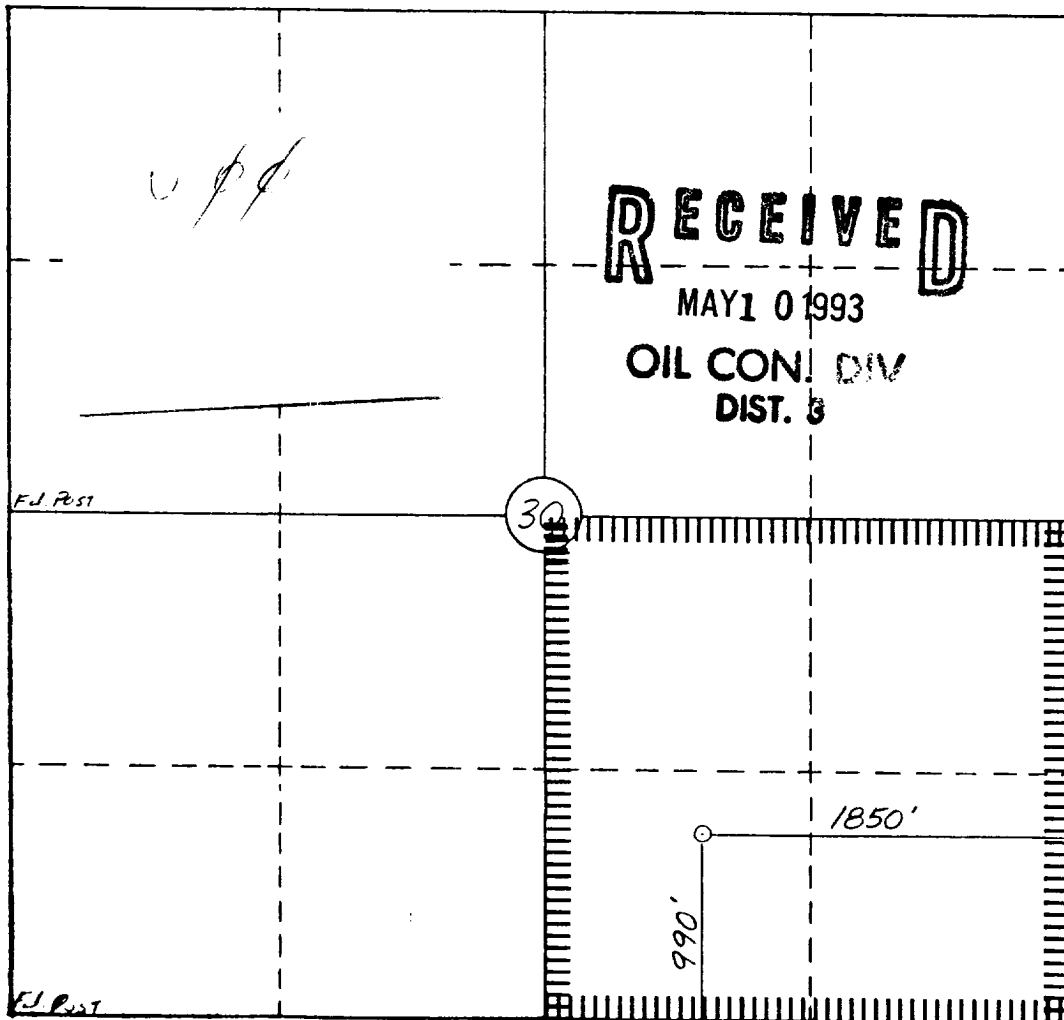

OPERATOR CERTIFICATION

I hereby certify that the information contained herein is true and complete to the best of my knowledge and belief.

Signature

[Signature]

Printed Name

Price M. Bayless

Position

Petroleum Engineer

Company

Robert L. Bayless

Date

April 6, 1993

SURVEYOR CERTIFICATION

I hereby certify that the well location shown on this plat was plotted from field notes of actual surveys made by me or under my supervision, and that the same is true and correct to the best of my knowledge and belief.

24 Mar., 1993

Date Surveyed

William E. Mahnke II

Signature & Seal of Professional Surveyor

WILLIAM E. MAHNKE II
NEW MEXICO
#8466
PROFESSIONAL LAND SURVEYOR

ROBERT L. BAYLESS
 APACHE BEND #6
 990' FSL & 1850' FEL
 Sec. 30, T23N, R2W
 Sandoval Co., N.M.