

UNITED STATES
DEPARTMENT OF THE INTERIOR
BUREAU OF LAND MANAGEMENT

APPLICATION FOR PERMIT TO DRILL OR DEEPEN

1a. TYPE OF WORK

DRILL ☒

DEEPEN ☐

b. TYPE OF WELL

OIL
WELL ☒

GAS
WELL ☐

OTHER

SINGLE
ZONE ☒

MULTIPLE
ZONE ☐

2. NAME OF OPERATOR

COULTHURST MANAGEMENT & INVESTMENTS INC. 5337

3. ADDRESS AND TELEPHONE NO.

1990 MARIN AVE. BERKELEY CA. 94707 510-415-527-2659

4. LOCATION OF WELL (Report location clearly and in accordance with any State requirements.)

At surface
990' FSL, 2310' FEL, Sec 28 T18N, R3W
At proposed prod. zone

Cretaceous Menefee

14. DISTANCE IN MILES AND DIRECTION FROM NEAREST TOWN OR POST OFFICE*

3 mi South of Torreon Navajo Mission

15. DISTANCE FROM PROPOSED*

LOCATION TO NEAREST
PROPERTY OR LEASE LINE, FT.
(Also to nearest drlg. unit line, if any) 990'

16. NO. OF ACRES IN LEASE

1202

17. NO. OF ACRES ASSIGNED
TO THIS WELL

10 40

18. DISTANCE FROM PROPOSED LOCATION*
TO NEAREST WELL, DRILLING, COMPLETED,
OR APPLIED FOR, ON THIS LEASE, FT.

660'

19. PROPOSED DEPTH

750' 720

20. ROTARY OR CABLE TOOLS

ROTARY

21. ELEVATIONS (Show whether DF, RT, GR, etc.)

6505.8 GR

6507

22. APPROX. DATE WORK WILL START*

JUNE 1, 1993

PROPOSED CASING AND CEMENTING PROGRAM

SIZE OF HOLE	GRADE SIZE OF CASING	WEIGHT PER FOOT	SETTING DEPTH	QUANTITY OF CEMENT
10 5/8"	J-55 8 5/8"	24#	.80' 120'	21 Sacks
6 3/4"	J-55 4 1/2"	9.5#	720'	120 Sacks

RECEIVED

JUN 4 1993

OIL CON. DIV.
DIST. 3

IN ABOVE SPACE DESCRIBE PROPOSED PROGRAM: If proposal is to deepen, give data on present productive zone and proposed new productive zone. If proposal is to drill or deepen directionally, give pertinent data on subsurface locations and measured and true vertical depths. Give blowout preventer program, if any.

24.

SIGNED

TITLE

AGENT

DATE

MAY 4, 1993

(This space for Federal or State office use)

PERMIT NO.

APPROVAL DATE

Application approval does not warrant or certify that the applicant holds legal or equitable title to those rights in the subject lease which would entitle the applicant to conduct operations thereon.
CONDITIONS OF APPROVAL, IF ANY:

APPROVED BY

SHIRLEY MONDY

Acting AREA MANAGER

TITLE

RIO PUECO RESOURCE AREA

DATE

MAY 28 1993

*See Instructions On Reverse Side

NMOCD

Title 18 U.S.C. Section 1001, makes it a crime for any person knowingly and willfully to make to any department or agency of the United States any false, fictitious or fraudulent statements or representations as to any matter within its jurisdiction.

**NEW MEXICO OIL CONSERVATION COMMISSION
WELL LOCATION AND ACREAGE DEDICATION PLAT**

Form C-102
Supersedes C-128
Effective 1-1-65

All distances must be from the outer boundaries of the Section.

Operator COULTHURST MGMT. & INVEST.			Lease JENNY		Well No. 1
Unit Letter 0	Section 28	Township 18N	Range 3W	County SANDOVAL	
Actual Footage Location of Well: 990 feet from the SOUTH line and 2310 feet from the EAST line					
Ground Level Elev. 6506.8	Producing Formation MENEFE		Pool SOUTHSAN LUIS	Dedicated Acreage: 40 Acres	

0

1. Outline the acreage dedicated to the subject well by colored pencil or hachure marks on the plat below.
2. If more than one lease is dedicated to the well, outline each and identify the ownership thereof (both as to working interest and royalty).
3. If more than one lease of different ownership is dedicated to the well, have the interests of all owners been consolidated by communitization, unitization, force-pooling, etc?

☐ Yes ☐ No If answer is "yes," type of consolidation _____

If answer is "no," list the owners and tract descriptions which have actually been consolidated. (Use reverse side of this form if necessary.) _____

No allowable will be assigned to the well until all interests have been consolidated (by communitization, unitization, forced-pooling, or otherwise) or until a non-standard unit, eliminating such interests, has been approved by the Commission.

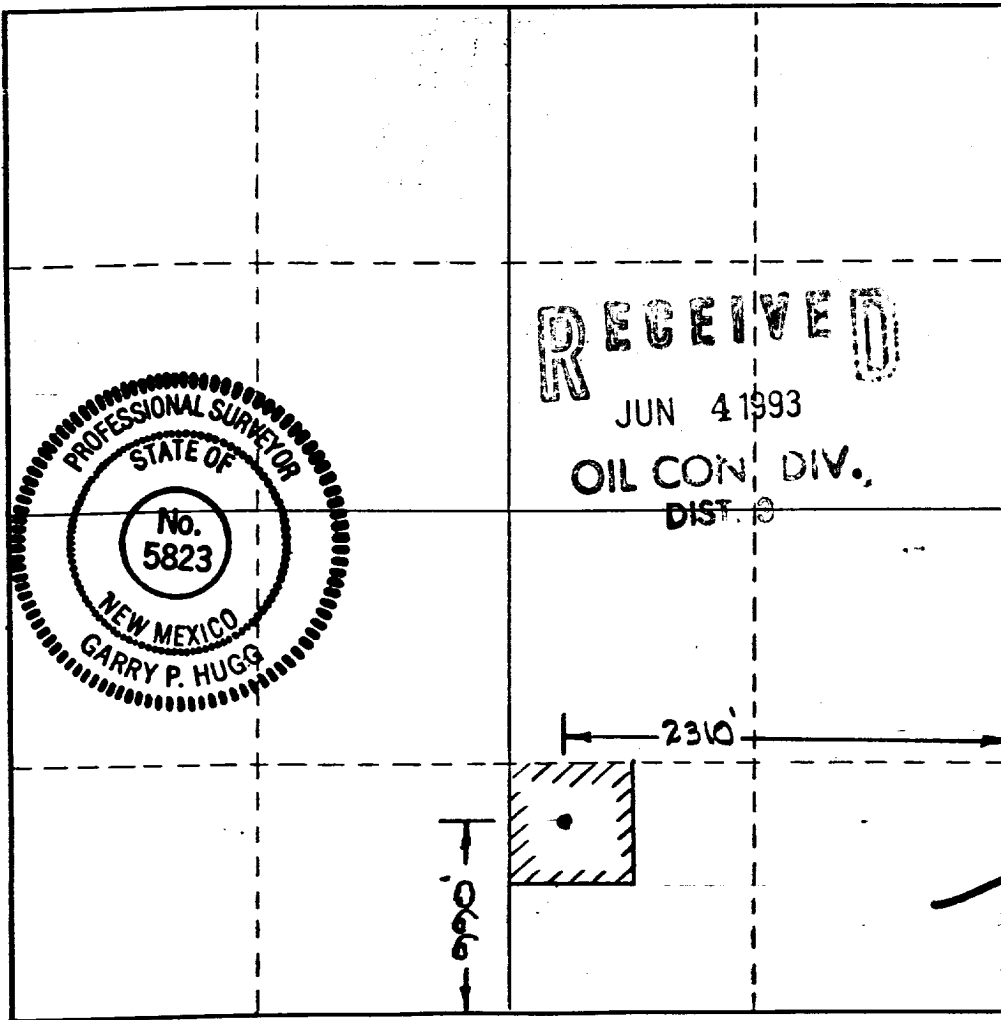

CERTIFICATION

I hereby certify that the information contained herein is true and complete to the best of my knowledge and belief.

Name David T. Wilson
Position Asst
Company COULTHURST MGT & INV. INC.
Date MAY 4 1993

I hereby certify that the well location shown on this plat was plotted from field notes of actual surveys made by me or under my supervision, and that the same is true and correct to the best of my knowledge and belief.

Date Surveyed APRIL 28, 1993
Registered Professional Surveyor [Signature]

5823
Certificate No.

CABEZON QUADRANGLE-28
McKINLEY & SANDOVAL COUNTIES
R. 2 W.

