

UNITED STATES  
DEPARTMENT OF THE INTERIOR  
BUREAU OF LAND MANAGEMENT

APPLICATION FOR PERMIT TO DRILL OR DEEPEN

1a. TYPE OF WORK

DRILL ☒

DEEPEN ☐

95 MAY 25 PM

b. TYPE OF WELL

OIL  
WELL ☒

GAS  
WELL ☐

OTHER

SINGLE  
ZONE ☒

MULTIPLE  
ZONE ☐

2. NAME OF OPERATOR

147882

FOSTER BROWN PRODUCTION INC

3. ADDRESS AND TELEPHONE NO.

318 325-1300

1401 Hudson Lane Suite 300 Monroe LA 71207-2470

4. LOCATION OF WELL (Report location clearly and in accordance with any State requirements.)\*

At surface

2313' FSL 2392' FWL Sec 7 T 17 N , R 3 W

At proposed prod. zone

Point Lookout Kpl

14. DISTANCE IN MILES AND DIRECTION FROM NEAREST TOWN OR POST OFFICE\*

10 Miles from San Luis N.M.

10. DISTANCE FROM PROPOSED\*

LOCATION TO NEAREST

PROPERTY OR LEASE LINE, FT.

(Also to nearest drig. unit line, if any)

2313'

16. NO. OF ACRES IN LEASE

1280

17. NO. OF ACRES ASSIGNED

TO THIS WELL

40

18. DISTANCE FROM PROPOSED LOCATION\*

TO NEAREST WELL, DRILLING, COMPLETED,  
OR APPLIED FOR, ON THIS LEASE, FT.

NA

19. PROPOSED DEPTH

1000'

20. ROTARY OR CABLE TOOLS

ROTARY

21. ELEVATIONS (Show whether DF, RT, GR, etc.)

6254' GR

22. APPROX. DATE WORK WILL START\*

7/10/95

23. PROPOSED CASING AND CEMENTING PROGRAM

SIZE OF HOLE	GRADE SIZE OF CASING	WEIGHT PER FOOT	SETTING DEPTH	QUANTITY OF CEMENT
9 5/8"	J-55 7"	23#	100' / 20'	45 Sacks
6 3/4"	J-55 4 1/2"	10.5#	1000'	157 Sacks

RECEIVED  
AUG - 8 1995  
OIL CON. DIV.  
DIST. 3

IN ABOVE SPACE DESCRIBE PROPOSED PROGRAM: If proposal is to deepen, give data on present productive zone and proposed new productive zone. If proposal is to drill or deepen directionally, give pertinent data on subsurface locations and measured and true vertical depths. Give blowout preventer program, if any.

24.

SIGNED

TITLE AGENT

DATE 5/24/95

(This space for Federal or State office use)

PERMIT NO.

APPROVAL DATE

Application approval does not warrant or certify that the applicant holds legal or equitable title to those rights in the subject lease which would entitle the applicant to conduct operations thereon.  
CONDITIONS OF APPROVAL, IF ANY:

APPROVED BY

5/ Patricia Hester

TITLE

Acting Area Manager

DATE

7/11/95

Hold G-109 For NEW Plat 1054 Instructions On Reverse Side

Title 18 U.S.C. Section 1001, makes it a crime for any person knowingly and willfully to make to any department or agency of the United States any false, fictitious or fraudulent statements or representations as to any matter within its jurisdiction.

**NEW MEXICO OIL CONSERVATION COMMISSION**  
**WELL LOCATION AND ACREAGE DEDICATION PLAT**

C-104 401  
 Form C-102  
 Supersedes C-128  
 Effective 1-1-65  
 New Plat # 152

30-043-20930

All distances must be from the outer boundaries of the Section.

Operator <b>FOSTER BROWN CO.</b>		Lease <b>FRANKLIN Not</b>		Well No. <b>1</b>
Unit Letter	Section <b>7</b>	Township <b>17 N</b>	Range <b>3 W</b>	County <b>SANDOVAL</b>
Actual Footage Location of Well: <b>2313'</b> feet from the <b>SOUTH</b> line and <b>2392'</b> feet from the <b>WEST</b> line				
Ground Level Elev. <b>6254'</b>	Producing Formation <b>7</b>	Pool <b>WC, 17N, 3W 7K-MV 96383</b>	Dedicated Acreage: <b>40</b> Acres	

- Outline the acreage dedicated to the subject well by colored pencil or hachure marks on the plat below.
- If more than one lease is dedicated to the well, outline each and identify the ownership thereof (both as to working interest and royalty).
- If more than one lease of different ownership is dedicated to the well, have the interests of all owners been consolidated by communitization, unitization, force-pooling, etc?

☐ Yes ☐ No If answer is "yes," type of consolidation \_\_\_\_\_

If answer is "no," list the owners and tract descriptions which have actually been consolidated. (Use reverse side of this form if necessary.) \_\_\_\_\_

No allowable will be assigned to the well until all interests have been consolidated (by communitization, unitization, forced-pooling, or otherwise) or until a non-standard unit, eliminating such interests, has been approved by the Commission.

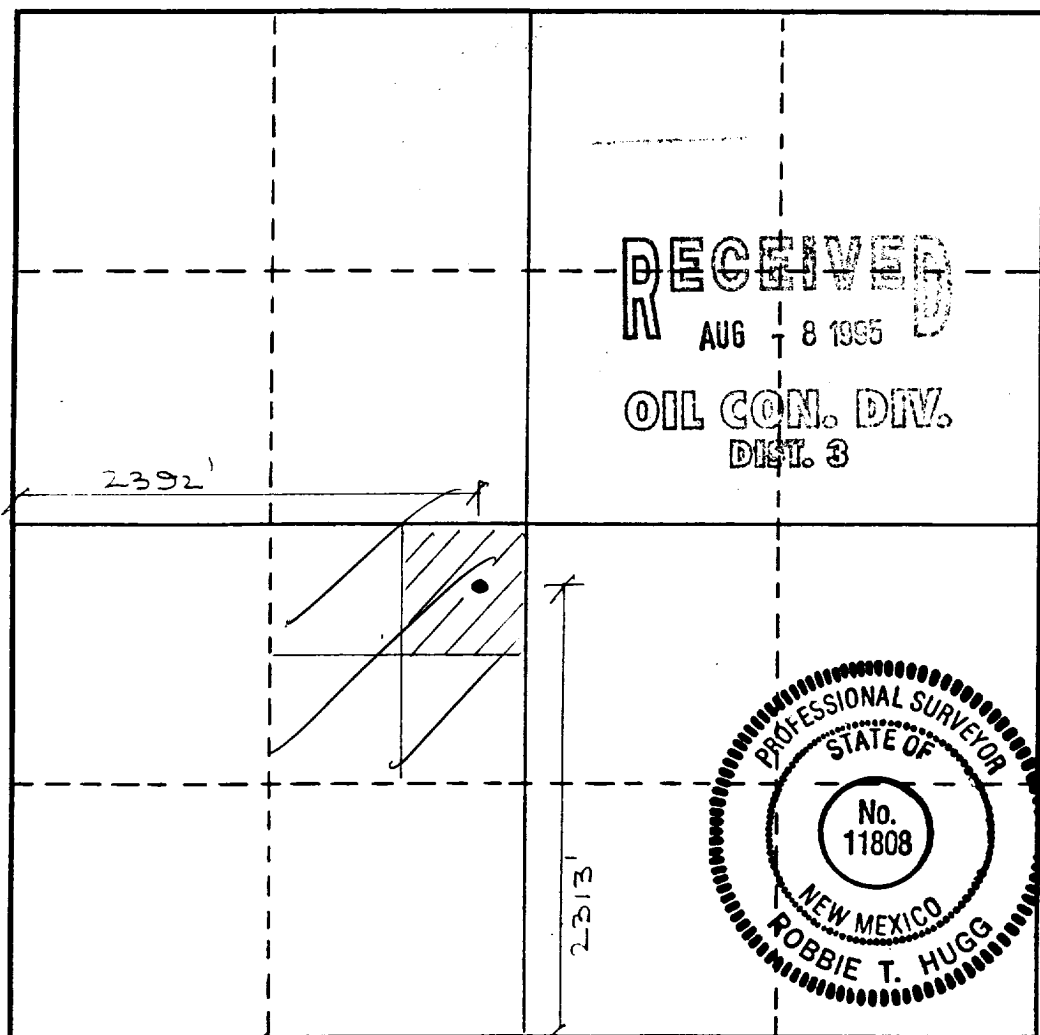

**CERTIFICATION**

I hereby certify that the information contained herein is true and complete to the best of my knowledge and belief.

Name **ROBBIE T. HUGG**  
 Position **Co-Owner**  
 Company **SUN-TEK INC**  
 Date **4-14-95**

I hereby certify that the well location shown on this plat was plotted from field notes of actual surveys made by me or under my supervision, and that the same is true and correct to the best of my knowledge and belief.

Date Surveyed **4-14-95**  
 Registered Professional Engineer and/or Land Surveyor

**NM OLS 11808**  
 Certificate No.

0 330 660 990 1320 1650 1980 2310 2640 2000 1800 1600 1400 1200 1000 800 600 400 200 0

