

UNITED STATES
DEPARTMENT OF THE INTERIOR
BUREAU OF LAND MANAGEMENT

SUBMIT IN TRIPLICATE
(Other instructions on
reverse side)

FORM APPROVED
OMB NO. 1004-0136
Expires February 28, 1995

APPLICATION FOR PERMIT TO DRILL OR DEEPEN

1a. TYPE OF WORK
Drill ☒ Deepen ☐
b. TYPE OF WELL
Oil Well ☐ Gas Well ☒ Other ☐ Single Zone ☐ Multiple Zone ☐

2. NAME OF OPERATOR
Mallon Oil Company 13925

3. ADDRESS AND TELEPHONE NO.
P.O. Box 3256
Carlsbad, NM 88220 (505) 885-4596

4. LOCATION OF WELL (Report location clearly and in accordance with any State requirements.)
At surface 1750' FSL and 1750' FEL (NW SE) Unit J
At proposed prod. zone 1750' FSL and 1750' FEL (NW SE) Unit J

14. DISTANCE IN MILES AND DIRECTION FROM NEAREST TOWN OR POST OFFICE
4 miles West Junction 537

15. DISTANCE FROM PROPOSED *
LOCATION TO NEAREST
PROPERTY OR LEASE LINE, FT. 1750'
(Also to nearest dirg. unit line, if any)

18. DISTANCE FROM PROPOSED LOCATION*
TO NEAREST WELL, DRILLING, COMPLETED,
OR APPLIED FOR, ON THIS LEASE, FT. 4000'

21. ELEVATIONS (SHOW WHETHER DF, RT, GR, Etc.) 6780' GR

23. PROPOSED CASING AND CEMENTING PROGRAM

SIZE OF HOLE	GRADE, SIZE OF CASING	WEIGHT PER FOOT	SETTING DEPTH
12-1/4"	8-5/8"	24#	300' 310'
7-7/8"	5-1/2"	15.5#/17#	ID 650'

Mallon Oil Company proposes to drill to a depth sufficient to test the Morrison formation. If productive, 5-1/2" casing will be cemented at TD. If non-productive, the well will be plugged and abandoned in a manner consistent with Federal regulations. Specific programs as per on-shore Oil and Gas Order No. 1 are outlined in the following attachments:

Drilling Program

Exhibit 1: Blow Out Preventor Equipment Plan
Exhibit A: Location and Elevation Plat
Exhibit B: Existing Roads/Planned Access Roads
Exhibit C: One Mile Radius Map

Exhibit D: Drilling Site Layout
Exhibit E: Production Facilities

RECEIVED
MAY - 6 1997

OIL CON. DIV.
DIST. 3

IN ABOVE SPACE DESCRIBE PROPOSED PROGRAM: If proposal is to deepen, give data on present productive zone and proposed new productive zone. If proposal is to drill or deepen directionally, give pertinent data on subsurface locations and measured and true vertical depths. Give blowout preventer program, if any.

24. SIGNED: Duane C. Winkler TITLE: Operations Manager DATE: 3/3/97
Duane C. Winkler

(This space for Federal or State office use)

PERMIT NO. APPROVAL DATE

Application approval does not warrant or certify that the applicant holds legal or equitable title to those rights in the subject lease which would entitle the applicant to conduct operations thereon.

CONDITIONS OF APPROVAL, IF ANY:

APPROVED BY (Original Signed) NECTOR A. VILLALOBOS TITLE Area Manager DATE MAY 5 1997

*See Instructions On Reverse Side

Title 18 U.S.C. Section 1001, makes it a crime for any person knowingly and willfully to make to any department or agency of the United States any false, fictitious or fraudulent statements or representations as to any matter within its jurisdiction.

OK
CJ

DISTRICT I.
P.O. Box 1980, Hobbs, N.M. 88241-1980

State of New Mexico
Energy, Minerals & Natural Resources Department

Form C-102

Revised February 21, 1994

Instructions on back

Submit to Appropriate District Office

State Lease - 4 Copies

Fee Lease - 3 Copies

DISTRICT II
P.O. Drawer DD, Artesia, N.M. 88211-0719

DISTRICT III
1000 Rio Brazos Rd., Aztec, N.M. 87410

DISTRICT IV
PO Box 2088, Santa Fe, NM 87504-2088

OIL CONSERVATION DIVISION

P.O. Box 2088
Santa Fe, NM 87504-2088

☐ AMENDED REPORT

WELL LOCATION AND ACREAGE DEDICATION PLAT

1 API Number <u>30-043-20941</u>		2 Pool Code <u>96711</u>		3 Pool Name <u>WILDCAT 22N4W6E; JICARILLA (GAS)</u>	
4 Property Code <u>6248</u>		5 Property Name <u>JICARILLA 434 G</u>			6 Well Number <u>4</u>
7 OGRID No. <u>13925</u>		8 Operator Name <u>MALLON OIL COMPANY</u>			9 Elevation <u>6780</u>

10 Surface Location

UL or lot no.	Section	Township	Range	Lot Idn	Feet from the	North/South line	Feet from the	East/West line	County
J	6	22-N	4-W		1750	SOUTH	1750	EAST	SANDOVAL

11 Bottom Hole Location If Different From Surface

UL or lot no.	Section	Township	Range	Lot Idn	Feet from the	North/South line	Feet from the	East/West line	County

12 Dedicated Acres <u>6.5</u>	13 Joint or Infill	14 Consolidation Code	15 Order No.
----------------------------------	--------------------	-----------------------	--------------

NO ALLOWABLE WILL BE ASSIGNED TO THIS COMPLETION UNTIL ALL INTERESTS HAVE BEEN CONSOLIDATED
OR A NON-STANDARD UNIT HAS BEEN APPROVED BY THE DIVISION

Fd.Bc.
U.S.G.L.O.

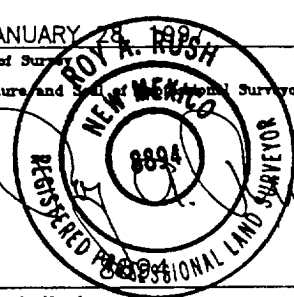
16		Fd. 1" IRON PIPE W/CAP		17 OPERATOR CERTIFICATION I hereby certify that the information contained herein is true and complete to the best of my knowledge and belief. <u>Duane C. Winkler</u> Signature Duane C. Winkler Printed Name Operations Manager Title January 28, 1997 Date	
18 SURVEYOR CERTIFICATION I hereby certify that the well location shown on this plat was plotted from field notes of actual surveys made by me or under my supervision, and that the same is true and correct to the best of my belief. JANUARY 28, 1997 Date of Survey <u>ROY A. RUSH</u> Signature and Seal of Professional Surveyor:  Certificate Number		6132.1'			
		S 01-36 E			
S 89-33-16 W		4677.86'			

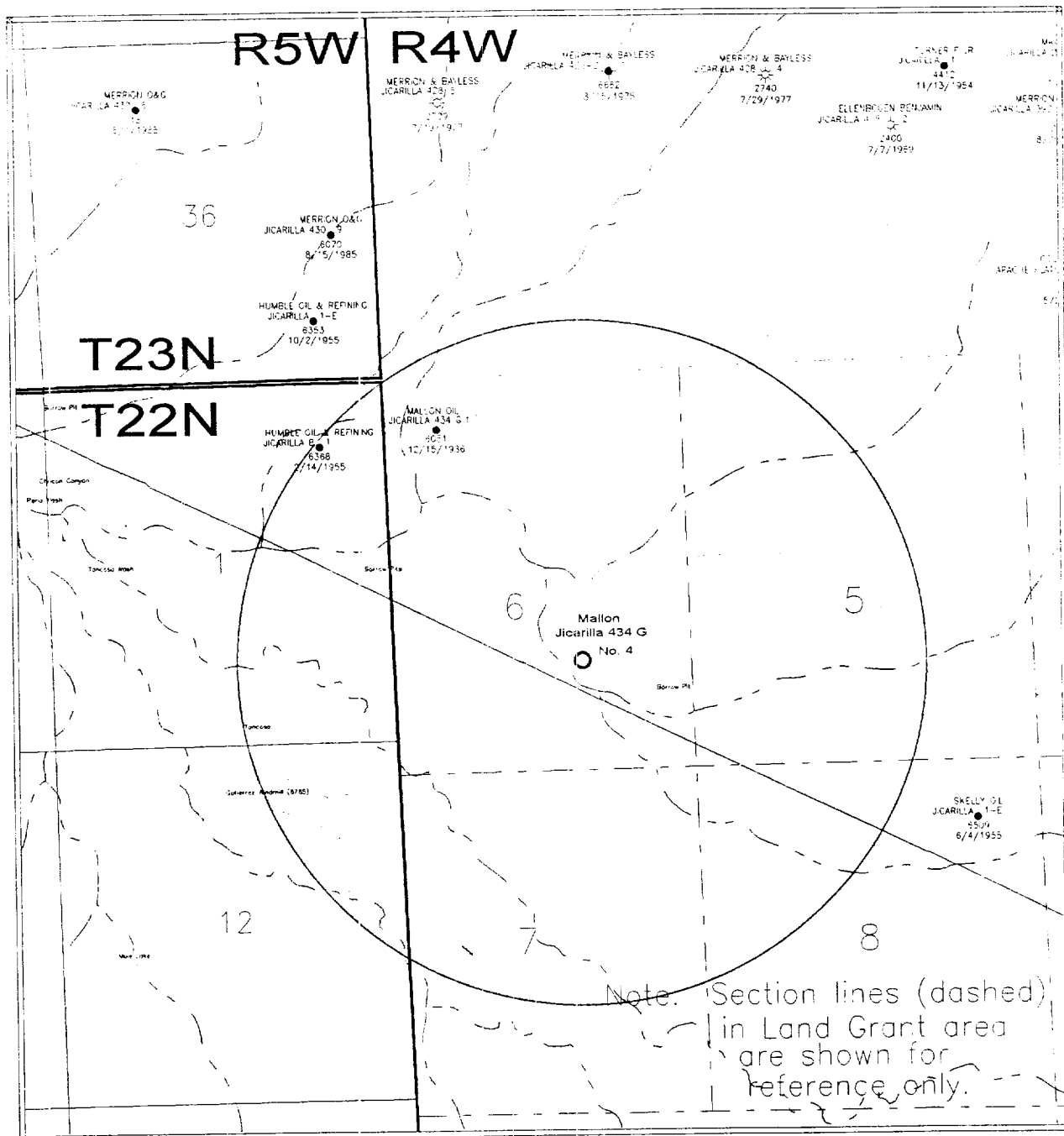

Scale 1:30000.

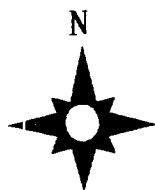

0.1 0.2 0.3 0.4 0.5 miles

MALLON OIL COMPANY		
Mallon Jicarilla 434 G No. 4 One Mile Radius Map Sandoval County, New Mexico		
T22N-R4W Sec 6	1750' FSL 1750' FEL	
		2/21/97