



COPY NO. 965

IN REPLY REFER TO:

UNITED STATES
DEPARTMENT OF THE INTERIOR
GEOLOGICAL SURVEY
P. O. Box 965
Farmington, New Mexico

May 18, 1956

Fred Turner, Jr. et al
Box 910
Midland, Texas

Re: Jicarilla Contract 18

Gentlemen:

Receipt is acknowledged of your "Notice of Intention to Drill" dated May 17, 1956 covering your well No. 2 Jicarilla in SW 1/4 sec. 32, T. 23 N., R. 1 W., N. M. P. M., Sandoval County, New Mexico, Wildcat pool.

Your proposed work is hereby approved subject to compliance with the provisions of the "Oil and Gas Operating Regulations" revised May 24, 1942, a copy of which will be sent to you on request, and subject to the following conditions:

1. Drilling operations so authorized are subject to the attached sheet for general conditions of approval.
2. Furnish copies of all logs.

Very truly yours,

Jerry W. Long
Acting District Engineer

JWLong:ac
cc - Jicarilla Agency



UNITED STATES
DEPARTMENT OF THE INTERIOR
GEOLOGICAL SURVEY



(SUBMIT IN TRIPLICATE)

Indian Agency TEHAMA

UNITED STATES
DEPARTMENT OF THE INTERIOR
GEOLOGICAL SURVEY

Allottee _____

Lease No. Contract No. 28

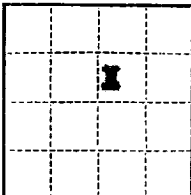

SUNDRY NOTICES AND REPORTS ON WELLS

NOTICE OF INTENTION TO DRILL	<input checked="" type="checkbox"/>	SUBSEQUENT REPORT OF WATER SHUT-OFF	
NOTICE OF INTENTION TO CHANGE PLANS		SUBSEQUENT REPORT OF SHOOTING OR ACIDIZING	
NOTICE OF INTENTION TO TEST WATER SHUT-OFF		SUBSEQUENT REPORT OF ALTERING CASING	
NOTICE OF INTENTION TO REDRILL OR REPAIR WELL		SUBSEQUENT REPORT OF REDRILLING OR REPAIR	
NOTICE OF INTENTION TO SHOOT OR ACIDIZE		SUBSEQUENT REPORT OF ABANDONMENT	
NOTICE OF INTENTION TO PULL OR ALTER CASING		SUPPLEMENTARY WELL HISTORY	
NOTICE OF INTENTION TO ABANDON WELL			

(INDICATE ABOVE BY CHECK MARK NATURE OF REPORT, NOTICE, OR OTHER DATA)

May 17, 1956

Well No. 2 is located 1980 ft. from [N] line and 1980 ft. from [E] line of sec. 32
SW 1/4 of Sec. 32 (1/4 Sec. and Sec. No.) 23N (Twp.) 4-2 (Range) R.R.P.R. (Meridian)
TEHAMA (Field) TEHAMA (County or Subdivision) NEW MEXICO (State or Territory)

The elevation of the derrick floor above sea level is _____ ft.

DETAILS OF WORK

(State names of and expected depths to objective sands; show sizes, weights, and lengths of proposed casings; indicate mudding jobs, cementing points, and all other important proposed work)

10 3/4"
 Will drill a well to approximately 4500' to test the Point Lockout Formation.
 Will set 300' of 5-3/8" surface casing, cement to be circulated. If
 commercial production is indicated, will set approximately 4500' of
5-3/8" production casing and cement with 300 sec.
7"

I understand that this plan of work must receive approval in writing by the Geological Survey before operations may be commenced.

Company FRED TUCKER, JR. ET AL

Address Box 912 - Midland, Texas

By [Signature]
 Title Office Manager

NEW MEXICO
OIL CONSERVATION COMMISSION

Form C-128

Well Location and/or Gas Proration Plat

Date _____

Operator FRED TURNER Lease JIC APACHE

Well No. _____ Section 32 Township 23 NORTH Range 4 WEST NMPM

Located 1980 Feet From the NORTH Line, 1980 Feet From the EAST Line,

SANDOVAL County, New Mexico. G. L. Elevation 6977.5 UNGRADED

Name of Producing Formation _____ Pool _____ Dedicated Acreage _____

(Note: All distances must be from outer boundaries of Section)

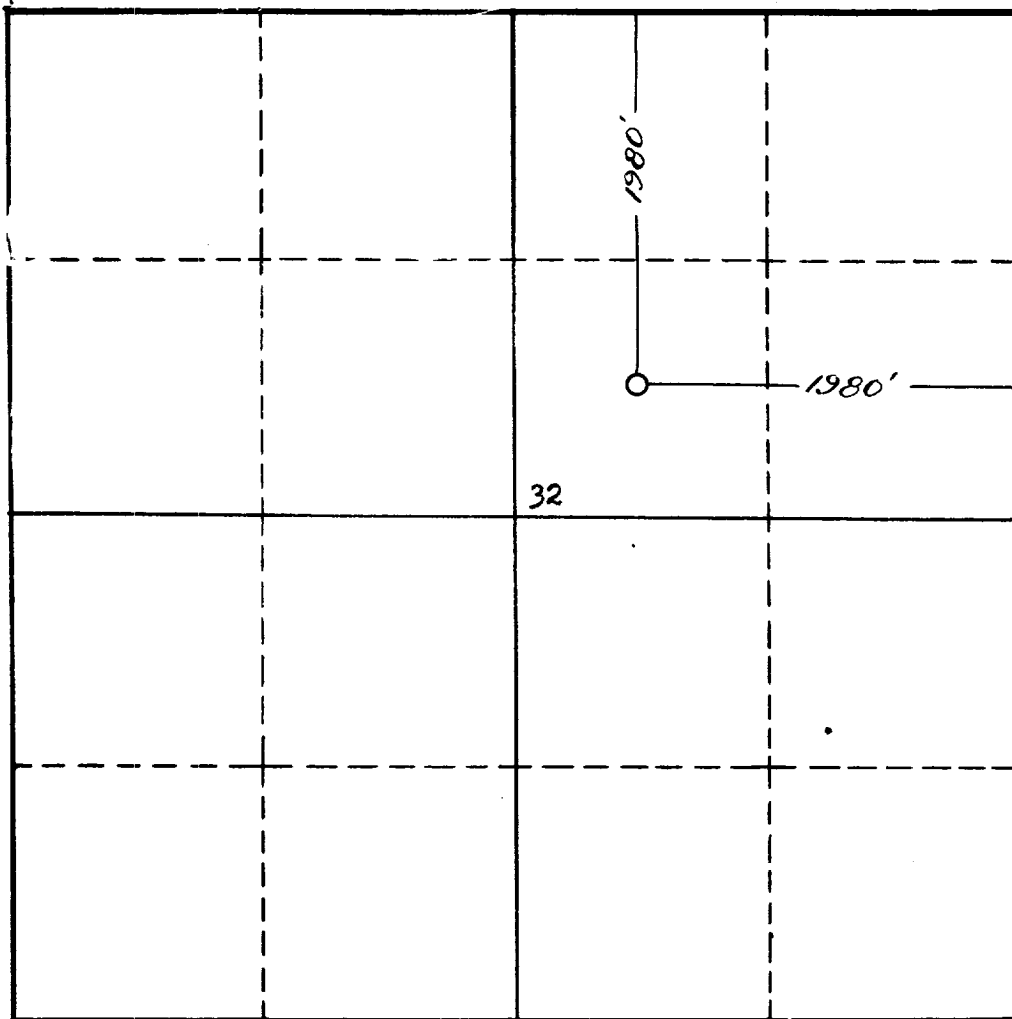

NOTE

This section of
form is to be
used for gas
wells only.



SCALE: 1" = 1000'

1. Is this Well a Dual Comp. ? Yes ☐ No ☐.
2. If the answer to Question 1 is yes, are there any other dually completed wells within the dedicated acreage? Yes ☐ No ☐.

Name _____
Position _____
Representing _____
Address _____

This is to certify that the above plat was prepared from field notes of actual surveys made by me or under my supervision and that the same are true and correct to the best of my knowledge and belief.

Date Surveyed 18 MAY, 1956
James P. Leese
Registered Professional Engineer and/or
Land Surveyor James P. Leese
N. Mex. Reg. No. 1463