

(SUBMIT IN TRIPLICATE)

Indian Agency Window Rock

UNITED STATES  
DEPARTMENT OF THE INTERIOR  
GEOLOGICAL SURVEY

Allottee Navajo

Lease No. Contr. 14-20-603-520

X		

SUNDRY NOTICES AND REPORTS ON WELLS

NOTICE OF INTENTION TO DRILL	X	SUBSEQUENT REPORT OF WATER SHUT-OFF
NOTICE OF INTENTION TO CHANGE PLANS		SUBSEQUENT REPORT OF SHOOTING OR ACIDIZING
NOTICE OF INTENTION TO TEST WATER SHUT-OFF		SUBSEQUENT REPORT OF ALTERING CASING
NOTICE OF INTENTION TO REDRILL OR REPAIR WELL		SUBSEQUENT REPORT OF REDRILLING OR REPAIR
NOTICE OF INTENTION TO SHOOT OR ACIDIZE		SUBSEQUENT REPORT OF ABANDONMENT
NOTICE OF INTENTION TO PULL OR ALTER CASING		SUPPLEMENTARY WELL HISTORY
NOTICE OF INTENTION TO ABANDON WELL		

(INDICATE ABOVE BY CHECK MARK NATURE OF REPORT, NOTICE, OR OTHER DATA)

November 22nd, 19 55

Well No. 1 is located 850 ft. from N line and 1850 ft. from W line of sec. 14

NE/4 NW/4 Sec. 14 22N 16W N.M.P.M.  
(34 Sec. and Sec. No.) (Twp.) (Range) (Meridian)  
Wildcat San Juan New Mexico  
(Field) (County or Subdivision) (State or Territory)

The elevation of the derrick floor above sea level is 5749 ft.

DETAILS OF WORK

(State names of and expected depths to objective sands; show sizes, weights, and lengths of proposed casings; indicate mudding jobs, cementing points, and all other important proposed work)

Dakota test. Estimated total depth 4300'.

Surface Casing: 275' of 9-5/8" OD 32#, cemented with 150 sacks.  
Production : Approximately 4000' of 5-1/2" OD 14# J-55,  
cemented with 150 sacks.

If commercial production is indicated, the producing section  
be shot and/or sand-oil treated.

I understand that this plan of work must receive approval in writing by the Geological Survey before operations may be commenced.

Company BEYSON-MONTIN-GRAER DRILLING CORP.

Address 405 1/2 West Broadway

Farmington, New Mexico

By Albert J. Green

Title Vice-President



Company CONTINENTAL OIL COMPANY

Lease NAVJO CONTE. NO. 14-20-603-520 Well No. ....

Sec. 14, T. 22 N., R. 16 W., E.M.P.M.

Location 850' FROM THE NORTH LINE AND 1850' FROM THE WEST LINE.

Elevation 5739.0 UNGRADED GROUND.

RECEIVED  
NOV 22 1955  
U. S. GEOLOGICAL SURVEY  
FARMINGTON, NEW MEXICO

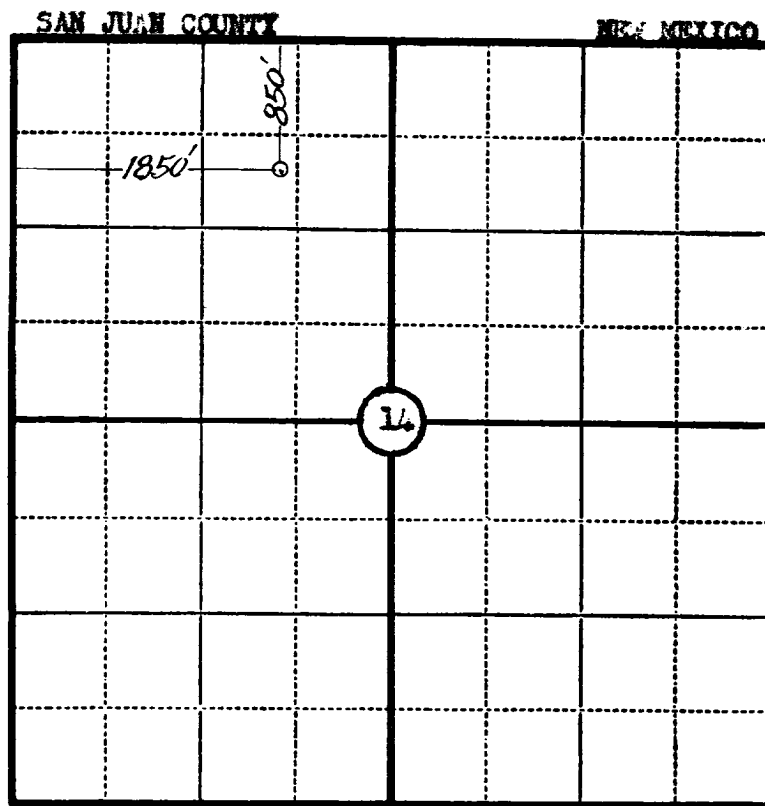

Scale—4 inches equal 1 mile.

This is to certify that the above plat was prepared from field notes of actual surveys made by me or under my supervision and that the same are true and correct to the best of my knowledge and belief.

Seal:

*James P. Leese*  
Registered Land Surveyor.  
James P. Leese  
N. Mex. Reg. No. 1463

Surveyed 13 October, 19 55



SAN JUAN ENGINEERING COMPANY, FARMINGTON, N. M.