

(SUBMIT IN TRIPLICATE)

UNITED STATES
DEPARTMENT OF THE INTERIOR
GEOLOGICAL SURVEY

Land Office **Window Rock**
Lease No. **I-149-Ind.-7167**
Unit **Ind. Allot.**

SUNDRY NOTICES AND REPORTS ON WELLS

NOTICE OF INTENTION TO DRILL	<input checked="" type="checkbox"/>	SUBSEQUENT REPORT OF WATER SHUT-OFF	
NOTICE OF INTENTION TO CHANGE PLANS		SUBSEQUENT REPORT OF SHOOTING OR ACIDIZING	
NOTICE OF INTENTION TO TEST WATER SHUT-OFF		SUBSEQUENT REPORT OF ALTERING CASING	
NOTICE OF INTENTION TO RE-DRILL OR REPAIR WELL		SUBSEQUENT REPORT OF RE-DRILLING OR REPAIR	
NOTICE OF INTENTION TO SHOOT OR ACIDIZE		SUBSEQUENT REPORT OF ABANDONMENT	
NOTICE OF INTENTION TO PULL OR ALTER CASING		SUPPLEMENTARY WELL HISTORY	
NOTICE OF INTENTION TO ABANDON WELL			

(INDICATE ABOVE BY CHECK MARK NATURE OF REPORT, NOTICE, OR OTHER DATA)

September 5

1936

Well No. **1** is located **1980** ft. from **S** line and **660** ft. from **W** line of sec. **15**
SW/4 - 15 (1/4 Sec. and Sec. No.) **21 N** (Twp.) **3W** (Range) **N M P M** (Meridian)
W C (Field) **San Juan** (County or Subdivision) **New Mexico** (State or Territory)

The elevation of the derrick floor above sea level is _____ ft. To be furnished later

DETAILS OF WORK

(State names of and expected depths to objective sands; show sizes, weights, and lengths of proposed casings; indicate mudding jobs, cementing points, and all other important proposed work)

It is proposed to drill a well at the above location to an approximate depth of 4,000' or the Mespah formation. 100' of 9 5/8" - 36# will be set N/40 sx. 3 1/2" - 14# casing will be set at T. D. with approximately 150 sx. cement. If production encountered casing to be perforated and formation sand fraced if needed. Cement to be circulated in setting pipe.

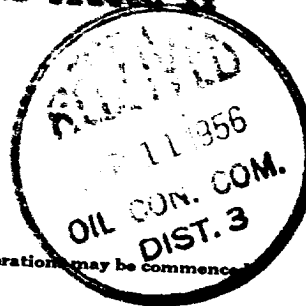

I understand that this plan of work must receive approval in writing by the Geological Survey before operation may be commenced

Company **TEXAS CALGARY COMPANY**

Address **330 Petroleum Building**

Abilene, Texas

By **Mark P. Antley**
Title **Geologist**

NEW MEXICO
OIL CONSERVATION COMMISSION

Form C-128

Well Location and/or Gas Proration Plat

Date _____

Operator Texas Calgary Lease _____

Well No. _____ Section 15 Township 21 North Range 8 West NMPM

Located 1980 Feet From South Line, 660 Feet From West Line,

San Juan County, New Mexico. G. L. Elevation 6487

Name of Producing Formation _____ Pool _____ Dedicated Acreage _____

(Note: All distances must be from outer boundaries of Section)

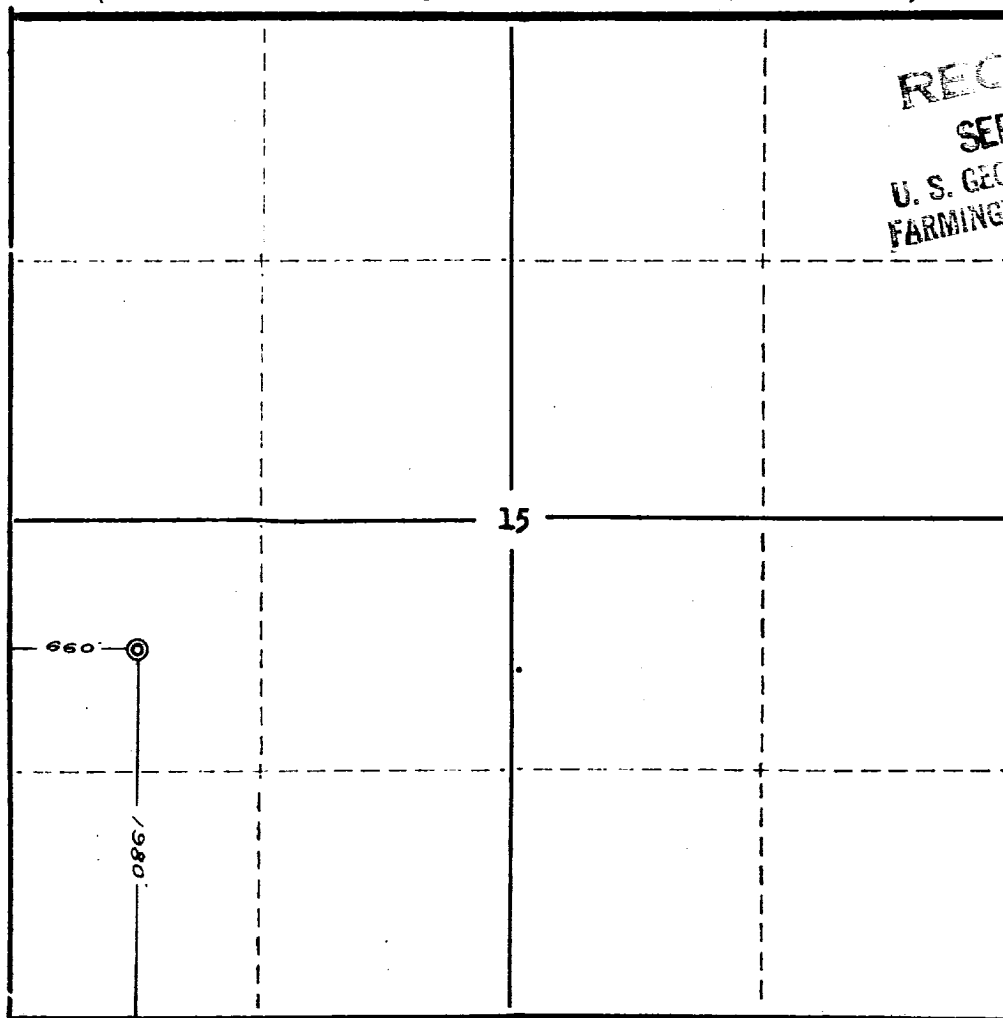

NOTE

This section of form is to be used for gas wells only.

SCALE: 1"=1000'

1. Is this Well a Dual Comp. ? Yes ___ No ___
2. If the answer to Question 1 is yes, are there any other dually completed wells within the dedicated acreage?
Yes ___ No ___

Name _____

Position _____

Representing _____

Address _____

This is to certify that the above plat was prepared from field notes of actual surveys made by me or under my supervision and that the same are true and correct to the best of my knowledge and belief.

Date Surveyed September 5, 1956

Ernest V. Echshaw

Ernest V. Echshaw
Reg. Land Surveyor, N. Mex., Reg. No. 1545