

UNITED STATES  
DEPARTMENT OF THE INTERIOR  
GEOLOGICAL SURVEY

30-045-21004

5. LEASE DESIGNATION AND SERIAL NO. USA-NM-7265-C	
6. IF INDIAN, ALLOTTEE OR TRIBE NAME	
7. UNIT AGREEMENT NAME	
8. FARM OR LEASE NAME Andele	
9. WELL NO. 1	
10. FIELD AND POOL, OR WILDCAT Wildcat-Dakota	
11. SEC., T., R., M., OR BLK. AND SURVEY OR AREA Sec. 13, T21N, R8W.	
12. COUNTY OR PARISH San Juan	13. STATE N. Mex.

## APPLICATION FOR PERMIT TO DRILL, DEEPEN, OR PLUG BACK

1a. TYPE OF WORK  
DRILL ☒ DEEPEN ☐ PLUG BACK ☐b. TYPE OF WELL  
OIL WELL ☒ GAS WELL ☐ OTHER ☐  
SINGLE ZONE ☒ MULTIPLE ZONE ☐2. NAME OF OPERATOR  
Eastern Petroleum Company3. ADDRESS OF OPERATOR  
Post Office Box 226, Farmington New Mexico 874014. LOCATION OF WELL (Report location clearly and in accordance with any State requirements.)\*  
At surface 668 FSL, 1980 FEL  
At proposed prod. zone same14. DISTANCE IN MILES AND DIRECTION FROM NEAREST TOWN OR POST OFFICE\*  
22 miles west of 44 store.15. DISTANCE FROM PROPOSED\*  
LOCATION TO NEAREST  
PROPERTY OR LEASE LINE, FT.  
(Also to nearest drig. unit line, if any) 668 ft.16. NO. OF ACRES IN LEASE  
4017. NO. OF ACRES ASSIGNED  
TO THIS WELL 8018. DISTANCE FROM PROPOSED LOCATION\*  
TO NEAREST WELL, DRILLING, COMPLETED,  
OR APPLIED FOR, ON THIS LEASE, FT. none19. PROPOSED DEPTH  
520020. ROTARY OR CABLE TOOLS  
Rotary21. ELEVATIONS (Show whether DF, RT, GR, etc.)  
6648 GL22. APPROX. DATE WORK WILL START\*  
Sept. 1972

## 23. PROPOSED CASING AND CEMENTING PROGRAM

SIZE OF HOLE	SIZE OF CASING	WEIGHT PER FOOT	SETTING DEPTH	QUANTITY OF CEMENT
12"	9 5/8	36#	62 ft.	45 sx.
7 7/8	4 1/2	9.5	5200 ft.	150 sx.

Propose to drill and test the Dakota Sandstone. If productive, will run  
and set 4 1/2 casing.

Verbal permission to spud and set surface pipe ~~only~~ requested on 8-18-72.

IN ABOVE SPACE DESCRIBE PROPOSED PROGRAM: If proposal is to deepen or plug back, give data on present productive zone and proposed new productive zone. If proposal is to drill or deepen directionally, give pertinent data on subsurface locations and measured and true vertical depths. Give blowout preventer program, if any.

24. SIGNED Henry Fulmer TITLE President DATE 8-18-72  
(This space for Federal or State office use)

PERMIT NO. \_\_\_\_\_ APPROVAL DATE \_\_\_\_\_

APPROVED BY sq TITLE \_\_\_\_\_ DATE \_\_\_\_\_  
CONDITIONS OF APPROVAL, IF ANY:

**NEW MEXICO OIL CONSERVATION COMMISSION  
WELL LOCATION AND ACREAGE DEDICATION PLAT**

Form C-102  
Supersedes C-128  
Effective 1-1-65

All distances must be from the outer boundaries of the Section.

Operator <b>Eastern Petroleum Company</b>			Lease <b>Andele</b>		Well No. <b>No. 1</b>
Section <b>13</b>	Township <b>21 North</b>	Range <b>8 West</b>	County <b>San Juan</b>		
Approximate Location of Well: <b>668</b> feet from the <b>South</b> line and <b>1980</b> feet from the <b>East</b> line					
Section <b>6648</b>	Producing Formation <b>Dakota</b>	Pool <b>Wildcat</b>	Dedicated Acreage: <b>40</b> Acres		

1. Outline the acreage dedicated to the subject well by colored pencil or hachure marks on the plat below.
2. If more than one lease is dedicated to the well, outline each and identify the ownership thereof (both as to working interest and royalty).
3. If more than one lease of different ownership is dedicated to the well, have the interests of all owners been consolidated by communitization, unitization, force-pooling, etc?

☐ Yes ☐ No If answer is "yes," type of consolidation \_\_\_\_\_

If answer is "no," list the owners and tract descriptions which have actually been consolidated. (Use reverse side of this form if necessary.) \_\_\_\_\_

No allowable will be assigned to the well until all interests have been consolidated (by communitization, unitization, forced-pooling, or otherwise) or until a non-standard unit, eliminating such interests, has been approved by the Commission.

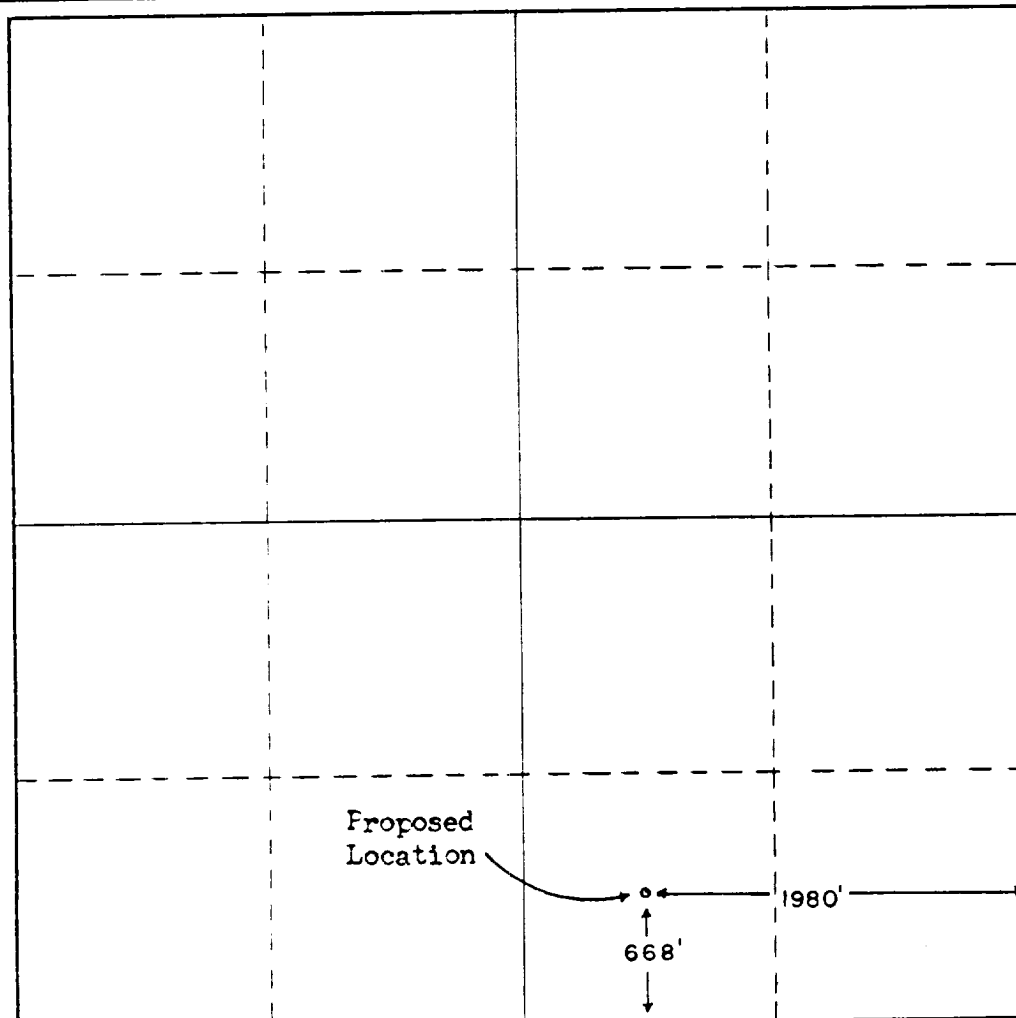

**CERTIFICATION**

I hereby certify that the information contained herein is true and correct to the best of my knowledge and belief.

Name Henry J. Reed  
Position  
**President**  
Company  
**Eastern Petroleum Company**  
Date  
**8-18-72**

I hereby certify that the well location shown on this plat was plotted from field notes of actual surveys made by me or under my supervision, and that the same is true and correct to the best of my knowledge and belief.

**June 16, 1972**  
Date Surveyed  
**Frederick H. Reed**  
Registered Professional Engineer  
and/or Land Surveyor  
*Frederick H. Reed*  
**3795**  
Certificate No.

