

UNITED STATES  
DEPARTMENT OF THE INTERIORGEOLOGICAL SURVEY **API 30-045-22128**

## APPLICATION FOR PERMIT TO DRILL, DEEPEN, OR PLUG BACK

## 1a. TYPE OF WORK

DRILL ☒DEEPEN ☐PLUG BACK ☐

## b. TYPE OF WELL

OIL  
WELL ☐GAS  
WELL ☐

OTHER \*Strat Test

SINGLE  
ZONE ☐MULTIPLE  
ZONE ☐

## 2. NAME OF OPERATOR

Mobil Oil Corporation

## 3. ADDRESS OF OPERATOR

P. O. Box 633, Midland, Texas 79701

## 4. LOCATION OF WELL (Report location clearly and in accordance with any State requirements.)\*

At surface

1980' FEL &amp; 1980' FSL, Sec. 13, T21N, R15W

At proposed prod. zone \*

## 14. DISTANCE IN MILES AND DIRECTION FROM NEAREST TOWN OR POST OFFICE\*

## 10. DISTANCE FROM PROPOSED\*

LOCATION TO NEAREST

PROPERTY OR LEASE LINE, FT.

(Also to nearest drlg. unit line, if any)

## 18. DISTANCE FROM PROPOSED LOCATION\*

TO NEAREST WELL, DRILLING, COMPLETED,

OR APPLIED FOR, ON THIS LEASE, FT.

## 16. NO. OF ACRES IN LEASE

2559.83 Surveyed

2560 Lease

## 19. PROPOSED DEPTH

5000'

17. NO. OF ACRES ASSIGNED  
TO THIS WELL \*

## 20. ROTARY OR CABLE TOOLS

Rotary

## 21. ELEVATIONS (Show whether DF, RT, GR, etc.)

5826.1' Ground

## 22. APPROX. DATE WORK WILL START\*

As soon as possible

## 23.

## PROPOSED CASING AND CEMENTING PROGRAM

SIZE OF HOLE	SIZE OF CASING	WEIGHT PER FOOT	SETTING DEPTH	QUANTITY OF CEMENT
8-3/4"	7"	17# - H-40	300'	Circulate to surface
5-5/8-6-1/4"	Open Hole	-	-	with Class A Cement

## MUD PROGRAM:

From	To	Type Mud	Weight	Viscosity	PH	Water Loss
0	300'	Spud Mud	No Control			
300'	T.D.	Fresh Water w/additions of Gel as necessary	9.0-10.5	30-45	9+	NC

## DIAGRAMMATIC SKETCH OF BLOWOUT PREVENTER ATTACHED

\*This well to be drilled for information only and will not be produced.

IN ABOVE SPACE DESCRIBE PROPOSED PROGRAM: If proposal is to deepen or plug back, give data on present productive zone and proposed new productive zone. If proposal is to drill or deepen directionally, give pertinent data on subsurface locations and measured and true vertical depths. Give blowout preventer program, if any.

24.

SIGNED



A. D. Bond

TITLE

Proration Staff Assistant

DATE

April 24, 1975

(This space for Federal or State office use)

PERMIT NO.

APPROVAL DATE

APPROVED BY

TITLE

DATE

CONDITIONS OF APPROVAL, IF ANY:

\*See Instructions On Reverse Side

**NEW MEXICO OIL CONSERVATION COMMISSION  
WELL LOCATION AND ACREAGE DEDICATION PLAT**

Form C-102  
Supersedes C-128  
Effective 1-1-65

All distances must be from the outer boundaries of the Section.

Operator <b>Mobil Oil Corporation</b>			Lease <b>Navajo "D"</b>		Well No. <b>1</b>
Unit Letter <b>J</b>	Section <b>13</b>	Township <b>21N</b>	Range <b>15W</b>	County <b>San Juan</b>	
Actual Footage Location of Well: <div style="display: flex; justify-content: space-between;"> <span><b>1980</b> feet from the <b>South</b> line and</span> <span><b>1980'</b> feet from the <b>East</b> line</span> </div>					
Ground Level Elev. <b>5826.1</b>	Producing Formation <b>Dakota</b>	Pool <b>Wildcat</b>	Dedicated Acreage: <b>Strat Test</b> Acres		

1. Outline the acreage dedicated to the subject well by colored pencil or hachure marks on the plat below.
2. If more than one lease is dedicated to the well, outline each and identify the ownership thereof (both as to working interest and royalty).
3. If more than one lease of different ownership is dedicated to the well, have the interests of all owners been consolidated by communitization, unitization, force-pooling, etc?

☐ Yes    ☐ No    If answer is "yes," type of consolidation \_\_\_\_\_

If answer is "no," list the owners and tract descriptions which have actually been consolidated. (Use reverse side of this form if necessary.) \_\_\_\_\_

No allowable will be assigned to the well until all interests have been consolidated (by communitization, unitization, forced-pooling, or otherwise) or until a non-standard unit, eliminating such interests, has been approved by the Commission.

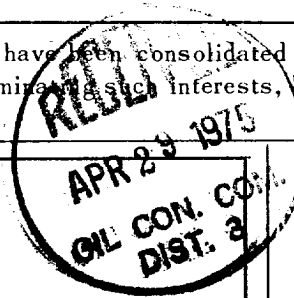
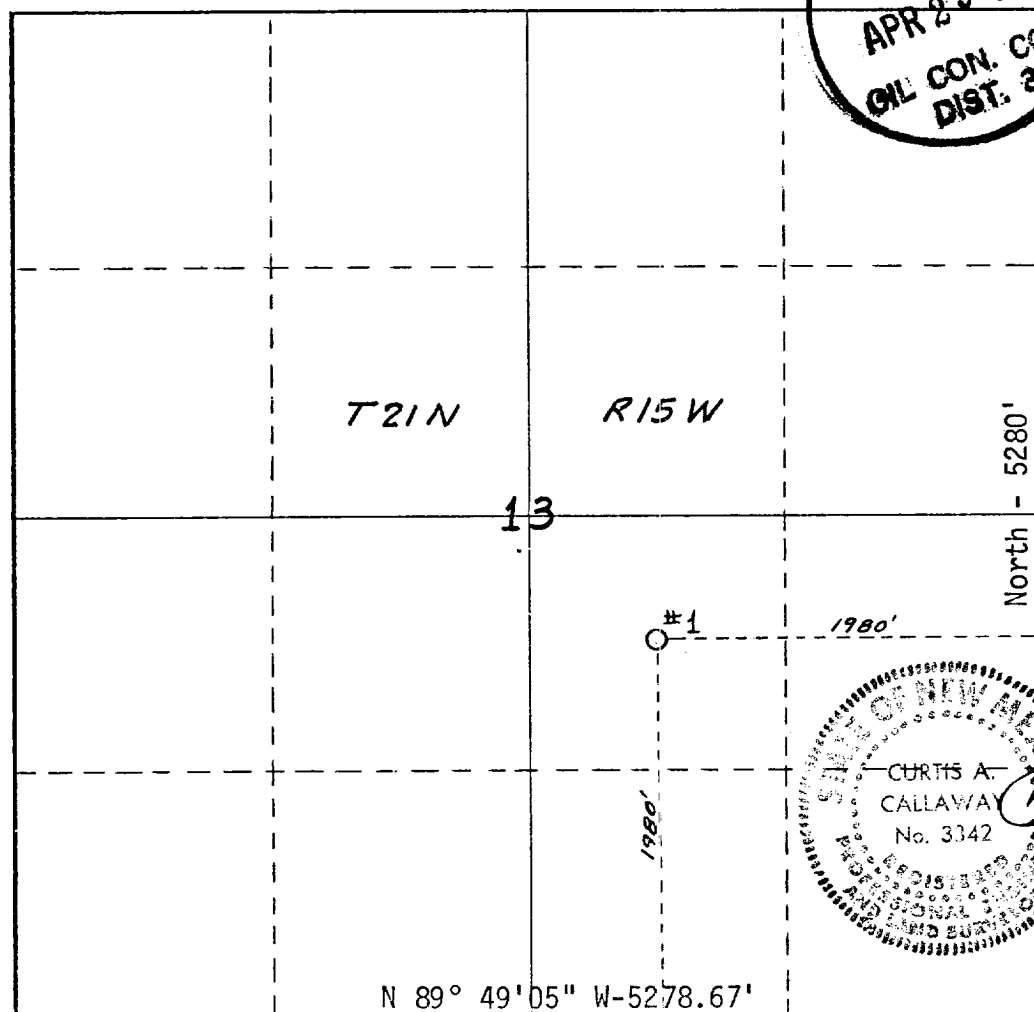

**CERTIFICATION**

I hereby certify that the information contained herein is true and complete to the best of my knowledge and belief.

*A. D. Bond*

Name  
**A. D. Bond**  
Position  
**Proration Staff Assistant**  
Company  
**Mobil Oil Corporation**  
Date  
**April 24, 1975**

I hereby certify that the well location shown on this plat was plotted from field notes of actual surveys made by me or under my supervision, and that the same is true and correct to the best of my knowledge and belief.

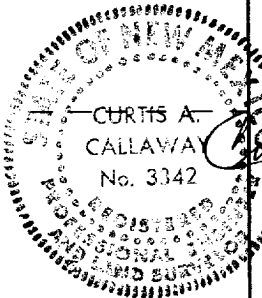

*Curtis A. Callaway*  
Date Surveyed  
**April 2, 1975**  
Registered Professional Engineer and/or Land Surveyor

**Curtis A. Callaway**  
Certificate No.  
**3342**

PROPOSED BOP STACK  
7 " CASING

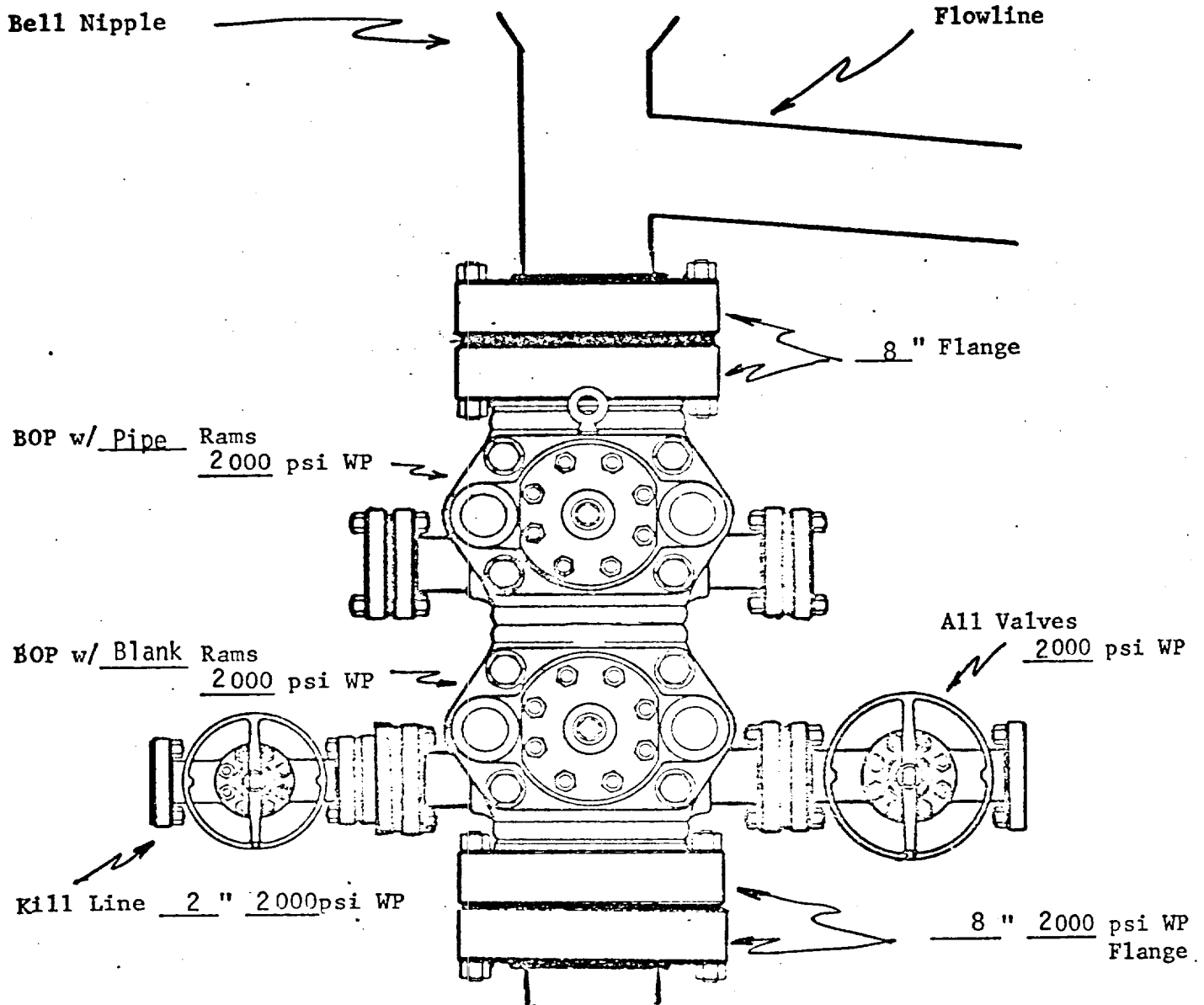

MOBIL OIL CORPORATION  
Navajo "D", Well #1  
San Juan COUNTY,  
New Mexico

MOBIL OIL CORPORATION  
P. O. Box 633  
Midland, Texas 79701

TWELVE-POINT SURFACE USE PLAN FOR  
DRILLING OPERATIONS ON FEDERAL LEASES

Lease Name: Navajo "D" Well No. 1  
Well Location: 1980' FSL & 1980' FEL, Sec. 13, T21N, R15W  
Field: Wildcat  
County: San Juan State: New Mexico

1. \* Existing roads including location of the exit from the main highway.
2. \* Planned access roads.
3. \* Location of wells.
4. \* Lateral roads to well location.
5. \* Location of tank batteries and flow lines. None
6. Location and types of water supply: Water will be hauled to the drill site.  
\_\_\_\_\_  
\_\_\_\_\_
7. Methods for handling waste disposal: Waste will be burned, buried and/or  
hauled from the drill site.  
\_\_\_\_\_
8. Location of camps: None  
\_\_\_\_\_
9. Location of air strips: None  
\_\_\_\_\_
10. Location layout to include position or rig, mud tanks, reserve pits,  
burn pits, pipe racks, etc.: Well will be drilled with a truck-mounted rig.  
A small mud pit and circulation pit will be dug nearby.  
\_\_\_\_\_
11. Plans for restoration of the surface: Drill site will be cleaned - The surface  
will be returned to original grade as near as practical and left for return  
of natural vegetation. The area will be reseeded if necessary.  
\_\_\_\_\_  
\_\_\_\_\_
12. Any other information that may be used in evaluating the impact on  
environment: This well is in a semiarid region and broken rocky country with  
sandy sparse grass pasture and no timber.  
\_\_\_\_\_  
\_\_\_\_\_  
\_\_\_\_\_  
\_\_\_\_\_  
\_\_\_\_\_  
\_\_\_\_\_  
\_\_\_\_\_

\* Shown on attached map.