

UNITED STATES  
DEPARTMENT OF THE INTERIOR  
GEOLOGICAL SURVEY30-045-22352  
5. LEASE DESIGNATION AND SERIAL NO.

NM 28750

6. IF INDIAN, ALLOTTEE OR TRIBE NAME

7. UNIT AGREEMENT NAME

8. FARM OR LEASE NAME

Federal 17

9. WELL NO.

1

10. FIELD AND POOL, OR WILDCAT

Undesignated--Entrada

11. SEC., T., R., M., OR BLK.  
AND SURVEY OR AREA

SEC. 17, T21N, R8W

12. COUNTY OR PARISH

San Juan

13. STATE  
N. M.

## 1a. TYPE OF WORK

DRILL ☒DEEPEN ☐PLUG BACK ☐

## b. TYPE OF WELL

OIL  
WELL ☒GAS  
WELL ☐

OTHER

SINGLE  
ZONE ☐MULTIPLE  
ZONE ☐

## 2. NAME OF OPERATOR

Dome Petroleum Corporation

## 3. ADDRESS OF OPERATOR

c/o Minerals Management Inc., Suite 105,

501 Airport Drive, Farmington, New Mexico 87401

## 4. LOCATION OF WELL (Report location clearly and in accordance with any State requirements.)\*

At surface

330'FSL, 1880'FEL, SEC. 17, T21N, R8W

At proposed prod. zone

## 14. DISTANCE IN MILES AND DIRECTION FROM NEAREST TOWN OR POST OFFICE\*

23 miles southwest of 44 Trading Post

## 15. DISTANCE FROM PROPOSED\*

LOCATION TO NEAREST

PROPERTY OR LEASE LINE, FT.

(Also to nearest drlg. unit line, if any)

330'

## 16. NO. OF ACRES IN LEASE

400

17. NO. OF ACRES ASSIGNED  
TO THIS WELL

40

## 18. DISTANCE FROM PROPOSED LOCATION\*

TO NEAREST WELL, DRILLING, COMPLETED,  
OR APPLIED FOR, ON THIS LEASE, FT.

1220'

## 19. PROPOSED DEPTH

5800'

## 20. ROTARY OR CABLE TOOLS

Rotary

## 21. ELEVATIONS (Show whether DF, RT, GR, etc.)

6505' GR

## 22. APPROX. DATE WORK WILL START\*

March 1, 1977

## 23.

## PROPOSED CASING AND CEMENTING PROGRAM

| SIZE OF HOLE | SIZE OF CASING | WEIGHT PER FOOT | SETTING DEPTH | QUANTITY OF CEMENT   |
|--------------|----------------|-----------------|---------------|----------------------|
| 15"          | 10 3/4 (new)   | 32.75           | 200'          | 200 sx               |
| 8 3/4"       | 7 (new)        | 23.00           | 5800'         | 300-500 sx (2-stage) |

Dome Petroleum Corporation (Operator) proposes to drill a Jurassic test to 5800'. Completion will be determined from logs. A Series 900 (3000 psi, WP) blowout preventer will be used. The BOP will be tested before drilling the surface plug. The geologic name of the surface formation is Lewis Shale. Pertinent formation tops are estimated as Point Lookout 2515', Gallup 3400', Dakota 4660', Entrada 5650'. Drill stem tests will be taken where necessary for evaluation. No abnormal pressures or temperatures are anticipated. Drilling should require about 15 days.

CONFIDENTIAL

FEB 23 1977

U. S. GEOLOGICAL SURVEY

IN ABOVE SPACE DESCRIBE PROPOSED PROGRAM: If proposal is to deepen or plug back, give data on present productive zone and proposed new productive zone. If proposal is to drill or deepen directionally, give pertinent data on subsurface locations and measured and true vertical depths. Give blowout preventer program, if any.

## 24.

SIGNED

*J. Arnold Hall*

Area Manager

TITLE Minerals Management Inc. DATE February 22, 1977

(This space for Federal or State office use)

PERMIT NO.

APPROVAL DATE

APPROVED BY

TITLE

DATE

CONDITIONS OF APPROVAL, IF ANY:

\*See Instructions On Reverse Side

**NEW MEXICO OIL CONSERVATION COMMISSION  
WELL LOCATION AND ACREAGE DEDICATION PLAT**

Form C-102  
Supersedes C-128  
Effective 1-1-65

All distances must be from the outer boundaries of the Section.

|                                                                                                                               |                                       |                        |                                       |                           |                                       |
|-------------------------------------------------------------------------------------------------------------------------------|---------------------------------------|------------------------|---------------------------------------|---------------------------|---------------------------------------|
| Operator<br><b>Dome Petroleum Corporation</b>                                                                                 |                                       |                        | Lease<br><b>Federal 17</b>            |                           | Well No.<br><b>1</b>                  |
| Unit Letter<br><b>0</b>                                                                                                       | Section<br><b>17</b>                  | Township<br><b>21N</b> | Range<br><b>8W</b>                    | County<br><b>San Juan</b> |                                       |
| Actual Footage Location of Well:<br><b>330</b> feet from the <b>South</b> line and <b>1880</b> feet from the <b>East</b> line |                                       |                        |                                       |                           |                                       |
| Ground Level Elev.<br><b>6505</b>                                                                                             | Producing Formation<br><b>Entrada</b> |                        | Pool<br><b>Undesignated - Entrada</b> |                           | Dedicated Acreage:<br><b>40</b> Acres |

1. Outline the acreage dedicated to the subject well by colored pencil or hachure marks on the plat below.
2. If more than one lease is dedicated to the well, outline each and identify the ownership thereof (both as to working interest and royalty).
3. If more than one lease of different ownership is dedicated to the well, have the interests of all owners been consolidated by communitization, unitization, force-pooling, etc?

☐ Yes ☐ No If answer is "yes," type of consolidation \_\_\_\_\_

If answer is "no," list the owners and tract descriptions which have actually been consolidated. (Use reverse side of this form if necessary.) \_\_\_\_\_

No allowable will be assigned to the well until all interests have been consolidated (by communitization, unitization, forced-pooling, or otherwise) or until a non-standard unit, eliminating such interests, has been approved by the Commission.

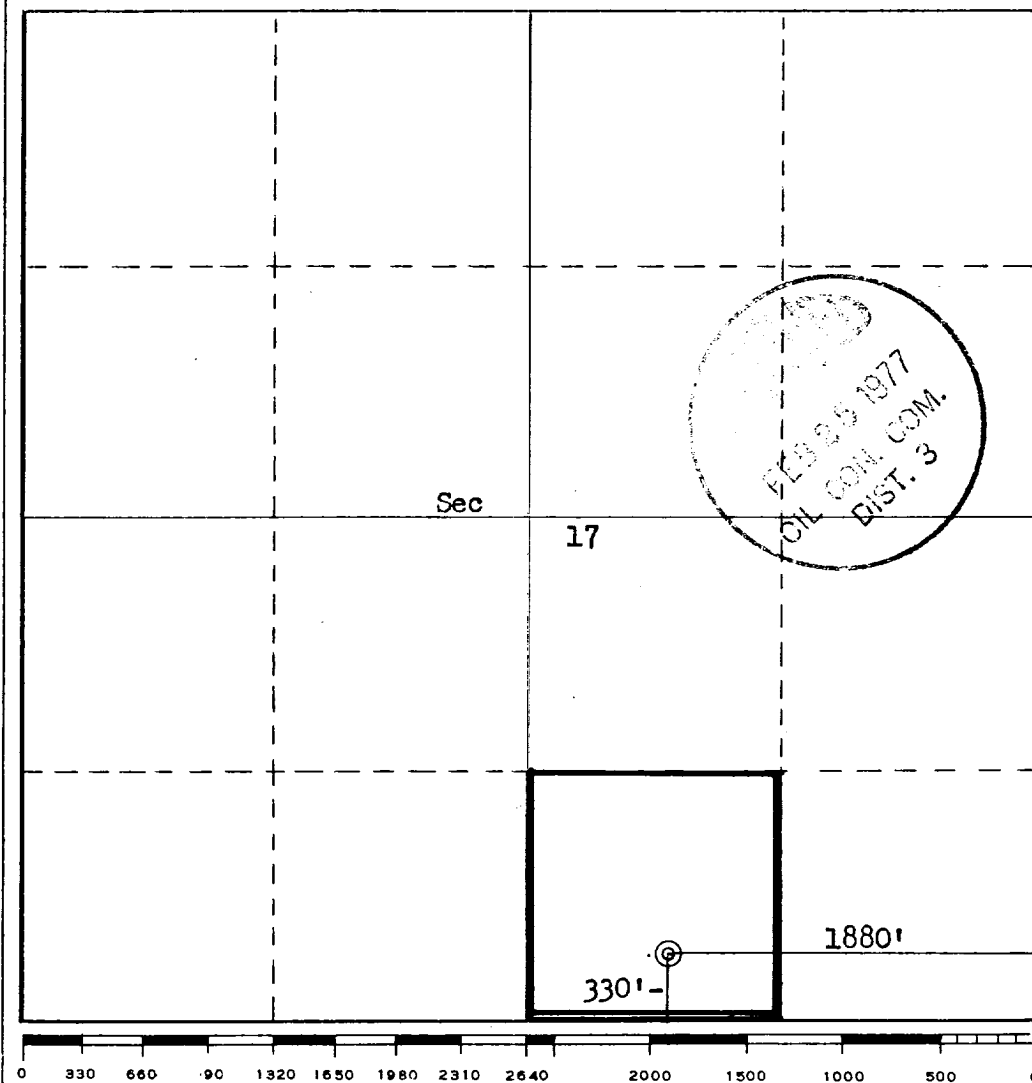

**CERTIFICATION**

*I hereby certify that the information contained herein is true and complete to the best of my knowledge and belief.*

Name  
*T. Arnold Smith*  
Position  
**Area Manager**  
Company  
**Minerals Management Inc.**  
Date  
**February 18, 1977**

*I hereby certify that the well location shown on this plat was plotted from field notes of actual surveys made by me or under my supervision, and that the same is true and correct to the best of my knowledge and belief.*

Date Surveyed  
**February 15, 1977**  
Registered Professional Engineer and/or Land Surveyor  
*Fred B. Kerr Jr.*  
Certificate No.  
**3950**