

NO. OF COPIES RECEIVED	6
DISTRIBUTION	
SANTA FE	1
FILE	1
U.S.G.S.	2
LAND OFFICE	1
OPERATOR	1

NEW MEXICO OIL CONSERVATION COMMISSION

30-045-23225  
Form C-101  
Revised 1-1-75

5A. Indicate Type of Lease	
STATE <input checked="" type="checkbox"/>	FEE <input type="checkbox"/>
5. State Oil & Gas Lease No.	
St. NM-L-1574	

APPLICATION FOR PERMIT TO DRILL, DEEPEN, OR PLUG BACK

1a. Type of Work		7. Unit Agreement Name	
b. Type of Well OIL WELL <input type="checkbox"/> GAS WELL <input checked="" type="checkbox"/> OTHER <input type="checkbox"/>		8. Farm or Lease Name	
DRILL <input checked="" type="checkbox"/> DEEPEN <input type="checkbox"/> PLUG BACK <input type="checkbox"/>		State 32-23-8	
2. Name of Operator		9. Well No.	
Benson Mineral Group, Inc.		1	
3. Address of Operator		10. Field and Pool, or Wildcat	
3200 Anaconda Tower, 555 17th St., Denver, CO 80202		Wildcat Chacra	
4. Location of Well		12. County	
UNIT LETTER E LOCATED 1560 FEET FROM THE North LINE		San Juan	
AND 1160 FEET FROM THE West LINE OF SEC. 32 TWP. 23N RGE. 8W NMPM			
19. Proposed Depth		19A. Formation	20. Rotary or C.T.
1700		Chacra	Rotary
21. Elevations (Show whether DF, RT, etc.)	21A. Kind & Status Plug. Bond	21B. Drilling Contractor	22. Approx. Date Work will start
6791 GR	State-wide	B & N Drilling	As soon as permitted

23.

PROPOSED CASING AND CEMENT PROGRAM

SIZE OF HOLE	SIZE OF CASING	WEIGHT PER FOOT	SETTING DEPTH	SACKS OF CEMENT	EST. TOP
9-5/8	7" used	23	100	50 sx. circ.	
6 1/2	4 1/2" new	9.5	1700	180 sx. circ.	

Benson Mineral Group, Inc. intends to drill the above well to evaluate the Chacra formation. A blowout preventer diagram is attached.  
The gas is not dedicated.

APPROVAL VALID  
FOR 90 DAYS UNLESS  
DRILLING COMMENCED,

EXPIRES 12-12-78

IN ABOVE SPACE DESCRIBE PROPOSED PROGRAM: IF PROPOSAL IS TO DEEPEN OR PLUG BACK, GIVE DATA ON PRESENT PRODUCTIVE ZONE AND PROPOSED NEW PRODUCTIVE ZONE. GIVE BLOWOUT PREVENTER PROGRAM, IF ANY.

I hereby certify that the information above is true and complete to the best of my knowledge and belief.

Signed Paul C. Ellison Title Production Manager Date 9-8-78  
(This space for State Use)

APPROVED BY Frank S. Chang TITLE \_\_\_\_\_ DATE \_\_\_\_\_

CONDITIONS OF APPROVAL, IF ANY:

NEW MEXICO OIL CONSERVATION COMMISSION  
WELL LOCATION AND ACREAGE DEDICATION PLAT

Form O-10  
Supersedes O-10-1  
Effective 1-1-68

All distances must be from the outer boundaries of the Section

Owner <b>BENSON MINERAL GROUP, INC.</b>			Lease No. <b>STATE 32-23-8</b>		Well No. <b>1</b>
Section <b>E</b>	Range <b>32</b>	Township <b>23N</b>	Meridian <b>8W</b>	County <b>San Juan</b>	
Actual Footage to and from Well: 1560 feet from the <b>North</b> line and 1160 feet from the <b>West</b> line.					
Ground Level Elev. <b>6791</b>	Underlying Formation <b>Chacra</b>		Well Name <b>Wellcat</b>		Estimated Acreage <b>160</b>

1. Outline the acreage dedicated to the subject well by colored pencil or hatchure marks on the plat below.
2. If more than one lease is dedicated to the well, outline each and identify the ownership thereof (both as to working interest and royalty).
3. If more than one lease of different ownership is dedicated to the well, have the interests of all owners been consolidated by communitization, unitization, force-pooling, etc?

☐ Yes ☐ No If answer is "yes," type of consolidation \_\_\_\_\_

If answer is "no," list the owners and tract descriptions which have actually been consolidated. (Use reverse side of this form if necessary.) \_\_\_\_\_

No allowable will be assigned to the well until all interests have been consolidated (by communitization, unitization, forced-pooling, or otherwise) or until a non-standard unit, eliminating such interests, has been approved by the Commission.

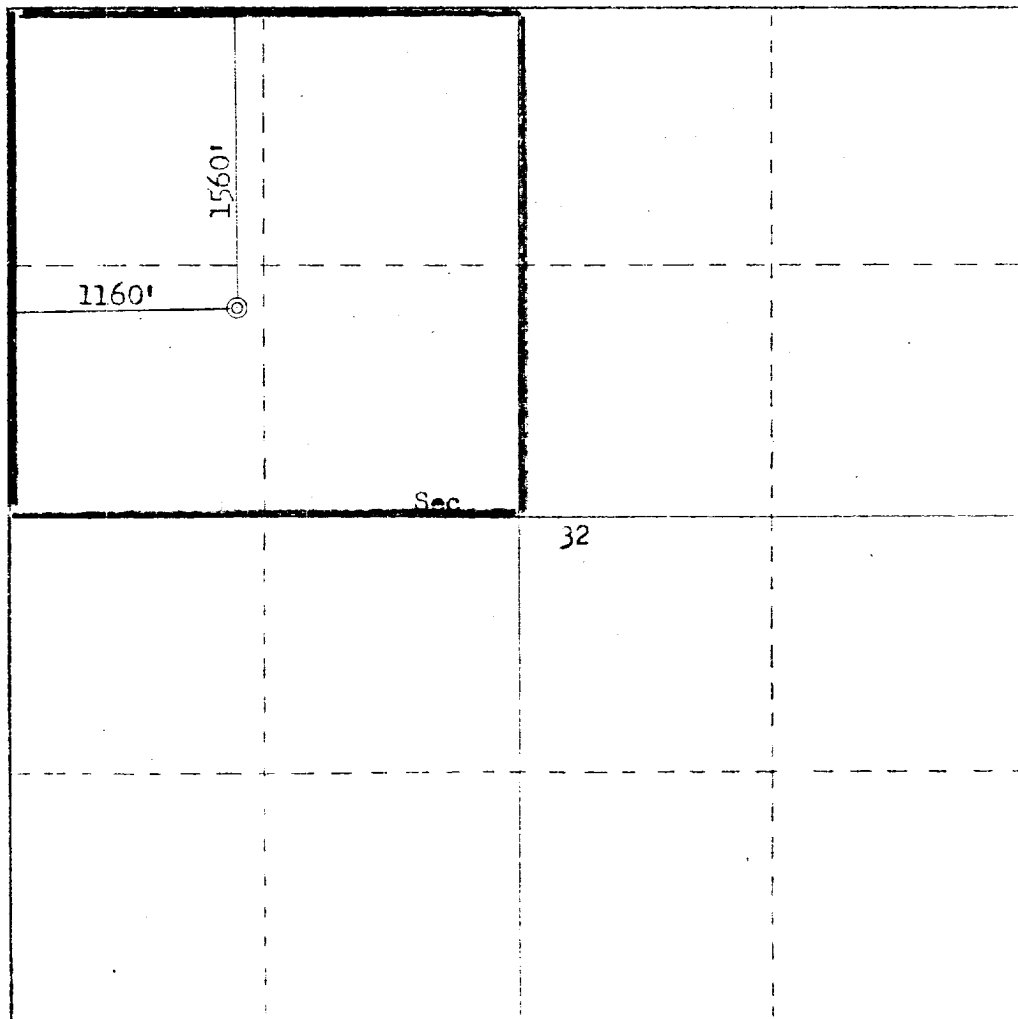

CERTIFICATION

I hereby certify that the information contained herein is true and complete to the best of my knowledge and belief.

*Paul C. Ellison*

Name  
**Paul C. Ellison**  
Position  
**Production Manager**  
Company  
**Benson Mineral Group, Inc.**  
Date  
**September 8, 1978**

I hereby certify that the well location shown on this plat was plotted from field notes of actual surveys made by me or under my supervision, and that the same is true and correct to the best of my knowledge and belief.

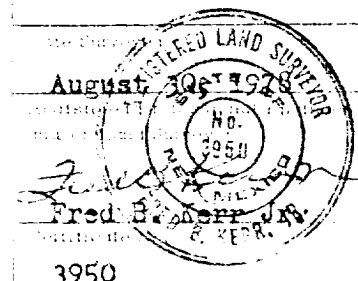

3950