

All distances must be from the outer boundary of the section.

| | | | | |
|-------------------------------------------|--------------------------------------|-------------------------------------|---------------------------------------|----------------------------------|
| Operator KENAI OIL AND GAS INC. | | Lease DOMESTIC FEDERAL 13 | | Well No. #41 |
| Unit Letter A | Section 13 | Township 23N | Range 8W | County San Juan County |
| Actual Footage Location of Well: | | | | |
| 790 feet from the North line and | | 1080 feet from the East line | | |
| Ground Level Elev. 7068 | Producing Formation Gallup | Pool Wildcat | Dedicated Acreage: 40 Acres | |

1. Outline the acreage dedicated to the subject well by colored pencil or hatchure marks on the plat below.
2. If more than one lease is dedicated to the well, outline each and identify the ownership thereof (both as to working interest and royalty).
3. If more than one lease of different ownership is dedicated to the well, have the interests of all owners been consolidated by communitization, unitization, force-pooling, etc?

☐ Yes ☐ No If answer is "yes," type of consolidation _____

If answer is "no," list the owners and tract descriptions which have actually been consolidated. (Use reverse side of this form if necessary.) _____

No allowable will be assigned to the well until all interests have been consolidated (by communitization, unitization, forced-pooling, or otherwise) or until a non-standard unit, eliminating such interests, has been approved by the Division.

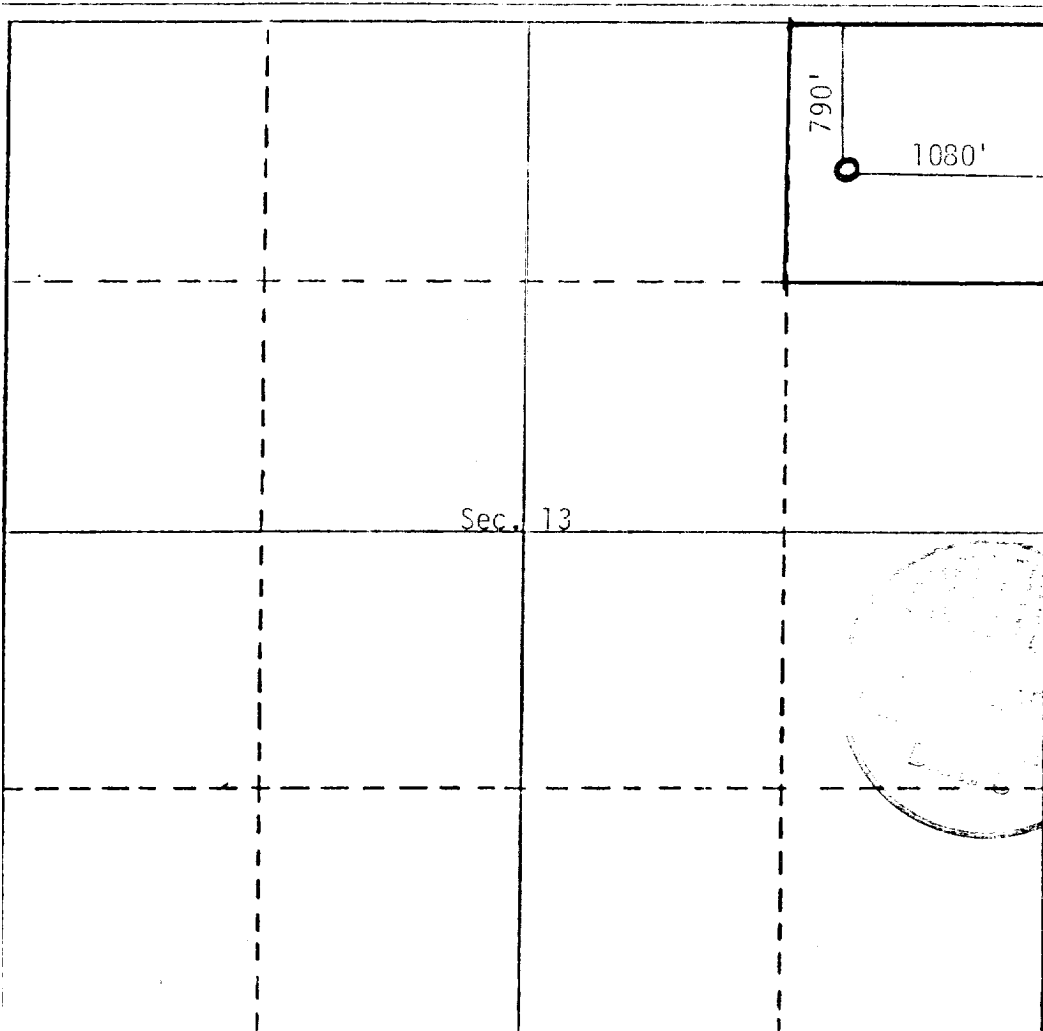

CERTIFICATION

I hereby certify that the information contained herein is true and complete to the best of my knowledge and belief.

George B. Judd
Name

Manager-Drilling and Production
Position

KENAI OIL AND GAS INC.
Company

July 2, 1980
Date

July 2, 1980
Date

Date

I hereby certify that the well location shown on this plat was plotted from field notes of actual surveys made by me or under my supervision, and that the same is true and correct to the best of my knowledge and belief.

Date Surveyed

Registered Professional Engineer
or Licensed Surveyor

Certificate No.