

UNITED STATES
DEPARTMENT OF THE INTERIOR
GEOLOGICAL SURVEY

30045-25318

APPLICATION FOR PERMIT TO DRILL, DEEPEN, OR PLUG BACK

1a. TYPE OF WORK
 DRILL ☒ DEEPEN ☐ PLUG BACK ☐
 b. TYPE OF WELL
 OIL WELL ☒ GAS WELL ☐ OTHER ☐
 SINGLE ZONE ☒ MULTIPLE ZONE ☐
 2. NAME OF OPERATOR
 Kenai Oil & Gas, Inc.
 3. ADDRESS OF OPERATOR
 717 - 17 Street, Suite 2000, Denver, CO 80202
 4. LOCATION OF WELL (Report location clearly and in accordance with any State requirements.)
 At surface
 1665' FNL, & 1840' FWL, Sec. 12
 At proposed prod. zone
 14. DISTANCE IN MILES AND DIRECTION FROM NEAREST TOWN OR POST OFFICE*
 44 Miles SE Bloomfield, NM
 10. DISTANCE FROM PROPOSED*
 LOCATION TO NEAREST
 PROPERTY OR LEASE LINE, FT.
 (Also to nearest drig. unit line, if any) 1665'
 16. NO. OF ACRES IN LEASE
 800
 17. NO. OF ACRES ASSIGNED
 TO THIS WELL
 40
 18. DISTANCE FROM PROPOSED LOCATION*
 TO NEAREST WELL, DRILLING, COMPLETED,
 OR APPLIED FOR, ON THIS LEASE, FT. 1700
 19. PROPOSED DEPTH
 5275'
 20. ROTARY OR CABLE TOOLS
 Rotary
 21. ELEVATIONS (Show whether DF, RT, GR, etc.)
 7006' ungraded ground
 22. APPROX. DATE WORK WILL START*
 Upon approval

5. LEASE DESIGNATION AND SERIAL NO.
 NM 36946
 6. IF INDIAN, ALLOTTEE OR TRIBE NAME
 7. UNIT AGREEMENT NAME
 8. FARM OR LEASE NAME
 Federal 12
 9. WELL NO.
 22
 10. FIELD AND POOL, OR WILDCAT
 11. SEC., T., E., M., OR BLK.
 AND SURVEY OR AREA
 Lybrook Gallup Ext.
 Sec. 12, T23N, R8W
 12. COUNTY OR PARISH
 San Juan
 13. STATE
 NM

23. PROPOSED CASING AND CEMENTING PROGRAM

SIZE OF HOLE	SIZE OF CASING	WEIGHT PER FOOT	SETTING DEPTH	QUANTITY OF CEMENT
12 1/2	8 5/8"	24#	500'	300 cu ft. to circ.
7 7/8"	4 1/2"	11.6#	5275'	800 cu ft. 2 stage

It is proposed to drill to test the Gallup formation. If production is indicated, by log or by test, the well will be perforated & hydraulically stimulated.

A 3000 psi WP, 6000 psi test double gate BOP with blind rams & pipe rams will be used while drilling & completing.

IN ABOVE SPACE DESCRIBE PROPOSED PROGRAM: If proposal is to deepen or plug back, give data on present productive zone and proposed new productive zone. If proposal is to drill or deepen directionally, give pertinent data on subsurface locations and measured and true vertical depths. Give blowout preventer program, if any.

24. SIGNED [Signature] TITLE Agent DATE 11-30-81
 (This space for Federal or State office use)

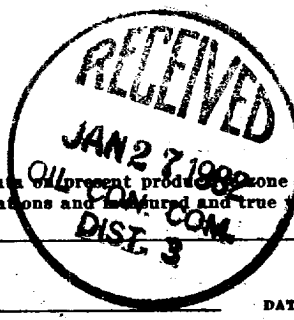

PERMIT NO. _____ APPROVAL DATE _____
 APPROVED BY _____ TITLE _____ DATE _____
 CONDITIONS OF APPROVAL, IF ANY:

DRILLING OPERATIONS AUTHORIZED ARE
 SUBJECT TO COMPLIANCE WITH ATTACHED
 "GENERAL REQUIREMENTS"

NMOCC

JAN 25 1982
 [Signature]

STATE OF NEW MEXICO
ENERGY AND MINERALS DEPARTMENT

OIL CONSERVATION DIVISION

P. O. BOX 2088
SANTA FE, NEW MEXICO 87501

Form C-102
Revised 10-1-78

All distances must be from the outer boundaries of the Section.

Operator KENAI OIL & GAS INCORPORATED			Lease FEDERAL 12 NM 36946		Well No. 22
Unit Letter F	Section 12	Township 23N	Range 8W	County San Juan	
Actual Footage Location of Well: 1665 feet from the North line and 1840 feet from the West line					
Ground Level Elev. 7006	Producing Formation Gallup	Pool Lybrook Ext.	Dedicated Acreage: 40 Acres		

1. Outline the acreage dedicated to the subject well by colored pencil or hachure marks on the plat below.
2. If more than one lease is dedicated to the well, outline each and identify the ownership thereof (both as to working interest and royalty).
3. If more than one lease of different ownership is dedicated to the well, have the interests of all owners been consolidated by communitization, unitization, force-pooling, etc?

☐ Yes ☐ No If answer is "yes," type of consolidation _____

If answer is "no," list the owners and tract descriptions which have actually been consolidated. (Use reverse side of this form if necessary.) _____

No allowable will be assigned to the well until all interests have been consolidated (by communitization, unitization, forced-pooling, or otherwise) or until a non-standard unit, eliminating such interests, has been approved by the Commission.

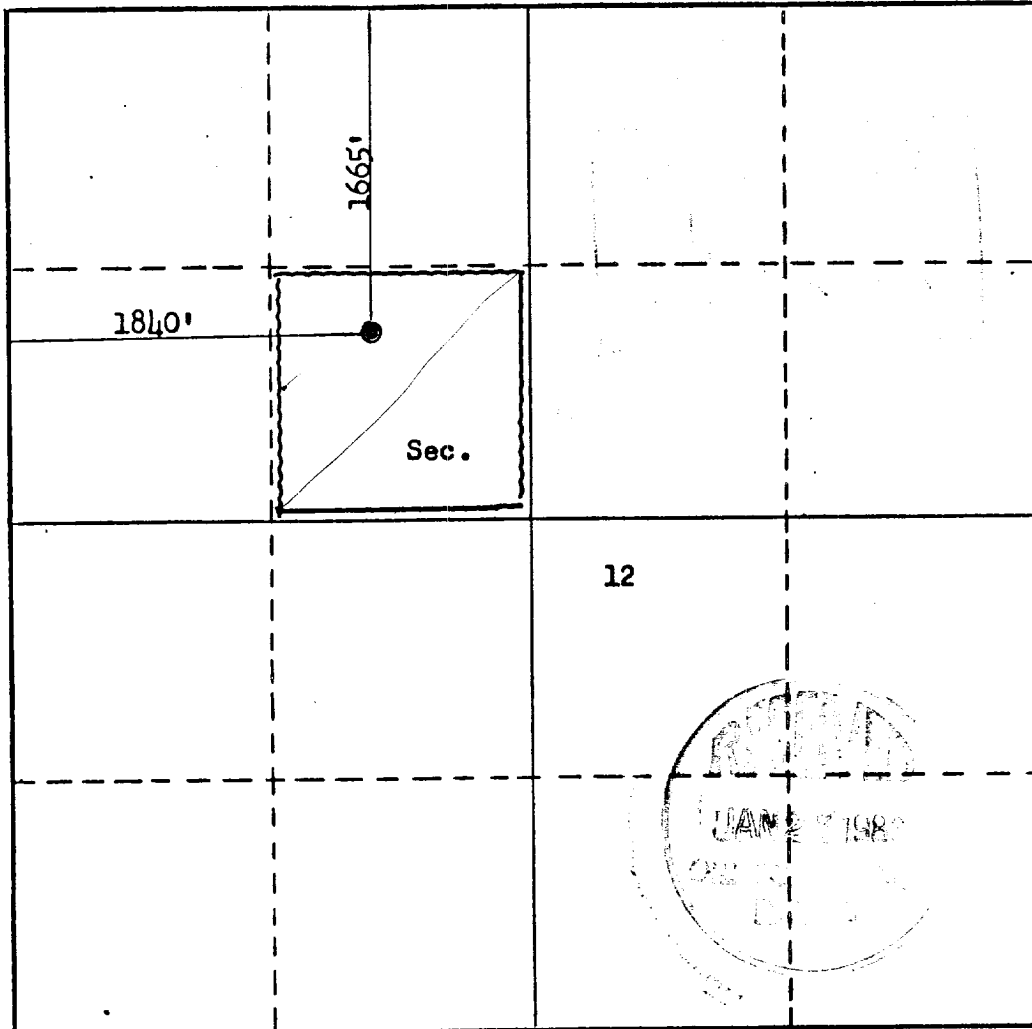

CERTIFICATION

I hereby certify that the information contained herein is true and complete to the best of my knowledge and belief.

Name _____

Position _____

Company _____

Date _____

I hereby certify that the well location shown on this plat was plotted from field notes of actual surveys made by me or under my supervision, and that the same is true and correct to the best of my knowledge and belief.

Date Surveyed _____

November 1981

Registered Professional Engineer and/or Land Surveyor

Fred B. Kerr Jr.

Certificate No. _____

3950

F. B. KERR, JR.

0 330 660 990 1320 1650 1980 2310 2640 2970 3300 3630 3960 4290 4620 4950 5280 5610 5940 6270 6600

LYBROOK NW QUADRANGLE
NEW MEXICO-SAN JUAN CO.
7.5 MINUTE SERIES (TOPOGRAPHIC)

UNITED STATES
DEPARTMENT OF THE INTERIOR
GEOLOGICAL SURVEY

