

STATE OF NEW MEXICO
ENERGY AND MINERALS DEPARTMENT

6 NMOCD 1 File
OIL CONSERVATION DIVISION
P. O. BOX 2088
SANTA FE, NEW MEXICO 87501

Form C-101
Revised 10-1-78

NO. OF COPIES RECEIVED	
DISTRIBUTION	
SANTA FE	
FILE	
U.S.G.S.	
LAND OFFICE	
OPERATOR	

5A. Indicate Type of Lease
STATE ☒ FEE ☐
5. State Oil & Gas Lease No.
LH-1896

APPLICATION FOR PERMIT TO DRILL, DEEPEN, OR PLUG BACK

1a. Type of Work b. Type of Well OIL WELL <input checked="" type="checkbox"/> GAS WELL <input type="checkbox"/> OTHER <input type="checkbox"/> DEEPEN <input type="checkbox"/> PLUG BACK <input type="checkbox"/> SINGLE ZONE <input type="checkbox"/> MULTIPLE ZONE <input type="checkbox"/>		7. Unit Agreement Name
2. Name of Operator Dugan Production Corp.		8. Farm or Lease Name Wit's End
3. Address of Operator P O Box 208, Farmington, NM 87499		9. Well No. 1
4. Location of Well UNIT LETTER 0 LOCATED 660' FEET FROM THE South LINE AND 1980 FEET FROM THE East LINE OF SEC. 2 TWP. 23N RGE. 10W NMPM		10. Field and Pool, or Wildcat Undesignated Gallup
19. Proposed Depth 5000'		19A. Formation Gallup
20. Rotary or C.T. Rotary		12. County San Juan
21. Elevations (Show whether DF, RT, etc.) 6754' GL	21A. Kind & Status Plug. Bond State Wide	21B. Drilling Contractor Four Corners Drilling
22. Approx. Date Work will start February 15, 1985		

PROPOSED CASING AND CEMENT PROGRAM

SIZE OF HOLE	SIZE OF CASING	WEIGHT PER FOOT	SETTING DEPTH	SACKS OF CEMENT	EST. TOP
12-1/4"	8-5/8"	32#	200'	150 cf	Surface
7-7/8"	4-1/2"	10.5#	5000'	1680 cf	Surface

Plan to drill a 12-1/4" hole and set 200' of 8-5/8" OD, 32#, K-55 surface casing; then plan to drill a 7-7/8" hole to total depth with gel-water-mud program to test the Gallup formation. Plan to run IES and CDL logs. If deemed productive, will run 4-1/2", 10.5#, J-55 casing, selectively perforate, frac, clean out after frac, and complete well.

APPROVAL EXPIRES 6-12-85
UNLESS DRILLING IS COMMENCED.
SPUD NOTICE MUST BE SUBMITTED
WITHIN 10 DAYS.

RECEIVED
DEC 12 1984
OIL CON. DIV.
DIST. 3

IN ABOVE SPACE DESCRIBE PROPOSED PROGRAM: IF PROPOSAL IS TO DEEPEN OR PLUG BACK, GIVE DATA ON PRESENT PRODUCTIVE ZONE AND PROPOSED NEW PRODUCTIVE ZONE. GIVE BLOWOUT PREVENTER PROGRAM, IF ANY.

I hereby certify that the information above is true and complete to the best of my knowledge and belief.

Signed Sherman E. Dugan Sherman E. Dugan Title Geologist Date 12-11-84

(This space for State Use)

APPROVED BY [Signature] TITLE SUPERVISOR DISTRICT # 3 DATE DEC 12 1984

CONDITIONS OF APPROVAL, IF ANY:

BOP required

All distances must be from the outer boundaries of the Section.

Operator Dugan Production Corporation		Lease Wit's End		Well No. 1
Unit Letter 0	Section 2	Township 23 North	Range 10 West	County San Juan
Actual Footage Location of Well: 660 feet from the South line and 1980 feet from the East line				
Ground Level Elev. 6754	Producing Formation Gallup	Pool Undesignated Gallup	Dedicated Acreage: 40 Acres	

1. Outline the acreage dedicated to the subject well by colored pencil or hatchure marks on the plat below.
2. If more than one lease is dedicated to the well, outline each and identify the ownership thereof (both as to working interest and royalty).
3. If more than one lease of different ownership is dedicated to the well, have the interests of all owners been consolidated by communitization, unitization, force-pooling, etc?

☐ Yes ☐ No If answer is "yes," type of consolidation _____

If answer is "no," list the owners and tract descriptions which have actually been consolidated. (Use reverse side of this form if necessary.) _____

No allowable will be assigned to the well until all interests have been consolidated (by communitization, unitization, forced-pooling, or otherwise) or until a non-standard unit, eliminating such interests, has been approved by the Division.

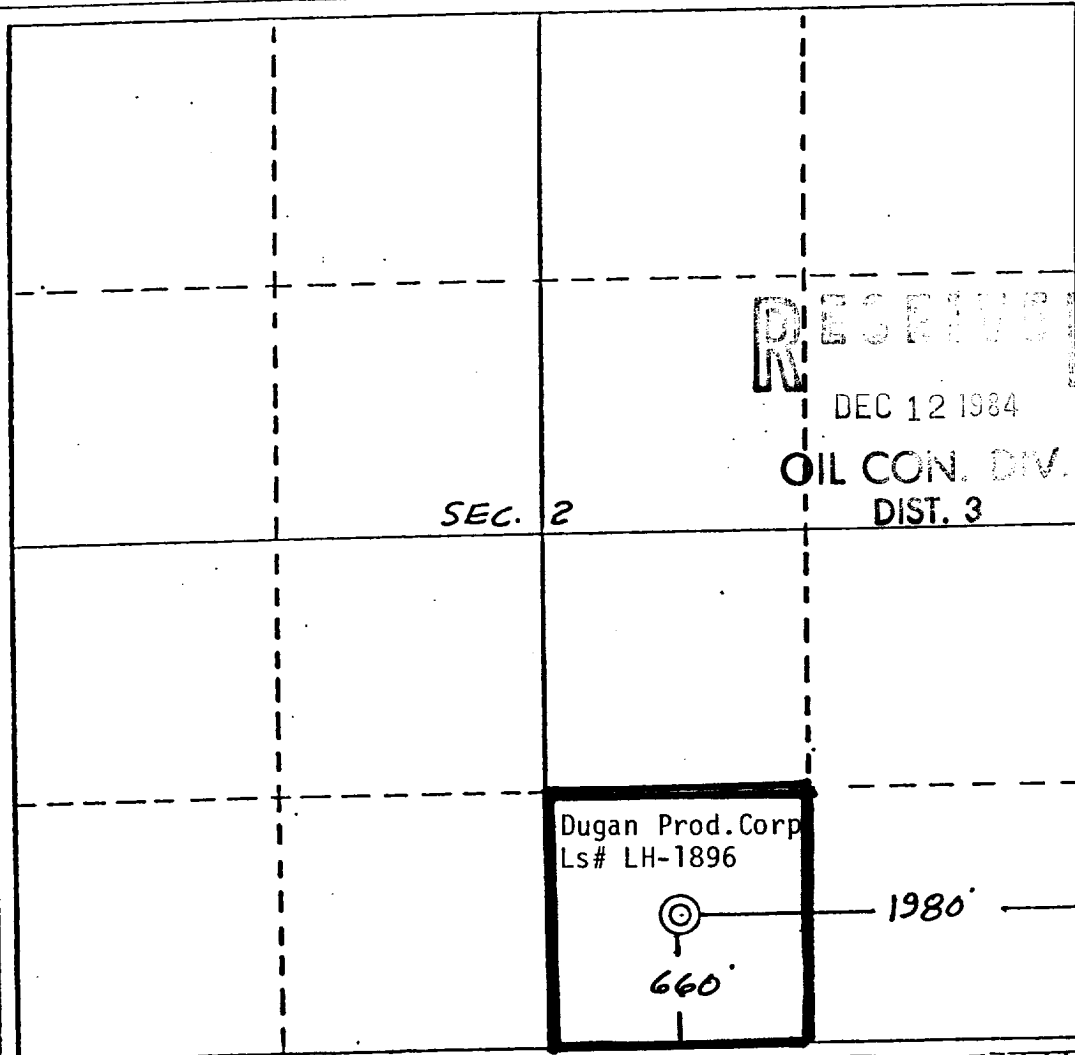

CERTIFICATION

I hereby certify that the information contained herein is true and complete to the best of my knowledge and belief.

Sherman E. Dugan
Name

Sherman E. Dugan

Position
Geologist

Company
Dugan Production Corp.

Date
12-11-84

EDGAR L. RISENHOVER
NEW MEXICO
5979
I hereby certify that the location of the well is as shown on the plat, and that the same is correct to the best of my knowledge and belief.

Date Surveyed
November 30, 1984
Registered Professional Engineer
and/or Land Surveyor

Edgar L. Risenhoover

Certificate No. 5979

Edgar L. Risenhoover, L.S.

