

5 BLM 1 File  
UNITED STATES  
DEPARTMENT OF THE INTERIOR  
BUREAU OF LAND MANAGEMENT

SUBMIT IN TRIPLICATE\*  
(Other instructions on re-  
verse side)

Form approved.  
Budget Bureau No. 1004-0135  
Expires August 31, 1985

5. LEASE DESIGNATION AND SERIAL NO.

NM 55849

6. IF INDIAN, ALLOTTEE OR TRIBE NAME

7. UNIT AGREEMENT NAME

8. FARM OR LEASE NAME

E.T. Lard

9. WELL NO.

1

10. FIELD AND POOL, OR WILDCAT

Wildcat - Gallup

11. SEC., T., R., M., OR BLK. AND  
SURVEY OR AREA

Sec. 4, T23N, R12W, NMPM

12. COUNTY OR PARISH 13. STATE

San Juan

NM

SUNDRY NOTICES AND REPORTS ON WELLS

(Do not use this form for proposals to drill or to deepen or plug back to a different reservoir.  
Use "APPLICATION FOR PERMIT—" for such proposals.)

1.

OIL WELL ☒ GAS WELL ☐ OTHER

2. NAME OF OPERATOR

DUGAN PRODUCTION CORP.

3. ADDRESS OF OPERATOR

P O Box 208, Farmington, NM 87499

4. LOCATION OF WELL (Report location clearly and in accordance with any State requirements.\*  
See also space 17 below.)  
At surface

892' FSL - 1743' FWL

14. PERMIT NO.

15. ELEVATIONS (Show whether DF, ST, GR, etc.)

5974' GR

16.

Check Appropriate Box To Indicate Nature of Notice, Report, or Other Data

NOTICE OF INTENTION TO:

TEST WATER SHUT-OFF

FRACTURE TREAT

SHOOT OR ACIDIZE

REPAIR WELL

(Other)

PELL OR ALTER CASING

MULTIPLE COMPLETION

ABANDON\*

CHANGE PLANS

Plug Back

X

SUBSEQUENT REPORT OF:

WATER SHUT-OFF

FRACTURE TREATMENT

SHOOTING OR ACIDIZING

(Other)

REPAIRING WELL

ALTERING CASING

ABANDONMENT\*

(NOTE: Report results of multiple completion on Well  
Completion or Recompletion Report and Log form.)

17. DESCRIBE PROPOSED OR COMPLETED OPERATIONS (Clearly state all pertinent details, and give pertinent dates, including estimated date of starting any proposed work. If well is directionally drilled, give subsurface locations and measured and true vertical depths for all markers and zones pertinent to this work.)\*

This well was perforated with 30 holes from 3281 - 3604'. The well was then sand-water frac'd and swab tested. No commercial quantities of oil or gas were tested. We propose to plug back this well from PBTD 3611' to 3165' with 50 sx neat cement. We will then perf and test selected zones in the Mesaverde formation.

Discussed this procedure with Steve Mason 11-10-87 during phone conversation.

A plat (NMOCD Form C-102) is attached reflecting the proposed change to Wildcat Mesaverde.

18. I hereby certify that the foregoing is true and correct

SIGNED

Jim L. Jacobs

TITLE

Geologist

DATE

11-10-87

(This space for Federal or State office use)

APPROVED BY

TITLE

CONDITIONS OF APPROVAL, IF ANY:

DATE

## OIL CONSERVATION DIVISION

STATE OF NEW MEXICO  
ENERGY AND MINERALS DEPARTMENTP. O. BOX 2088  
SANTA FE, NEW MEXICO 87501Form C-102  
Revised 10-1-78

All distances must be from the outer boundaries of the Section.

|   |   |                             |                              |  |                      |
|---|---|-----------------------------|------------------------------|--|----------------------|
| Operator<br><b>DUGAN PRODUCTION CORP.</b>   |   |                             | Lease<br><b>E.T. Lard</b>    |  | Well No.<br><b>1</b> |
| Unit Letter<br><b>N</b>   | Section<br><b>4</b>                     | Township<br><b>23 North</b> | Range<br><b>12 West</b>      | County<br><b>San Juan</b>              |                      |
| Actual Footage Location of Well:<br><b>892</b> feet from the <b>South</b> line and <b>1743</b> feet from the <b>West</b> line |   |                             |                              |  |                      |
| Ground Level Elev.<br><b>5974' GR</b>   | Producing Formation<br><b>Mesaverde</b> |                             | Pool<br><b>Wildcat (Gas)</b> | Dedicated Acreage:<br><b>160</b> Acres |                      |

1. Outline the acreage dedicated to the subject well by colored pencil or hatchure marks on the plat below.
2. If more than one lease is dedicated to the well, outline each and identify the ownership thereof (both as to working interest and royalty).
3. If more than one lease of different ownership is dedicated to the well, have the interests of all owners been consolidated by communitization, unitization, force-pooling, etc?

☐ Yes ☐ No If answer is "yes," type of consolidation \_\_\_\_\_

If answer is "no," list the owners and tract descriptions which have actually been consolidated. (Use reverse side of this form if necessary.) \_\_\_\_\_

No allowable will be assigned to the well until all interests have been consolidated (by communitization, unitization, forced-pooling, or otherwise) or until a non-standard unit, eliminating such interests, has been approved by the Division.

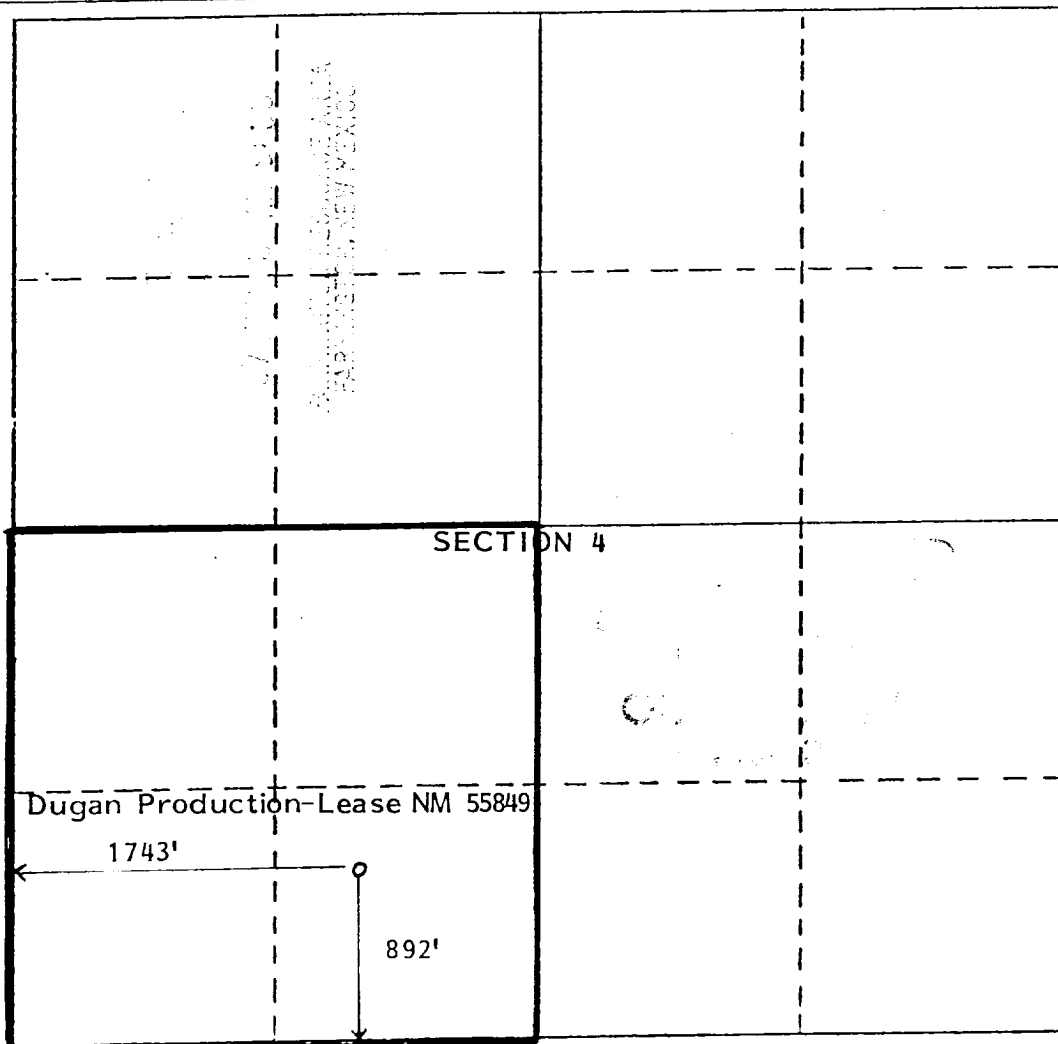

## CERTIFICATION

I hereby certify that the information contained herein is true and complete to the best of my knowledge and belief.

Name

Jim L. Jacobs

Position

Geologist

Company

Dugan Production Corp.

Date

11-10-87

I hereby certify that the well location shown on this plat was plotted from field notes of actual surveys made by me or under my supervision, and that the same is true and correct to the best of my knowledge and belief.

Original plat surveyed

Date Surveyed

by Gerald G. Huddles

Registered Professional Engineer  
and/or Land Surveyor

Certificate No.

6844