

NEW MEXICO
OIL CONSERVATION COMMISSION

Form C-128

Well Location and/or Gas Proration Plat

Date _____

Operator U. S. Smelting Refining & Mining Company Lease _____

Well No. Jicarilla 1-33 Section 33 Township 24 North Range 4 West NMPM

Located 490 Feet From South Line, 620 Feet From West Line,

Rio Arriba County, New Mexico. G. L. Elevation _____

Name of Producing Formation _____ Pool _____ Dedicated Acreage _____

(Note: All distances must be from outer boundaries of Section)

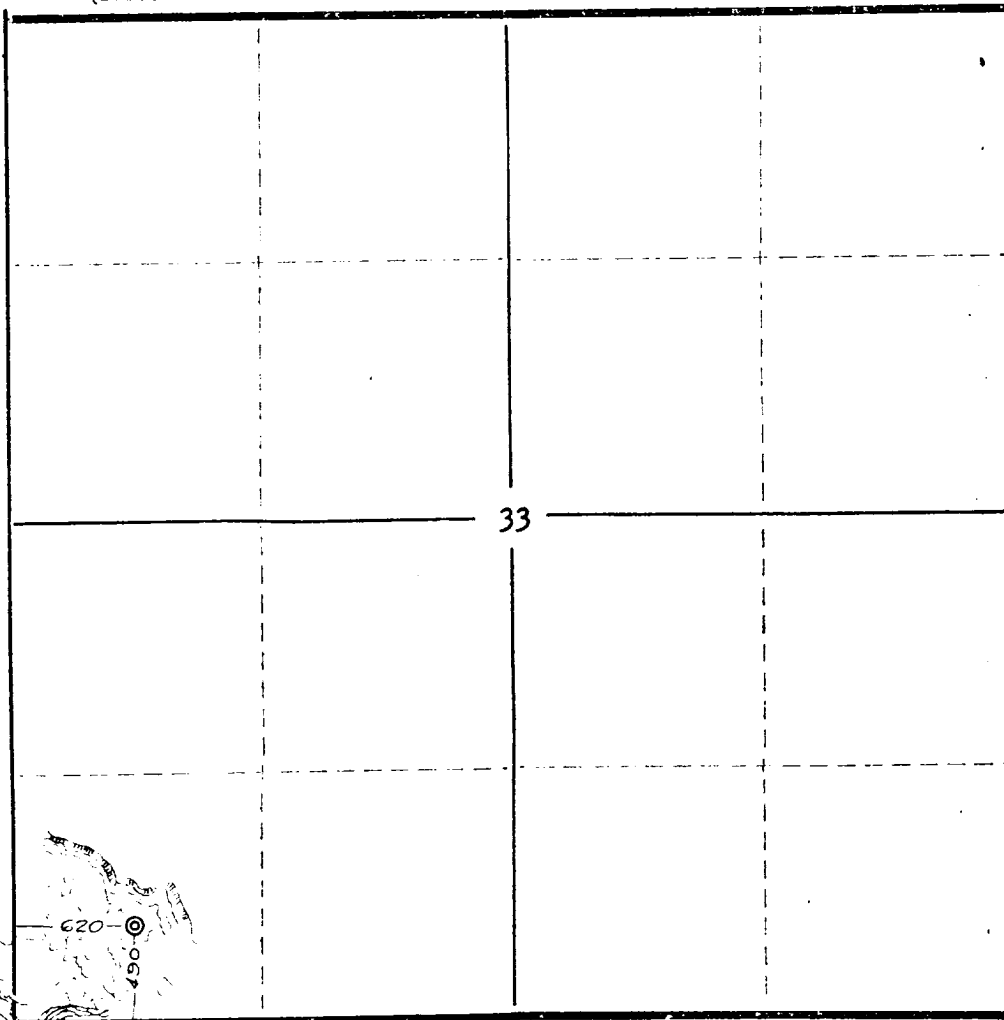

NOTE

This section of form is to be used for gas wells only.



SCALE: 1" = 1000'

1. Is this Well a Dual Comp. ? Yes No .
2. If the answer to Question 1 is yes, are there any other dually completed wells within the dedicated acreage?
Yes No .

Name _____
 Position _____
 Representing _____
 Address _____

This is to certify that the above plat was prepared from field notes of actual surveys made by me or under my supervision and that the same are true and correct to the best of my knowledge and belief.

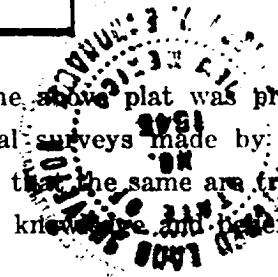

Date Surveyed May 6, 1956

Ernest V. Echohawk

Ernest V. Echohawk
Reg. Land Surveyor, N. Mex., Reg. No. 1545