

NEW MEXICO  
OIL CONSERVATION COMMISSION

Form C-128

Well Location and/or Gas Proration Plat

Date May 15, 1956

Operator HUMBLE OIL & REFINING COMPANY Lease JICARILLA APACHE TRIBE OF INDIANS "C"

Well No. 2 Section 34 Township - 24 - N Range - 5 W NMPM

Located 990 Feet From SOUTH Line, 990 Feet From EAST Line,

RIO ARRIBA County, New Mexico. G. L. Elevation \_\_\_\_\_

OTERO

Name of Producing Formation PICTURED CLIFFS Pool PICTURED CLIFF Dedicated Acreage 160

(Note: All distances must be from outer boundaries of Section)

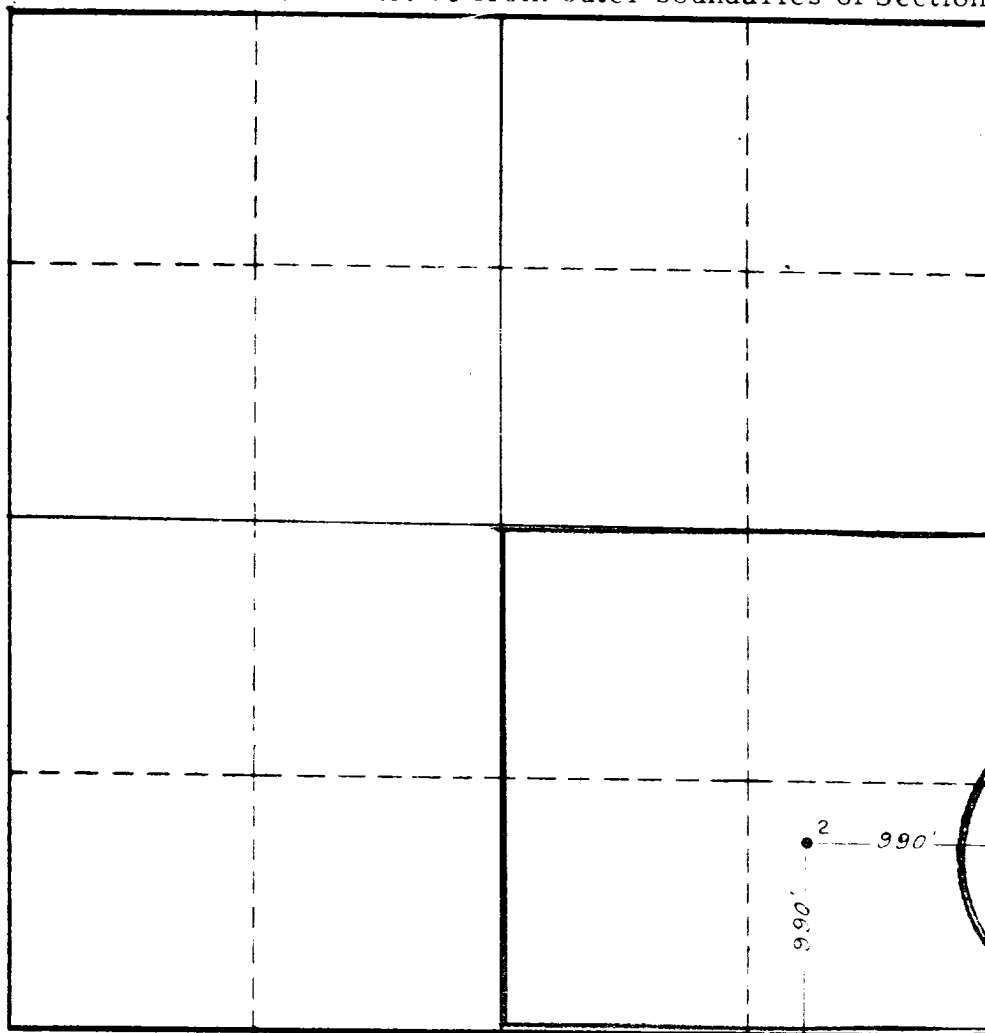

1. Is this Well a Dual Comp. ? Yes No \_\_\_\_\_
2. If the answer to Question 1 is yes, are there any other dually completed wells within the dedicated acreage ? Yes \_\_\_\_\_ No \_\_\_\_\_

This is to certify that the above plat was prepared from field notes of actual surveys made by me or under my supervision and that the same are true and correct to the best of my knowledge and belief.

Name N. J. Venoles  
Position ASSISTANT DIVISION SUPERINTENDENT  
Representing HUMBLE OIL & REFINING COMPANY  
Address BOX 1600 MIDLAND, TEXAS

Date Surveyed 9-13-55  
E. T. Shahan  
Registered Professional Engineer and/or  
Land Surveyor  
Lease No. 163112

**OIL CONSERVATION COMMISSION**

**AZTEC DISTRICT OFFICE**

No. Copies Received 4

**DISTRIBUTION**

	COPIES	
Director	2	
Asst. Dir.	1	
Chief Clerk	1	
Public Affairs		
Spec. Inv. & Sec.		
U. S. G. S.	1	
Transporter		
File	1	<input checked="" type="checkbox"/>