

(SUBMIT IN TRIPLICATE)

UNITED STATES
DEPARTMENT OF THE INTERIOR
GEOLOGICAL SURVEY

Land Office Santa Fe
Lease No. NM 0101694
Unit _____

SUNDRY NOTICES AND REPORTS ON WELLS

NOTICE OF INTENTION TO DRILL.....	<input checked="" type="checkbox"/>	SUBSEQUENT REPORT OF WATER SHUT-OFF.....	
NOTICE OF INTENTION TO CHANGE PLANS.....		SUBSEQUENT REPORT OF SHOOTING OR ACIDIZING.....	
NOTICE OF INTENTION TO TEST WATER SHUT-OFF.....		SUBSEQUENT REPORT OF ALTERING CASING.....	
NOTICE OF INTENTION TO RE-DRILL OR REPAIR WELL.....		SUBSEQUENT REPORT OF RE-DRILLING OR REPAIR.....	
NOTICE OF INTENTION TO SHOOT OR ACIDIZE.....		SUBSEQUENT REPORT OF ABANDONMENT.....	
NOTICE OF INTENTION TO PULL OR ALTER CASING.....		SUPPLEMENTARY WELL HISTORY.....	
NOTICE OF INTENTION TO ABANDON WELL.....			

(INDICATE ABOVE BY CHECK MARK NATURE OF REPORT, NOTICE, OR OTHER DATA)

December 7, 19 61

Melik-Federal
Well No. 2 is located 1750 ft. from XXX line and 1850 ft. from W line of sec. 36
SW/4 - 36 24 North 2 West NMPM
(1/4 Sec. and Sec. No.) (Twp.) (Range) (Meridian)
Undesignated Rio Arriba New Mexico
(Field) (County or Subdivision) (State or Territory)

The elevation of the ~~drain~~ ground floor above sea level is 7393 ft.

DETAILS OF WORK

(State names of and expected depths to objective sands; show sizes, weights, and lengths of proposed casings; indicate mud, cementing points, and all other important proposed work)

To set approx. 100 feet of 3 5/8 inch surface casing and cement with approx. 50 sacks. To drill with rotary tools to an approx. total depth of 3400 feet. To run an electric log and if productive to set approx. 3400 feet of 4 1/2 inch new casing and cement with approx. 100 sacks. To perforate the Pictured Cliffs pay zone and sand-water frac same. To run approx. 3350 feet of 1 1/4 inch EUE tubing and to complete and produce as a Pictured Cliffs gas producer. To comply with the rules and regulations of the U.S.O.S. and New Mexico Oil and Gas Commission.

I understand that this plan of work must receive approval in writing by the Geological Survey before operations are commenced.

Company SHAR-ALAN OIL COMPANY
Address 1402 Denver U. S. National Center
Denver 2, Colorado

Send approval to:
By Richard S. Hunt
Title Mgr., Lands and Exploration
Box 1428, Durango, Colorado

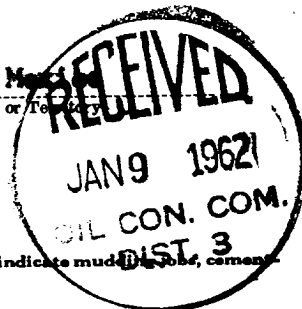

NUMBER OF COPIES RECEIVED	
DISTRIBUTION	
SANTA FE	
FILE	
U.S.G.S.	
LAND OFFICE	
TRANSPORTER	OIL
	GAS
PRODUCTION OFFICE	
OPERATOR	

FORM C-128
Revised 5/1/57

NEW MEXICO OIL CONSERVATION COMMISSION
WELL LOCATION AND ACREAGE DEDICATION PLAT
SEE INSTRUCTIONS FOR COMPLETING THIS FORM ON THE REVERSE SIDE

SECTION A

Operator Irving Pasternak DBA Shar-Alan Oil Company		Lease NM 010 1694	Well No. 2 Melik-Federal
Unit Letter K	Section 36	Township 24 North	Range 2 West
Actual Footage Location of Well: 1750 feet from the South line and 1850 feet from the West line		County Rio Arriba	
Ground Level Elev. 7393 ungraded	Producing Formation Picture Cliff	Pool undesignated	Dedicated Acreage: 160 Acres

1. Is the Operator the only owner in the dedicated acreage outlined on the plat below? YES NO . ("Owner" means the person who has the right to drill into and to produce from any pool and to appropriate the production either for himself or for himself and another. (65-3-29 (e) NMSA 1935 Comp.)
2. If the answer to question one is "no," have the interests of all the owners been consolidated by communitization agreement or otherwise? YES NO . If answer is "yes," Type of Consolidation _____
3. If the answer to question two is "no," list all the owners and their respective interests below:

Owner Irving Pasternak, DBA Shar-Alan Oil Company	Land Description SW Section 36, T24N, R2W
-------------------------------------------------------------	-----------------------------------------------------

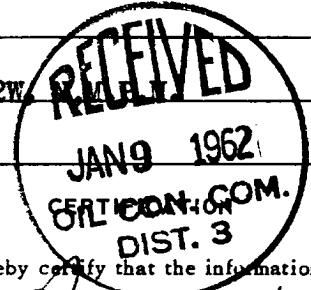

SECTION B

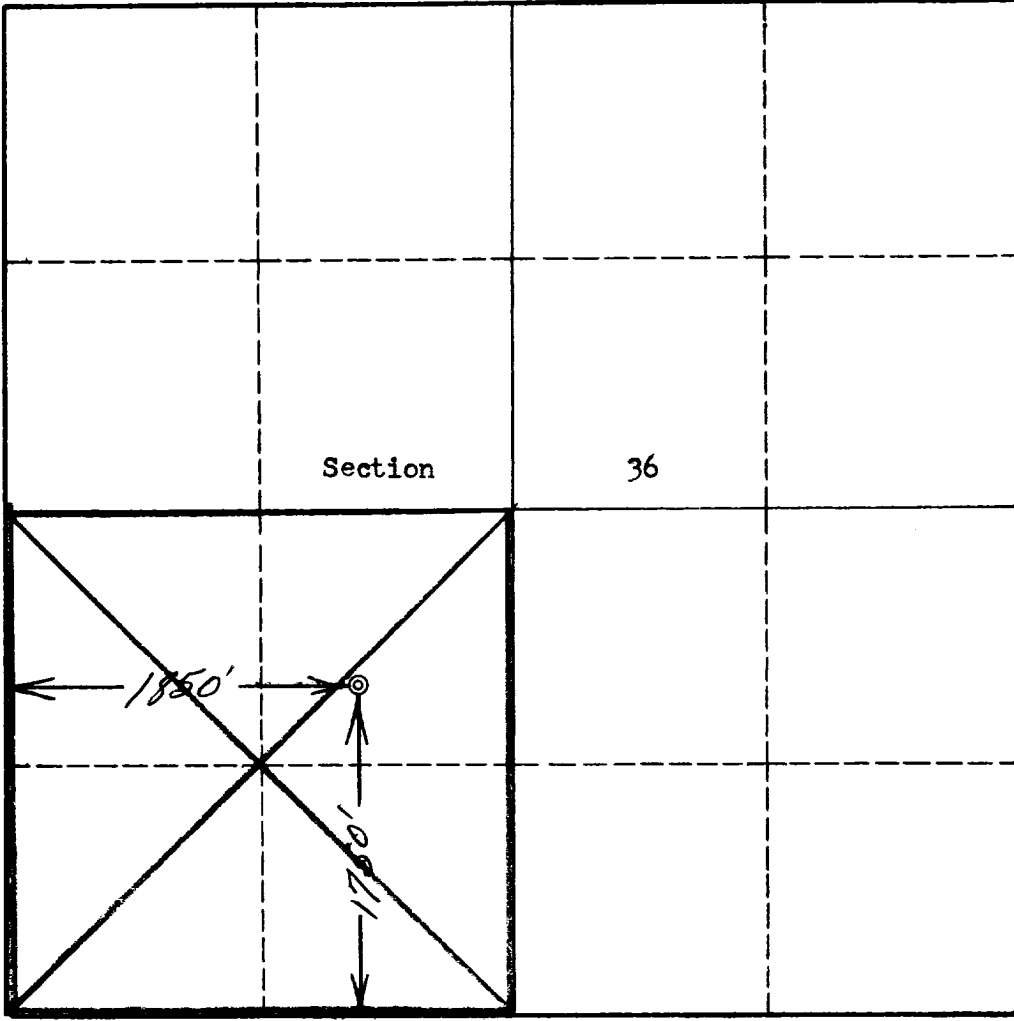

I hereby certify that the information in SECTION A above is true and complete to the best of my knowledge and belief.

Name
Richard S. Hunt
Position **Manager of Lands & Exploration**
Company **Irving Pasternak DBA Shar-Alan Oil Company**
Date
27 December 1961

I hereby certify that the well location shown on the plat in SECTION B was plotted from field notes of actual surveys made by me or under my supervision, and that the same is true and correct to the best of my knowledge and belief.

Date Surveyed
22 December 1961
Registered Professional Engineer and/or Land Surveyor
Robert H. Ernst
Soil Map Engineering Co.
Certificate No.
PE & IS 2463

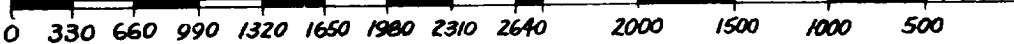

INSTRUCTIONS FOR COMPLETION OF FORM C-128

1. Operator shall furnish and certify to the information called for in Section A.
2. Operator shall outline the dedicated acreage for *both* oil and gas wells on the plat in Section B.
3. A registered professional engineer or land surveyor registered in the State of New Mexico or approved by the Commission shall show on the plat the location of the well and certify this information in the space provided.
4. All distances shown on the plat must be from the outer boundaries of the Section.
5. If additional space is needed for listing owners and their respective interests as required in question 3 of Section A, please use space below.