

(SUBMIT IN TRIPLICATE)

UNITED STATES  
DEPARTMENT OF THE INTERIOR  
GEOLOGICAL SURVEY

Land Office **Santa Fe**  
Lease No. **SP079354-A**  
Unit \_\_\_\_\_

SUNDRY NOTICES AND REPORTS ON WELLS

NOTICE OF INTENTION TO DRILL	<input checked="" type="checkbox"/>	SUBSEQUENT REPORT OF WATER SHUT-OFF
NOTICE OF INTENTION TO CHANGE PLANS		SUBSEQUENT REPORT OF SHOOTING OR ACIDIZING
NOTICE OF INTENTION TO TEST WATER SHUT-OFF		SUBSEQUENT REPORT OF ALTERING CASING
NOTICE OF INTENTION TO RE-DRILL OR REPAIR WELL		SUBSEQUENT REPORT OF RE-DRILLING OR REPAIR
NOTICE OF INTENTION TO SHOOT OR ACIDIZE		SUBSEQUENT REPORT OF ABANDONMENT
NOTICE OF INTENTION TO PULL OR ALTER CASING		SUPPLEMENTARY WELL HISTORY
NOTICE OF INTENTION TO ABANDON WELL		

(INDICATE ABOVE BY CHECK MARK NATURE OF REPORT, NOTICE, OR OTHER DATA)

August 25, 1961

**Wernitz-Federal**

Well No. **3** is located **1650** ft. from **N** line and **1650** ft. from **E** line of sec. **31**

**NE/4** **6** **24N** **1W** **N40PM**  
(1/4 Sec. and Sec. No.) (Twp.) (Range) (Meridian)

**Undesignated** **Rio Arriba** **New Mexico**  
(Field) (County or Subdivision) (State or Territory)

**Ground**  
The elevation of the **drill** floor above sea level is **7492** ft.

DETAILS OF WORK

(State names of and expected depths to objective sands; show sizes, weights, and lengths of proposed casings; indicate mudding jobs, cementing points, and all other important proposed work)

To set approximately 100' of 8 5/8 surface casing and cement with approximately 75 sacks. To drill with rotary tools to an approximate depth of 3200' if production encountered, to set 4 1/2" casing to TD, to perforate and sandfrac the Pictured Cliffs formation, to run 1" EUE tubing to approximately 3100' and complete as a Pictured Cliffs gas producer. To comply with all rules and regulations of the U.S.G.S. New Mexico Oil and Gas Conservation Commission.

I understand that this plan of work must receive approval in writing by the Geological Survey before operations may be commenced.

Company **SHAR-ALAN OIL COMPANY**

Address **1402 Denver U. S. National Center**

**Denver 2, Colorado**

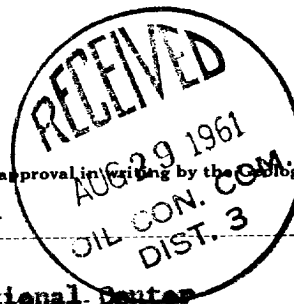

Send approval to  
By *Richard S. Hunt*  
Richard S. Hunt  
Title **Mgr. of Lands & Exploration**  
**Box 1428**  
**Denver, Colorado**

# NEW MEXICO OIL CONSERVATION COMMISSION Well Location and Acreage Dedication Plot

Section A.  
Operator Four States Oil Company Lease Warren-Federal  
Well No. 1 Unit Letter Q Section 31 Township 24 North Range 1 West NMPM  
Located 1650 Feet From North Line, 1650 Feet From East Line  
County Elizabethe G. L. Elevation 7872 Dedicated Acreage 160 Acres  
Name of Producing Formation Pictured Cliffs Pool Undesignated

Date August 14, 1961

1. Is the Operator the only owner\* in the dedicated acreage outlined on the plat below? Yes ☒ No ☐
2. If the answer to question One is "No," have the interests of all the owners been consolidated by communization agreement or otherwise? Yes ☐ No ☐ If answer is "Yes," Type of Consolidation \_\_\_\_\_

3. If the answer to question Two is "No," list all the owners and their respective interests below:

OWNER

LAND DESCRIPTION

AUG 20 1961

U.S. GEOLOGICAL SURVEY  
FARMINGTON, NEW MEXICO

## SECTION B.

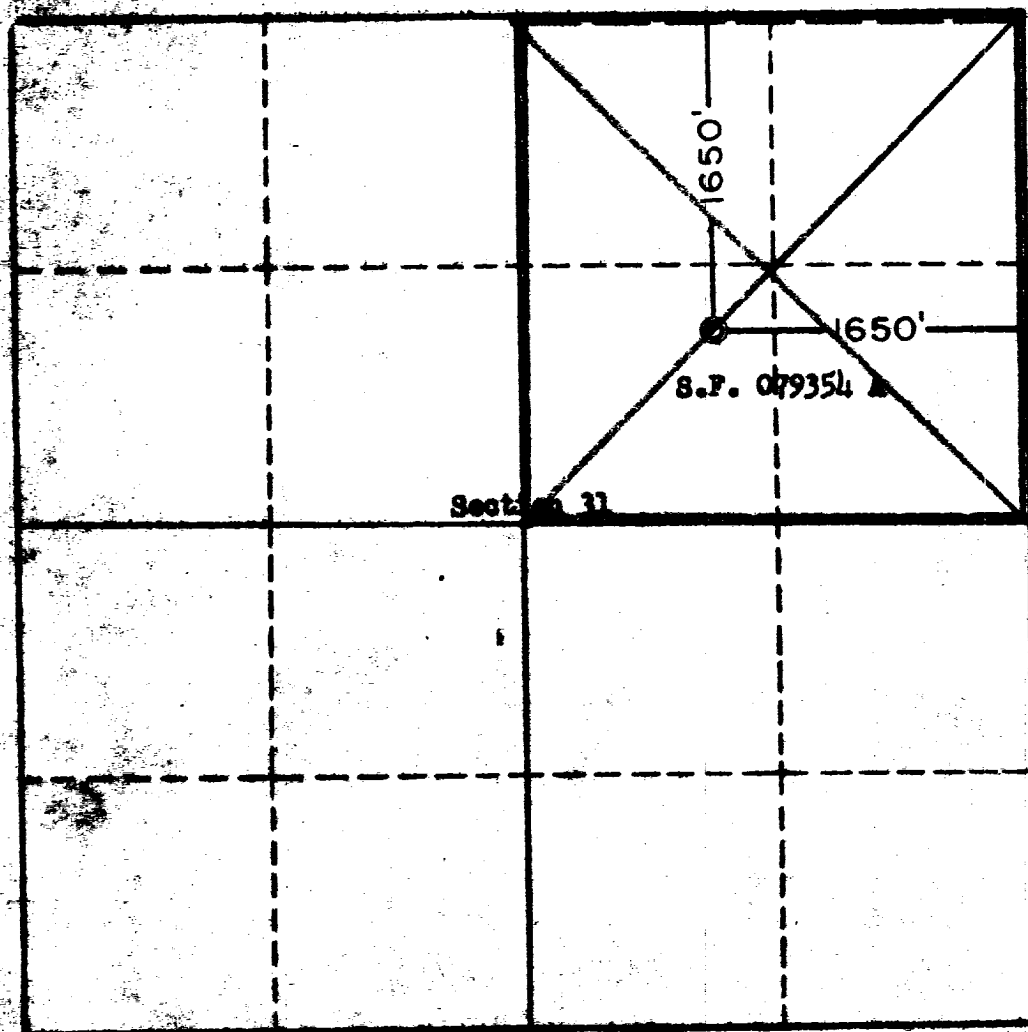

This is to certify that the information in Section A above is true and complete to the best of my knowledge and belief.

Four States Oil Company  
By: Richard S. Hunt  
Mgr. of Lands & Engineering  
(REPRESENTATIVE)

P.O. Box 1488, Durango, Colo.

(ADDRESS)

This is to certify that the information shown on the plat in Section B was plotted from field notes of actual survey under my supervision and is true and correct to the best of my knowledge and belief.



Date Surveyed Aug 3-4, 1961

**Four States Engineering Co.**  
FARMINGTON, NEW MEXICO

C. L. Poter  
REGISTERED ENGINEER OR  
LAND SURVEYOR

Certificate No. 3084