

UNITED STATES
DEPARTMENT OF THE INTERIOR
GEOLOGICAL SURVEY

APPLICATION FOR PERMIT TO DRILL, DEEPEN, OR PLUG BACK

1a. TYPE OF WORK

DRILL ☒DEEPEN ☐PLUG BACK ☐

b. TYPE OF WELL

OIL
WELL ☐GAS
WELL ☒

OTHER

SINGLE
ZONE ☐MULTIPLE
ZONE ☐

2. NAME OF OPERATOR

Continental Oil Company

3. ADDRESS OF OPERATOR

P. O. Box 3312 - Durango, Colorado

4. LOCATION OF WELL (Report location clearly and in accordance with any State requirements.*)

At surface

808' FWL, 987' FWL

At proposed prod. zone

14. DISTANCE IN MILES AND DIRECTION FROM NEAREST TOWN OR POST OFFICE*

38 Miles NW of Cuba, New Mexico

15. DISTANCE FROM PROPOSED*

LOCATION TO NEAREST
PROPERTY OR LEASE LINE, FT.
(Also to nearest drlg. unit line, if any)

808'

18. DISTANCE FROM PROPOSED LOCATION*
TO NEAREST WELL, DRILLING, COMPLETED,
OR APPLIED FOR, ON THIS LEASE, FT.

3300'

16. NO. OF ACRES IN LEASE

2560

19. PROPOSED DEPTH

2350'

17. NO. OF ACRES ASSIGNED
TO THIS WELL

160

20. ROTARY OR CABLE TOOLS

Rotary

21. ELEVATIONS (Show whether DF, RT, GR, etc.)

6630' GR

22. APPROX. DATE WORK WILL START*

5-7-65

23.

PROPOSED CASING AND CEMENTING PROGRAM

SIZE OF HOLE	SIZE OF CASING	WEIGHT PER FOOT	SETTING DEPTH	QUANTITY OF CEMENT
12 1/4"	9 5/8"	36#	200'	100 sacks regular
6 3/4"	4 1/2"	9.5#	2350'	150 sacks neat

We propose to drill the subject well to further develop the Pictured Cliffs reservoir and to increase gas withdrawal rates. A string of surface casing will be cemented to surface. If commercial production is encountered, production casing will be run and cemented and the well completed.

RECEIVED

APR 22 1965

U. S. GEOLOGICAL SURVEY
FARMINGTON, N. M.

IN ABOVE SPACE DESCRIBE PROPOSED PROGRAM: If proposal is to deepen or plug back, give data on present productive zone and proposed new productive zone. If proposal is to drill or deepen directionally, give pertinent data on subsurface locations and measured and true vertical depths. Give blowout preventer program, if any.

24.

Original Signed By

SIGNED

H. D. HALEY

TITLE

District Manager

DATE

4/21/65

(This space for Federal or State office use)

PERMIT NO.

APPROVAL DATE

APPROVED BY

TITLE

DATE

CONDITIONS OF APPROVAL, IF ANY:

*See Instructions On Reverse Side

USGS (4) MROCC (2) DRS HDN Humble

Instructions

General: This form is designed for submitting proposals to perform certain well operations, as indicated, on all types of lands and leases for appropriate action by either a Federal or a State agency, or both, pursuant to applicable Federal and/or State laws and regulations. Any necessary special instructions concerning the use of this form and the number of copies to be submitted, particularly with regard to local, area, or regional procedures and practices, either are shown below or will be issued by, or may be obtained from, the local Federal and/or State office.

Item 1: If the proposal is to redrill to the same reservoir at a different subsurface location or to a new reservoir, use this form with appropriate notations. Consult applicable State or Federal regulations concerning subsequent work proposals or reports on the well.

Item 4: If there are no applicable State requirements, locations on Federal or Indian land should be described in accordance with Federal requirements. Consult local State or Federal office for specific instructions.

Item 14: Needed only when location of well cannot readily be found by road from the land or lease description. A plat, or plats, separate or on this reverse side, showing the roads to, and the surveyed location of, the well, and any other required information, should be furnished when required by Federal or State agency offices.

Items 15 and 16: If well is to be, or has been directionally drilled, give distances for subsurface location of hole in any present or objective production zone.

Item 22: Consult applicable Federal or State regulations, or appropriate officials, concerning approval of the proposal before operations are started.

NUMBER OF COPIES RECEIVED	
DISTRIBUTION	
SANTA FE	
FILE	
U.S.G.S	
LAND OFFICE	
TRANSPORTER	OIL
	GAS
PRODUCTION OFFICE	
OPERATOR	

NEW MEXICO OIL CONSERVATION COMMISSION
WELL LOCATION AND ACREAGE DEDICATION PLAT
 SEE INSTRUCTIONS FOR COMPLETING THIS FORM ON THE REVERSE SIDE

FORM C-128
 Revised 5/1/57

SECTION A

Operator Continental Oil Company		Lease AXI Apache "H"		Well No. 15
Unit Letter D	Section 31	Township 24N	Range 5W	County Rio Arriba
Actual Footage Location of Well: 308 feet from the North line and 987 feet from the West line				
Ground Level Elev. 6630	Producing Formation Pictured Cliffs	Pool Ballard Pictured Cliffs	Dedicated Acreage: 166.95 150 Acres	

1. Is the Operator the only owner in the dedicated acreage outlined on the plat below? YES ☒ NO ____ . ("Owner" means the person who has the right to drill into and to produce from any pool and to appropriate the production either for himself or for himself and another. (65-3-29 (e) NMSA 1935 Comp.)
2. If the answer to question one is "no," have the interests of all the owners been consolidated by communitization agreement or otherwise? YES ____ NO ____ . If answer is "yes," Type of Consolidation _____
3. If the answer to question two is "no," list all the owners and their respective interests below:

Owner	Land Description

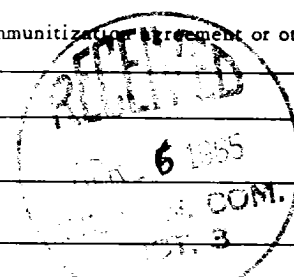

SECTION B

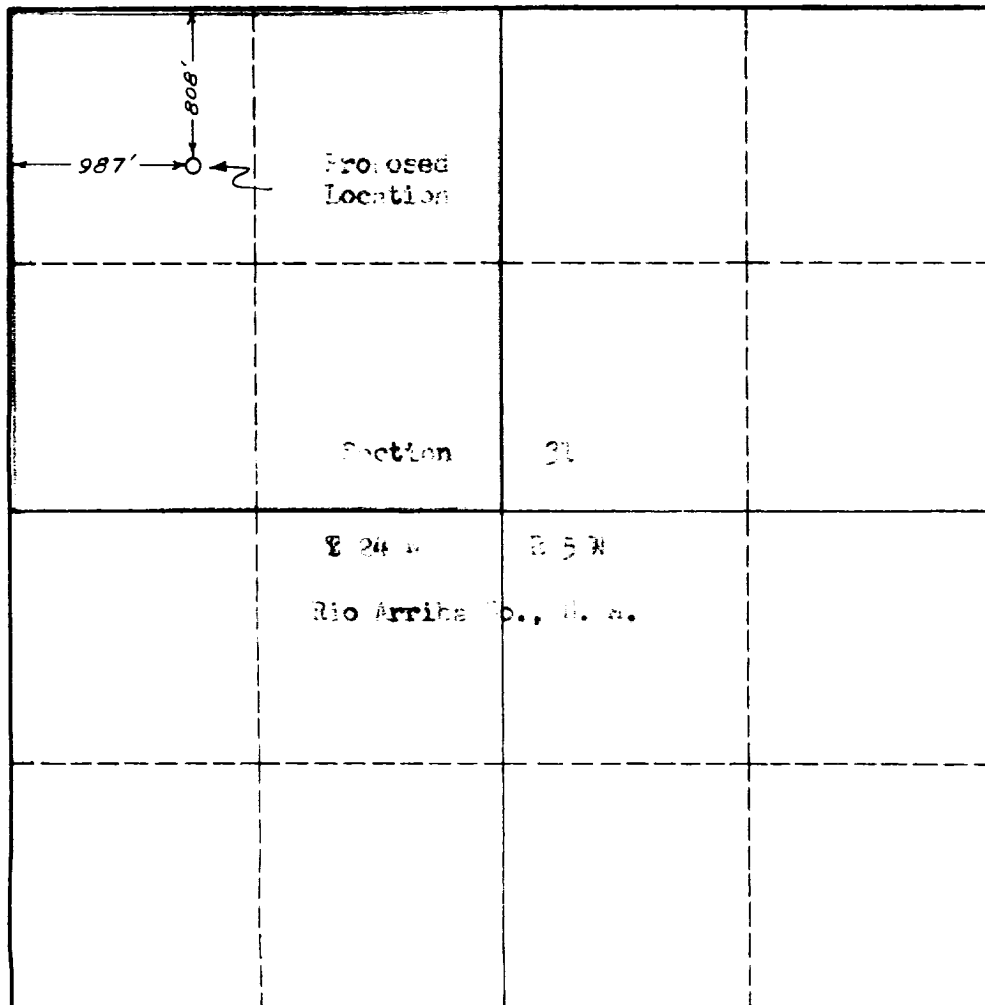

CERTIFICATION

I hereby certify that the information in SECTION A above is true and complete to the best of my knowledge and belief.

Name	Richard C. [unclear]
Position	District Manager
Company	Continental Oil Company
Date	April 21, 1965

I hereby certify that the well location shown on the plat in SECTION B was plotted from field notes of actual surveys made by me or under my supervision, and that the same is true and correct to the best of my knowledge and belief.

Date Surveyed	Apr. 10, 1965
Registered Professional Engineer and/or Land Surveyor	<i>Indurich H. Reed</i>
Certificate No.	

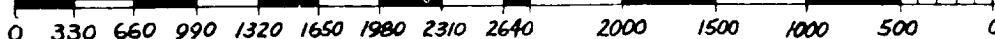

INSTRUCTIONS FOR COMPLETION OF FORM C-128

1. Operator shall furnish and certify to the information called for in Section A.
2. Operator shall outline the dedicated acreage for *both* oil and gas wells on the plat in Section B.
3. A registered professional engineer or land surveyor registered in the State of New Mexico or approved by the Commission shall show on the plat the location of the well and certify this information in the space provided.
4. All distances shown on the plat must be from the outer boundaries of the Section.
5. If additional space is needed for listing owners and their respective interests as required in question 3 of Section A, please use space below.

3-25-68

CONTINENTAL OIL COMPANY

WELLS REQUIRING FILE CORRECTION ONLY

LEASE NAME & NUMBER	LOCATION	POOL	PRESENT ACREAGE	CORRECT ACREAGE
AXI Apache H #11	D-5-23N-5W	Ballard PC	160	161.50 ✓
AXI Apache H #15	D-31-24N-5W	Ballard PC	160	160.95 ✓
XXXXXX	XXXXXX	XXXXXX	XXXXXX	XXXXXX
AXI Apache J #10	A-5-25N-5W	Otero Chacra	160	159.29 ✓
AXI Apache J #10	A-5-25N-5W	So. B1. PC	160	159.29 ✓
AXI Apache J #11	A-6-25N-5W	Otero Chacra	160	159.69 ✓
AXI Apache J #11	A-6-25N-5W	So. B1. PC	160	159.69 ✓

WELLS FOR WHICH FORM C-102, ACREAGE DEDICATION PLAT, MUST BE FILED
(PLEASE FILE IN TRIPLICATE)

AXI Apache C #9	A-3-23N-5W	Ballard PC	160	163.08 <i>3-8-68</i>
AXI Apache C #6	D-3-23N-5W	Ballard PC	160	162.84 <i>3-8-68</i>
AXI Apache C #7	A-4-23N-5W	Ballard PC	160	162.64 <i>3-8-68</i>
AXI Apache C #10	E-4-23N-5W	Ballard PC	160	162.48 <i>3-8-68</i>
AXI Apache H #1	H-5-23N-5W	Ballard PC	159.7	162.10 <i>3-8-68</i>
AXI Apache H #7	M-6-23N-5W	Ballard PC	160	157.68 <i>3-8-68</i>