

(SUBMIT IN TRIPLICATE)

UNITED STATES
DEPARTMENT OF THE INTERIOR
GEOLOGICAL SURVEY

Budget Bureau No. 42-R358.4.
Approval expires 12-31-60.

Land Office Santa Fe
Lease No. SP 080500
Unit Anderson "A"

SUNDRY NOTICES AND REPORTS ON WELLS

NOTICE OF INTENTION TO DRILL	<input checked="" type="checkbox"/>	SUBSEQUENT REPORT OF WATER SHUT-OFF	
NOTICE OF INTENTION TO CHANGE PLANS		SUBSEQUENT REPORT OF SHOOTING OR ACIDIZING	
NOTICE OF INTENTION TO TEST WATER SHUT-OFF		SUBSEQUENT REPORT OF ALTERING CASING	
NOTICE OF INTENTION TO RE-DRILL OR REPAIR WELL		SUBSEQUENT REPORT OF RE-DRILLING OR REPAIR	APR 2 - 1959
NOTICE OF INTENTION TO SHOOT OR ACIDIZE		SUBSEQUENT REPORT OF ABANDONMENT	
NOTICE OF INTENTION TO PULL OR ALTER CASING		SUPPLEMENTARY WELL HISTORY	
NOTICE OF INTENTION TO ABANDON WELL			

(INDICATE ABOVE BY CHECK MARK NATURE OF REPORT, NOTICE, OR OTHER DATA)

Well No. Anderson "A" is located 1650 ft. from S line and 990 ft. from W line of sec. 25
_____ April 23, 1959

SW/4 Section 25 24N 2W N.M.P.M.
(1/4 Sec. and 1/4 Sec. No.) (Twp.) (Range) (Meridian)
Undesignated (Pictured Cliffs) Rio Arriba New Mexico
(Field) (County or Subdivision) (State or Territory)

The elevation of the derrick floor above sea level is _____ ft.

DETAILS OF WORK

(State names of and expected depths to objective sands; show sizes, weights, and lengths of proposed casings; indicate mudding jobs, cementing points, and all other important proposed work)

It is our intention to drill Well No. 3 to approximately 3400' to test the Pictured Cliffs formation. Our casing program is as follows:

200' of 10-3/4" OD 32.75# SR H-40 casing, with 200 sacks regular cement. Cement to be circulated to surface.
3400' of 5 1/2" OD 14# SR J-55 casing, with 200 sacks regular cement.

The designated drilling unit is the SW/4 of Section 25-24N-2W, Rio Arriba County, New Mexico.

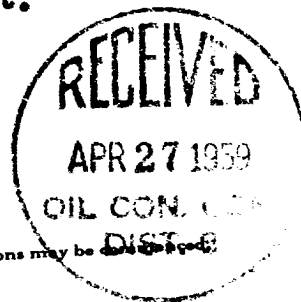

I understand that this plan of work must receive approval in writing by the Geological Survey before operations may be conducted.

Company SKELLY OIL COMPANY
Address Elmington, New Mexico

By (Signed) P. E. Cosper
Title District Superintendent

NEW MEXICO OIL CONSERVATION COMMISSION
WELL LOCATION AND ACREAGE DEDICATION PLAT

FORM C-128
 Revised 5/1/57

SEE INSTRUCTIONS FOR COMPLETING THIS FORM ON THE REVERSE SIDE

SECTION A

Operator SKELLY OIL COMPANY		Lease ANDERSON "A"		Well No. 3
Unit Letter L	Section 25	Township 24 NORTH	Range 2 WEST	County RIO ARriba
Actual Footage Location of Well: 1650 feet from the SOUTH line and 990 feet from the WEST line				
Ground Level Elev.	Producing Formation Pictured Cliffs	Pool Undesignated	Dedicated Acreage: 140 Acres	

- Is the Operator the only owner in the dedicated acreage outlined on the plat below? YES ☒ NO ☐ ("Owner" means the person who has the right to drill into and to produce from any pool and to appropriate the production either for himself or for himself and another. (65-3-29 (e) NMSA 1935 Comp.)
- If the answer to question one is "no," have the interests of all the owners been consolidated by consolidation agreement or otherwise? YES ☐ NO ☐ . If answer is "yes," Type of Consolidation _____
- If the answer to question two is "no," list all the owners and their respective interests below:

Owner	Land Description

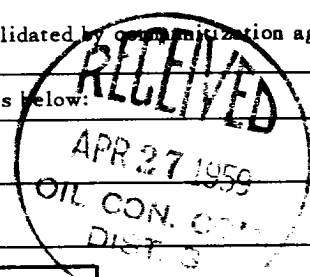

SECTION B

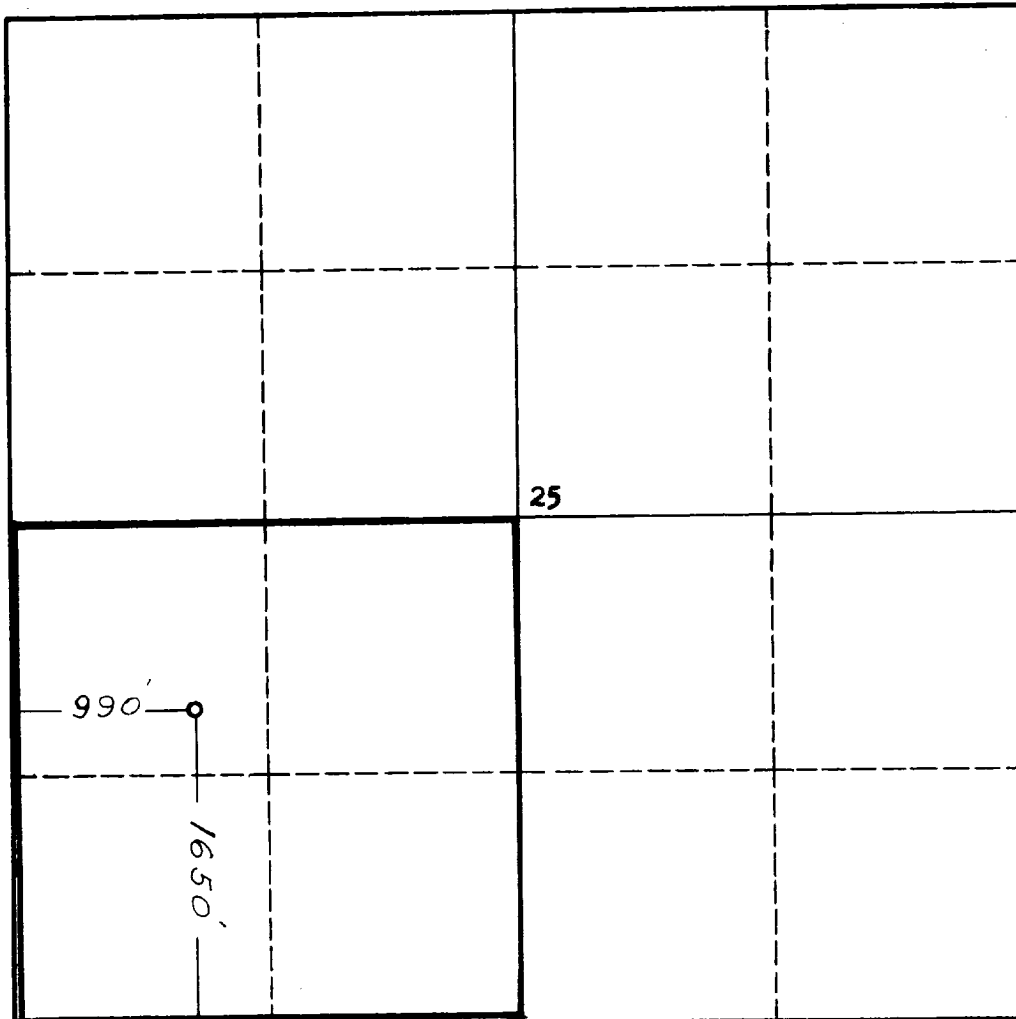

CERTIFICATION

I hereby certify that the information in SECTION A above is true and complete to the best of my knowledge and belief.

Name (Signed) P. E. Cosper
Position District Superintendent
Company SKELLY OIL COMPANY
Date April 23, 1959

REF. GLO PLAT DATED 18 DEC. 1917

I hereby certify that the well location shown on the plat in SECTION B was plotted from field notes of actual surveys made by me or under my supervision, and that the same is true and correct to the best of my knowledge and belief.

Date Surveyed 21 April 1959
Registered Professional Engineer and/or Land Surveyor

James P. Cosper
 Certificate No. **1463**

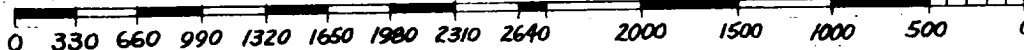

INSTRUCTIONS FOR COMPLETION OF FORM C-128

1. Operator shall furnish and certify to the information called for in Section A.
2. Operator shall outline the dedicated acreage for *both* oil and gas wells on the plat in Section B.
3. A registered professional engineer or land surveyor registered in the State of New Mexico or approved by the Commission shall show on the plat the location of the well and certify this information in the space provided.
4. All distances shown on the plat must be from the outer boundaries of the Section.
5. If additional space is needed for listing owners and their respective interests as required in question 3 of Section A, please use space below.