

3 Uses
1 Cal. Oil Co.
1 Germany

2 MIOCC
2 File

(SUBMIT IN TRIPLICATE)

UNITED STATES
DEPARTMENT OF THE INTERIOR
GEOLOGICAL SURVEY

Budget Bureau No. 42-R358.4.
Approval expires 12-31-60.

Land Office **Santa Fe**

Lease No. **SF 078562**

Unit _____

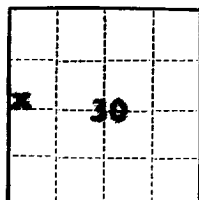

SUNDRY NOTICES AND REPORTS ON WELLS

NOTICE OF INTENTION TO DRILL	<input checked="" type="checkbox"/>	SUBSEQUENT REPORT OF WATER SHUT-OFF
NOTICE OF INTENTION TO CHANGE PLANS	<input type="checkbox"/>	SUBSEQUENT REPORT OF SHOOTING OR ACIDIZING
NOTICE OF INTENTION TO TEST WATER SHUT-OFF	<input type="checkbox"/>	SUBSEQUENT REPORT OF ALTERING CASING
NOTICE OF INTENTION TO RE-DRILL OR REPAIR WELL	<input type="checkbox"/>	SUBSEQUENT REPORT OF RE-DRILLING OR REPAIR
NOTICE OF INTENTION TO SHOOT OR ACIDIZE	<input type="checkbox"/>	SUBSEQUENT REPORT OF ABANDONMENT
NOTICE OF INTENTION TO PULL OR ALTER CASING	<input type="checkbox"/>	SUPPLEMENTARY WELL HISTORY
NOTICE OF INTENTION TO ABANDON WELL	<input type="checkbox"/>	

(INDICATE ABOVE BY CHECK MARK NATURE OF REPORT, NOTICE, OR OTHER DATA)

July 24, 19 61

Well No. **Goff 5-30** is located **2440** ft. from **[N]** line and **330** ft. from **[W]** line of sec. **30**
SW NW/4 **30** **24N** **6W** **100PM**
(1/4 Sec. and Sec. No.) (Twp.) (Range) (Meridian)
Escrito-Gallup **Rio Arriba** **New Mexico**
(Field) (County or Subdivision) (State or Territory)

The elevation of the ~~surface~~ ^{ungr. grad.} above sea level is **6931** ft.

DETAILS OF WORK

(State names of and expected depths to objective sands; show sizes, weights, and lengths of proposed casings; indicate mudding jobs, cementing points, and all other important proposed work)

Plan to drill 12-1/2" hole to 200' and run 8-5/8" csg. cemented with 125 sms. cement. Drill 7-7/8" hole to approximately 5950' to test Gallup. Run 4-1/2" csg. cemented with 150 sms. at total depth. Perf. & SWF Gallup formation.



I understand that this plan of work must receive approval in writing by the Geological Survey before operations may be commenced.

Company **Val R. Reese & Associates, Inc.**

Address **Lobby of Simms Building**

Albuquerque, New Mexico

Original Signed by
By **MORRIS B. JONES** **Morris B. Jones**
Title **Engineer**

NEW MEXICO OIL CONSERVATION COMMISSION

Well Location and Acreage Dedication Plat

SECTION A.

Date July 24, 1961

Operator Val R. Reese and Associates Lease Goff
Well No. 5-30 Unit Letter E Section 30 Township 24 North Range 6 West NMPM
Located 2440 Feet From North Line, 330 Feet From West Line
County Rio Arriba G. L. Elevation 6931 Dedicated Acreage 80.00 Acres
Name of Producing Formation Gallup Pool Escrito-Gallup

1. Is the Operator the only owner* in the dedicated acreage outlined on the plat below? Yes ☒ No ☐
2. If the answer to question One is "No," have the interests of all the owners been consolidated by communization agreement or otherwise? Yes ☐ No ☐ If answer is "Yes," Type of Consolidation _____

3. If the answer to question Two is "No," list all the owners and their respective interests below:

OWNER

LAND DESCRIPTION

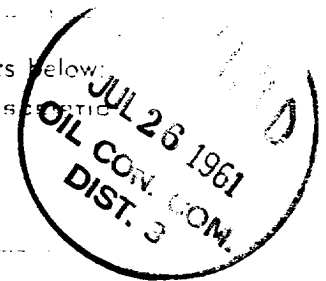

SECTION B.

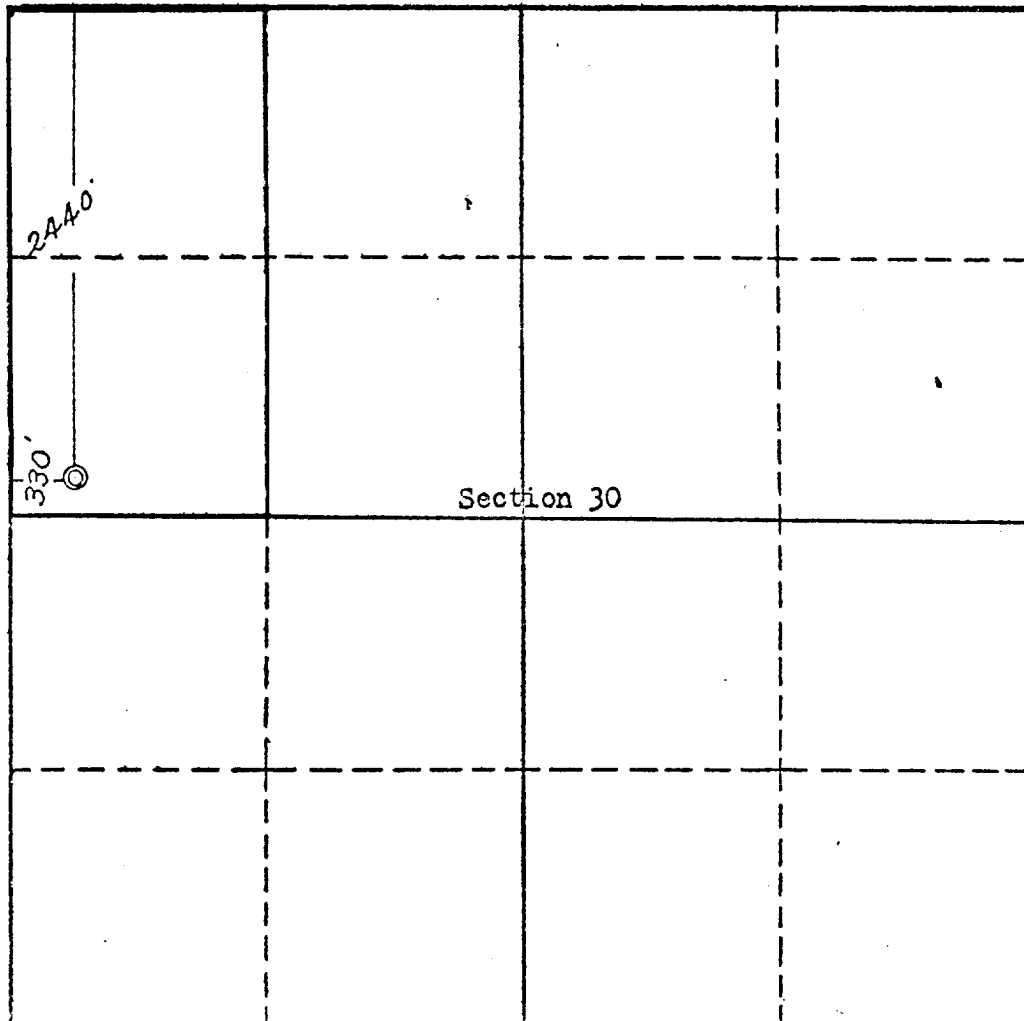

This is to certify that the information in Section A above is true and complete to the best of my knowledge and belief.

Val R. Reese & Assoc., Inc.

(OPERATOR)
Original Signed by
MORRIS B. JONES
Morris B. Jones

(REPRESENTATIVE)

Lobby of Simms Building
Albuquerque, New Mexico

(ADDRESS)

This is to certify that the well location shown on the plat in Section B was plotted from the actual survey of the land and that my supervision is true and correct to the best of my knowledge and belief.

Date Surveyed July 20, 1961

Four States Engineering Co.
FARMINGTON, NEW MEXICO

E. L. Poter
REGISTERED ENGINEER OR
LAND SURVEYOR

Certificate No. 3084

