

Form 9-351b  
(April 1952)

(SUBMIT IN TRIPLICATE)

Indian Agency

**Montezuma**

UNITED STATES  
DEPARTMENT OF THE INTERIOR  
GEOLOGICAL SURVEY

Allottee

Lease No.

**Contract #2**

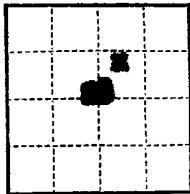

SUNDRY NOTICES AND REPORTS ON WELLS

NOTICE OF INTENTION TO DRILL	<input checked="" type="checkbox"/>	SUBSEQUENT REPORT OF WATER SHUT-OFF	
NOTICE OF INTENTION TO CHANGE PLANS		SUBSEQUENT REPORT OF SHOOTING OR ACIDIZING	
NOTICE OF INTENTION TO TEST WATER SHUT-OFF		SUBSEQUENT REPORT OF ALTERING CASING	
NOTICE OF INTENTION TO REDRILL OR REPAIR WELL		SUBSEQUENT REPORT OF REDRILLING OR REPAIR	
NOTICE OF INTENTION TO SHOOT OR ACIDIZE		SUBSEQUENT REPORT OF ABANDONMENT	
NOTICE OF INTENTION TO PULL OR ALTER CASING		SUPPLEMENTARY WELL HISTORY	MAY 15 1963
NOTICE OF INTENTION TO ABANDON WELL			

(INDICATE ABOVE BY CHECK MARK NATURE OF REPORT, NOTICE, OR OTHER DATA)

May 14

19 63

**Montezuma State**  
Well No. **22-28** is located **1670** ft. from **N** line and **1670** ft. from **E** line of sec. **28**  
**24N** **30** **104W**  
(14 Sec. and Sec. No.) (Twp.) (Range) (Meridian)  
**San Juan** **San Juan** **New Mexico**  
(Field) (County or Subdivision) (State or Territory)

The elevation of the ~~surface~~ **ground** above sea level is **6607** ft.

DETAILS OF WORK

(State names of and expected depths to objective sands; show sizes, weights, and lengths of proposed casings; indicate mudlogging jobs, cementing points, and all other important proposed work)

It is proposed to drill to **San Juan** as follows:

1. Spud **1 1/2"** hole and drill to **+ 300'**. Cement **8-5/8"** casing at **300'** with class **"X"** cement plus **1/2** Gall. Bring cement to surface. U.O.C. 8 hrs. and pump, test casing to **1500 psi** for **30** minutes.
2. Drill **6-1/2"** hole to **600'**. Run logs. Bring cement to **500'**. Stage at **500'** + (Leads Slime + **100'**) with **70** sacks class **"X"** cement. Top of cement above **1500'**. Run temp. survey. U.O.C. 24 hrs. and clean out.
3. Prod. **San Juan** as determined by logs and mud-free. Shut well in until pressure stabilizes. Run tubing and set well in.

I understand that this plan of work must receive approval in writing by the Geological Survey before operations may be commenced.

Company **Energy Mobil Oil Company, Inc.**

Address **P. O. Box 1971**

**Durango, Colorado**

By **H. J. Meyer**

Title **Dr. Fred. Portman**

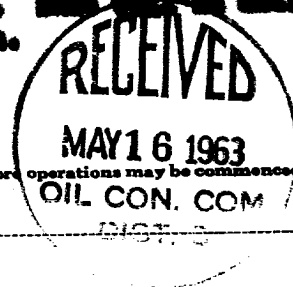

NAME OF COMPANY		DISTRIBUTION	
STATE	FILE	UNIT	LAND OFFICE
TRANSPORTER	OIL	GAS	PRODUCTION OFFICE
OPERATOR			

**NEW MEXICO OIL CONSERVATION COMMISSION**  
**WELL LOCATION AND ACREAGE DEDICATION PLAT**  
 SEE INSTRUCTIONS FOR COMPLETING THIS FORM ON THE REVERSE SIDE

FORM C-128  
 Revised 5/1/57

**SECTION A**

Operator <b>Socony Mobil Oil Company, Inc.</b>		Lease <b>Jicarilla Otero</b>		Well No. <b>32-28</b>
Unit Letter <b>G</b>	Section <b>28</b>	Township <b>24N</b>	Range <b>5W</b>	County <b>Rio Arriba</b>
Actual Footage Location of Well: <b>1650</b> feet from the <b>North</b> line and <b>1650</b> feet from the <b>East</b> line				
Ground Level Elev. <b>6607</b>	Producing Formation <b>Dakota</b>	Pool <b>Basin Dakota</b>	Dedicated Acreage: <b>320</b> Acres	

1. Is the Operator the only owner in the dedicated acreage outlined on the plat below? YES ☒ NO ☐ ("Owner" means the person who has the right to drill into and to produce from any pool and to appropriate the production either for himself or for himself and another. (65-3-29 (e) NMSA 1935 Comp.)
2. If the answer to question one is "no," have the interests of all the owners been consolidated by communitization agreement or otherwise? YES ☐ NO ☐ If answer is "yes," Type of Consolidation \_\_\_\_\_
3. If the answer to question two is "no," list all the owners and their respective interests below:

Owner	Land Description

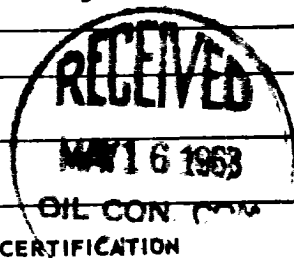

**SECTION B**

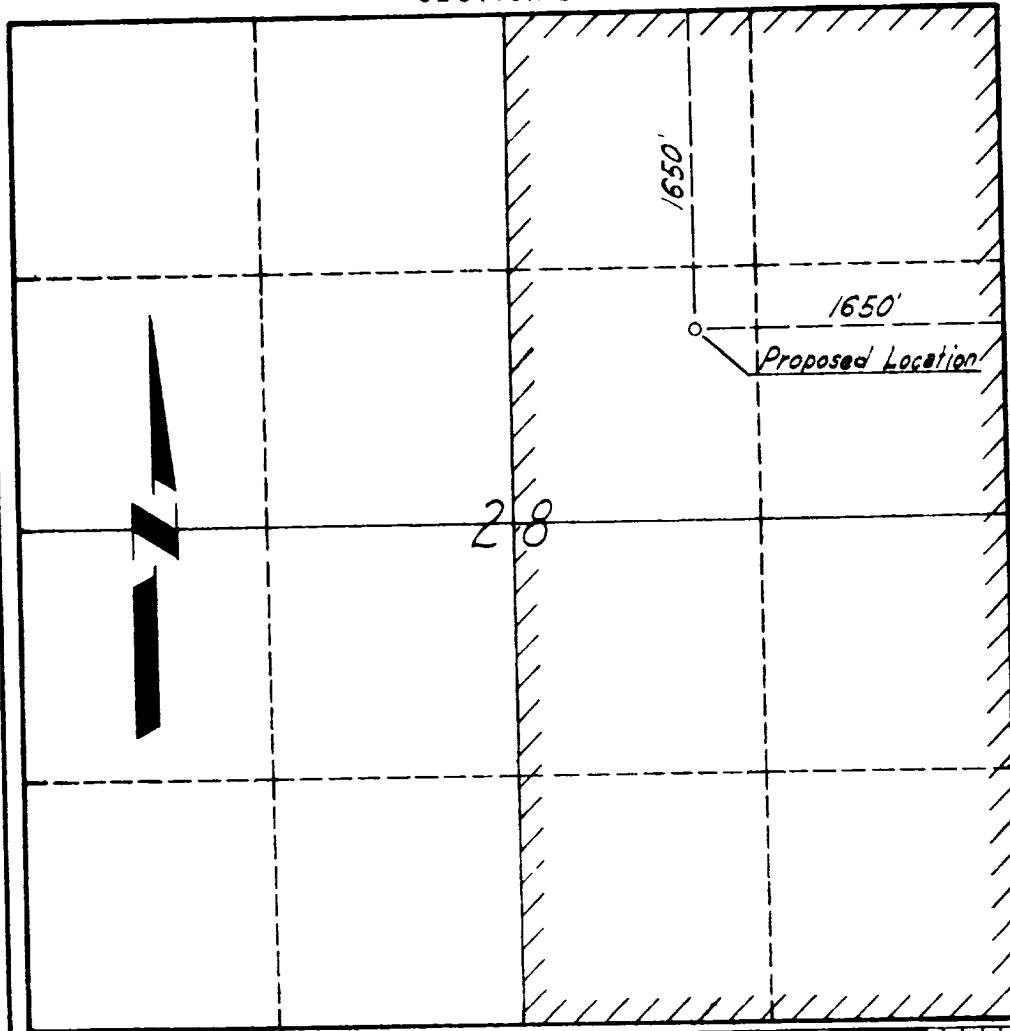

I hereby certify that the information in SECTION A above is true and complete to the best of my knowledge and belief.

Name	<b>M. J. Meyer</b>
Position	<b>Sr. Prod. Foreman</b>
Company	<b>Socony Mobil Oil Co., Inc.</b>
Date	<b>5/6/63</b>

I hereby certify that the well location shown on the plat in SECTION B was plotted from field notes of actual surveys made by me or under my supervision, and that the same is true and correct to the best of my knowledge and belief.

Date Surveyed	<b>4/30/63</b>
Registered Professional Engineer and/or Land Surveyor	<b>Reginald L. Pedersen</b>
Certificate No.	<b>L. S. 3330</b>

