

(SUBMIT IN TRIPLICATE)

UNITED STATES
DEPARTMENT OF THE INTERIOR
GEOLOGICAL SURVEY

Land Office **Santa Fe**
Lease No. **078924-B**
Unit **Federal**

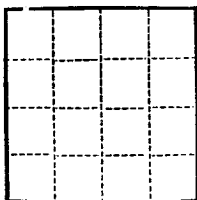

SUNDRY NOTICES AND REPORTS ON WELLS

NOTICE OF INTENTION TO DRILL	<input checked="" type="checkbox"/>	SUBSEQUENT REPORT OF WATER SHUT-OFF	
NOTICE OF INTENTION TO CHANGE PLANS		SUBSEQUENT REPORT OF SHOOTING OR ACIDIZING	
NOTICE OF INTENTION TO TEST WATER SHUT-OFF		SUBSEQUENT REPORT OF ALTERING CASING	
NOTICE OF INTENTION TO RE-DRILL OR REPAIR WELL		SUBSEQUENT REPORT OF RE-DRILLING OR REPAIR	
NOTICE OF INTENTION TO SHOOT OR ACIDIZE		SUBSEQUENT REPORT OF ABANDONMENT	
NOTICE OF INTENTION TO PULL OR ALTER CASING		SUPPLEMENTARY WELL HISTORY	
NOTICE OF INTENTION TO ABANDON WELL			

(INDICATE ABOVE BY CHECK MARK NATURE OF REPORT, NOTICE, OR OTHER DATA)

April 10, 1961

Well No. 1-30 is located 1860 ft. from N line and 1980 ft. from E line of sec. 30
NE/4 Sec. 30 24N 7W N.M.P.M.
 (1/4 Sec. and Sec. No.) (Twp.) (Range) (Meridian)
Undesignated Gallup Rio Arriba New Mexico
 (Field) (County or Subdivision) (State or Territory)

The elevation of the derrick floor above sea level is 7263 ft. (Estimated)

DETAILS OF WORK

(State names of and expected depths to objective sands; show sizes, weights, and lengths of proposed casings; indicate mudding jobs, cementing points, and all other important proposed work)

Objective sand - Gallup

Proposed Total Depth - 6200' or base of Gallup sand.

Surface Casing - 200' of 8-5/8" O.D. 24# Rg 2 Smls. Csg - cement to be circulated to top.

Production Casing - 4-1/2" O.D. 9.5# & 11.0# Smls. To be set through Gallup and cemented minimum of 400' above top of Gallup.

Proposed Spud Date - on or about April 14, 1961.



I understand that this plan of work must receive approval in writing by the Geological Survey before operations may be commenced.

Company Dorffman Production Company

Address 836 Mercantile Dallas Building

Dallas 1, Texas

By S. L. Florsheim, Jr.
 Title General Manager

NUMBER OF COPIES RECEIVED	
DISTRIBUTION	
SANTA FE	
FILE	
U.S.G.S.	
LAND OFFICE	
TRANSPORTER	OIL GAS
PRODUCTION OFFICE	
OPERATOR	

NEW MEXICO OIL CONSERVATION COMMISSION
WELL LOCATION AND ACREAGE DEDICATION PLAT
 SEE INSTRUCTIONS FOR COMPLETING THIS FORM ON THE REVERSE SIDE

FORM C-128
 Revised 5/1/57

SECTION A

Operator DORFMAN PRODUCTION COMPANY		Lease FEDERAL		Well No. 1 - 30
Unit Letter G	Section 30	Township 24 NORTH	Range 7 WEST	County RIO ARriba
Actual Footage Location of Well: 1860 feet from the NORTH line and 1980 feet from the EAST line				
Ground Level Elev. 7253.0	Producing Formation GALLUP	Pool UNDESIGNATED		Dedicated Acreage: 40 Acres

Ref: GLO plat dated 4 November 1882

1. Is the Operator the only owner in the dedicated acreage outlined on the plat below? YES _____ NO X . ("Owner" means the person who has the right to drill into and to produce from any pool and to appropriate the production either for himself or for himself and another. (65-3-29 (e) NMSA 1935 Comp.)
2. If the answer to question one is "no," have the interests of all the owners been consolidated by communitization agreement or otherwise? YES X NO _____. If answer is "yes," Type of Consolidation **Assignment of operating rights and operating agreements**
3. If the answer to question two is "no," list all the owners and their respective interests below:

Owner See back	Land Description SW/4 NE/4 Sec. 30, Twn 24N, Rg 7W
Rio Arriba County, New Mexico	

SECTION B

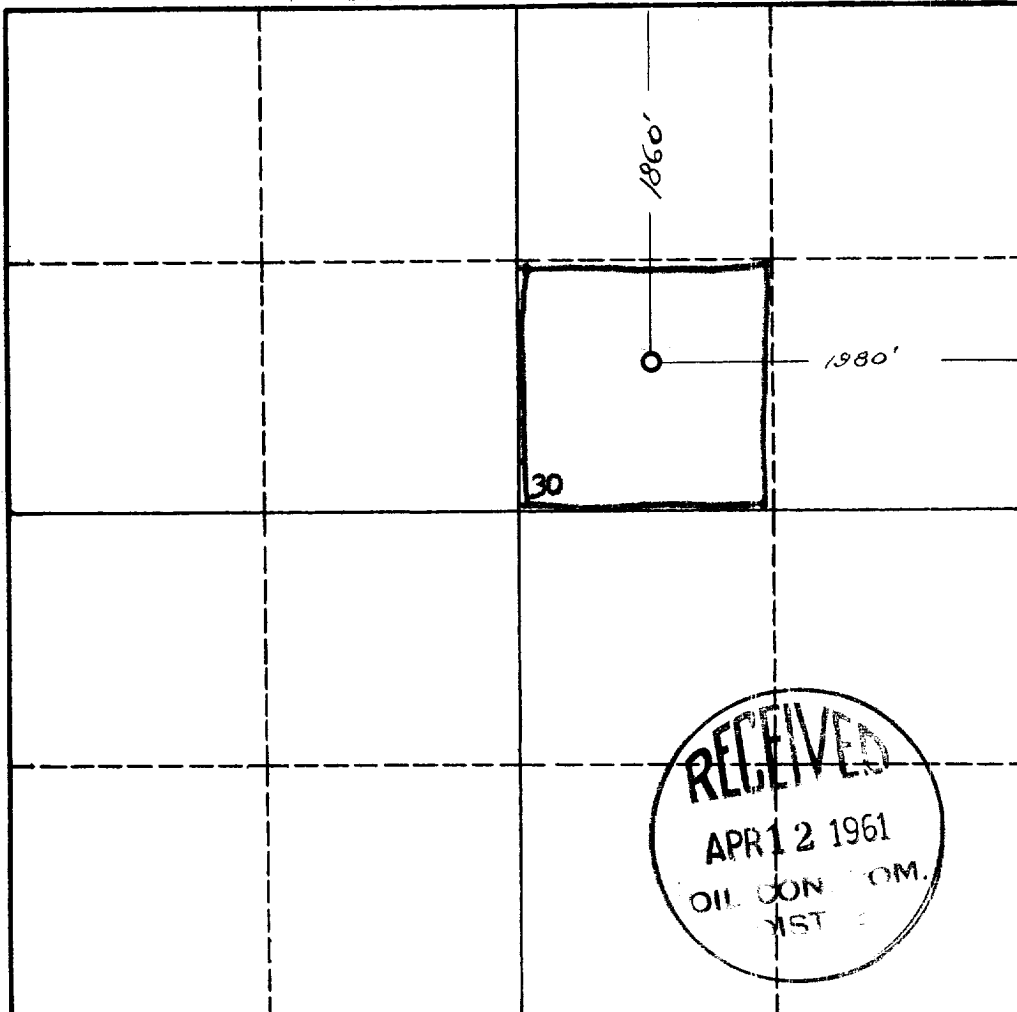

CERTIFICATION

I hereby certify that the information in SECTION A above is true and complete to the best of my knowledge and belief.

Name <i>S.L. Florsheim, Jr.</i>
Position S.L. Florsheim, Jr. General Manager
Company Dorfman Production Co.
Date April 10, 1961

I hereby certify that the well location shown on the plat in SECTION B was plotted from field notes of actual surveys made by me or under my supervision, and that the same is true and correct to the best of my knowledge and belief.

Date Surveyed 3 April 1961
Registered Professional Engineer and/or Land Surveyor <i>James P. Leese</i> James P. Leese
Certificate No. 1463

0 330 660 990 1320 1650 1980 2310 2640 2000 1500 1000 500 0

INSTRUCTIONS FOR COMPLETION OF FORM C-128

1. Operator shall furnish and certify to the information called for in Section A.
2. Operator shall outline the dedicated acreage for *both* oil and gas wells on the plat in Section B.
3. A registered professional engineer or land surveyor registered in the State of New Mexico or approved by the Commission shall show on the plat the location of the well and certify this information in the space provided.
4. All distances shown on the plat must be from the outer boundaries of the Section.
5. If additional space is needed for listing owners and their respective interests as required in question 3 of Section A, please use space below.

Ownership:

Louis Dorfman	.120117
Sam Y. Dorfman, Jr.	.120117
Elizabeth F. Dorfman Trust	.120117
S. L. Florsheim, Jr.	.011719
H. J. Grebing, Jr.	.002930
Delta Drilling Company	.250000
Paul F. Rutledge	.125000
A. E. McCubbin	.125000
Rex Stegall	.125000