

Section 27

(SUBMIT IN TRIPLICATE)

Land Office Santa Fe

Lease No. WM-02453

Unit Wasson-Federal

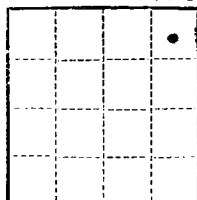

UNITED STATES  
DEPARTMENT OF THE INTERIOR  
GEOLOGICAL SURVEY

SUNDRY NOTICES AND REPORTS ON WELLS

NOTICE OF INTENTION TO DRILL	<input checked="" type="checkbox"/>	SUBSEQUENT REPORT OF WATER SHUT-OFF
NOTICE OF INTENTION TO CHANGE PLANS		SUBSEQUENT REPORT OF SHOOTING OR ACIDIZING
NOTICE OF INTENTION TO TEST WATER SHUT-OFF		SUBSEQUENT REPORT OF ALTERING CASING
NOTICE OF INTENTION TO RE-DRILL OR REPAIR WELL		SUBSEQUENT REPORT OF RE-DRILLING OR REPAIR
NOTICE OF INTENTION TO SHOOT OR ACIDIZE		SUBSEQUENT REPORT OF ABANDONMENT
NOTICE OF INTENTION TO PULL OR ALTER CASING		SUPPLEMENTARY WELL HISTORY
NOTICE OF INTENTION TO ABANDON WELL		

**RECEIVED**  
JUL 25 1958  
U. S. GEOLOGICAL SURVEY  
FARMINGTON, NEW MEXICO

(INDICATE ABOVE BY CHECK MARK NATURE OF REPORT, NOTICE, OR OTHER DATA)

July 23, 1958

Well No. 1 is located 990 ft. from N line and 950 ft. from E line of sec. 27

NE 1/4 27 24N 1W R.M.P.M.  
(1/4 Sec. and Sec. No.) (Twp.) (Range) (Meridian)

Underg. Pictured Cliffs Rio Arriba New Mexico  
(Field) (County or Subdivision) (State or Territory)

The elevation of the derrick floor above sea level is 7213 ft. est.

DETAILS OF WORK

(State names of and expected depths to objective sands; show sizes, weights, and lengths of proposed casings; indicate mudding jobs, cementing points, and all other important proposed work)

We propose to drill the above well to a total depth of approximately 3,400' with rotary tools. We expect to test the following zones at the following approximate depths:

<u>Sand</u>	<u>Expected Top</u>
<u>Pictured Cliffs</u>	<u>3128</u>

Casing Program

Set approximately 350' of 8-5/8" surface casing with approximately 200 lbs. cement. To set approximately 3,400' of 5-1/2" casing with approximately 200 lbs. We propose to perforate and sand water free for completion. We expect to test any other zones that appear productive of oil or gas.

I understand that this plan of work must receive approval in writing by the Geological Survey before operations may be commenced.

Company Magnolia Petroleum Company

Address P. O. Box 2406

Hobbs, New Mexico

By [Signature]

Title District Superintendent

# NEW MEXICO OIL CONSERVATION COMMISSION

## Well Location and Acreage Dedication Plat

### Section A.

Date July 15, 1958

Operator MAGNOLIA PETROLEUM COMPANY Lease WASSON-FEDERAL  
 Well No. 1 Unit Letter Section 27 Township 24N Range 11W  
 Located 990 Feet From North Line, 990 Feet From East Line  
 County Rio Arriba G. L. Elevation 7213 Dedicated Acreage 1/4  
 Name of Producing Formation Pictured Cliffs Pool Undersaturated

1. Is the Operator the only owner in the dedicated acreage outlined on the plat?  
 Yes X No       .
2. If the answer to question one is "no," have the interests of all the owners been consolidated by communitization agreement or otherwise? Yes        No       . If answer is "yes," Type of Consolidation       .
3. If the answer to question two is "no," list all the owners and their respective interests below:

Owner

Land Description

**RECEIVED**

**JUL 25 1958**

U. S. GEOLOGICAL SURVEY  
 FARMINGTON, NEW MEXICO

### Section B.

S89° 51' W (Call) 80.05 Ch

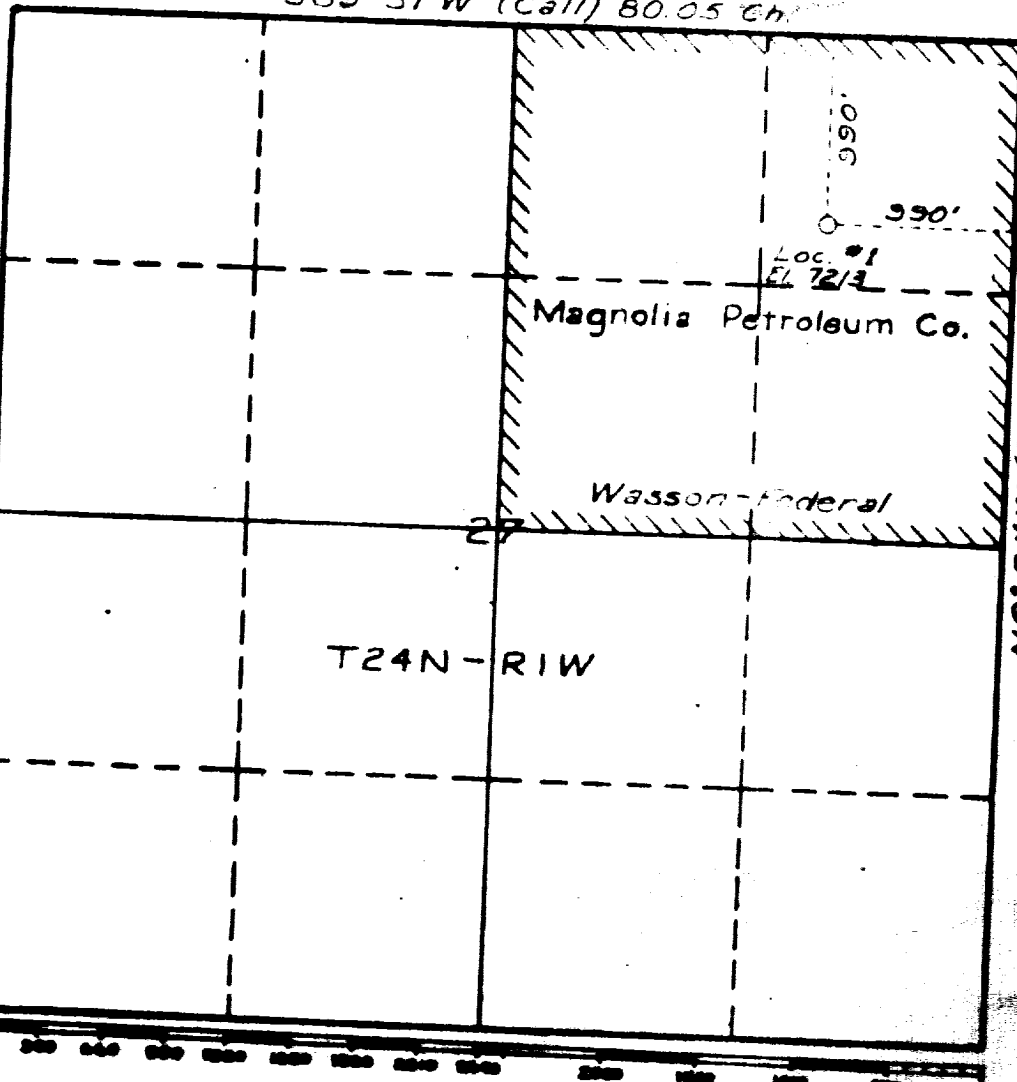

This is to certify that the information in Section A above is true and complete to the best of my knowledge and belief.

MAGNOLIA PETROLEUM COMPANY  
 (Operator)

(Representative)

Box 2406, Hobbs, New Mexico  
 Address

This is to certify that the well location shown on the plat in Section B was plotted from field notes of actual surveys made by me or under my supervision and that the same is true and correct to the best of my knowledge and belief.

Date Surveyed July 12, 1958

Carl E. [Signature]  
 Surveyor at Large  
 Registered under License No. 10,400