



UNITED STATES
DEPARTMENT OF THE INTERIOR
GEOLOGICAL SURVEY
P. O. Box 965
Farmington, New Mexico

COPY TO O.C.C.

June 24, 1955

E. B. Germany
Box 8007
Dallas 5, Texas

Re: Santa Fe 078562

Gentlemen:

Receipt is acknowledged of your "Notice of Intention to Drill" dated June 16, 1955 covering your well No. 1 E. B. Germany in NE $\frac{1}{4}$ NW $\frac{1}{4}$ sec. 30, T. 24 N., R. 6 W., N. M. P. M., Rio Arriba County, New Mexico, Wildcat pool.

Your proposed work is hereby approved subject to compliance with the provisions of the "Oil and Gas Operating Regulations" revised May 25, 1942, a copy of which will be sent to you on request, and subject to the following conditions:

1. Drilling operations so authorized are subject to the attached sheet for general conditions of approval.
2. Furnish copies of all logs.

Very truly yours,

(Orig. Sgd.) A. P. KLEEMAN

A. P. Kleeman
Acting District Engineer

APKleeman:as

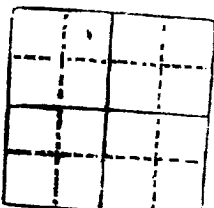

IN REPLY REFER TO

UNITED STATES
DEPARTMENT OF THE INTERIOR
GEOLOGICAL SURVEY



2-2-50

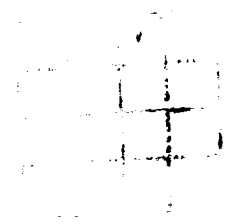

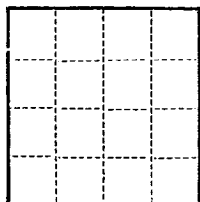

(SUBMIT IN TRIPLICATE)

UNITED STATES
DEPARTMENT OF THE INTERIOR
GEOLOGICAL SURVEYLand Office **Santa Fe**Lease No. **SF 078562**

Unit _____

SUNDRY NOTICES AND REPORTS ON WELLS

NOTICE OF INTENTION TO DRILL	<input checked="" type="checkbox"/>	SUBSEQUENT REPORT OF WATER SHUT-OFF	
NOTICE OF INTENTION TO CHANGE PLANS		SUBSEQUENT REPORT OF SHOOTING OR ACIDIZING	
NOTICE OF INTENTION TO TEST WATER SHUT-OFF		SUBSEQUENT REPORT OF ALTERING CASING	
NOTICE OF INTENTION TO RE-DRILL OR REPAIR WELL		SUBSEQUENT REPORT OF RE-DRILLING OR REPAIR	
NOTICE OF INTENTION TO SHOOT OR ACIDIZE		SUBSEQUENT REPORT OF ABANDONMENT	
NOTICE OF INTENTION TO PULL OR ALTER CASING		SUPPLEMENTARY WELL HISTORY	
NOTICE OF INTENTION TO ABANDON WELL			

(INDICATE ABOVE BY CHECK MARK NATURE OF REPORT, NOTICE, OR OTHER DATA)

June 16, 1955

E. B. Germany

Well No. **1** is located **940** ft. from **[N]** line and **1500** ft. from **[W]** line of sec. **30****NE-1/4 - NW-1/4 30**

(1/4 Sec. and Sec. No.)

24N

(Twp.)

6E

(Range)

N.M.P.M.

(Meridian)

Wildcat

(Field)

Rio Arriba

(County or Subdivision)

New Mexico

(State or Territory)

The elevation of the derrick floor above sea level is _____ ft.

DETAILS OF WORK

(State names of and expected depths to objective sands; show sizes, weights, and lengths of proposed casings; indicate mudding jobs, cementing points, and all other important proposed work)

Set 100' of 9-5/8" casing and cement w/100 sacks regular cement.
Drill with rotary tools to test Pictured Cliffs formation and set
5-1/2" x 14# - J-55 casing, cement with 100 sacks regular cement.
Drill plug with cable tools and complete by free method using
total 13,000 gallons #2 diesel, 8000 lbs sand - 3 Halliburton pump
trucks - install 2-3/8" tubing.



I understand that this plan of work must receive approval in writing by the Geological Survey before operations may be commenced.

Company **E. B. Germany**Address **Box 8007****Dallas, 5 Texas**

By

Title _____

RECEIVED

J. S. GEOLOGICAL SURVEY
WASHINGTON, NEW MEXICO

Company..... E. B. GERMANY

Lease..... Well No.....

Sec. 30 , T. 24 N. , R. 6 W. N.M.P.M.

Location..... 940' from the North line and
1500' from the West line.

Elevation..... 6720 Ungraded ground

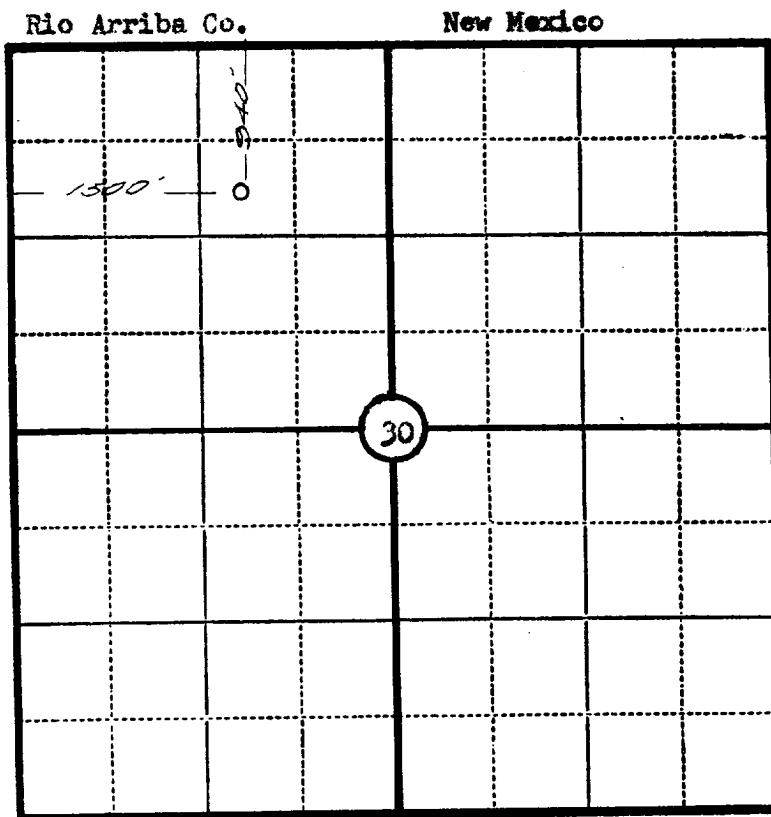

Scale—4 inches equal 1 mile.

This is to certify that the above plat was prepared from field notes of actual surveys made by me or under my supervision and that the same are true and correct to the best of my knowledge and belief.

Seal:

James P. Leese
Registered [redacted]
[redacted] Land Surveyor.

James P. Leese
N. Mex. Reg. No. 1463

Surveyed June 15 , 1955