

X			

(SUBMIT IN TRIPLICATE)

UNITED STATES
DEPARTMENT OF THE INTERIOR
GEOLOGICAL SURVEY

Land Office Santa Fe
Lease No. SF 078534
Unit _____

SUNDRY NOTICES AND REPORTS ON WELLS

NOTICE OF INTENTION TO DRILL	<input checked="" type="checkbox"/>	SUBSEQUENT REPORT OF WATER SHUT-OFF	
NOTICE OF INTENTION TO CHANGE PLANS		SUBSEQUENT REPORT OF SHOOTING OR ACIDIZING	
NOTICE OF INTENTION TO TEST WATER SHUT-OFF		SUBSEQUENT REPORT OF ALTERING CASING	
NOTICE OF INTENTION TO RE-DRILL OR REPAIR WELL		SUBSEQUENT REPORT OF RE-DRILLING OR REPAIR	
NOTICE OF INTENTION TO SHOOT OR ACIDIZE		SUBSEQUENT REPORT OF ABANDONMENT	
NOTICE OF INTENTION TO PULL OR ALTER CASING		SUPPLEMENTARY WELL HISTORY	
NOTICE OF INTENTION TO ABANDON WELL			

(INDICATE ABOVE BY CHECK MARK NATURE OF REPORT, NOTICE, OR OTHER DATA)

_____ May 5 _____, 19 60

Mesa
Well No. 1-25 is located 990 ft. from N line and 660 ft. from E line of sec. 25
NW/4 NW/4 Sec. 25 24N 7W NMPM
($\frac{1}{4}$ Sec. and Sec. No.) (Twp.) (Range) (Meridian)

Undesignated Rio Arriba New Mexico
Escrito Gal. 14/1 (Field) (County or Subdivision) (State or Territory)
Ground Level

The elevation of the ~~derivation~~ derivation above sea level is 6710 ft.

DETAILS OF WORK

(State names of and expected depths to objective sands; show sizes, weights, and lengths of proposed casings; indicate mudding jobs, cementing points, and all other important proposed work)

Plan to drill 12-1/4" hole to 200' and run 8-5/8" surface casing cemented w/ 110 sx. Drill 7-7/8" hole to approximately 6500' to test both Gallup and Dakota formations. In the event commercial production is encountered in both formations 5-1/2" casing will be run to T.D. and cemented. Both zones will then be fractured, tubing run and the well completed.



I understand that this plan of work must receive approval in writing by the Geological Survey before operations may be commenced.

Company Val R. Reese & Associates, Inc.

Address Lobby of Simms Bldg.

Albuquerque, New Mexico

By John L. Donahue

Title Geologist

NEW MEXICO OIL CONSERVATION COMMISSION

Well Location and Acreage Dedication Plat

Section A.

Date May 5, 1960

Operator VAL R. REESE & ASSOCIATES, INC. Lease Mesa
Well No. 1-25 Unit Letter D Section 25 Township 24 North Range 7 West NMPM
Located 990 Feet From North Line, 660 Feet From West Line
County Bla. Arriba G. L. Elevation 6710 Dedicated Acreage 160 Acres
Name of Producing Formation Gallup Pool Undesignated

1. Is the Operator the only owner* in the dedicated acreage outlined on the plat below?
Yes X No
2. If the answer to question one is "no," have the interests of all the owners been consolidated by communitization agreement or otherwise? Yes No . If answer is "yes,"
Type of Consolidation
3. If the answer to question two is "no," list all the owners and their respective interests below:

Owner

Land Description

Section B

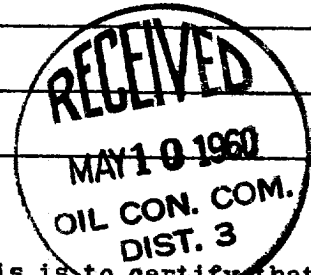
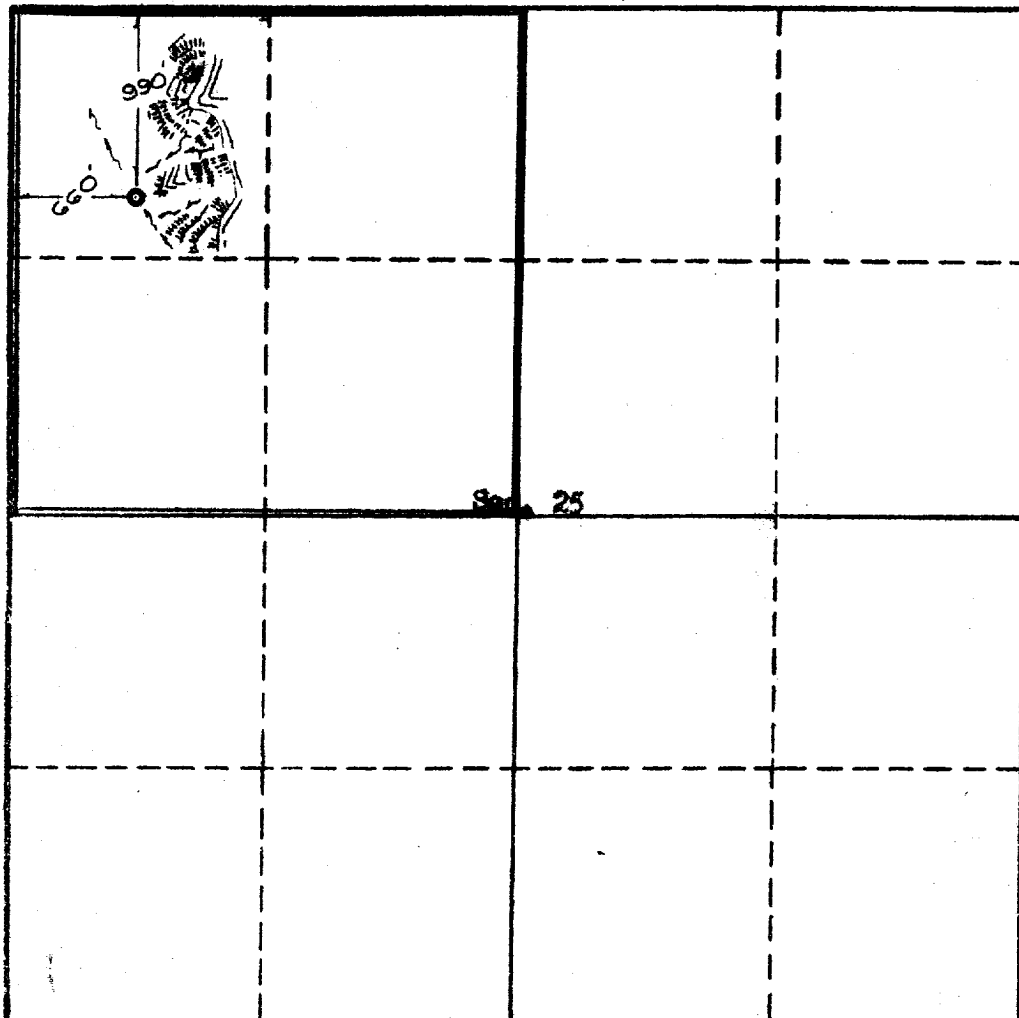

This is to certify that the information in Section A above is true and complete to the best of my knowledge and belief.

Val R. Reese & Assoc., Inc.
(Operator)

James L. Jones
(Representative)

Lobby of Simms Bldg.
Address

Albuquerque, New Mexico

This is to certify that the well location shown on the plat in Section A was taken from field notes of actual surveys by me or under my supervision and that the same is to the best of my belief.

Date Surveyed May 9, 1960

Ernest V. Echolaw
Ernest V. Echolaw
Registered Land Surveyor.

Certificate No. 1545