

OIL CONSERVATION COMMISSION
Aztec DISTRICT

OIL CONSERVATION COMMISSION
BOX 871
SANTA FE, NEW MEXICO

DATE June 22, 1964

Re: Proposed NSP _____

Proposed NWU _____

Proposed NSL _____

Proposed NFO _____

Proposed DC XXX

Gentlemen:

I have examined the application dated June 18, 1964
for the Mobil Oil Co. Jicarilla Otero #11-28 D-28-24N-5W
Operator Lease and Well No. S-T-R

and my recommendations are as follows:

Approve

Yours very truly,

A. R. Kendrick



Mobil Oil Company

A Division of Socony Mobil Oil Company, Inc.

10737 SO. SHOEMAKER ROAD, SANTA FE SPRINGS, CALIF.

June 18, 1964

El Paso Natural Gas Company
P.O. Box 990
Farmington, New Mexico

Jay J. Harris
1213 N. Mesa Verde Avenue
Farmington, New Mexico

Amerada Petroleum Corporation
West Building
Durango, Colorado

Continental Oil Company
1919 Main Avenue
Durango, Colorado

Gentlemen:

Enclosed is a copy of our Application for Dual Completion of Mobil's Jicarilla Otero #11-28 well located in the Northwest quarter of Section 28, Township 24 North, Range 5 West, Rio Arriba County, New Mexico.

If, as offset operators, you have no objection to this dual completion, we will appreciate your so advising the New Mexico Oil & Gas Conservation Commission. A copy of your letter to the commission directed to the undersigned would be appreciated.

Thank you for your cooperation.

Very truly yours,

Reynold L. Pedersen
Production Engineer

RLP/cm
Encl.



NEW MEXICO OIL CONSERVATION COMMISSION

SANTA FE, NEW MEXICO

7-3-58

APPLICATION FOR DUAL COMPLETION

Field Name Graneros Dakota & Otero Gallup		County Rio Arriba	Date June 18, 1964
Operator Socony Mobil Oil Co., Inc.		Lease Jicarilla Otero	Well No. 11-28
Location of Well Unit D	Section 28	Township 24N	Range 5W

1. Has the New Mexico Oil Conservation Commission heretofore authorized the dual completion of a well in these same pools or in the same zones within one mile of the subject well? YES ☒ NO ☐
2. If answer is yes, identify one such instance: Order No. MC-1328; Operator, Lease, and Well No.:

Continental Oil Company, Northeast Haynes #4E - 21 - 24N - 5W

3. The following facts are submitted:	Upper Zone	Lower Zone
a. Name of reservoir	Otero Gallup	Graneros Dakota
b. Top and Bottom of Pay Section (Perforations)	<u>Note:</u> To be submitted at a later date.	
c. Type of production (Oil or Gas)	Oil	Gas
d. Method of Production (Flowing or Artificial Lift)	Pumping	Flowing

4. The following are attached. (Please mark YES or NO)

Note: Actual depths will be submitted at a later date.

- ☒ a. Diagrammatic Sketch of the Dual Completion, showing all casing strings, including size and setting, top of cement, perforated intervals, tubing strings, including diameters and setting depth, location and type of packers and side door chokes, and such other information as may be pertinent.
- ☒ b. Plat showing the location of all wells on applicant's lease, all offset wells on offset leases, and the names and addresses of operators of all leases offsetting applicant's lease.
- ☒ c. Waivers consenting to such dual completion from each offset operator, or in lieu thereof, evidence that said offset operators have been furnished copies of the application. Note: To be submitted at a later date.
- ☐ d. Electrical log of the well or other acceptable log with tops and bottoms of producing zones and intervals of perforation indicated thereon. (If such log is not available at the time application is filed, it shall be submitted as provided by Rule 112-A.)

5. List all offset operators to the lease on which this well is located together with their correct mailing address.

1. El Paso Natural Gas Company, P.O. Box 990, Farmington, New Mexico
2. Amerada Petroleum Corporation, West Building, Durango, Colorado
3. Jay J. Harris, 1213 N. Mesa Verde Avenue, Farmington, New Mexico
4. Continental Oil Company, 1919 Main Avenue, Durango, Colorado

6. Were all operators listed in Item 5 above notified and furnished a copy of this application? YES ☒ NO ☐ . If answer is yes, give date of such notification June 18, 1964.

CERTIFICATE: I, the undersigned, state that I am the District Engineer of the Socony Mobil Oil Company, Inc. (company), and that I am authorized by said company to make this report; and that this report was prepared under my supervision and direction and that the facts stated therein are true, correct and complete to the best of my knowledge.

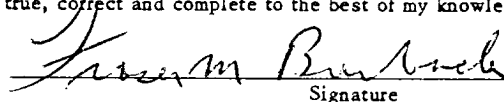
Signature

- * Should waivers from all offset operators not accompany an application for administrative approval, the New Mexico Oil Conservation Commission will hold the application for a period of twenty (20) days from date of receipt by the Commission's Santa Fe office. If, after said twenty-day period, no protest nor request for hearing is received by the Santa Fe office, the application will then be processed.
- NOTE: If the proposed dual completion will result in an unorthodox well location and/or a non-standard proration unit in either or both of the producing zones, then separate application for approval of the same should be filed simultaneously with this application.

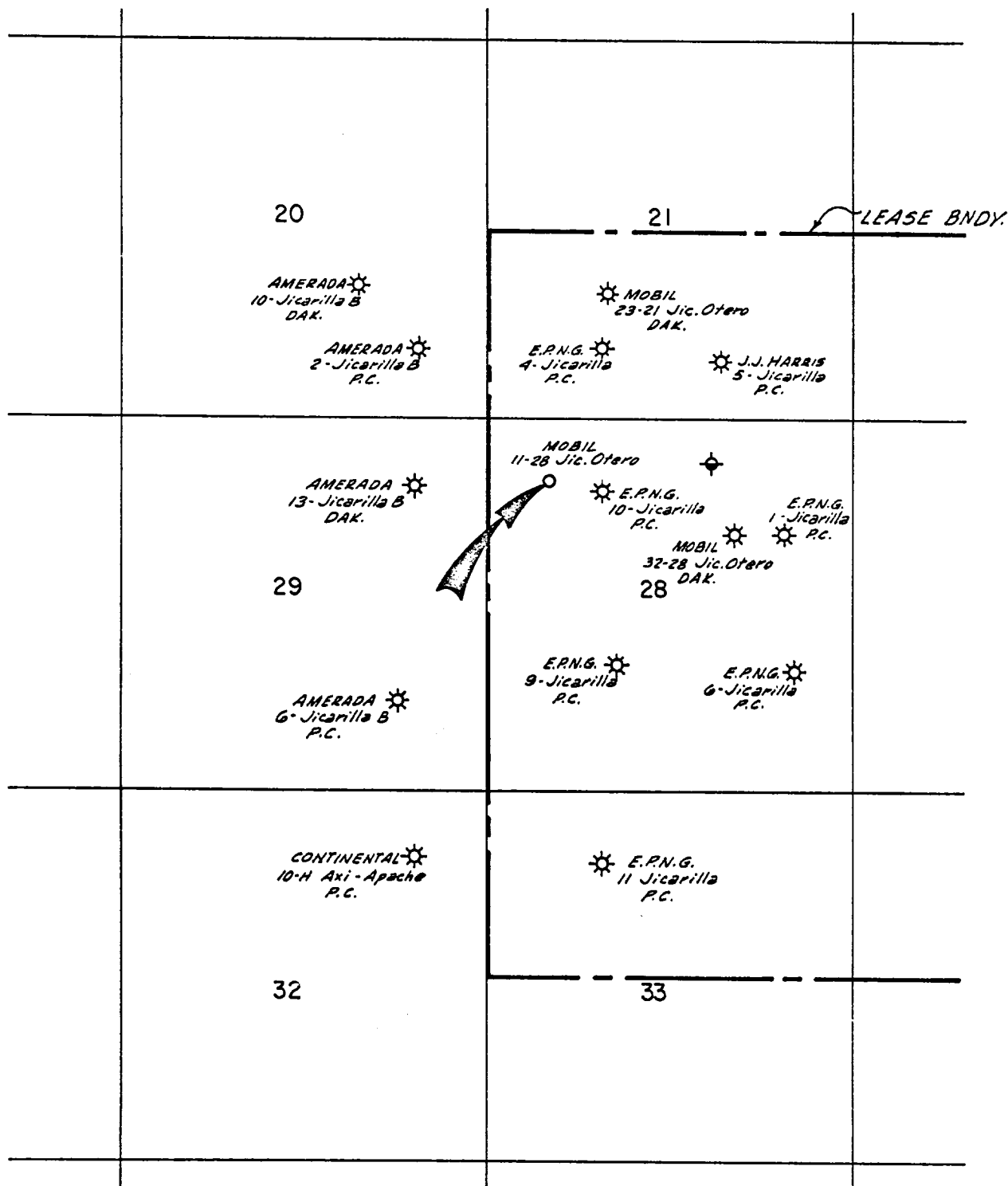

Location Plat to Accompany Application for Dual Completion of the Jicarilla-Otero #11-28, Unit D, Sec. 28, T.24N., R.5W., Rio Arriba Co., New Mexico

