



IN REPLY REFER TO:

UNITED STATES
DEPARTMENT OF THE INTERIOR
GEOLOGICAL SURVEY
P. O. Box 945
Farmington, New Mexico

September 2, 1955

Apache Petroleum Corporation
Denver 2
Farmington, New Mexico

Re: Jicarilla Apache
Contract 11, Tr. 19

Gentlemen:

Receipt is acknowledged of your "Notice of intention to drill" dated September 5, 1955 covering your well No. 4 Jicarilla Apache "11" in SE 1/4, Sec. 19, T. 24 N., R. 5 W., N. M. P. M., Rio Arriba County, New Mexico,

Your proposed work is hereby approved subject to compliance with the "Conditions of the Well and the Operating Regulations" revised May 2, 1952, a copy of which will be sent to you on request, and subject to the following conditions:

1. Drilling operations on such well are subject to the attached sheet for general conditions of approval.
2. Furnish copies of all logs.

Very truly yours,

Jerry B. Long
Acting District Engineer

JBL:ac
cc: Jicarilla Agency
W.G. Smith



DAVIDSON CITY,
MISSOURI,
JANUARY 10, 1911.



(SUBMIT IN TRIPLICATE)

Indian Agency Alamogordo Apache
CONTRACT
Tribal Oil Tract 219
Allottee _____
Lease No. Alamogordo Apache "B"

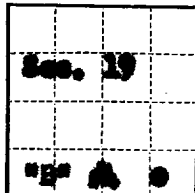

R
5
W

UNITED STATES
DEPARTMENT OF THE INTERIOR
GEOLOGICAL SURVEY

7-24-W

SUNDRY NOTICES AND REPORTS ON WELLS

NOTICE OF INTENTION TO DRILL	<input checked="" type="checkbox"/>	SUBSEQUENT REPORT OF WATER SHUT-OFF	
NOTICE OF INTENTION TO CHANGE PLANS		SUBSEQUENT REPORT OF SHOOTING OR ACIDIZING	
NOTICE OF INTENTION TO TEST WATER SHUT-OFF		SUBSEQUENT REPORT OF ALTERING CASING	
NOTICE OF INTENTION TO REDRILL OR REPAIR WELL		SUBSEQUENT REPORT OF REDRILLING OR REPAIR	
NOTICE OF INTENTION TO SHOOT OR ACIDIZE		SUBSEQUENT REPORT OF ABANDONMENT	
NOTICE OF INTENTION TO PULL OR ALTER CASING		SUPPLEMENTARY WELL HISTORY	
NOTICE OF INTENTION TO ABANDON WELL			

(INDICATE ABOVE BY CHECK MARK NATURE OF REPORT, NOTICE, OR OTHER DATA)

1955
U.S. GEOLOGICAL SURVEY
FARMINGTON, NEW MEXICO

September 5, 1955

Well No. 4 is located 990' ft. from XX line and 990' ft. from E line of sec. 19

24/A 24/A Sec. 19
(1/4 Sec. and Sec. No.)

7-24-W
(Twp.)

R-5-W
(Range)

104°W
(Meridian)

Undesignated
(Field)

Rio Arriba
(County or Subdivision)

New Mexico
(State or Territory)

The elevation of the derrick floor above sea level is _____ ft. not determined

DETAILS OF WORK

(State names of and expected depths to objective sands; show sizes, weights, and lengths of proposed casings; indicate mudding jobs, cementing points, and all other important proposed work)

Intend to drill well with rotary tools to approximately 2150' and then set pipe.

Complete with cable tools to approx. 2400' to test Fruitland Pictured Cliff Section.

Hole	Casing	Weight	Material	Depth	Remarks	Notes
12 1/4"	8 5/8"	24.5	New	140'	Cemented	75
7 7/8"	5 1/2"	13.55	New	2250'	Cemented	200
4 3/4"	Open Hole					

I understand that this plan of work must receive approval in writing by the Geological Survey before operations may be commenced.

Company Ames Petroleum Corporation

Address Brewer B

Moscow, New Mexico

By D. C. Capps

Title District Superintendent

Company AMERADA PETROLEUM CORPORATION

Lease JICARILLA APACHE Well No. B - 4

Sec. 19, T. 24 N., R. 5 W., N.M.P.M.

Location 990' FROM THE SOUTH LINE AND 990' FROM
THE EAST LINE.

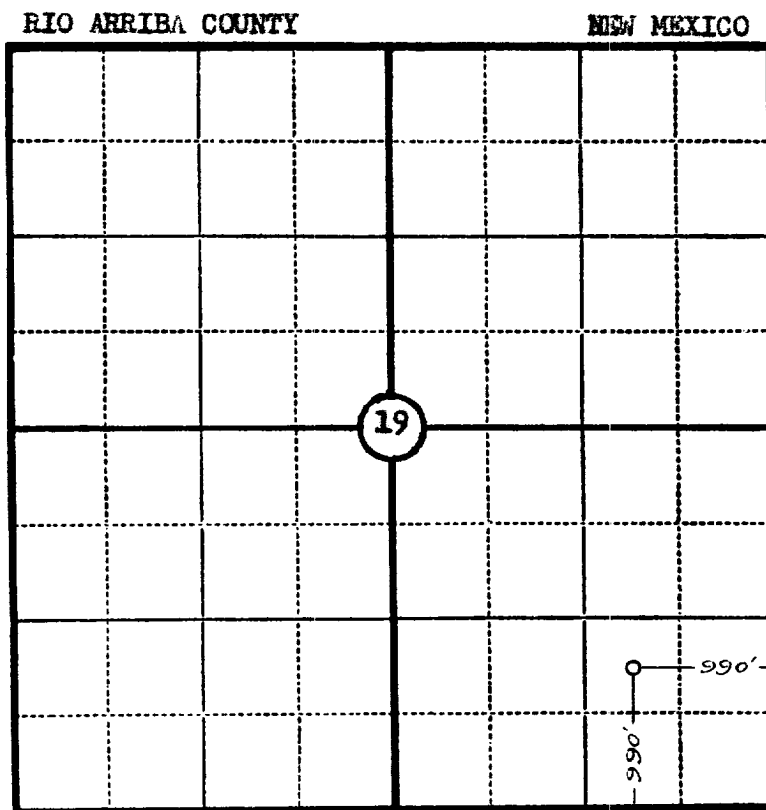

Scale—4 inches equal 1 mile.

This is to certify that the above plat was prepared from field notes of actual surveys made by me or under my supervision and that the same are true and correct to the best of my knowledge and belief.

Seal:

James P. Leese
Registered ~~Surveyor~~ Land Surveyor.

James P. Leese
N. Mex. Reg. No. 1463

Surveyed 3 September, 19 55